

PROP. CURVE PR-P1-3
 PI STA. = 21175+23.95
 $\Delta = 55^\circ 49' 47''$ (RT)
 $D = 6^\circ 59' 14''$
 $R = 820.00'$
 $T = 434.44'$
 $L = 799.02'$
 $E = 107.98'$
 $e = 7.96\%$
 T.R. = SEE SE TABLE
 S.E. RUN = SEE SE TABLE
 P.C. STA = 21170+89.51
 P.T. STA = 21178+88.53

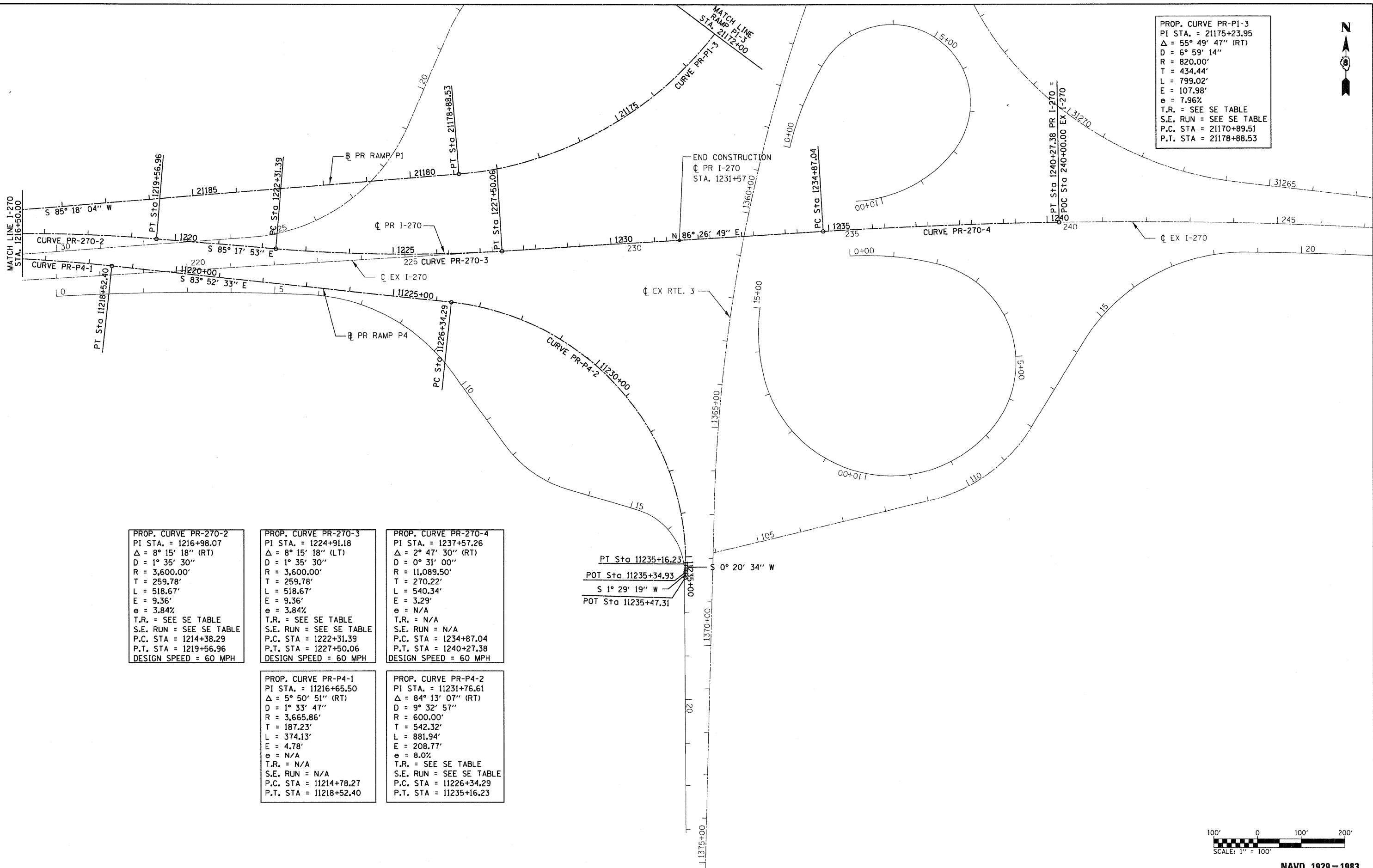

PROP. CURVE PR-270-2
 PI STA. = 1216+98.07
 $\Delta = 8^\circ 15' 18''$ (RT)
 $D = 1^\circ 35' 30''$
 $R = 3,600.00'$
 $T = 259.78'$
 $L = 518.67'$
 $E = 9.36'$
 $e = 3.84\%$
 T.R. = SEE SE TABLE
 S.E. RUN = SEE SE TABLE
 P.C. STA = 1214+38.29
 P.T. STA = 1219+56.96
 DESIGN SPEED = 60 MPH

PROP. CURVE PR-270-3
 PI STA. = 1224+91.18
 $\Delta = 8^\circ 15' 18''$ (LT)
 $D = 1^\circ 35' 30''$
 $R = 3,600.00'$
 $T = 259.78'$
 $L = 518.67'$
 $E = 9.36'$
 $e = 3.84\%$
 T.R. = SEE SE TABLE
 S.E. RUN = SEE SE TABLE
 P.C. STA = 1222+31.39
 P.T. STA = 1227+50.06
 DESIGN SPEED = 60 MPH

PROP. CURVE PR-270-4
 PI STA. = 1237+57.26
 $\Delta = 2^\circ 47' 30''$ (RT)
 $D = 0^\circ 31' 00''$
 $R = 11,089.50'$
 $T = 270.22'$
 $L = 540.34'$
 $E = 3.29'$
 $e = N/A$
 T.R. = N/A
 S.E. RUN = N/A
 P.C. STA = 1234+87.04
 P.T. STA = 1240+27.38
 DESIGN SPEED = 60 MPH

PROP. CURVE PR-P4-1
 PI STA. = 11216+65.50
 $\Delta = 5^\circ 50' 51''$ (RT)
 $D = 1^\circ 33' 47''$
 $R = 3,665.86'$
 $T = 187.23'$
 $L = 374.13'$
 $E = 4.78'$
 $e = N/A$
 T.R. = N/A
 S.E. RUN = N/A
 P.C. STA = 11214+78.27
 P.T. STA = 11218+52.40

PROP. CURVE PR-P4-2
 PI STA. = 11231+76.61
 $\Delta = 84^\circ 13' 07''$ (RT)
 $D = 9^\circ 32' 57''$
 $R = 600.00'$
 $T = 542.32'$
 $L = 881.94'$
 $E = 208.77'$
 $e = 8.0\%$
 T.R. = SEE SE TABLE
 S.E. RUN = SEE SE TABLE
 P.C. STA = 11226+34.29
 P.T. STA = 11235+16.23

PT Sta 11235+16.23
 POT Sta 11235+34.93
 S 1° 29' 19" W
 POT Sta 11235+47.31

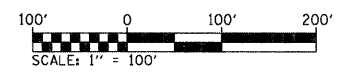

FILE NAME = D876A91-Sh1-ATB04.dgn
VOLKERT

USER NAME = mmccanachie	DESIGNED - CLS	REVISED -
PLOT SCALE = 1/8" = 100' / IN.	DRAWN - MAM	REVISED -
PLOT DATE = 3/15/2011	CHECKED - CLS	REVISED -
	DATE - 3/18/2011	REVISED -

**STATE OF ILLINOIS
 DEPARTMENT OF TRANSPORTATION**

ALIGNMENTS AND TIES

SCALE: 1" = 100' SHEET NO. 4 OF 10 SHEETS STA. 1216+50 TO STA. 1240+27.38

F.A.I. RTE. 270	SECTION	COUNTY	TOTAL SHEETS	SHEET NO.
	60-1B-1	MADISON	712	31
CONTRACT NO. 76A91			ILLINOIS FED. AID PROJECT	

NAVD 1929=1983