

**MOT LEGEND**

- WORK ZONE AREA
  - WORK ZONE FOR TEMPORARY PAVEMENT CONSTRUCTION
  - COMPLETED TEMPORARY PAVEMENT IN PREVIOUS STAGES
  - IMPACT ATTENUATOR
  - DIRECTION OF TRAFFIC
  - TEMPORARY CONCRETE BARRIER
  - SIGN ON PORTABLE OR PERMANENT SUPPORT
  - TYPE III BARRICADES
  - TYPE II WITH STEADY BURNING MONODIRECTIONAL LIGHT \*
  - MESSAGE BOARD
- \* DRUM OR BARRICADE SPACING:  
 50' C-C ON TANGENTS  
 25' C-C ON TAPERS OR LANE SHIFTS  
 12' C-C ON RADII'S OR RAMPS  
 5' C-C FOR RAMP OR ROAD CLOSURES

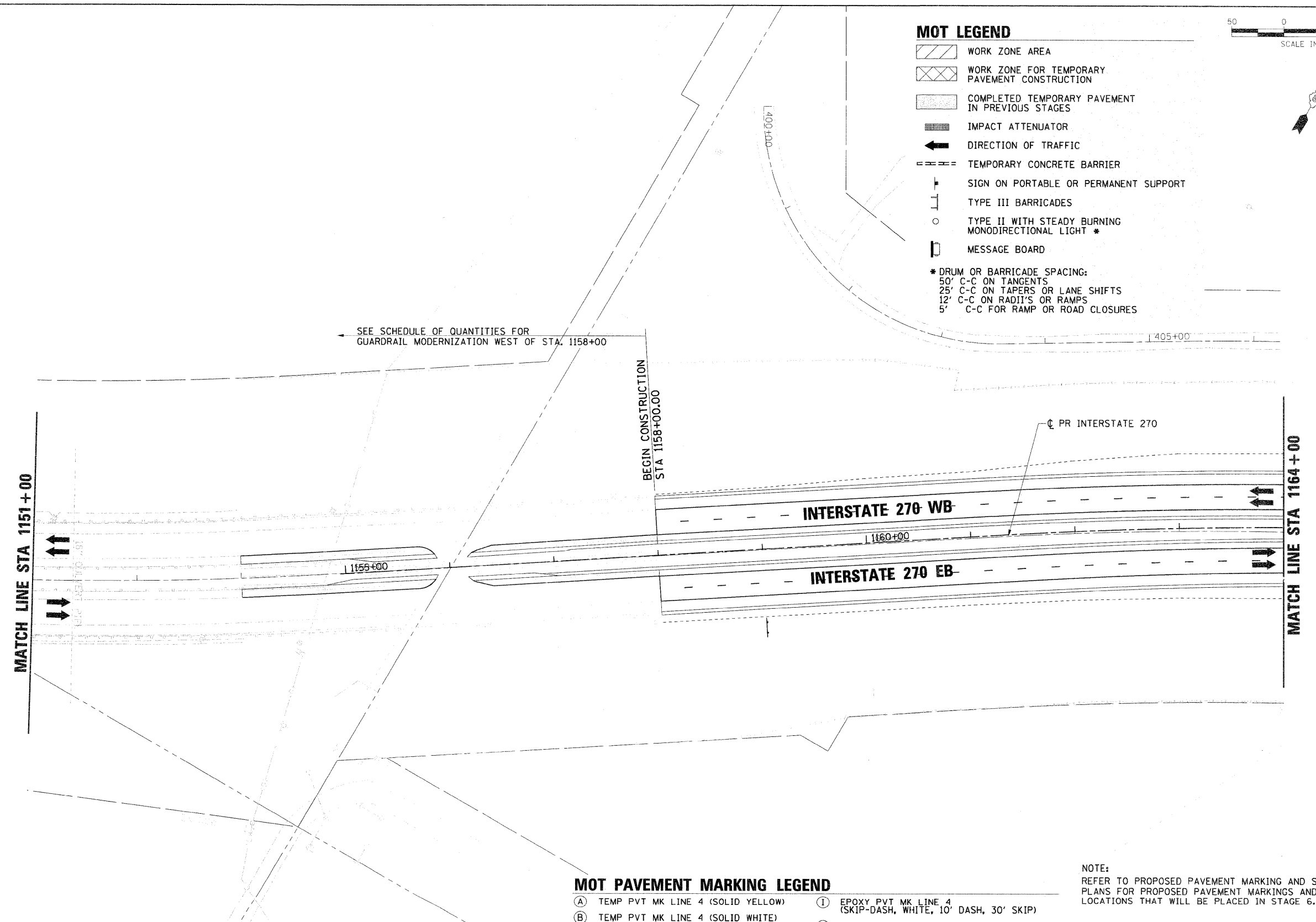

**MOT PAVEMENT MARKING LEGEND**

- |   |   |
|---|---|
| (A) TEMP PVT MK LINE 4 (SOLID YELLOW)                         | (I) EPOXY PVT MK LINE 4 (SKIP-DASH, WHITE, 10' DASH, 30' SKIP)              |
| (B) TEMP PVT MK LINE 4 (SOLID WHITE)                          | (J) NOT USED  |
| (C) TEMP PVT MK LINE 4 (SKIP-DASH, WHITE, 10' DASH, 30' SKIP) | (K) WET PAVT TAPE T3 4 (SOLID YELLOW)                                       |
| (D) NOT USED  | (L) WET PAVT TAPE T3 4 (SOLID WHITE)  |
| (E) TEMP PVT MK LINE 24 (SOLID WHITE)                         | (M) WET PAVT TAPE T3 4 (SOLID WHITE) (SKIP-DASH, WHITE, 10' DASH, 30' SKIP) |
| (F) TEMP PVT MK LTR & SYM (SOLID WHITE)                       | (N) WET PAVT TAPE T3 6 (SOLID WHITE)  |
| (G) EPOXY PVT MK LINE 4 (SOLID YELLOW)                        | (O) WET PAVT TAPE T3 24 (SOLID WHITE)                                       |
| (H) EPOXY PVT MK LINE 4 (SOLID WHITE)                         |   |

NOTE:  
 REFER TO PROPOSED PAVEMENT MARKING AND SIGNAGE PLANS FOR PROPOSED PAVEMENT MARKINGS AND SIGNAGE LOCATIONS THAT WILL BE PLACED IN STAGE 6.

**KEY MAP**

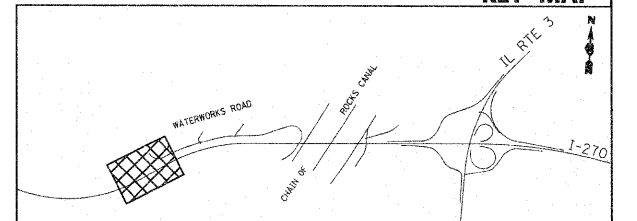

FILE NAME = 0876A91-Sht-MOT06-02.dgn	USER NAME = sb1:ven	DESIGNED - JC	REVISED - 1-01-11	<b>STATE OF ILLINOIS DEPARTMENT OF TRANSPORTATION</b>	<b>SUGGESTED MAINTENANCE OF TRAFFIC STAGE 6 INTERSTATE 270</b>	F.A.I. RTE. 270	SECTION 60-1B-1	COUNTY MADISON	TOTAL SHEETS 712	SHEET NO. 193		
PLOT SCALE = #SCALE#	DRAWN - BH	REVISED - 4-20-11	REVISED -			SCALE: 1" = 50'	SHEET NO. 2 OF 9 SHEETS	STA.	TO STA.	CONTRACT NO. 76A91		
PLOT DATE = 4/20/2011	CHECKED -	REVISED -	REVISED -			ILLINOIS FED. AID PROJECT						
	DATE -	REVISED -	REVISED -									