

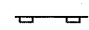





LEGEND

-  PERIMETER EROSION BARRIER
-  INLET AND PIPE PROTECTION
-  CLASS 2A SEEDING
(WITH MULCH METHOD 2)
-  TEMPORARY DITCH CHECKS
-  CLASS 3A SEEDING
(WITH EROSION CONTROL BLANKET)
-  SEEDING, SPECIAL
-  SEEDING, SPECIAL
(WITH EROSION CONTROL BLANKET)

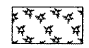
NOTE:
FINAL SEEDING AREAS ARE SHOWN BY STAGE
AND TYPE.
- SEEDING CLASS 2A SHALL BE USED WITH
MULCH METHOD 2 ON SIDE SLOPES FLATTER
THAN 1:3 (V:H).
- SEEDING CLASS 3A SHALL BE USED WITH
EROSION CONTROL BLANKET ON 1:3 (V:H)
OR STEEPER SLOPES.
- SEEDING, SPECIAL SHALL BE USED ON
LEVEE AREAS AS SHOWN.
TWO APPLICATIONS OF TEMPORARY SEEDING
WITH MULCH METHOD 2 IS ALSO QUANTIFIED
AND INCLUDED IN THE SEEDING SCHEDULE FOR
ALL AREAS.

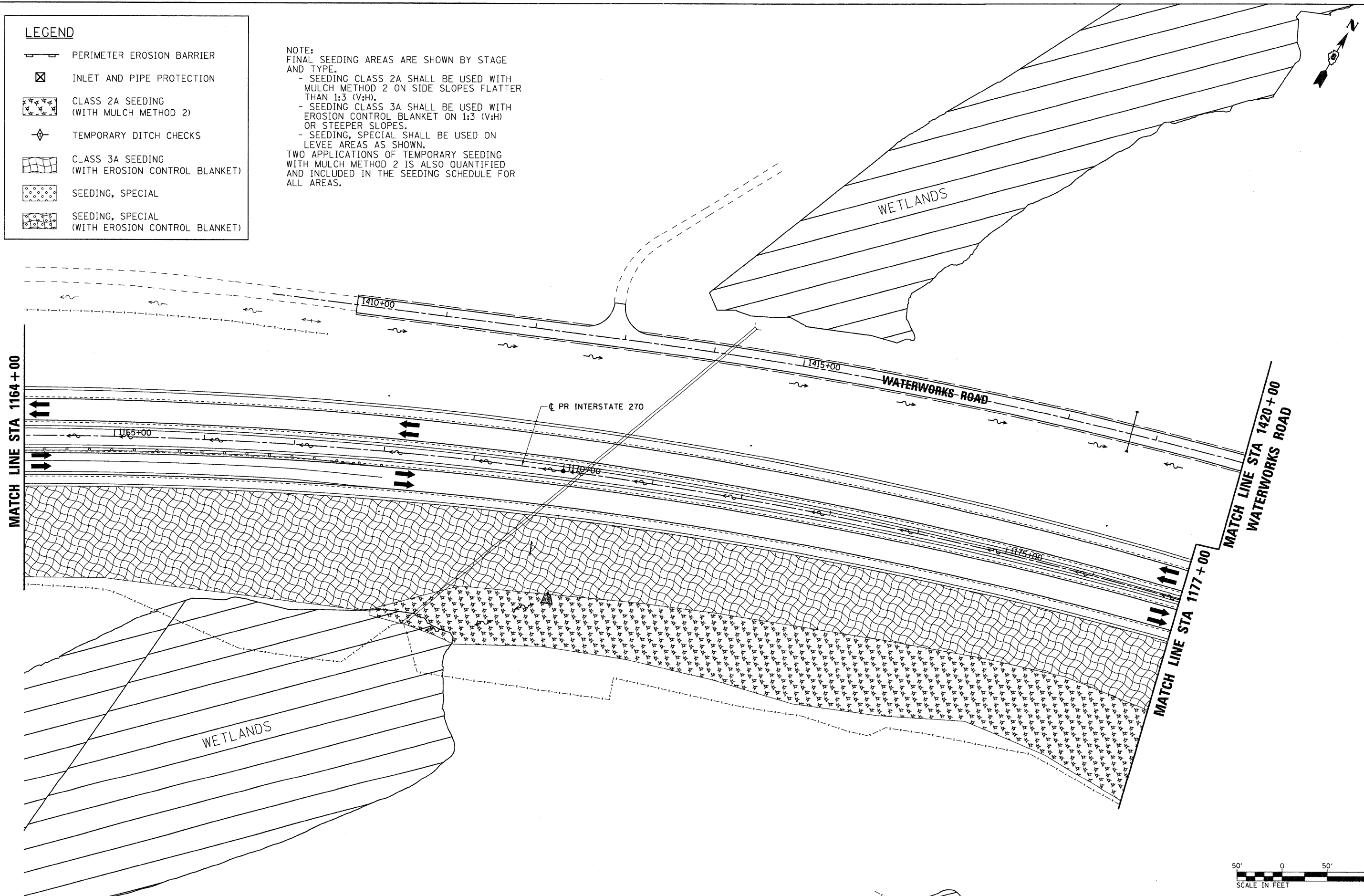

FILE NAME =
D876A91-Sht-Eros-05-02.dgn
VOLKERT

USER NAME = untitled	DESIGNED - MPW	REVISED -
PLOT SCALE = 50.0000' / IN.	DRAWN - CJS	REVISED -
PLOT DATE = 3/15/2011	CHECKED - PMK	REVISED -
	DATE - 3/18/2011	REVISED -

**STATE OF ILLINOIS
DEPARTMENT OF TRANSPORTATION**

EROSION CONTROL PLAN - STAGE 5

SCALE: 1" = 50' SHEET NO. 29 OF 38 SHEETS STA. 1164+00 TO STA. 1177+00

F.A.I. RTE.	SECTION	COUNTY	TOTAL SHEETS	SHEET NO.
270	60-18-1	MADISON	712	240
				CONTRACT NO. 76A91
ILLINOIS FED. AID PROJECT				