

DRAINAGE LEGEND

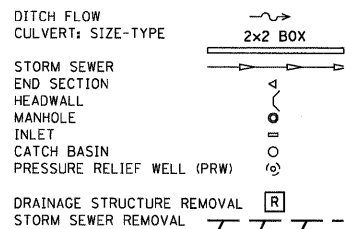

UTILITY LEGEND

ALL UTILITY INFORMATION HEREON IS DEPICTED TO QUALITY LEVEL "B" (QL-B) UNLESS OTHERWISE NOTED. QL-B INFORMATION IS OBTAINED THROUGH THE APPLICATION OF APPROPRIATE SURFACE GEOPHYSICAL METHODS TO IDENTIFY THE EXISTENCE AND APPROXIMATE HORIZONTAL POSITION OF SUBSURFACE UTILITIES. QL-B DATA ARE REPRODUCIBLE BY SURFACE GEOPHYSICS AT ANY POINT OF THEIR DEPICTION. THIS INFORMATION IS SURVEYED TO APPLICABLE TOLERANCES AND REDUCED ONTO PLAN DOCUMENTS.

SIZE INFORMATION SHOWN HEREON IS TAKEN FROM AVAILABLE UTILITY RECORDS.

ABBREVIATIONS:

(QL-C) DEPICTED ACCORDING TO RECORD INFORMATION AND EXISTING ASSOCIATED UTILITY STRUCTURES. NO ELECTRONIC INFORMATION WAS OBTAINED.

(QL-D) DEPICTED ACCORDING TO RECORD INFORMATION. NO ELECTRONIC INFORMATION WAS OBTAINED.

(FO) FIBER OPTIC

(AATUR) ABANDONED ACCORDING TO UTILITY RECORDS

(AATFI) ABANDONED ACCORDING TO FIELD INSPECTION

EOI END OF ELECTRONIC DESIGNATING INFORMATION

EORI END OF UTILITY RECORD INFORMATION

(NAP) NO ASSOCIATED PIPING FOUND FROM UTILITY STRUCTURE

— UTILITY ENDPOINT

UNLESS OTHERWISE NOTED, UTILITY LINE LIMITS DEPICTED REPRESENT FIELD DESIGNATING LIMITS AND NOT ENDPOINTS OF UTILITIES.

UTILITY INFORMATION LABELED "QL-C" OR "QL-D" IS DERIVED FROM FURNISHED RECORDS. SUCH INFORMATION MAY NOT BE ACCURATE OR RELIABLE. IT IS THE CONTRACTORS RESPONSIBILITY TO FIELD VERIFY THIS UTILITY INFORMATION.

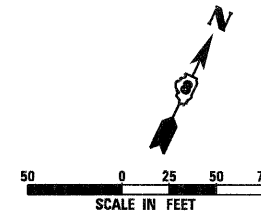

STORM SEWER REM 24
STA 1159+99.6, 1.7 RT TO STA 1159+98.4, 146.7 RT - 144.7'

REMOV CATCH BAS
STA 1159+99.6, 1.7 RT

NOTE:
REMOVAL OF EXISTING END SECTIONS AND HEADWALLS SHALL NOT BE MEASURED FOR PAYMENT, BUT SHALL BE CONSIDERED INCIDENTAL TO THE COST OF THE SEWER BEING REMOVED.

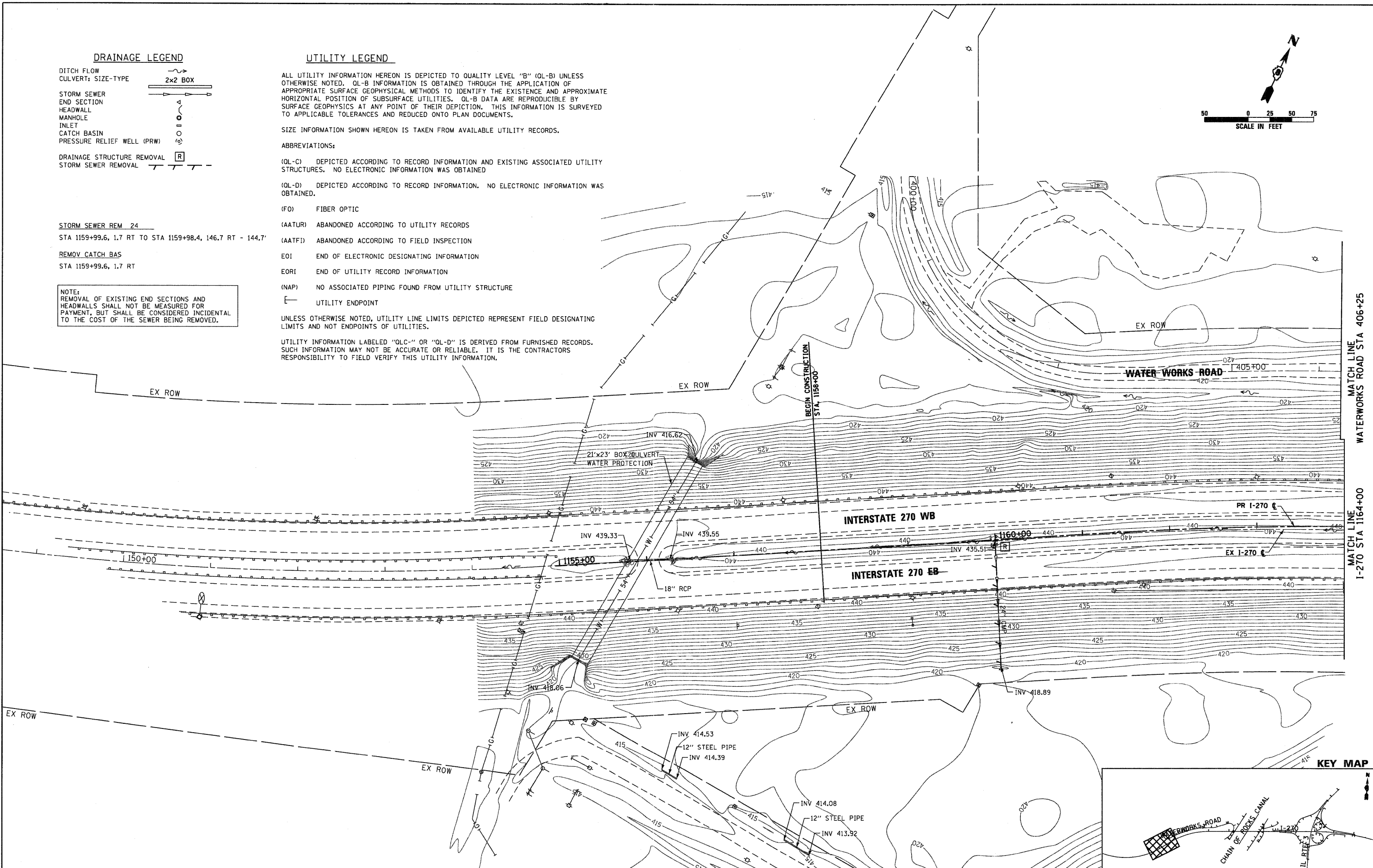

MATCH LINE WATERWORKS ROAD STA 406+25
MATCH LINE I-270 STA 1164+00

KEY MAP

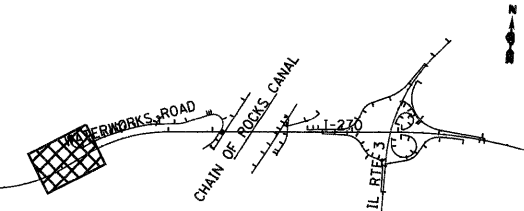

FILE NAME = DB76A91-Sht-ExD-rain01.dgn

USER NAME = EDeon
PLOT SCALE = 1:50
PLOT DATE = 3/18/11

DESIGNED - JWM
DRAWN - JWM
CHECKED - MBL
DATE - 3/18/11

REVISED -
REVISED -
REVISED -
REVISED -

**STATE OF ILLINOIS
DEPARTMENT OF TRANSPORTATION**

**EXISTING DRAINAGE & UTILITIES
INTERSTATE 270**

SCALE: 1" = 50' SHEET NO. 1 OF 11 SHEETS STA. BEGIN TO STA. 1164+00

F.A.I. RTE.	SECTION	COUNTY	TOTAL SHEETS	SHEET NO.
270	60-1B-1	MADISON	712	250
				CONTRACT NO. 76A91
ILLINOIS FED. AID PROJECT				