

SEE PROPOSED DRAINAGE LEGEND ON SHEET NO. 1 OF 11

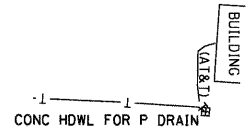

CONC HDWL FOR P DRAIN
 STA 11231+00.0, 40.0 LT
 STA 11231+00.0, 26.0 RT
 STA 11235+00.0, 26.0 RT

PIPE UNDERDRAIN 4 SP

STA 11231+00.0, 16.0 LT TO STA 11231+00.0, 40.0 LT - 24.0'
 STA 11231+00.0, 0.0 LT TO STA 11231+00.0, 26.0 RT - 26.0'
 STA 11235+00.0, 0.0 LT TO STA 11235+00.0, 26.0 RT - 26.0'

PIPE UNDERDRAINS 4

STA 11230+00.0, 16.0 LT TO STA 11235+00.0, 16.0 LT - 495.9'
 STA 11230+00.0, 0.0 LT TO STA 11235+00.0, 0.0 LT - 500.0'

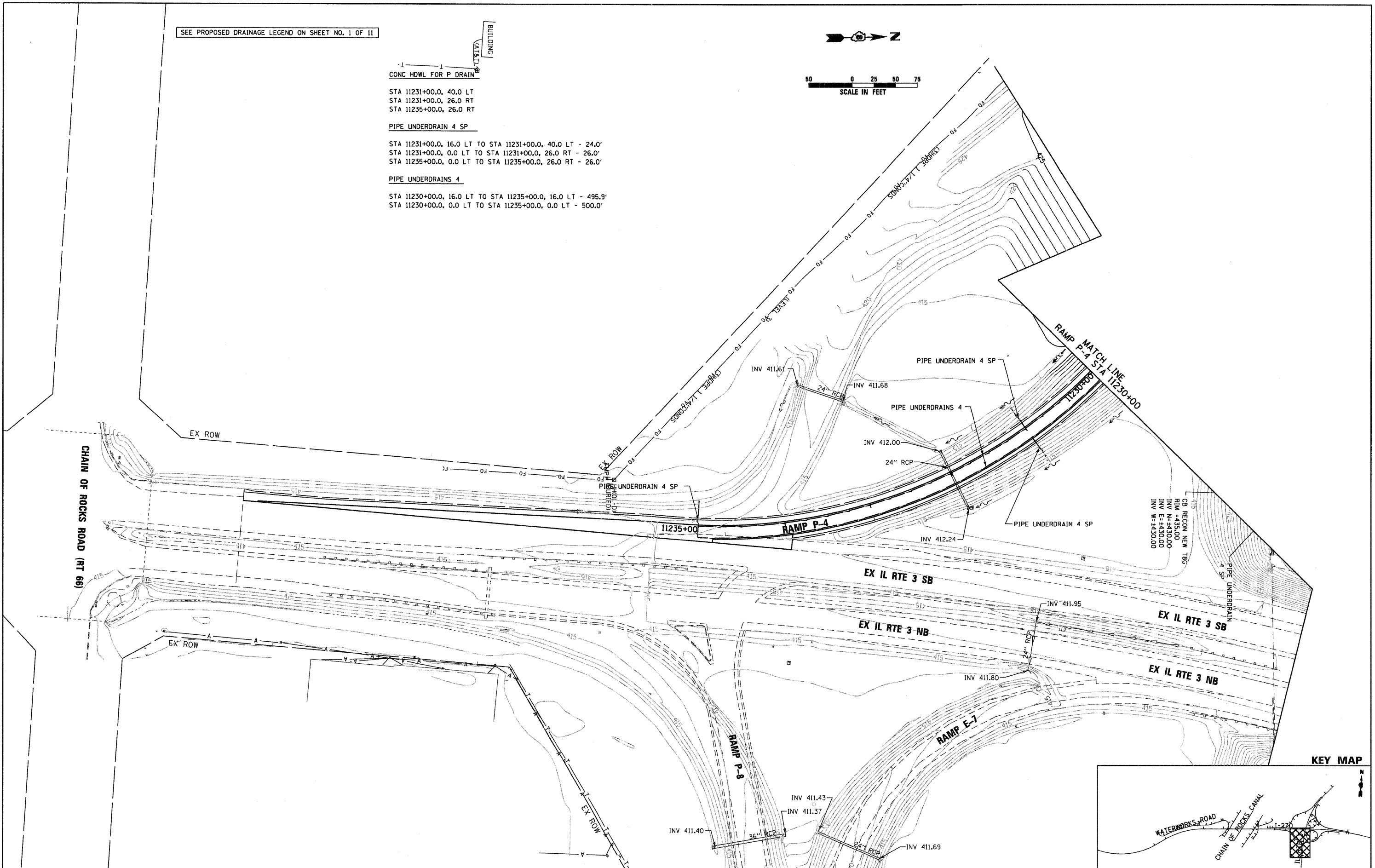
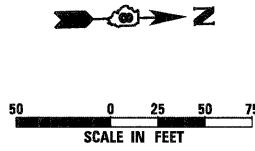

CB RECON NEW T8C
 RIM = 435.00
 INV N = 430.00
 INV E = 430.00
 INV W = 430.00

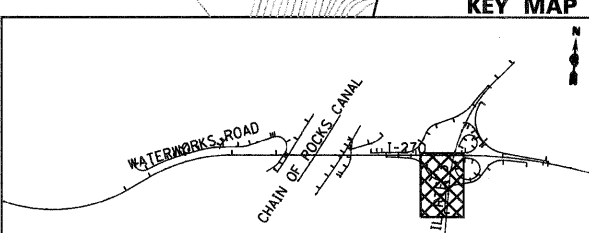

FILE NAME =
 DB76A91-Sht-P-Drain07.dgn

USER NAME = EDean
 PLOT SCALE = 1:50,000
 PLOT DATE = 3/18/11

DESIGNED - JWM
 DRAWN - JWM
 CHECKED - MBL
 DATE - 3/18/11

REVISED -
 REVISED -
 REVISED -
 REVISED -

STATE OF ILLINOIS
 DEPARTMENT OF TRANSPORTATION

PROPOSED DRAINAGE PLAN
 IL RTE 3
 SCALE: 1" = 50'
 SHEET NO. 7 OF 11 SHEETS
 STA. 1375+20 TO STA. 1361+00

F.A.I. RTE.	SECTION	COUNTY	TOTAL SHEETS	SHEET NO.
270	60-18-1	MADISON	712	267
CONTRACT NO. 76A91				
ILLINOIS FED. AID PROJECT				