

SEE PROPOSED DRAINAGE LEGEND ON SHEET NO. 1 OF 11

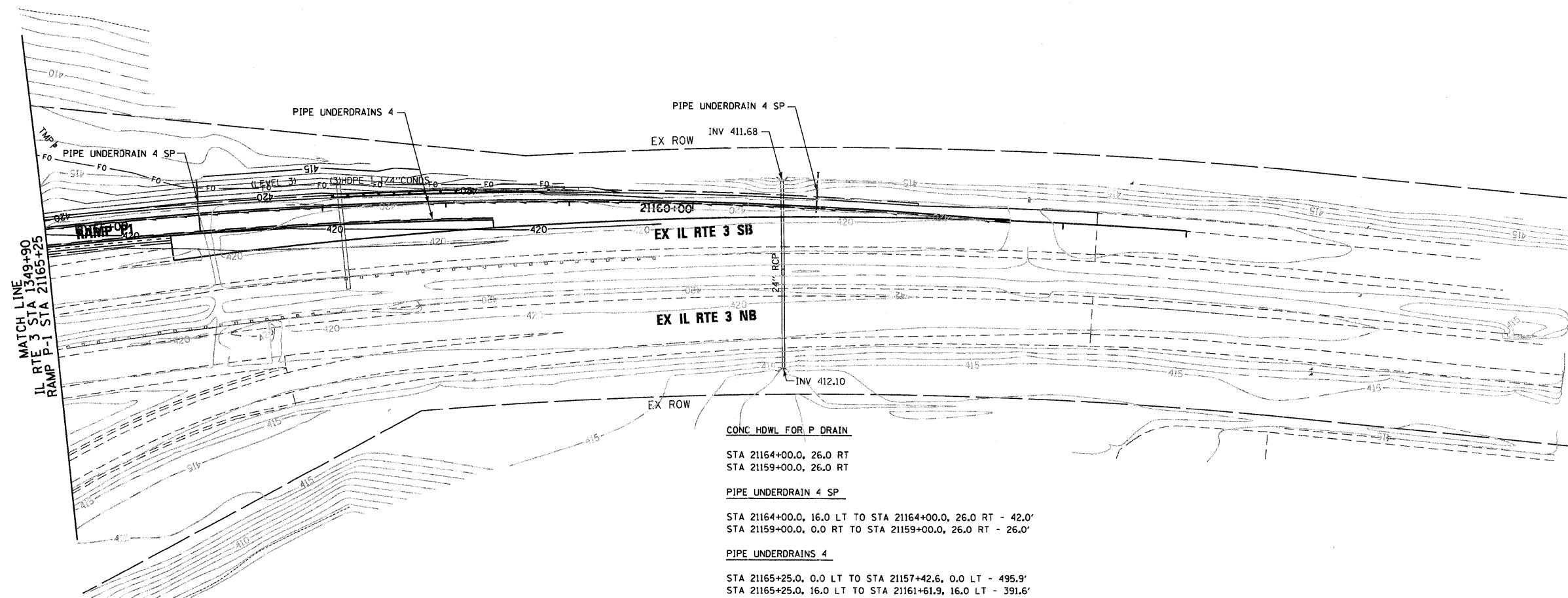
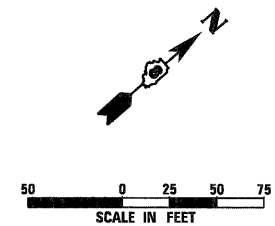

MATCH LINE
IL RTE 3 STA 1349+90
RAMP P-1 STA 21165+25

CONC HDWL FOR P DRAIN
 STA 21164+00.0, 26.0 RT
 STA 21159+00.0, 26.0 RT

PIPE UNDERDRAIN 4 SP
 STA 21164+00.0, 16.0 LT TO STA 21164+00.0, 26.0 RT - 42.0'
 STA 21159+00.0, 0.0 RT TO STA 21159+00.0, 26.0 RT - 26.0'

PIPE UNDERDRAINS 4
 STA 21165+25.0, 0.0 LT TO STA 21157+42.6, 0.0 LT - 495.9'
 STA 21165+25.0, 16.0 LT TO STA 21161+61.9, 16.0 LT - 391.6'

KEY MAP

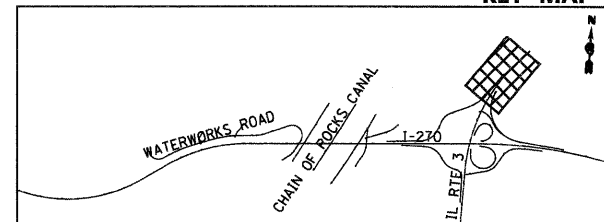

FILE NAME =
D876A91-Sht-P-Drain09.dgn

USER NAME = EDeen	DESIGNED - JWM	REVISED -
	DRAWN - JWM	REVISED -
PLOT SCALE = 1:50	CHECKED - MBL	REVISED -
PLOT DATE = 3/18/11	DATE - 3/18/11	REVISED -

STATE OF ILLINOIS
DEPARTMENT OF TRANSPORTATION

PROPOSED DRAINAGE PLAN
IL RTE 3

SCALE: 1" = 50' SHEET NO. 9 OF 12 SHEETS STA. 1349+90 TO STA. 1335+37

F.A.I. RTE.	SECTION	COUNTY	TOTAL SHEETS	SHEET NO.
270	60-18-1	MADISON	712	269
				CONTRACT NO. 76A91
ILLINOIS FED. AID PROJECT				