

**SUPERSTRUCTURE  
BILL OF MATERIAL**

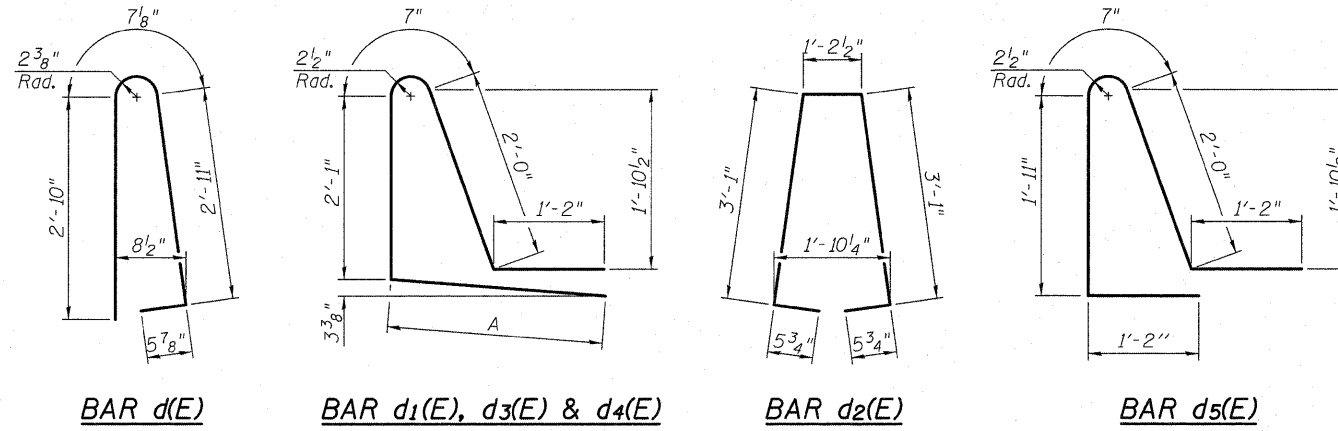

Bar	A
d1(E)	2'-5"
d3(E)	2'-2"
d4(E)	2'-0"

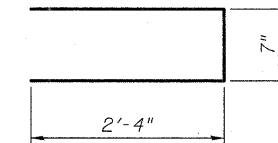
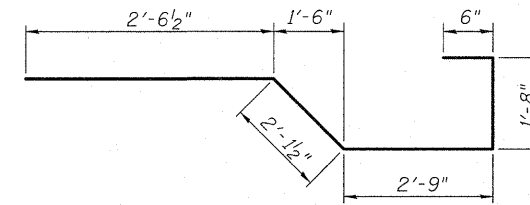

Bar	No.	Size	Length	Shape
d(E)	9,462	#5	48'-5"	U
d1(E)	9,465	#5	33'-4"	U
d2(E)	9,460	#6	6'-6"	T
d3(E)	9,460	#6	10'-0"	U
d4(E)	48	#6	48'-8"	U
d5(E)	36	#6	9'-4"	U
d6(E)	608	#5	1'-6"	U
b(E)	4,850	#5	42'-0"	—
b1(E)	4,512	#6	35'-6"	—
b2(E)	3,978	#5	41'-3"	—
d(E)	4,302	#5	6'-10"	L
d1(E)	394	#5	8'-3"	L
d2(E)	2,151	#5	8'-4"	L
d3(E)	2,566	#5	8'-0"	L
d4(E)	1,342	#5	7'-10"	L
d5(E)	4,302	#5	6'-10"	L
e(E)	2,194	#4	19'-8"	—
e1(E)	92	#4	14'-10"	—
e2(E)	32	#8	19'-8"	—
e3(E)	32	#8	33'-4"	—
e4(E)	32	#4	30'-7"	—
e5(E)	96	#8	38'-1"	—
e6(E)	96	#4	35'-2"	—
e7(E)	46	#4	14'-8"	—
e8(E)	52	#8	39'-5"	—
e9(E)	52	#4	36'-6"	—
e10(E)	40	#8	37'-9"	—
e11(E)	40	#4	34'-11"	—
x(E)	182	#5	9'-7"	L
x1(E)	180	#4	5'-3"	U
Reinforcement Bars, Epoxy Coated			Pound	1,847,820
Concrete Superstructure			Cu. Yd.	6,202.8

Bars indicated thus 1 x 4-#8 etc. indicates 1 line of bars with 4 lengths per line.

5/22/2011 9:25:18 AM c:\pwworking\oma\0549104\0600345-76A91-040-SDT.dgn jmgus