

DATE	
BY	
SURVEYED	
PLOTTED	
TEMPLATE	
AREAS	
NO.	

DATE	
BY	
SURVEYED	
PLOTTED	
TEMPLATE	
AREAS	
NO.	

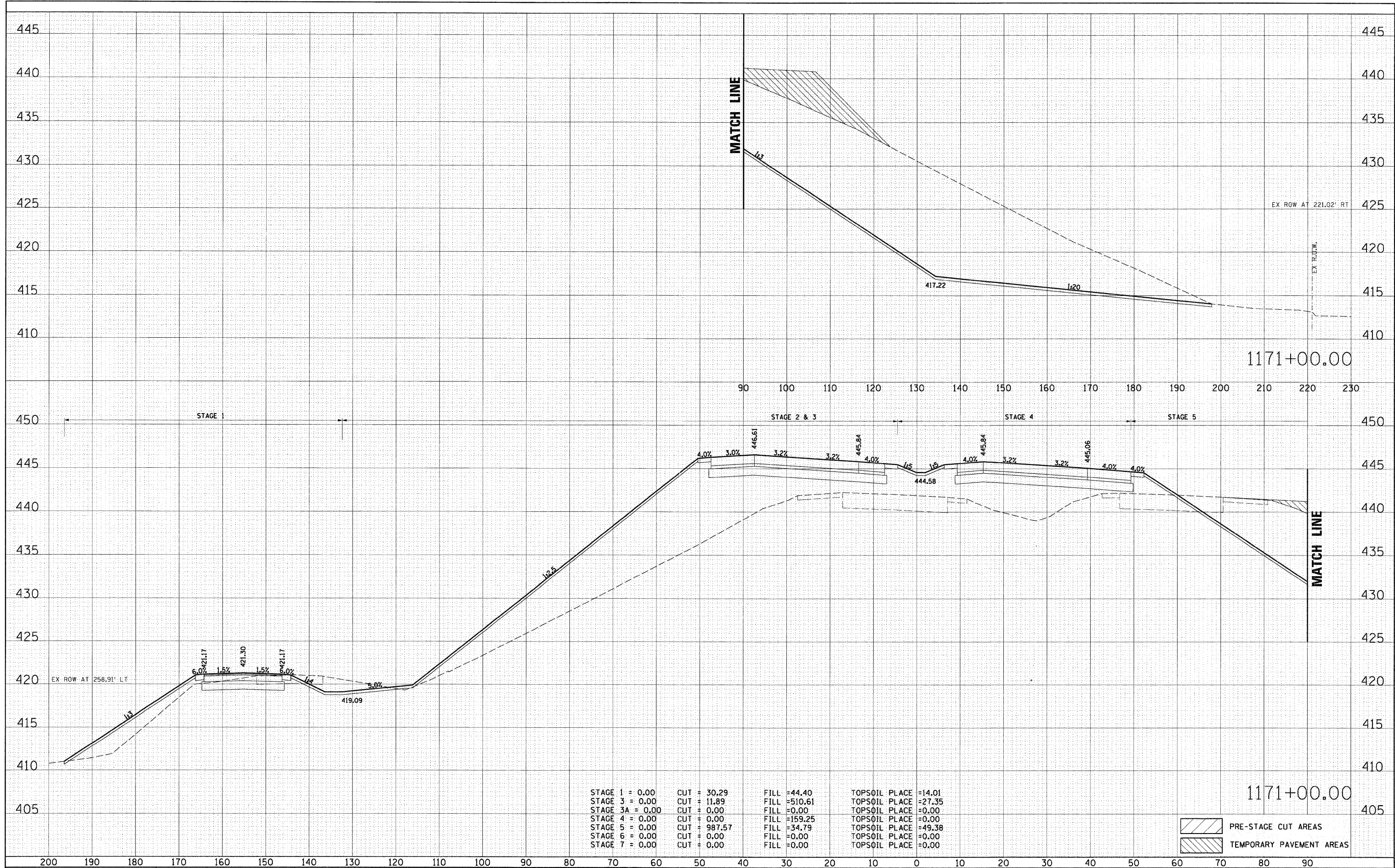
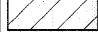
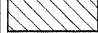

STAGE 1 = 0.00	CUT = 30.29	FILL = 44.40	TOPSOIL PLACE = 14.01
STAGE 3 = 0.00	CUT = 11.89	FILL = 510.61	TOPSOIL PLACE = 27.35
STAGE 3A = 0.00	CUT = 0.00	FILL = 0.00	TOPSOIL PLACE = 0.00
STAGE 4 = 0.00	CUT = 0.00	FILL = 159.25	TOPSOIL PLACE = 0.00
STAGE 5 = 0.00	CUT = 987.57	FILL = 34.79	TOPSOIL PLACE = 49.38
STAGE 6 = 0.00	CUT = 0.00	FILL = 0.00	TOPSOIL PLACE = 0.00
STAGE 7 = 0.00	CUT = 0.00	FILL = 0.00	TOPSOIL PLACE = 0.00

 PRE-STAGE CUT AREAS
 TEMPORARY PAVEMENT AREAS

FILE NAME = DB76D91-shl-ss-278.dgn

USER NAME = malopez
 DESIGNED *SJM*
 DRAWN *BAH*
 CHECKED -
 DATE -

REVISIONS
 REVISED -
 REVISED -
 REVISED -
 REVISED -

**STATE OF ILLINOIS
 DEPARTMENT OF TRANSPORTATION**

**CROSS SECTIONS
 INTERSTATE I-270**

SCALE: SHEET NO. OF SHEETS STA. 1171+00.00 TO STA. 1171+00.00

F.A.I. RTE. 270	SECTION 60-1B-1	COUNTY MADISON	TOTAL SHEETS 712	SHEET NO. 554
CONTRACT NO. 76A91			ILLINOIS FED. AID PROJECT	