

STATE OF ILLINOIS
 DEPARTMENT OF TRANSPORTATION
 DIVISION OF HIGHWAYS
**PROPOSED
 HIGHWAY PLANS**
 FAP ROUTE 600 (IL 159)
 SECTION (51, 132)RS-4
 PROJECT F-HSIP-0600(062)
**RESURFACING, SAFETY SHOULDERS, & RUMBLE STRIP
 MONROE & RANDOLPH COUNTY**

C-98-047-08

F.A.P. RTE.	SECTION	COUNTY	TOTAL SHEETS	SHEET NO.
600	(51,132)RS-4		23	1
ILLINOIS			76B79	

• MONROE, RANDOLPH

FOR INDEX OF SHEETS, SEE SHEET NO. 02

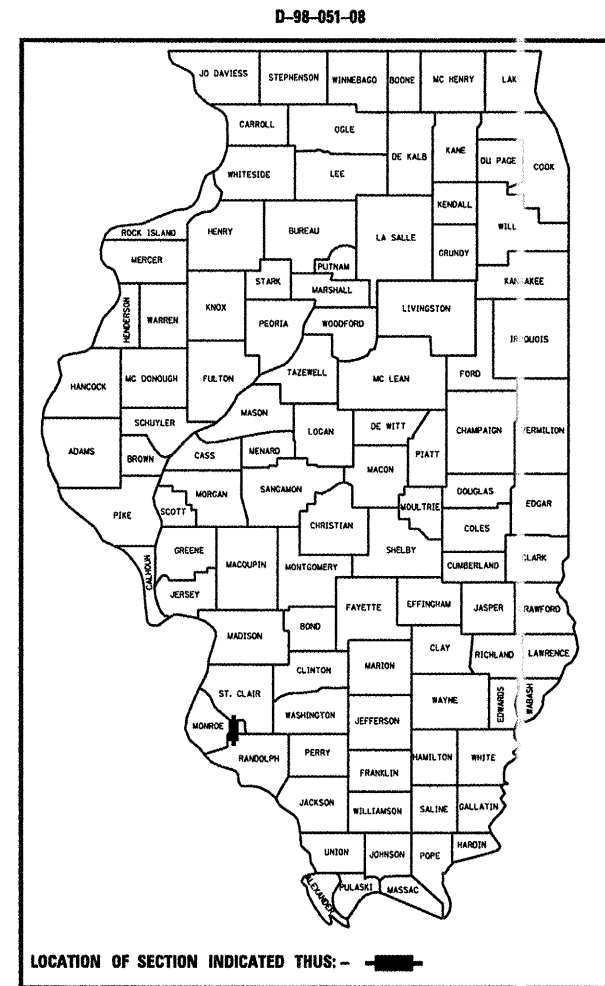

TRAFFIC DATA

ADT: 5800 (2009)
 5900 (2011)
 7200 (2031)
 SU: 4.3%
 MU: 2.7%

FUNCTIONAL CLASS

MINOR ARTERIAL

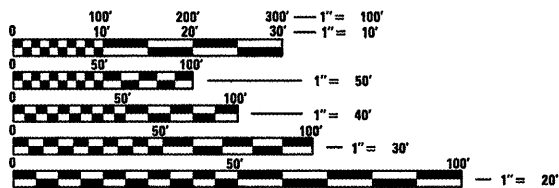

FULL SIZE PLANS HAVE BEEN PREPARED USING STANDARD ENGINEERING SCALES. REDUCED SIZED PLANS WILL NOT CONFORM TO STANDARD SCALES. IN MAKING MEASUREMENTS ON REDUCED PLANS, THE ABOVE SCALES MAY BE USED.

J.U.L.I.E.
 JOINT UTILITY LOCATION INFORMATION FOR EXCAVATION
 1-800-892-0123
 OR 811

PROJECT ENGINEER: TIM PADGETT (618)346-3325
 PROJECT MANAGER: JUAN LOPEZ (618)346-3194

CONTRACT NO. 76B79

END PROJECT
 M.S. 6.43
 LAT=38.3010
 LONG=-89.9944

S.N. 067-0007 OMIT
 M.S. 3.48-3.50

S.N. 067-0008
 M.S. 1.72-1.73

S.N. 079-0009
 M.S. 0.74-0.75

BEGIN PROJECT
 M.S. 0.00
 LAT=38.2117
 LONG=-89.9941

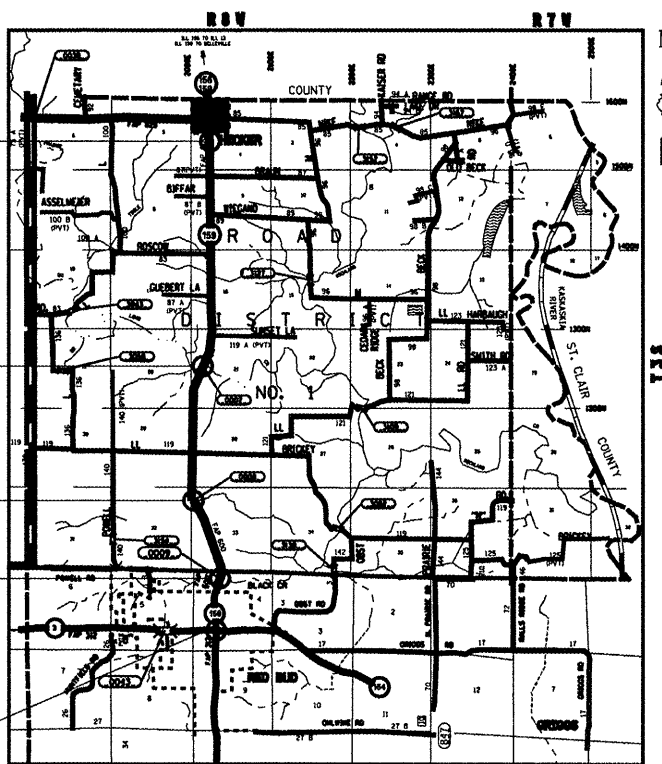

SCALE:
 1" = 2.25 MILES

GROSS LENGTH = 33950.4 FT. = 6.43 MILES
 OMISSIONS = 475.2 FT. = 0.09 MILES
 NET LENGTH = 33475.2 FT. = 6.34 MILES

STATE OF ILLINOIS
 DEPARTMENT OF TRANSPORTATION
 DIVISION OF HIGHWAYS

SUBMITTED 3/25 20 11
Mary C. Farnie
 DEPUTY DIRECTOR OF HIGHWAYS, REGION ENGINEER
May 13 20 11
Scott E. Stitt, P.E.
 acting ENGINEER OF DESIGN AND ENVIRONMENT
May 13 20 11
Christine M. Reed
 DIRECTOR OF HIGHWAYS, CHIEF ENGINEER

**PRINTED BY THE AUTHORITY
 OF THE STATE OF ILLINOIS**

INDEX OF SHEETS

- 1 COVER SHEET
- 2 INDEX OF SHEETS, HIGHWAY STANDARDS, GENERAL NOTES, COMMITMENTS
- 3 SUMMARY OF QUANTITIES
- 4-5 SCHEDULES OF QUANTITIES
- 6-16 TYPICAL SECTIONS
- 17-18 LOCATION MAPS
- 19-23 DETAILS

HIGHWAY STANDARDS

- 280001-05
- 420001-07
- 420701-02
- 442101-07
- 442201-03
- 630301-05
- 635006-03
- 642001-01
- 701001-02
- 701006-03
- 701011-02
- 701201-04
- 701301-04
- 701306-03
- 701311-03
- 701326-04
- 701336-06
- 701501-06
- 701901-01
- 780001-02
- 781001-03

GENERAL NOTES

1. THE STANDARDS AND REVISION NUMBERS LISTED SHALL APPLY TO THIS PROJECT.
2. IF ANY SECTION OR SUB-SECTION MONUMENTS ARE ENCOUNTERED, THE ENGINEER SHALL BE NOTIFIED BEFORE SUCH MONUMENTS ARE REMOVED OR RESURFACED OVER. THE CONTRACTOR SHALL PROTECT AND CAREFULLY PRESERVE ALL PROPERTY MARKERS AND MONUMENTS UNTIL THE OWNER, AN AUTHORIZED SURVEYOR, OR AGENT HAS WITNESSED OR OTHERWISE REFERENCED THEIR LOCATION.
3. ILLINOIS STATE LAW REQUIRES A 48-HOUR NOTICE TO BE GIVEN TO ALL UTILITIES BEFORE DIGGING. FIELD MARKING OF FACILITIES MAY BE OBTAINED BY CONTACTING J.U.L.I.E. OR FOR NON-MEMBERS, THE UTILITY COMPANY DIRECTLY. AGENCIES KNOWN TO HAVE FACILITIES WITHIN THE PROJECT AREA ARE AS FOLLOWS:

	ABOVE GROUND	BELOW GROUND
*AMEREN ILLINOIS, GAS & ELECTRIC	X	X
*CITY OF RED BUD, GAS & ELECTRIC	X	X
*MONROE COUNTY ELECTRIC CO-OPERATIVE, INC., ELECTRIC	X	X
*AT&T ILLINOIS, COMMUNICATIONS	X	X
*FRONTIER NORTH, INC., COMMUNICATIONS	X	X
*HARRISONVILLE TELEPHONE COMPANY, COMMUNICATIONS	X	X
*MEDIACOM, CABLE	X	X
*FHS WATER COMMISSION, WATER	X	X
*VILLAGE OF HECKER, WATER & SEWER	X	X
*CITY OF RED BUD, WATER & SEWER	X	X

MEMBERS OF J.U.L.I.E. (800)-892-0123 ARE INDICATED BY *. NON J.U.L.I.E. MEMBERS MUST BE NOTIFIED INDIVIDUALLY.
4. THE CONTRACTOR SHALL BE AWARE THAT THERE ARE MANHOLES & VALVES LOCATED WITHIN THE RESURFACING LIMITS. CARE SHALL BE TAKEN IN THESE LOCATIONS DURING MILLING OPERATIONS.
5. THE THICKNESS OF THE BITUMINOUS MIXTURE SHOWN ON THE PLANS IS THE NOMINAL THICKNESS. DEVIATIONS FROM THE NOMINAL THICKNESS WILL BE PERMITTED WHEN SUCH DEVIATIONS OCCUR DUE TO IRREGULARITIES IN THE EXISTING SURFACE OR BASE ON WHICH THE BITUMINOUS MIXTURE IS PLACED.

6. ANY EARTHWORK REQUIRED FOR HMA SHOULDER SHALL BE INCLUDED IN THE COST OF THE HMA SHOULDER.
7. ALL AREAS DISTURBED FOR ANY REASON SHALL BE PERMANENTLY SEEDED AS DIRECTED BY THE ENGINEER. ALL AREAS DISTURBED BY THE CONTRACTOR OUTSIDE THE PROPOSED CONSTRUCTION LIMITS SHALL BE SEEDED AT THE CONTRACTOR'S EXPENSE.
8. THE CONTRACTOR AND THE ENGINEER SHALL BE AWARE THAT NO SURVEY WAS PERFORMED FOR THIS PROJECT. THE STATIONING AND TOPO SHOWN IN THE PLANS WAS CREATED USING MICROFILM AND FIELD MEASUREMENTS MADE BY DESIGN PERSONNEL. BOTH SHALL BE ASSUMED TO BE APPROXIMATE.
9. STRAW BALES, HAY BALES, PERIMETER EROSION BARRIER, AND SILT FENCES WILL NOT BE PERMITTED FOR TEMPORARY OR PERMANENT DITCH CHECKS. DITCH CHECKS SHALL BE COMPOSED OF AGGREGATE, SILT PANELS, ROLLED EXCELSIOR, SILT WEDGES, OR ANY OTHER MATERIAL APPROVED BY THE ENGINEER.
10. EXCESS BITUMEN REMOVAL SHALL BE PAID FOR ACCORDING TO ARTICLE 109.04 OF THE STANDARD SPECIFICATIONS.
11. MIXTURES FOR JOINTS, CRACKS, AND FLANGWAYS SHALL BE PAID FOR ACCORDING TO ARTICLE 109.04 OF THE STANDARD SPECIFICATIONS.
12. THE USE OF VIBRATORY ROLLERS IS PROHIBITED IN RESIDENTIAL AREAS. THIS DOES NOT RELIEVE THE CONTRACTOR OF DENSITY REQUIREMENTS FOR THE BITUMINOUS PAVEMENTS AS SPECIFIED IN THE APPROPRIATE SECTIONS OF THE STANDARD SPECIFICATIONS.
13. THE THICKNESS OF BITUMINOUS SURFACE REMOVAL IS THE REMOVAL DEPTH AT THE CENTERLINE. THE REMOVAL DEPTH VARIES FROM 1/4" TO 2". AN ESTIMATED 4708 TONS OF BITUMINOUS SURFACE WILL BE REMOVED.
14. THE FOLLOWING MIXTURE REQUIREMENTS ARE APPLICABLE FOR THIS PROJECT:

ROUTE	FAP RTE. 600
SECTION	(51, 132)RS-4
COUNTY	MONROE, RANDOLPH
CONTRACT	76879

DESCRIPTION:	IL 159 FROM 0.2 MI S. OF JUANITA ST. IN HECKER TO IL 154, IL 159 FROM LL RD. TO RANDOLPH COUNTY LINE.
--------------	---

ADT (Construction Yr)	5900
MU%:	2.7
SU%:	4.3
20 YR. ESAL'S:	1.22

MIXTURE USE	SURFACE	LEVEL BINDER	PATCHING	INCIDENTAL SURFACE
AC/PG	PG 64-22	PG 64-22	PG 64-22	PG 64-22
RAP % (MAX)	SEE SPEC.	SEE SPEC.	SEE SPEC.	SEE SPEC.
DESIGN AIR VOIDS	4.0% @ Ndes=70	4.0% @ Ndes=70	4.0% @ Ndes=70	4.0% @ Ndes=70
MIX COMPOSITION				
(GRADATION MIXTURE)	IL 12.5/9.5	IL 9.5	IL 19.0	
FRICTION AGG	MIXTURE "D"	MIXTURE "C"	MIXTURE "B"	MIXTURE "C"

MIXTURE USE	SHOULDERS ≥ 2.25"	SHOULDERS < 2.25"
AC/PG	PG 64-22	PG 64-22
RAP % (MAX)	See Contract RAP Special Provision	See Contract RAP Special Provision
DESIGN AIR VOIDS	4.0% @ Ndes=70	4.0% @ Ndes=70
MIX COMPOSITION	**2.0% @ Ndes=30	**2.0% @ Ndes=30
(GRADATION MIXTURE)	NMAS 3/4"	NMAS 1/2"
FRICTION AGG		

15. SHORT-TERM PAVEMENT MARKING SHALL BE APPLIED TO THE MILLED, PRIMED, AND FINAL BITUMINOUS SURFACE. A QUANTITY FOR TEMPORARY PAVEMENT MARKING EQUAL TO THE AMOUNT OF PERMANENT PAVEMENT MARKING HAS BEEN ADDED TO THE PLANS.
16. REFER TO ARTICLE 107.20 & 107.25 OF THE STANDARD SPECIFICATIONS AND AS DIRECTED BY THE ENGINEER FOR RELOCATION OF ALL MAILBOXES, EXISTING STREET NAME SIGNS, AND ALL PRIVATE AND COMMERCIAL SIGNS.
17. ALL TEMPORARY PAVEMENT MARKINGS WILL BE PLACED IN SUCH A MANNER SO AS NOT TO INTERFERE WITH THE PLACEMENT OF PERMANENT PAVEMENT MARKINGS.

18. ALL PATCHING ON THIS PROJECT SHALL BE COMPLETED PRIOR TO BITUMINOUS SURFACE REMOVAL.
19. THE CONTRACTOR SHALL VERIFY ALL DIMENSIONS AND CONDITIONS IN THE FIELD PRIOR TO CONSTRUCTION AND ORDERING OF MATERIALS.
20. THE CONTRACTOR IS TO USE A FULL LANE WIDTH MILL (12 FT WIDE) DURING HMA SURFACE REMOVAL.
21. THE PAVEMENT MARKING SHOWN IN THE PLANS IS APPROXIMATE. THE LOCATION OF THE PROPOSED PAVEMENT MARKINGS SHOULD MATCH EXISTING FIELD CONDITIONS.
22. THE LOCATION STATIONS FOR GRADING AND SHAPING DITCHES ARE APPROXIMATE AND SHALL BE VERIFIED AND/OR DETERMINED BY THE ENGINEER.
23. THIS PROJECT REQUIRES THE CONTRACTOR TO SEAL AN ABANDONED WATER WELL. THIS WORK IS COVERED IN THE STANDARD SPECIFICATION FOR ROAD AND BRIDGE CONSTRUCTION AND IN THE SUPPLEMENTAL SPECIFICATIONS. IN ADDITION, THE CONTRACTOR SHALL REMOVE ANY BRICKWORK, CONCRETE MASONRY, PIPE, OR ANY OTHER UNSTABLE MATERIAL WITHIN THREE FEET OF FINAL GRADE. THE CONTRACTOR WILL BE REQUIRED FILL THE AREA WITH SUITABLE EMBANKMENT, SEED AND FERTILIZE AS APPROVED BY THE ENGINEER. NO ADDITIONAL COMPENSATION WILL BE GIVEN FOR THIS WORK AND SHALL BE INCLUDED IN THE PAY ITEM PRICE PER EACH FOR SEALING ABANDONED WATER WELLS.
24. NO OVERNIGHT LANE CLOSURES WILL BE ALLOWED.
25. EXCAVATION ADJACENT TO EDGE OF PAVEMENT SHALL BE PROTECTED WITH EXTENDED LEG BARRICADES WITH STEADY BURN LIGHTS.
26. ROAD CONSTRUCTION AHEAD SIGNS SHALL BE PLACED AT THE BEGINNING AND END OF THE PROJECT PLUS THE INTERSECTING SIDE ROADS, AND WILL BE INCLUDED IN THE TRAFFIC CONTROL PAY ITEMS. ALL CONSTRUCTION SIGNS SHALL BE (48X48) FLUORESCENT ORANGE.
27. FLAGMEN SHALL BE PRESENT DURING ALL CLOSURE HOURS, INCLUDING LUNCH HOUR, AND NO ADDITIONAL COMPENSATION SHALL BE APPLIED.

COMMITMENTS

STUDIES AND PLANS: COMMITMENT TO CITY OF RED BUD TO PATCH INTERSECTION OF IL 159, IL 154, AND IL 3.

FILE NAME =	USER NAME = *USER*	DESIGNED - ___	REVISED - ___	STATE OF ILLINOIS DEPARTMENT OF TRANSPORTATION	GENERAL NOTES	F.A.P. RTE.	SECTION	COUNTY	TOTAL SHEETS	SHEET NO.
*FILE#		DRAWN - ___	REVISED - ___			600	(51,132)RS-4	*	23	2
	PLOT SCALE = *SCALE*	CHECKED - ___	REVISED - ___			SCALE: _____ SHEET NO. ___ OF ___ SHEETS STA. _____ TO STA. _____		CONTRACT NO. 76879		
	PLOT DATE = *DATE*	DATE - _____	REVISED - ___			FED. ROAD DIST. NO. - [ILLINOIS] FED. AID PROJECT				

* MONROE, RANDOLPH

SUMMARY OF QUANTITIES

STP (L24E)
80% FED.
20% STATE

HSIP (LS3E)
90% FED.
10% STATE

SUMMARY OF QUANTITIES			CONSTRUCTION TYPE CODE			
CODE NO	ITEM	UNIT	TOTAL QUANTITIES	0005 80% FED. 20% STATE MONROE	0005 80% FED. 20% STATE RANDOLPH	0021 90% FED. 10% STATE MONROE
X4420670	CLASS B PATCHES, TYPE I, 9 INCH (SPECIAL)	SQ YD	60		60	
X4420672	CLASS B PATCHES, TYPE II, 9 INCH (SPECIAL)	SQ YD	107		107	
X4420674	CLASS B PATCHES, TYPE III, 9 INCH (SPECIAL)	SQ YD	19		19	
21400100	GRADING AND SHAPING DITCHES	FOOT	2957	2957		
28000305	TEMPORARY DITCH CHECKS	FOOT	120	120		
40600200	BITUMINOUS MATERIALS (PRIME COAT)	TON	27.5	24.45	3.09	
40600300	AGGREGATE (PRIME COAT)	TON	131	116.5	14.5	
40600635	LEVELING BINDER (MACHINE METHOD), N70	TON	3683	3269.3	413.7	
40600982	HOT-MIX ASPHALT SURFACE REMOVAL - BUTT JOINT	SQ YD	1070	1057	13	
40600990	TEMPORARY RAMP	SQ YD	290	272	18	
40603340	HOT-MIX ASPHALT SURFACE COURSE, MIX "D", N70	TON	7387	6555.43	831.57	
40800050	INCIDENTAL HOT-MIX ASPHALT SURFACING	TON	10	10		
44000153	HOT-MIX ASPHALT SURFACE REMOVAL, 1"	SQ YD	66739	60684	6055	
44000157	HOT-MIX ASPHALT SURFACE REMOVAL, 2"	SQ YD	22810	19008	3802	
44200180	PAVEMENT PATCHING, TYPE II, 15 INCH	SQ YD	227	213.67	13.33	
44200184	PAVEMENT PATCHING, TYPE III, 15 INCH	SQ YD	182	182		
44200186	PAVEMENT PATCHING, TYPE IV, 15 INCH	SQ YD	203	171	32	
44200956	CLASS B PATCHES, TYPE II, 9 INCH	SQ YD	41		41	
44200964	CLASS B PATCHES, TYPE IV, 9 INCH	SQ YD	81		81	
44201299	DOWEL BARS 1 1/2"	EACH	617		617	
44213100	PAVEMENT FABRIC	SQ YD	100		100	
44213200	SAW CUTS	FOOT	1488		1488	
44213204	TIE BARS 3/4"	EACH	25		25	
44213208	TIE BARS 1 1/4"	EACH	19		19	
48102100	AGGREGATE WEDGE SHOULDER, TYPE B	TON	1177	1091	86	
48203021	HOT-MIX ASPHALT SHOULDERS, 6"	SQ YD	5427			5427
63100169	TRAFFIC BARRIER TERMINAL, TYPE 1 (SPECIAL) FLARED	EACH	2	2		
63200310	GUARDRAIL REMOVAL	FOOT	100	100		
64200105	SHOULDER RUMBLE STRIPS	FOOT	16281			16281
67000400	ENGINEER'S FIELD OFFICE, TYPE A	CAL MO	4	2	2	
67100100	MOBILIZATION	L SUM	1	0.5	0.5	
67201000	SEALING ABANDONED WATER WELLS	EACH	1	1		

SUMMARY OF QUANTITIES				CONSTRUCTION TYPE CODE		
CODE NO	ITEM	UNIT	TOTAL QUANTITIES	0005 MONROE	0005 RANDOLPH	0021 MONROE
70100450	TRAFFIC CONTROL AND PROTECTION, STANDARD 701201	L SUM	1	0.5	0.5	
70100460	TRAFFIC CONTROL AND PROTECTION, STANDARD 701306	L SUM	1	0.5	0.5	
70100500	TRAFFIC CONTROL AND PROTECTION, STANDARD 701325	L SUM	1	0.5	0.5	
70100600	TRAFFIC CONTROL AND PROTECTION, STANDARD 701336	L SUM	1	0.5	0.5	
70102620	TRAFFIC CONTROL AND PROTECTION, STANDARD 701501	L SUM	1	0.5	0.5	
70300100	SHORT TERM PAVEMENT MARKING	FOOT	9187	8179	1008	
70300220	TEMPORARY PAVEMENT MARKING - LINE 4"	FOOT	103583	92943.8	10639.2	
70301000	WORK ZONE PAVEMENT MARKING REMOVAL	SQ FT	1021	909	112	
*78000200	THERMOPLASTIC PAVEMENT MARKING - LINE 4"	FOOT	91862	81222.8	10639.2	
*78001110	PAINT PAVEMENT MARKING - LINE 4"	FOOT	11722	11722		
*78100100	RAISED REFLECTIVE PAVEMENT MARKER	EACH	424	377	47	
*78201000	TERMINAL MARKER - DIRECT APPLIED	EACH	2	2		
78300200	RAISED REFLECTIVE PAVEMENT MARKER REMOVAL	EACH	424	377	47	
X0325866	CENTER LINE - RUMBLE STRIP	FOOT	8290			8290
Z0010910	COLD MILLING (SPECIAL)	SQ YD	5427			5427
+Z0076600	TRAINEES	HOUR	1,000	500	500	

*SPECIALTY ITEM + 0042

FILE NAME =	USER NAME = #USER#	DESIGNED - ----	REVISED - ----
#FILE#		DRAWN - ----	REVISED - ----
	PLOT SCALE = #SCALE#	CHECKED - ----	REVISED - ----
	PLOT DATE = #DATE#	DATE - ----	REVISED - ----

STATE OF ILLINOIS
DEPARTMENT OF TRANSPORTATION

SUMMARY OF QUANTITIES			
SCALE: -----	SHEET NO. OF ----- SHEETS	STA. -----	TO STA. -----

* MONROE, RANDOLPH	
F.A.P. RTE.	TOTAL SHEET NO.
600	23 3
SECTION COUNTY	CONTRACT NO.
151.132IRS-4	76879
FED. ROAD DIST. NO. ILLINOIS FED. AID PROJECT	

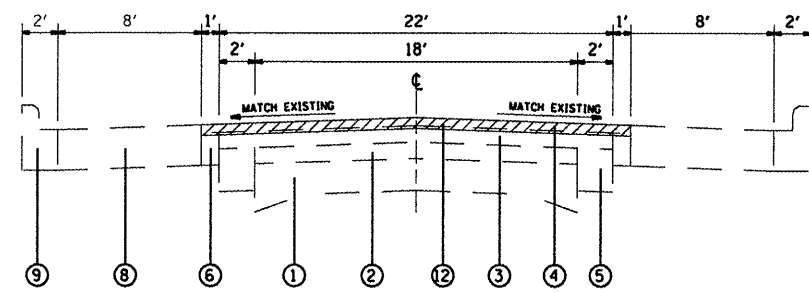

TANGENT SECTION
MILE STA. 0.05 TO 0.32

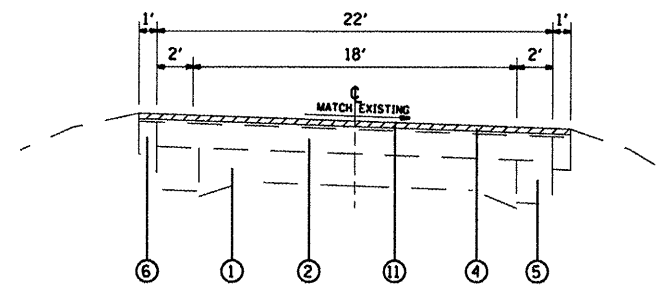

SUPER-ELEVATED SECTION

MILE STA. 0.32 TO 0.50 (RIGHT CURVE)
MILE STA. 0.72 TO 0.74 (LEFT CURVE)
MILE STA. 0.75 TO 0.89 (LEFT CURVE)
MILE STA. 1.25 TO 1.45 (LEFT CURVE)
MILE STA. 1.45 TO 1.70 (RIGHT CURVE)
MILE STA. 1.77 TO 2.00 (RIGHT CURVE)
MILE STA. 3.03 TO 3.33 (RIGHT CURVE)
MILE STA. 3.64 TO 4.06 (LEFT CURVE)

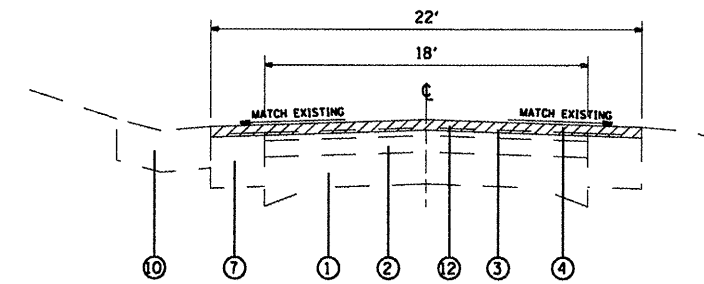

TANGENT SECTION
MILE STA. 3.33 TO 3.44
MILE STA. 3.54 TO 3.64

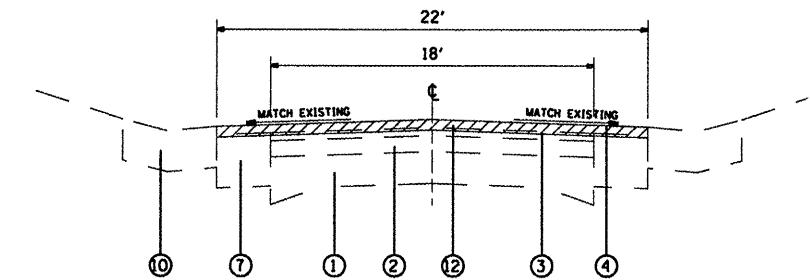

TANGENT SECTION
MILE STA. 4.54 TO 4.64
MILE STA. 4.73 TO 4.84

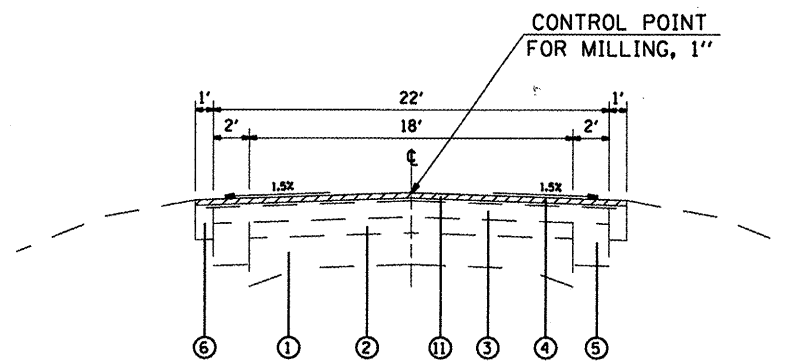

TANGENT SECTION

MILE STA. 0.50 TO 0.72
MILE STA. 0.89 TO 1.25
MILE STA. 1.70 TO 1.72
MILE STA. 1.73 TO 1.77
MILE STA. 2.00 TO 3.03
MILE STA. 3.44 TO 3.48
MILE STA. 3.50 TO 3.54
MILE STA. 4.06 TO 4.54
MILE STA. 4.64 TO 4.73
MILE STA. 4.84 TO 5.50

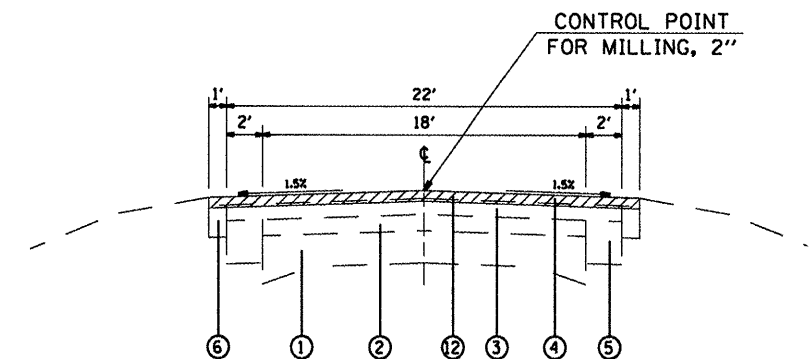

TANGENT SECTION
MILE STA. 5.50 TO 6.43

LEGEND

- ① EXISTING PCC PAVEMENT 9"-6"-9"
- ② EXISTING BITUMINOUS RESURFACING 3" (ESTIMATED FROM CORE SAMPLES COLLECTED)
- ③ EXISTING BITUMINOUS RESURFACING 3" (ESTIMATED FROM CORE SAMPLES COLLECTED)
- ④ EXISTING BITUMINOUS RESURFACING 1 1/2"
- ⑤ EXISTING WIDENING (THICKNESS VARIES)
- ⑥ EXISTING WIDENING 6" (MILLED SURFACE)
- ⑦ EXISTING WIDENING 10"
- ⑧ EXISTING PARKING LANES
- ⑨ EXISTING CONCRETE CURB AND GUTTER
- ⑩ EXISTING CONCRETE GUTTER, TYPE B
- ⑪ PROPOSED HMA SURFACE REMOVAL, 1"
- ⑫ PROPOSED HMA SURFACE REMOVAL, 2"
- ⑬ PROPOSED LEVEL BINDER, MACHINE METHOD, 3/4"
- ⑭ PROPOSED HMA SURFACE COURSE, MIX D, 1 1/2"
- ⑮ PROPOSED BITUMINOUS MATERIAL (PRIME COAT)
- ⑯ PROPOSED AGGREGATE PRIME COAT
- ⑰ PROPOSED AGGREGATE WEDGE, TYPE A
- ⑱ PROPOSED HMA SHOULDER, 6"
- ⑲ PROPOSED CENTERLINE RUMBLE STRIP
- ⑳ PROPOSED SHOULDER RUMBLE STRIP
- ㉑ PROPOSED THERMOPLASTIC PAVEMENT MARKING - LINE 4"

OMISSIONS

MILE STA. 0.74 TO 0.75
MILE STA. 1.72 TO 1.73
MILE STA. 3.48 TO 3.50

FILE NAME =	USER NAME = #USER#	DESIGNED -	REVISED -
#FILE#		DRAWN -	REVISED -
	PLOT SCALE = #SCALE#	CHECKED -	REVISED -
	PLOT DATE = #DATE#	DATE -	REVISED -

STATE OF ILLINOIS
DEPARTMENT OF TRANSPORTATION

EXISTING TYPICALS

SCALE: _____ SHEET NO. ____ OF ____ SHEETS STA. _____ TO STA. _____

* MD-10E, RANDOLPH		F.A.P. RTE.	SECTION	COUNTY	TOTAL SHEET NO.
600	(S1,132)RS-4	*		23	4
FED. ROAD DIST. NO. - ILLINOIS FED. AID PROJECT				CONTRACT NO. 76B79	

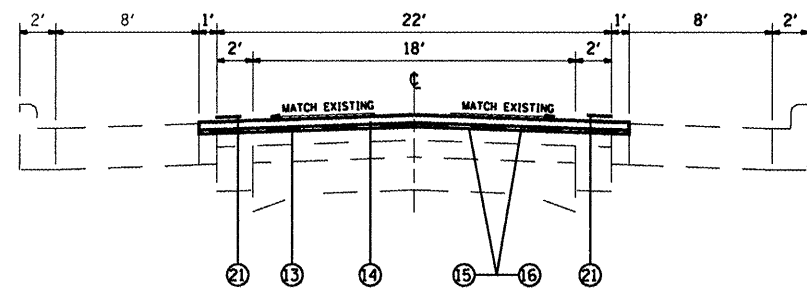

TANGENT SECTION
MILE STA. 0.05 TO 0.32

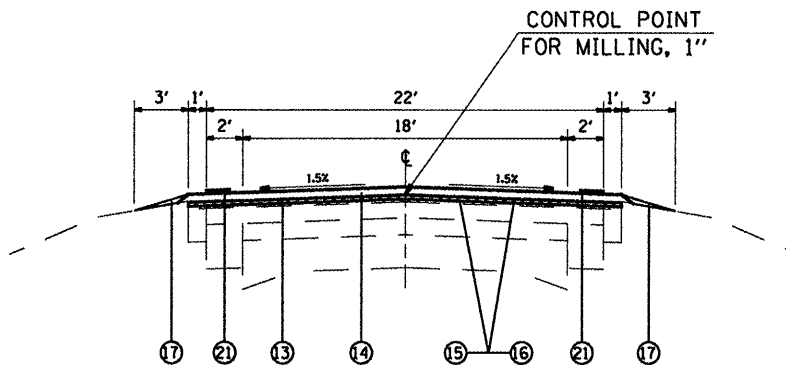

TANGENT SECTION
MILE STA. 0.50 TO 0.72
MILE STA. 2.33 TO 3.03
MILE STA. 3.44 TO 3.48
MILE STA. 3.50 TO 3.54
MILE STA. 4.06 TO 4.54
MILE STA. 4.64 TO 4.73
MILE STA. 4.84 TO 5.50

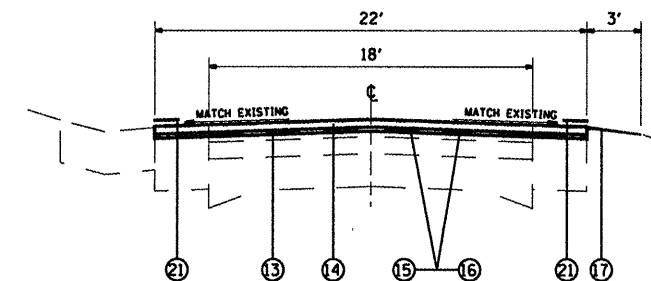

TANGENT SECTION
MILE STA. 3.33 TO 3.44
MILE STA. 3.54 TO 3.64

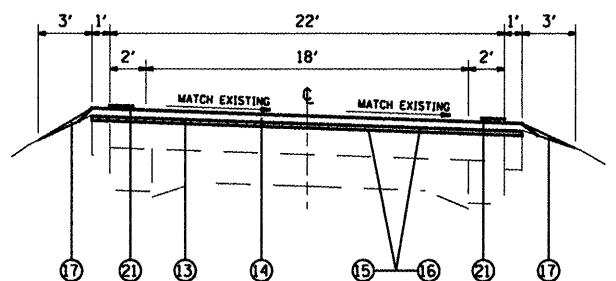

SUPER-ELEVATED SECTION
MILE STA. 0.32 TO 0.50 (RIGHT CURVE)
MILE STA. 0.72 TO 0.74 (RIGHT CURVE)
MILE STA. 3.03 TO 3.33 (RIGHT CURVE)
MILE STA. 3.64 TO 4.06 (RIGHT CURVE)

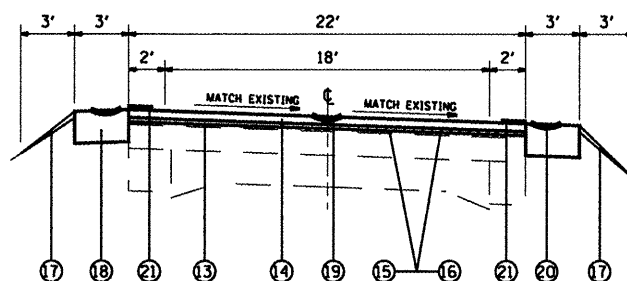

SUPER-ELEVATED SECTION
MILE STA. 0.75 TO 0.89 (RIGHT CURVE)
MILE STA. 1.25 TO 1.45 (LEFT CURVE)
MILE STA. 1.45 TO 1.70 (RIGHT CURVE)
MILE STA. 1.77 TO 2.00 (RIGHT CURVE)

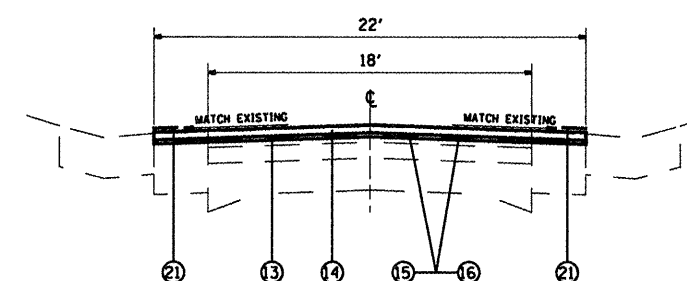

TANGENT SECTION
MILE STA. 4.54 TO 4.64
MILE STA. 4.73 TO 4.84

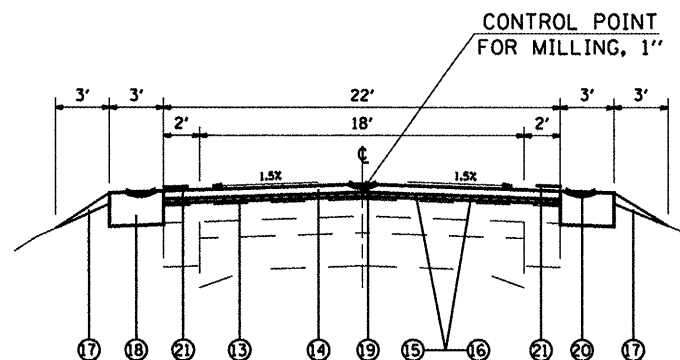

TANGENT SECTION
MILE STA. 0.89 TO 1.25
MILE STA. 1.70 TO 1.72
MILE STA. 1.73 TO 1.77
MILE STA. 2.00 TO 2.33

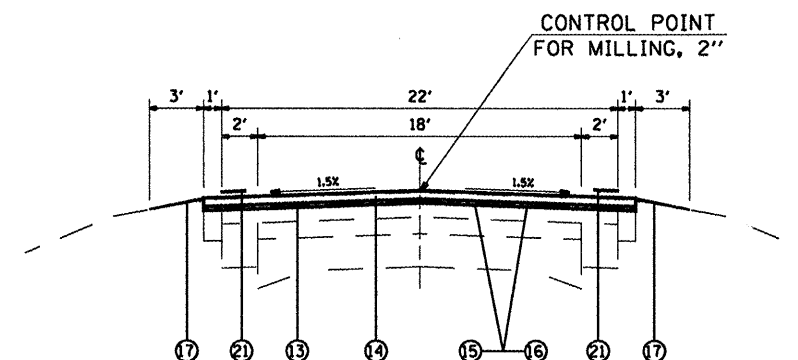

TANGENT SECTION
MILE STA. 5.50 TO 6.43

LEGEND

- ① EXISTING PCC PAVEMENT 9"-8"-9"
- ② EXISTING BITUMINOUS RESURFACING 3" (ESTIMATED FROM CORE SAMPLES COLLECTED)
- ③ EXISTING BITUMINOUS RESURFACING 3" (ESTIMATED FROM CORE SAMPLES COLLECTED)
- ④ EXISTING BITUMINOUS RESURFACING 1 1/2"
- ⑤ EXISTING WIDENING (THICKNESS VARIES)
- ⑥ EXISTING WIDENING 6" (MILLED SURFACE)
- ⑦ EXISTING WIDENING 10"
- ⑧ EXISTING PARKING LANES
- ⑨ EXISTING CONCRETE CURB AND GUTTER
- ⑩ EXISTING CONCRETE GUTTER, TYPE B
- ⑪ PROPOSED HMA SURFACE REMOVAL, 1"
- ⑫ PROPOSED HMA SURFACE REMOVAL, 2"
- ⑬ PROPOSED LEVEL BINDER, MACHINE METHOD, 3/4"
- ⑭ PROPOSED HMA SURFACE COURSE, MIX D, 1 1/2"
- ⑮ PROPOSED BITUMINOUS MATERIAL (PRIME COAT)
- ⑯ PROPOSED AGGREGATE PRIME COAT
- ⑰ PROPOSED AGGREGATE WEDGE, TYPE A
- ⑱ PROPOSED HMA SHOULDER, 6"
- ⑲ PROPOSED CENTERLINE RUMBLE STRIP
- ⑳ PROPOSED SHOULDER RUMBLE STRIP
- ㉑ PROPOSED THERMOPLASTIC PAVEMENT MARKING - LINE 4"

OMISSIONS

- MILE STA. 0.74 TO 0.75
- MILE STA. 1.72 TO 1.73
- MILE STA. 3.48 TO 3.50

FILE NAME =	USER NAME = #USER#	DESIGNED -	REVISD -
#FILE#		DRAWN -	REVISD -
	PLOT SCALE = #SCALE#	CHECKED -	REVISD -
	PLOT DATE = #DATE#	DATE -	REVISD -

STATE OF ILLINOIS
DEPARTMENT OF TRANSPORTATION

PROPOSED TYPICALS

SCALE: _____ SHEET NO. ___ OF ___ SHEETS STA. _____ TO STA. _____

* MONRIE, RANDOLPH			
F.A.P. RTE.	SECTION	COUNTY	TOTAL SHEETS
600	(51,132)RS-4		23
			5
FED. ROAD DIST. NO. _____ ILLINOIS FED. AID PROJECT			CONTRACT NO. 76879

SURFACE REMOVAL SCHEDULE				
LOCATION		HMA SURFACE REMOVAL, 1"	HMA SURFACE REMOVAL, 2"	
M.S.	TO M.S.	SQ YD	SQ YD	
0.05	0.32		3802	
0.32	0.50	2534		
0.50	0.72	3098		
0.72	0.74	282		
0.74	0.75	141		
0.75	0.89	1971		
0.89	1.25	5069		
1.25	1.45	2816		
1.45	1.70	3520		
1.70	1.72	282		
1.72	1.73	141		
1.73	1.77	563		
1.77	2.00	3238		
2.00	3.03	14502		
3.03	3.33	4224		
3.33	3.44		1549	
3.44	3.48	563		
3.48	3.50	BRIDGE OMISSION		
3.50	3.54	563		
3.54	3.64		1408	
3.64	4.06	5914		
4.06	4.54	6758		
4.54	4.64		1408	
4.64	4.73	1267		
4.73	4.84		1549	
4.84	5.50	9293		
5.50	6.43		13094	
TOTAL		66739	22810	

RESURFACING SCHEDULE					
LOCATION		BITUMINOUS MATERIALS (PRIME COAT)	AGGREGATE (PRIME COAT)	LEVELING BINDER, N70, 3/4"	HMA SURFACE COURSE MIX D, 1/2"
M.S.	TO M.S.	TON	TON	TON	TON
0.05	0.32	1.19	5.7	159.7	319.3
0.32	0.50	0.79	3.8	106.4	212.9
0.50	0.72	0.97	4.6	130.1	260.2
0.72	0.74	0.09	0.4	11.8	23.7
0.74	0.75	0.05	0.2	5.7	12.0
0.75	0.89	0.57	2.7	75.9	151.8
0.89	1.25	1.45	7.0	195.1	390.3
1.25	1.45	0.81	3.9	108.4	216.8
1.45	1.70	1.01	4.8	135.5	271.0
1.70	1.72	0.08	0.4	10.8	21.7
1.72	1.73	0.05	0.2	5.3	11.0
1.73	1.77	0.16	0.8	21.7	43.4
1.77	2.00	0.93	4.5	124.7	249.4
2.00	2.33	1.33	6.4	178.9	357.8
2.33	3.03	3.08	14.8	414.0	827.9
3.03	3.33	1.32	6.3	177.4	354.8
3.33	3.44	0.48	2.3	65.1	130.2
3.44	3.48	0.19	0.8	23.7	47.3
3.48	3.50	BRIDGE OMISSION			
3.50	3.54	0.19	0.8	23.7	47.3
3.54	3.64	0.45	2.1	59.1	118.3
3.64	4.06	1.85	8.9	248.4	496.7
4.06	4.54	2.11	10.1	283.9	567.7
4.54	4.64	0.45	2.1	59.1	118.3
4.64	4.73	0.40	1.9	53.2	106.4
4.73	4.84	0.48	2.3	65.1	130.2
4.84	5.50	2.91	13.9	390.3	780.6
5.50	6.43	4.10	19.5	550.0	1100.0
TOTAL		27.5	131	3683	7367

FILE NAME =	USER NAME = *USER*	DESIGNED - ---	REVISED - ---	STATE OF ILLINOIS DEPARTMENT OF TRANSPORTATION	SURFACE REMOVAL & RESURFACING SCHEDULES	F.A.P. RTE.	SECTION	COUNTY	TOTAL SHEETS	SHEET NO.
FILE#	PLOT SCALE = *SCALE*	DRAWN - ---	REVISED - ---			600	(51.132)RS-4	*	23	6
	PLOT DATE = *DATE*	CHECKED - ---	REVISED - ---			SCALE: _____ SHEET NO. ___ OF ___ SHEETS STA. _____ TO STA. _____		CONTRACT NO. 76879		
* MONROE, RANDOLPH FED. ROAD DIST. NO. - ILLINOIS FED. AID PROJECT										

SHOULDERS SCHEDULE									
LOCATION		WIDTH	OFFSET	HMA SHOULDERS, 6"	AGGREGATE WEDGE	SHOULDER RUMBLE STRIP	CENTER LINE-RUMBLE STRIP		
M.S.	TO M.S.	FOOT	RT/LF	SQ YD	TONS	FOOT	FOOT		
0.05	0.32	NO SHOULDER WEDGE							
0.32	0.74	3	RT/LF		86				
0.74	0.75	BRIDGE OMISSION							
0.75	1.72	3	RT/LF	3339	198	10017	5122		
1.72	1.73	BRIDGE OMISSION							
1.73	2.33	3	RT/LF	2088	124	6264	3168		
2.33	3.33	3	RT/LF		204				
3.33	3.44	3	RT		11				
3.44	3.48	3	RT/LF		8				
3.48	3.5	BRIDGE OMISSION							
3.50	3.54	3	RT/LF		8				
3.54	3.64	3	RT		10				
3.64	4.54	3	RT/LF		185				
4.54	4.64	NO SHOULDER WEDGE							
4.64	4.73	3	RT/LF		19				
4.73	4.84	NO SHOULDER WEDGE							
4.84	6.43	3	RT/LF		324				
TOTAL				5427	1177	16281	8290		

FILE NAME :	USER NAME : *USER*	DESIGNED -	REVISD -	STATE OF ILLINOIS DEPARTMENT OF TRANSPORTATION	SHOULDER SCHEDULE	F.A.P. RTE.	SECTION	COUNTY	TOTAL SHEETS	SHEET NO.
FILEL	PLOT SCALE = *SCALE*	DRAWN -	REVISD -			600	(51,132)RS-4	*	23	7
	PLOT DATE = *DATE*	CHECKED -	REVISD -			SCALE: _____ SHEET NO. ___ OF ___ SHEETS STA. _____ TO STA. _____		CONTRACT NO. 76879		
		DATE -	REVISD -			FED. ROAD DIST. NO. - [ILLINOIS] FED. AID PROJECT				

* MONRIE, RANDOLPH

PAVEMENT PATCHING SCHEDULE										
LOCATION	NORTHBOUND LANE					SOUTHBOUND LANE				
	SIZE		PAVEMENT PATCHING 15"			SIZE		PAVEMENT PATCHING 15"		
	LENGTH	WIDTH	TYPE II	TYPE III	TYPE IV	LENGTH	WIDTH	TYPE II	TYPE III	TYPE IV
MILE STATION	FOOT	FOOT	SQ YD	SQ YD	SQ YD	FOOT	FOOT	SQ YD	SQ YD	SQ YD
0.5	20	12			26.67					
0.7						25	4	11.11		
0.8	6	12	8.00							
1.5						200	3			66.67
2.1	8	12	10.67			15	12		20.00	
2.2						12	12		16.00	
2.32	10	12	13.33							
2.4	10	12	13.33							
2.6						15	4	6.67		
3						15	12		20.00	
3.4	15	5	8.33							
3.5	6	12	8.00			50	4		22.22	
3.7	6	12	8.00			6	12	8.00		
3.9	15	12		20.00						
4.13						10	12	13.33		
4.18	6	12	8.00			6	12	8.00		
4.3	6	12	8.00							
4.4						6	12	8.00		
4.55	80	4			35.56					
4.6	10	12	13.33							
4.61						10	12	13.33		
4.9	30	12			40.00					
5.5	12	12		16.00		12	12		16.00	
5.6	16	12		21.33						
5.8						6	12	8.00		
6.0	10	12	13.33							
SUBTOTAL			112.33	57.33	102.22			76.44	94.22	66.67
ANTICIPATED FAILURE (20%)			22.71	11.54	20.62			15.52	18.91	13.49
TOTAL			135.04	68.87	122.84			91.96	113.13	80.16

TOTAL QTY TYPE II	227.00
-------------------	--------

TOTAL QTY TYPE III	182.00
--------------------	--------

TOTAL QTY TYPE IV	203.00
-------------------	--------

FILE NAME =	USER NAME = #USER#	DESIGNED - ---	REVISED - ---	STATE OF ILLINOIS DEPARTMENT OF TRANSPORTATION	PATCHING SCHEDULE	F.A.P. RTE.	SECTION	COUNTY	TOTAL SHEETS	SHEET NO.	
#FILE#		DRAWN - ---	REVISED - ---			600	(51,132)RS-4	*	23	8	
	PLOT SCALE = #SCALE#	CHECKED - ---	REVISED - ---			SCALE: ----- SHEET NO. ___ OF ___ SHEETS STA. ----- TO STA. -----		FED. ROAD DIST. NO. ILLINOIS FED. AID PROJECT			
	PLOT DATE = #DATE#	DATE - -----	REVISED - ---					CONTRACT NO. 76879			

* MONROE, RANDOLPH

CLASS B PATCHING 9 INCH SCHEDULE

LOCATION	LANE	LENGTH	LANE WIDTH	CLASS B PATCH TYPE I	CLASS B PATCH TYPE II	CLASS B PATCH TYPE III	CLASS B PATCH TYPE IV	DOWEL BARS 1 1/2"	TIE BARS	PAVEMENT FABRIC	SAWCUT
		FT	FT	SQ YD	SQ YD	SQ YD	SQ YD	EACH	EACH	SQ YD	FT
IL Rte. 154 EAST LEG											
	+	EASTBOUND	6.0	12.0	8.0			20			48.0
	+	WESTBOUND	8.0	12.0	10.7			20			52.0
	+	WESTBOUND	6.0	12.0	8.0			20			48.0
	+	WESTBOUND	7.0	12.0	9.3			20			50.0
IL Rte. 3 WEST LEG											
	+	WESTBOUND	34.0	12.0			45.3	20	16	45.3	104.0
IL Rte. 159 NORTH LEG											
	+	NORTHBOUND	19.0	12.0			25.3	20		25.3	74.0
SUBTOTAL:					36.0		70.7	120	16	70.7	376.0
ANTICIPATED FAILURES (15%):					5.4		10.6	18	3	10.6	56.4
TOTAL:					41		81	138	19	81	432

FILE NAME =	USER NAME = #USER#	DESIGNED -	REVISED -	STATE OF ILLINOIS DEPARTMENT OF TRANSPORTATION	CLASS B PATCHING SCHEDULE	F.A.P. RTE.	SECTION	COUNTY	TOTAL SHEETS	SHEET NO.
#FILE#		DRAWN -	REVISED -			600	(51.132)RS-4	*	25	9
		CHECKED -	REVISED -			SCALE: _____ SHEET NO. _____ OF _____ SHEETS STA. _____ TO STA. _____		CONTRACT NO. 76B79		
		DATE -	REVISED -			FED. ROAD DIST. NO. _____ ILLINOIS FED. AID PROJECT				

* MONROE, RANDOLPH

CLASS B PATCHING 9 INCH (SPECIAL) SCHEDULE

LOCATION	LANE	LENGTH	LANE WIDTH	CLASS B PATCH TYPE I	CLASS B PATCH TYPE II	CLASS B PATCH TYPE III	CLASS B PATCH TYPE IV	DOWEL BARS 1 1/2"	TIE BARS	PAVEMENT FABRIC	SAWCUT
		FT	FT	SQ YD	SQ YD	SQ YD	SQ YD	EACH	EACH	SQ YD	FT
IL Rte. 154 EAST LEG											
	+	EASTBOUND	6.0	6.0	4.0			10			30.0
	+	EASTBOUND	12.0	6.0		8.0		20			42.0
	+	EASTBOUND	6.0	6.0	4.0			10			30.0
	+	EASTBOUND	6.0	6.0	4.0			10			30.0
	+	EASTBOUND	6.0	6.0	4.0			10			30.0
	+	EASTBOUND	15.0	6.0		10.0		26			48.0
	+	EASTBOUND	6.0	6.0	4.0			10			30.0
	+	EASTBOUND	12.0	6.0		8.0		20			42.0
MIDDLE OF INTERSECTION											
	+		6.0	6.0	4.0			10			30.0
	+		19.0	6.0		12.7		34			56.0
	+		6.0	6.0	4.0			10			30.0
	+		20.0	6.0		13.3		36	9		58.0
SUBTOTAL:				28.0	52.0			206	9		456.0
ANTICIPATED FAILURES (15%):				4.2	7.8			31	2		68.4

FILE NAME =	USER NAME = #USER#	DESIGNED - ---	REVISED - ---	STATE OF ILLINOIS DEPARTMENT OF TRANSPORTATION	CLASS B PATCHING (SPECIAL) SCHEDULE	F.A.P. RTE.	SECTION	COUNTY	TOTAL SHEETS	SHEET NO.	
#FILE#		DRAWN - ---	REVISED - ---			600	(51,132)RS-4	*	23	10	
	PLOT SCALE = #SCALE#	CHECKED - ---	REVISED - ---			SCALE: _____ SHEET NO. ___ OF ___ SHEETS STA. _____ TO STA. _____		FED. ROAD DIST. NO. _____ ILLINOIS FED. AID PROJECT			
	PLOT DATE = #DATE#	DATE - -----	REVISED - ---			* MONROE, RANDOLPH CONTRACT NO. 76879					

CLASS B PATCHING 9 INCH (SPECIAL) SCHEDULE

LOCATION	LANE	LENGTH	LANE WIDTH	CLASS B PATCH TYPE I	CLASS B PATCH TYPE II	CLASS B PATCH TYPE III	CLASS B PATCH TYPE IV	DOWEL BARS 1/2"	TIE BARS	PAVEMENT FABRIC	SAWCUT
		FT	FT	SQ YD	SQ YD	SQ YD	SQ YD	EACH	EACH	SQ YD	FT
IL Rte. 159 NORTH LEG											
	+		NORTHBOUND	6.0	6.0	4.0		10			30.0
	+		NORTHBOUND	6.0	6.0	4.0		10			30.0
	+		SOUTHBOUND	6.0	6.0	4.0		10			30.0
	+		SOUTHBOUND	25.0	6.0		16.7	46	12	16.7	68.0
	+		SOUTHBOUND	6.0	6.0	4.0		10			30.0
	+		SOUTHBOUND	9.0	6.0		6.0	14			36.0
	+		SOUTHBOUND	6.0	6.0	4.0		10			30.0
IL Rte. 3 SOUTH LEG											
	+		NORTHBOUND	17.0	6.0		11.3	30			52.0
	+		NORTHBOUND	15.0	6.0		10.0	26			48.0
	+		NORTHBOUND	8.0	6.0		5.3	12			34.0
	+		SOUTHBOUND	13.0	6.0		8.7	22			44.0
	+		SOUTHBOUND	6.0	6.0	4.0		10			30.0
SUBTOTAL:				24.0	41.3	16.7		210	12	16.7	462.0
ANTICIPATED FAILURES (15%):				3.6	6.2	2.5		32	2	2.5	69.3
TOTAL:				60	107	19		479	25	19	1056

FILE NAME =	USER NAME = *USER*	DESIGNED - ---	REVISED - ---	STATE OF ILLINOIS DEPARTMENT OF TRANSPORTATION	CLASS B PATCHING (SPECIAL) SCHEDULE	F.A.P. RTE.	SECTION	COUNTY	TOTAL SHEETS	SHEET NO.
FILE#	PLOT SCALE = *SCALE*	DRAWN - ---	REVISED - ---			600	(51,132)RS-4	*	23	11
	PLOT DATE = *DATE*	CHECKED - ---	REVISED - ---			SCALE: _____ SHEET NO. ___ OF ___ SHEETS STA. _____ TO STA. _____		FED. ROAD DIST. NO. _____ ILLINOIS FED. AID PROJECT		CONTRACT NO. 76B79

* MONR. E. RANDOLPH

SIDE ROAD SCHEDULE

LOCATION	OFFSET	ROAD NAME	EXISTING SURFACE	WIDTH	LENGTH	INCIDENTAL HOT-MIX ASPHALT SURFACING
MILE STA.	RT/LT			FOOT	FOOT	TON
0.070	RT	E RED BUD ST	BITUMINOUS	18.9		
0.070	LT	W RED BUD ST	BITUMINOUS	30.2		
0.103	RT	E OLIVE ST	BITUMINOUS	38.7		
0.103	LT	W OLIVE ST	BITUMINOUS	43.1		
0.171	RT	E PINE ST	BITUMINOUS	32.8		
0.171	LT	W PINE ST	BITUMINOUS	37.7		
0.237	RT	MILL ST	BITUMINOUS	39.6		
0.237	LT	RANDOLPH ST	BITUMINOUS	38.2		
0.312	LT	RAILROAD ST	BITUMINOUS	35.3		
2.331	RT	LL RD	BITUMINOUS	58.6	7.5	1.70
2.332	LT	LL RD	BITUMINOUS	60.1	7.5	1.70
3.868	RT	SUNSET LN	BITUMINOUS	67.1	7.5	1.90
4.366	LT	7963 GUEBERT DR	BITUMINOUS	41.5	7.5	1.10
4.869	LT	ROSCOW RD	BITUMINOUS	65.6	7.5	1.90
5.361	RT	WIEGAND RD	BITUMINOUS	49.6	7.5	1.40
5.610	LT	BIFFAR DR	BITUMINOUS	39.3	3.5	0.10
5.851	RT	BRAUN RD	BITUMINOUS	46.4	3.5	0.10
5.850	LT	BRAUN RD	BITUMINOUS	37.8	3.5	0.10
TOTAL						10.00

FILE NAME = #FILE#	USER NAME = #USER#	DESIGNED - ---	REVISED - ---	STATE OF ILLINOIS DEPARTMENT OF TRANSPORTATION	SIDE ROAD SCHEDULE	F.A.P. RTE. 600	SECTION (51.132)RS-4	COUNTY •	TOTAL SHEETS 23	SHEET NO. 12		
	PLOT SCALE = #SCALE#	CHECKED - ---	REVISED - ---			SCALE: -----	SHEET NO. .. OF ... SHEETS	STA. -----	TO STA. -----	CONTRACT NO. 76B79		
	PLOT DATE = #DATE#	DATE - -----	REVISED - ---			FED. ROAD DIST. NO. (ILLINOIS) FED. AID PROJECT						

* MONROE, RANDOLPH

ENTRANCE SCHEDULE						
LOCATION	OFFSET	TYPE	EXISTING SURFACE	WIDTH	LENGTH	HMA SURFACE COURSE MIX D. 1/2"
MILE STA.	RT/LT			FOOT	FOOT	TON
0.370	RT	COMMERCIAL	BIT	25	3	0.37
0.386	LT	COMMERCIAL	BIT	25	3	0.37
0.401	RT	PRIVATE	BIT	18	3	0.25
0.412	LT	COMMERCIAL	BIT	25	3	0.37
0.419	RT	PRIVATE	BIT	18	3	0.25
0.441	LT	COMMERCIAL	BIT	25	3	0.37
0.460	LT	PRIVATE	BIT	18	3	0.25
0.469	RT	COMMERCIAL	BIT	25	3	0.37
0.484	RT	PRIVATE	BIT	18	3	0.25
0.489	LT	COMMERCIAL	BIT	25	3	0.37
0.572	RT	PRIVATE	BIT	18	3	0.25
0.857	LT	COMMERCIAL	BIT	25	3	0.37
0.878	LT	COMMERCIAL	BIT	25	3	0.37
0.898	LT	PRIVATE	BIT	18	3	0.25
1.081	LT	COMMERCIAL	BIT	25	3	0.37
1.140	LT	COMMERCIAL	BIT	25	3	0.37
1.333	RT	PRIVATE	BIT	18	3	0.25
1.336	LT	PRIVATE	BIT	18	3	0.25
1.489	RT	PRIVATE	BIT	18	3	0.25
1.620	LT	PRIVATE	BIT	18	3	0.25
1.625	LT	PRIVATE	BIT	18	3	0.25
1.729	LT	PRIVATE	BIT	18	3	0.25
1.758	LT	PRIVATE	BIT	18	3	0.25
1.856	LT	PRIVATE	BIT	18	3	0.25
2.116	LT	PRIVATE	BIT	18	3	0.25
2.183	RT	PRIVATE	BIT	18	3	0.25
2.482	LT	PRIVATE	BIT	18	3	0.25
2.679	RT	PRIVATE	BIT	18	3	0.25
2.886	LT	PRIVATE	BIT	18	3	0.25
2.889	RT	PRIVATE	BIT	18	3	0.25
2.921	RT	PRIVATE	BIT	18	3	0.25
3.003	RT	PRIVATE	BIT	18	3	0.25
3.103	LT	PRIVATE	BIT	18	3	0.25
3.106	RT	PRIVATE	BIT	18	3	0.25
3.175	LT	PRIVATE	BIT	18	3	0.25
3.197	LT	PRIVATE	BIT	18	3	0.25
3.213	LT	PRIVATE	BIT	18	3	0.25
SUBTOTAL						10.45

ENTRANCE SCHEDULE						
LOCATION	OFFSET	TYPE	EXISTING SURFACE	WIDTH	LENGTH	HMA SURFACE COURSE MIX D. 1/2"
MILE STA.	RT			FOOT	FOOT	TON
3.242	LT	PRIVATE	BIT	18	3	0.25
3.269	RT	PRIVATE	BIT	18	3	0.25
3.324	RT	COMMERCIAL	BIT	25	3	0.36
3.543	LT	PRIVATE	BIT	18	3	0.25
3.597	RT	PRIVATE	BIT	18	3	0.25
3.632	RT	PRIVATE	BIT	18	3	0.25
3.648	LT	PRIVATE	BIT	18	3	0.25
3.657	RT	PRIVATE	BIT	18	3	0.25
3.723	RT	PRIVATE	BIT	18	3	0.25
3.790	RT	PRIVATE	BIT	18	3	0.25
3.870	LT	PRIVATE	BIT	18	3	0.25
4.287	LT	PRIVATE	BIT	18	3	0.25
4.414	RT	PRIVATE	BIT	18	3	0.25
4.452	LT	COMMERCIAL	BIT	25	3	0.36
4.859	RT	PRIVATE	BIT	18	3	0.25
4.861	LT	PRIVATE	BIT	18	3	0.25
4.873	LT	PRIVATE	BIT	18	3	0.25
4.921	RT	PRIVATE	BIT	18	3	0.25
5.142	RT	PRIVATE	BIT	18	3	0.25
5.159	RT	PRIVATE	BIT	18	3	0.25
5.251	LT	PRIVATE	BIT	18	3	0.25
5.281	LT	PRIVATE	BIT	18	3	0.25
5.311	LT	PRIVATE	BIT	18	3	0.25
5.415	LT	PRIVATE	BIT	18	3	0.25
5.586	LT	PRIVATE	BIT	18	3	0.25
5.638	RT	PRIVATE	BIT	18	3	0.25
5.652	RT	PRIVATE	BIT	18	3	0.25
5.677	LT	PRIVATE	BIT	18	3	0.25
5.872	RT	PRIVATE	BIT	18	3	0.25
5.990	RT	PRIVATE	BIT	18	3	0.25
6.140	LT	PRIVATE	BIT	18	3	0.25
6.153	RT	COMMERCIAL	BIT	25	3	0.36
6.163	LT	PRIVATE	BIT	18	3	0.25
6.175	RT	COMMERCIAL	BIT	25	3	0.36
6.195	RT	COMMERCIAL	BIT	25	3	0.36
6.224	LT	PRIVATE	BIT	18	3	0.25
SUBTOTAL						9.55
TOTAL						20.00

PAVEMENT MARKING SCHEDULE

LOCATION	THERMOPLASTIC PAVEMENT MARKING - LINE 4"				PAINT PAVEMENT MARKING - LINE 4"			RAISED REFLECTIVE PAVEMENT MARKER REMOVAL	REISED REFLECTIVE PAVEMENT MARKERS
	SOLID WHITE EDGE LINE	SKIP DASH (YELLOW)	NO PASSING ZONE (SOLID YELLOW)	SOLID LINE (YELLOW)	SKIP DASH (YELLOW)	NO PASSING ZONE (SOLID YELLOW)	SOLID LINE (YELLOW)		
M.S. TO M.S	FOOT	FOOT	NB or SB	FOOT	FOOT	NB or SB	FOOT	EACH	EACH
0.05	0.24	2006.4	250					13	13
0.24	0.30	633.6	80	NB	316.8			4	4
0.30	0.37	739.2	90					5	5
0.37	0.61	2534.4	320	SB	1267.2			16	16
0.61	0.75	1478.4	190	NB	739.2			9	9
0.75	0.88	1372.8				NB/SB	1372.8	9	9
0.88	1.05	1795.2			220	SB	897.6	11	11
1.05	1.21	1689.6			210			11	11
1.21	1.44	2428.8			300	NB	1214.4	15	15
1.44	1.90	4857.6				NB/SB	4857.7	30	30
1.90	2.14	2534.4			320	SB	1267.2	16	16
2.14	2.19	528.0			70			3	3
2.19	2.34	1584.0			200	NB	792.3	10	10
2.34	2.52	1900.8	240	SB	950.4			12	12
2.52	3.03	5385.6	670					34	34
3.03	3.21	1900.8	240	NB	950.4			12	12
3.21	3.26	528.0		NB/SB	528.0			3	3
3.26	3.51	2640.0	330	SB	1320.0			17	17
3.51	3.73	2323.2	290	NB	1161.6			15	15
3.73	3.99	2745.6		NB/SB	2745.6			17	17
3.99	4.23	2534.4	320	SB	1267.2			16	16
4.23	4.44	2217.6	280	NB	1108.8			14	14
4.44	4.80	3801.6		NB/SB	3801.6			24	24
4.80	5.04	2534.4	320	SB	1267.2			16	16
5.04	5.18	1478.4	180					9	9
5.18	5.30	1267.2	160	NB	633.6			8	8
5.30	5.34	422.4	50					3	3
5.34	5.53	2006.4	250	SB	1003.4			13	13
5.53	6.43	9482.2	1190					59	59
SUBTOTAL	67350.0	5450.0		19060.0	1320.0		10402.0	424.0	424.0
TOTAL	91862.0			11722.0			424.0	424.0	

FILE NAME =	USER NAME = *USER*	DESIGNED - ---	REVISED - ---	STATE OF ILLINOIS DEPARTMENT OF TRANSPORTATION	PAVEMENT MARKING SCHEDULE	F.A.P. RTE.	SECTION	COUNTY	TOTAL SHEETS	SHEET NO.
FILE#	PLOT SCALE = *SCALE*	DRAWN - ---	REVISED - ---			600	(51.132RS-4	*	23	14
PLOT DATE = *DATE*	DATE - -----	CHECKED - ---	REVISED - ---			SCALE: ----- SHEET NO. OF SHEETS STA. ----- TO STA. -----		CONTRACT NO. 76B79		FED. ROAD DIST. NO. ILLINOIS FED. AID PROJECT

* MONROE, RANDOLPH

BUTTJOINT AND TEMPORARY RAMP SCHEDULE

LOCATION	OFFSET	SURFACE REMOVAL	PROPOSED SURFACE	WIDTH	BUTT JOINT	TEMPORARY RAMP
MILE STA.	ROADWAY, OR SIDE ROAD RT/LT	INCH	INCH	FOOT	SQ YD	SQ YD
0.05	ROADWAY	2	2.25	24	13	18
2.33	SIDE ROAD, RT	1	2.25	58.6	163	22
2.33	SIDE ROAD, LT	1	2.25	60.1	167	22
3.48	ROADWAY	1	2.25	24	67	9
3.50	ROADWAY	1	2.25	24	67	9
3.87	SIDE ROAD, RT	1	2.25	67.1	186	25
4.37	SIDE ROAD, LT	1	2.25	41.5	115	15
4.87	SIDE ROAD, LT	1	2.25	65.6	182	24
5.61	SIDE ROAD, RT	2	2.25	49.6	28	37
5.61	SIDE ROAD, LT	2	2.25	39.3	22	29
5.85	SIDE ROAD, RT	2	2.25	46.4	26	34
5.85	SIDE ROAD, LT	2	2.25	37.8	21	28
6.43	ROADWAY	2	2.25	24	13	18

TOTAL QUANTITY

1070

290

FILE NAME =	USER NAME = *USER*	DESIGNED - ---	REVISED - ---	STATE OF ILLINOIS DEPARTMENT OF TRANSPORTATION	BUTTJOINT & TEMPORARY RAMP SCHEDULE	F.A.P. RTE.	SECTION	COUNTY	TOTAL SHEETS	SHEET NO.
FILEL	PLOT SCALE = *SCALE*	DRAWN - ---	REVISED - ---			600	(51.132)RS-4	*	23	15
	PLOT DATE = *DATE*	CHECKED - ---	REVISED - ---			CONTRACT NO. 76879		FED. ROAD DIST. NO. ILLINOIS FED. AID PROJECT		
				SCALE: -----	SHEET NO. -- OF -- SHEETS	STA. ----- TO STA. -----				

* MONROE, RANDOLPH

COLD MILLING (SPECIAL) SCHEDULE

LOCATION	WIDTH	OFFSET	COLD MILLING (SPECIAL)
M.S. TO M.S.	FOOT	RT/LF	SQ YD
0.75 1.72	3	RT/LF	3339
1.72 1.73	BRIDGE OMISSION		
1.73 2.33	3	RT/LF	2088
TOTAL			5427

TRAFFIC BARRIER TERMINAL SCHEDULE

LOCATION	OFFSET	GUARDRAIL REMOVAL	TRAFFIC BARRIER TERMINAL, TYPE 1 SPECIAL	TERMINAL MARKER DIRECT APPLIED
MILE STATION	RT/LT	FOOT	EACH	EACH
3.44	RT	50		
3.54	RT	50		
3.44	RT		1	1
3.54	RT		1	1
TOTAL		100	2	2

* MONROE, RANDOLPH

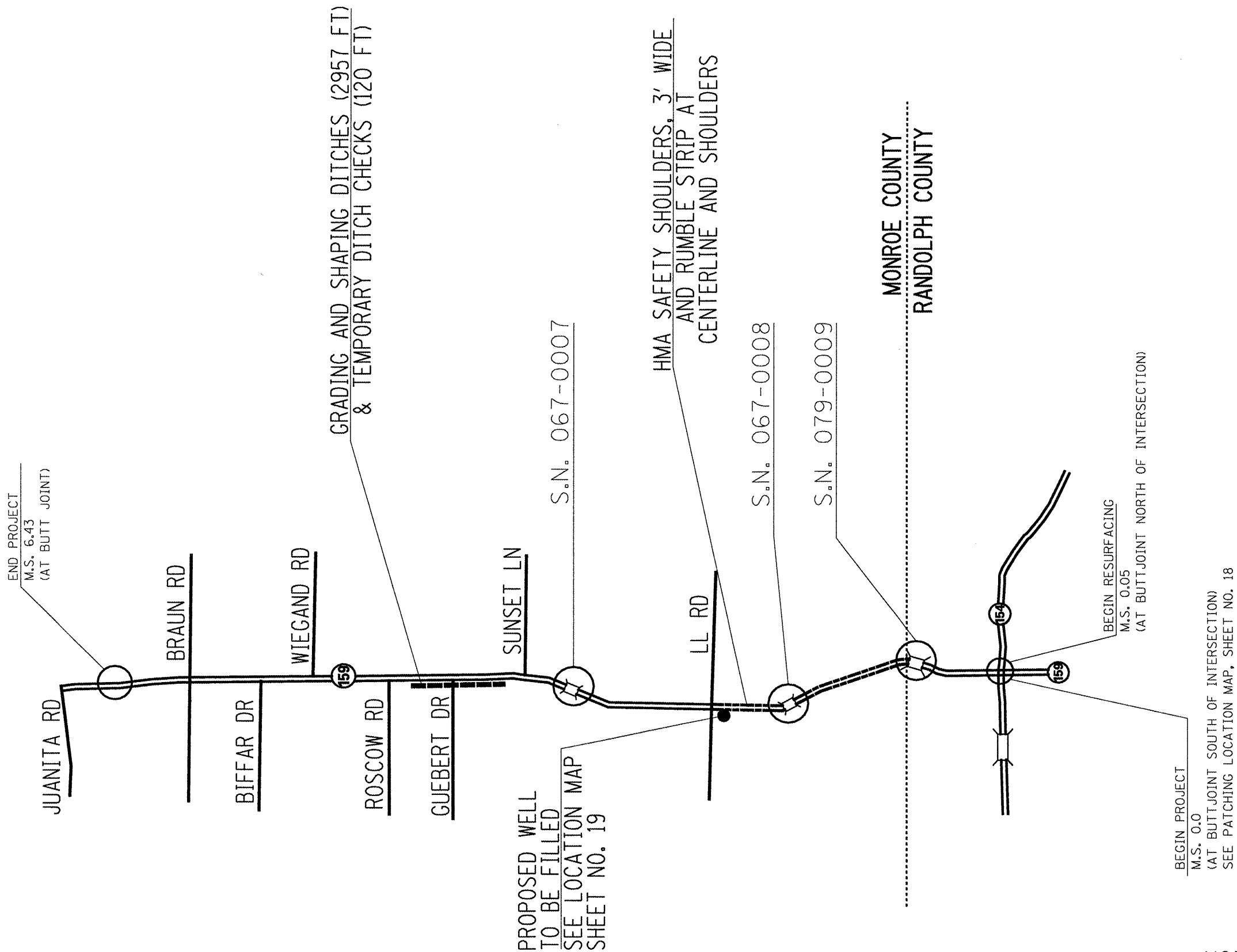

PROPOSED WELL
TO BE FILLED
SEE LOCATION MAP
SHEET NO. 19

NOT TO SCALE

FILE NAME = #FILE#	USER NAME = #USER#	DESIGNED - ---	REVISED - ---	STATE OF ILLINOIS DEPARTMENT OF TRANSPORTATION	LOCATION MAP		F.A.P. RTE. 600	SECTION 151.132RS-4	COUNTY *	TOTAL SHEETS 23	SHEET NO. 17
	PLOT SCALE = #SCALE#	CHECKED - ---	REVISED - ---		SCALE: -----	SHEET NO. -- OF -- SHEETS	STA. -----	TO STA. -----	FED. ROAD DIST. NO. ILLINOIS FED. AID PROJECT	CONTRACT NO. 76B79	
	PLOT DATE = #DATE#	DATE - -----	REVISED - ---								

* MONR. E. RANDOLPH

WELL TO BE SEALED LOCATION MAP

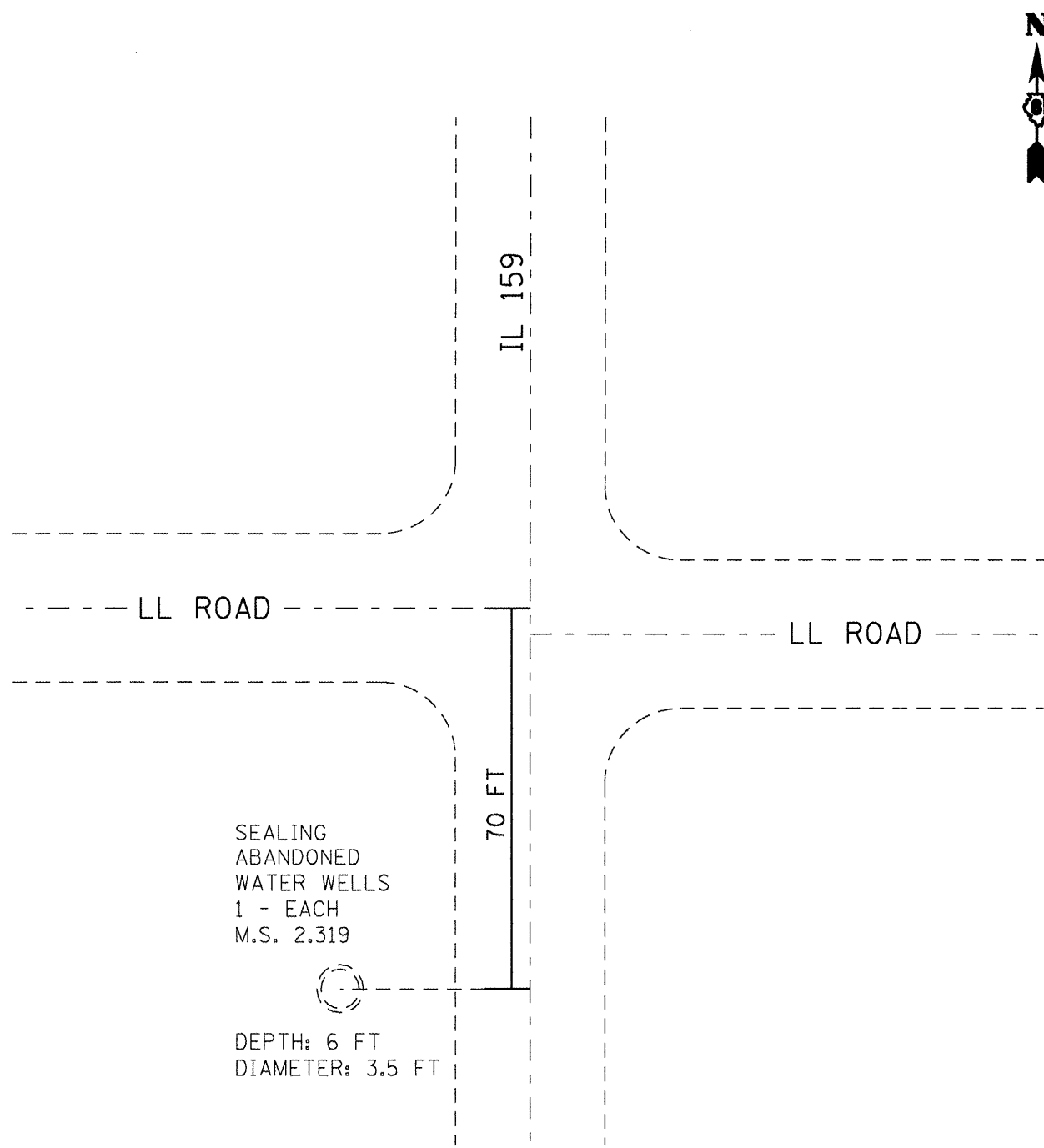

SEALING
ABANDONED
WATER WELLS
1 - EACH
M.S. 2.319

DEPTH: 6 FT
DIAMETER: 3.5 FT

NOT TO SCALE

CLASS B PATCHING LOCATION MAP

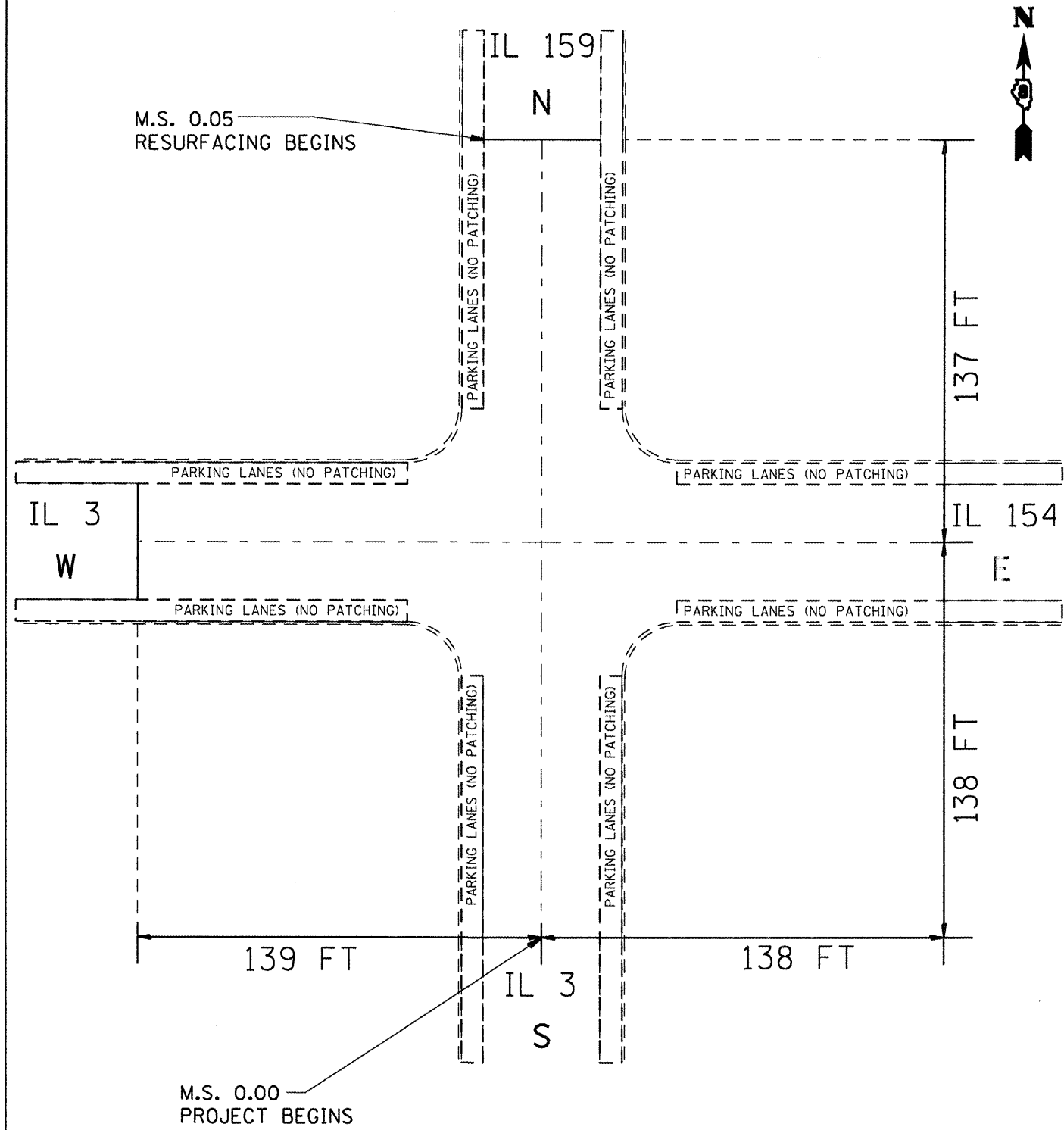

NOT TO SCALE

FILE NAME =	USER NAME = *USER*	DESIGNED - ---	REVISED - ---	STATE OF ILLINOIS DEPARTMENT OF TRANSPORTATION	WELL TO BE SEALED & CLASS B PATCHING LOCATION MAPS	F.A.P. RTE.	SECTION	COUNTY	TOTAL SHEETS	SHEET NO.
FILE#		DRAWN - ---	REVISED - ---			600	(51.132)RS-4	*	23	18
		CHECKED - ---	REVISED - ---			CONTRACT NO. 76879		FED. ROAD DIST. NO. ILLINOIS FED. AID PROJECT		
		DATE - ---	REVISED - ---	SCALE: _____ SHEET NO. OF SHEETS STA. TO STA.						

CLASS B (SPECIAL) PATCHING DETAILS

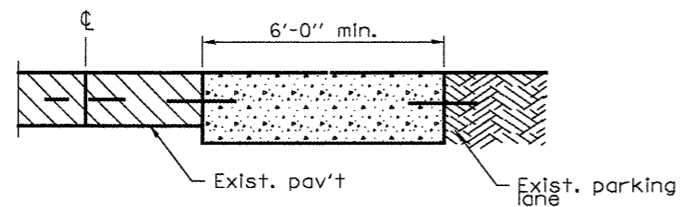
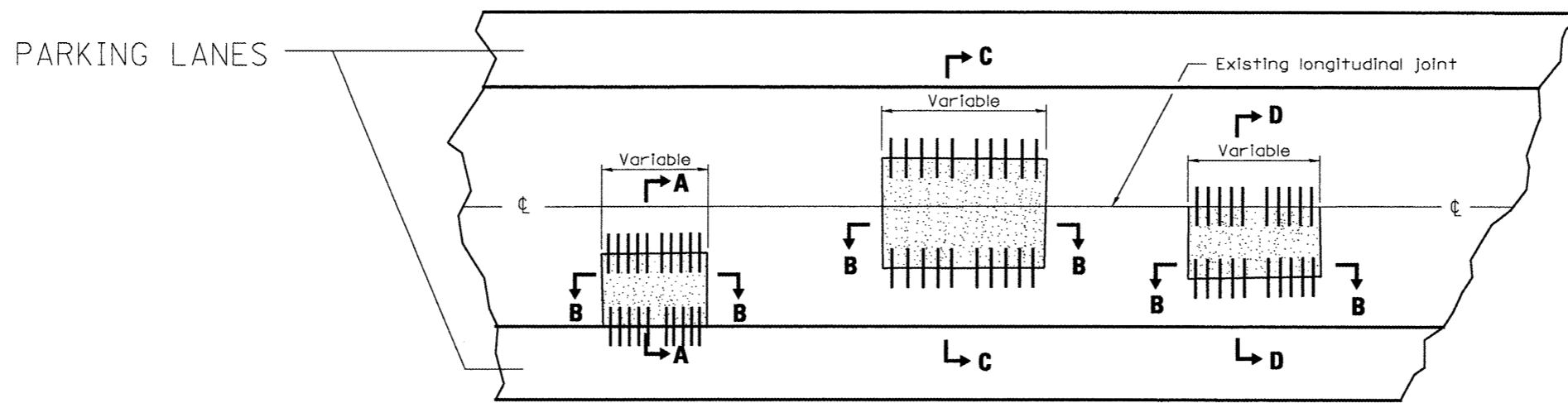

SECTION A-A

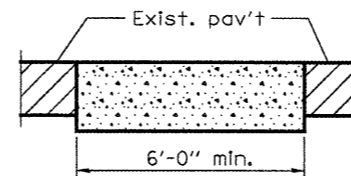

SECTION B-B

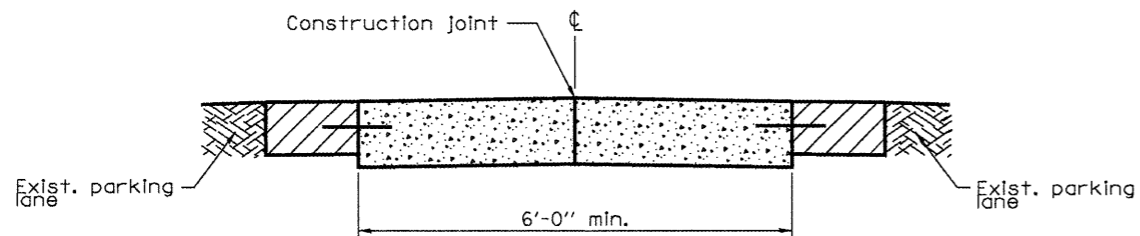

SECTION C-C
(Built in two operations)

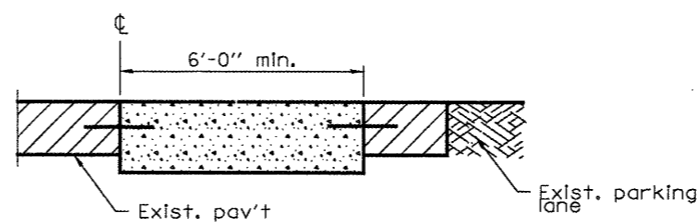

SECTION D-D

Dowel bars shall be placed at 1'-0" centers

All dimensions are in inches (millimeters) unless otherwise shown.

DOWEL BAR TABLE		
PAVEMENT THICKNESS	DOWEL BAR DIAMETER	HOLE DIAMETER
8 (200) or greater	1/2 (38)	1 5/8 (41)
7 (180) thru 7.99 (199)	1/4 (32)	1 3/8 (35)
Less than 7 (180)	1 (25)	1 1/8 (29)

FILE NAME =	USER NAME = #USER#	DESIGNED - ---	REVISED - ---
#FILE#		DRAWN - ---	REVISED - ---
	PLOT SCALE = #SCALE#	CHECKED - ---	REVISED - ---
	PLOT DATE = #DATE#	DATE - -----	REVISED - ---

STATE OF ILLINOIS
DEPARTMENT OF TRANSPORTATION

CLASS B PATCHING (SPECIAL) DETAILS

SCALE: _____ SHEET NO. ___ OF ___ SHEETS STA. _____ TO STA. _____

F.A.P. RTE.	SECTION	COUNTY	TOTAL SHEETS	SHEET NO.
600	(51.132)RS-4	.	23	19
FED. ROAD DIST. NO. _____ ILLINOIS FED. AID PROJECT			CONTRACT NO. 76B79	

• MONROE, RANDOLPH

CENTERLINE RUMBLE STRIP DETAIL

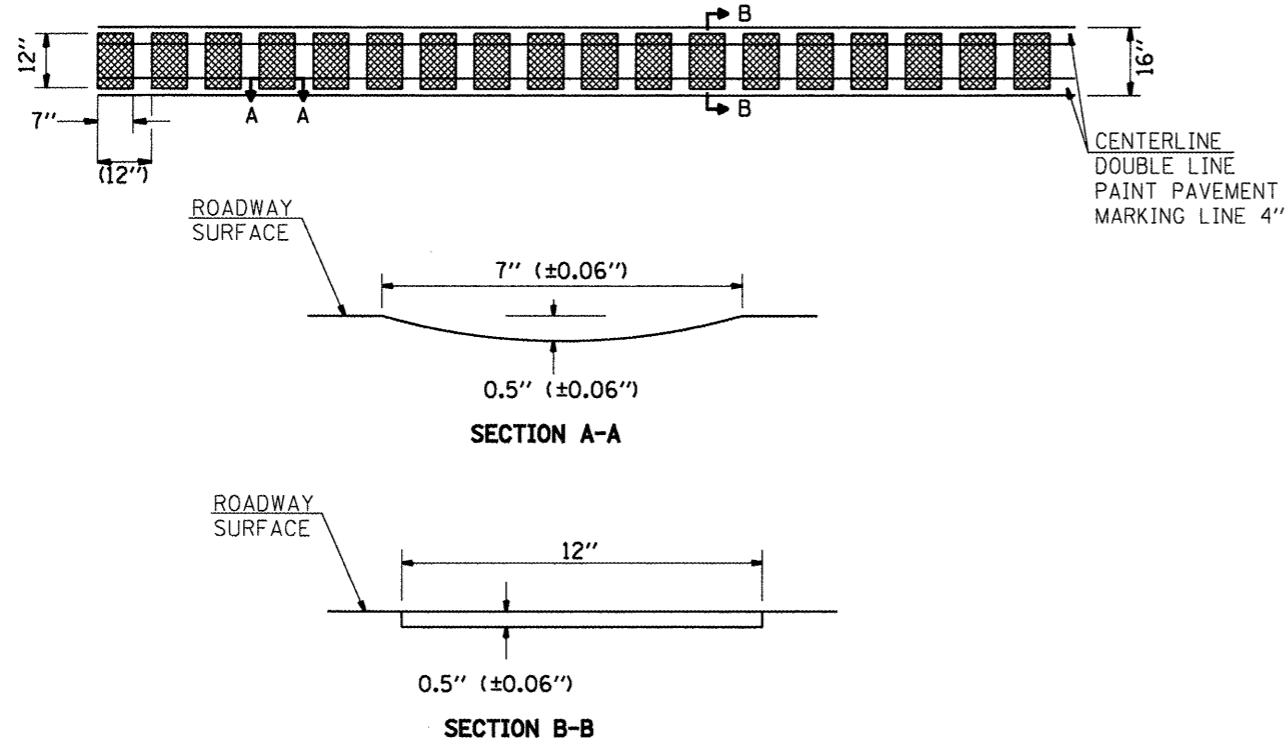

NOTE: THE PROPOSED CENTERLINE PAINT PAVEMENT MARKINGS SHALL BE PLACED AFTER THE CONSTRUCTION OF THE RUMBLE STRIP.

NOT TO SCALE

COLD MILLING (SPECIAL) DETAIL

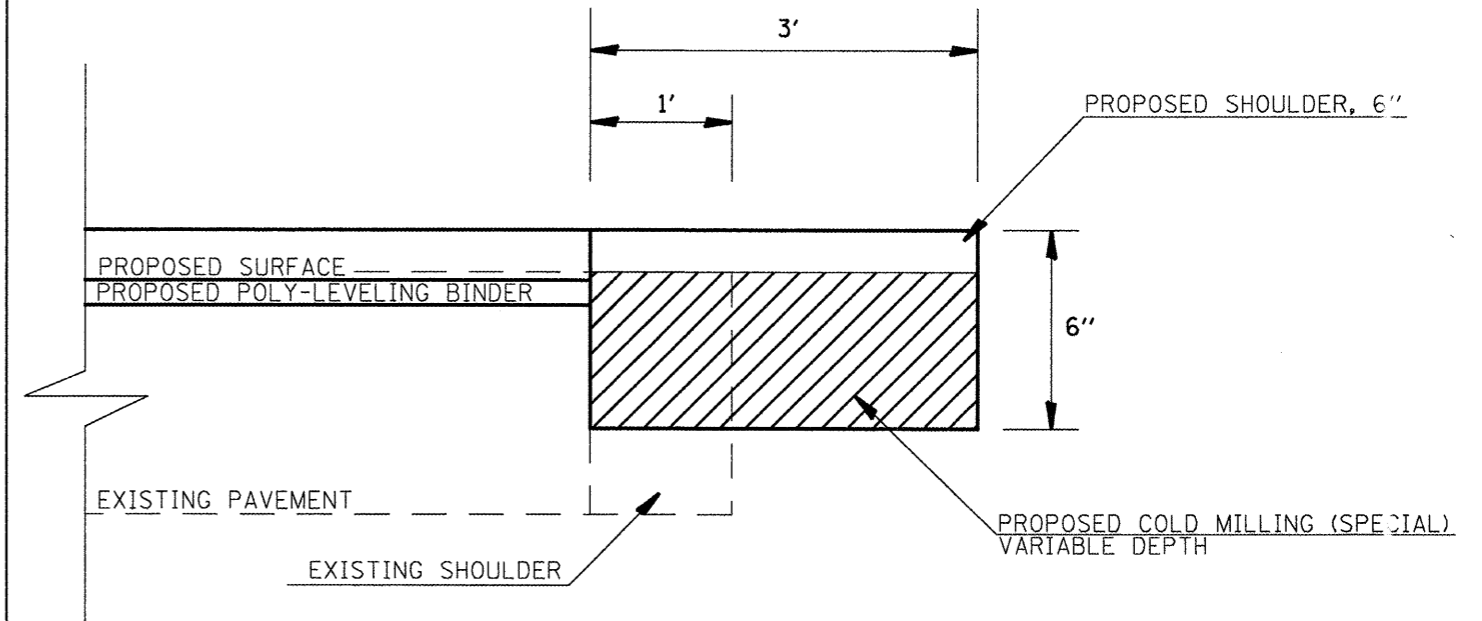

NOT TO SCALE

FILE NAME =	USER NAME = #USER#	DESIGNED -	REVISED -	STATE OF ILLINOIS DEPARTMENT OF TRANSPORTATION	CENTER LINE RUMBLE STRIP & COLD MILLING DETAILS	F.A.P. RTE.	SECTION	COUNTY	TOTAL SHEETS	SHEET NO.
#FILE#		DRAWN -	REVISED -			600	(51,132)RS-4		23	20
PLOT SCALE = #SCALE#		CHECKED -	REVISED -			CONTRACT NO. 76B79				
PLOT DATE = #DATE#		DATE -	REVISED -			FED. ROAD DIST. NO. ILLINOIS FED. AID PROJECT				

BUTTJOINT DETAIL

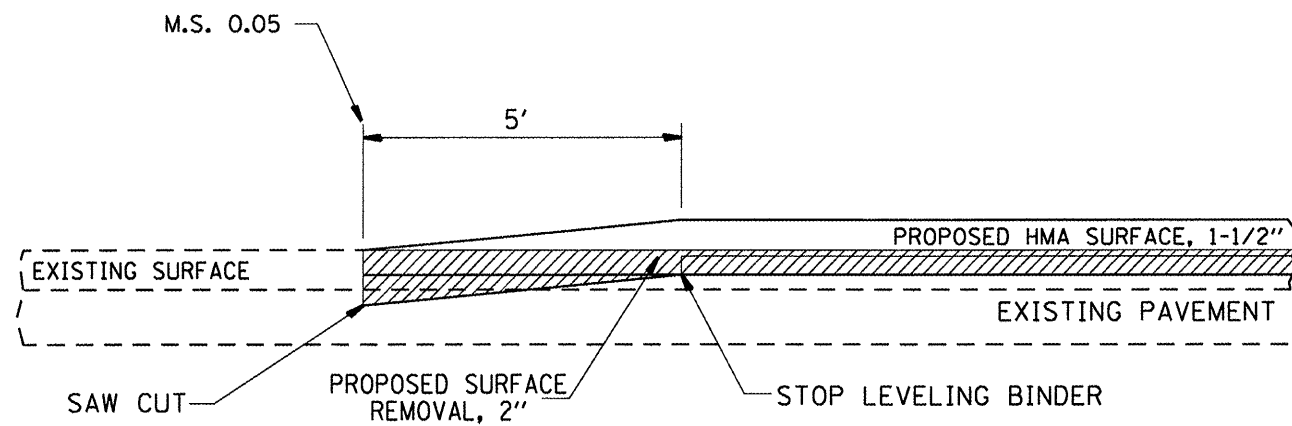

BRIDGE BUTTJOINT DETAIL

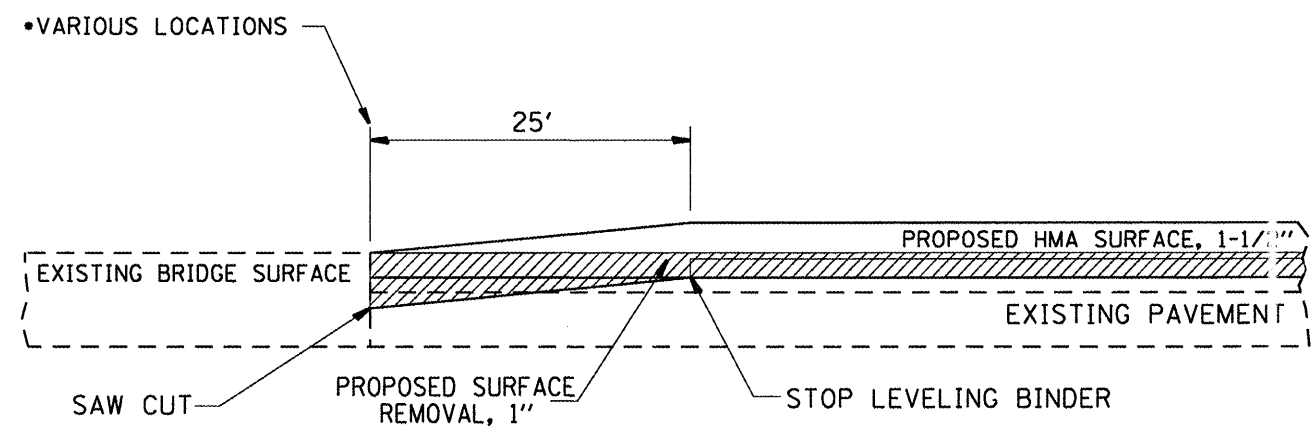

*VARIOUS LOCATIONS

M.S. 3.48
M.S. 3.50

NOT TO SCALE

SURFACE REMOVAL TRANSITION DETAIL

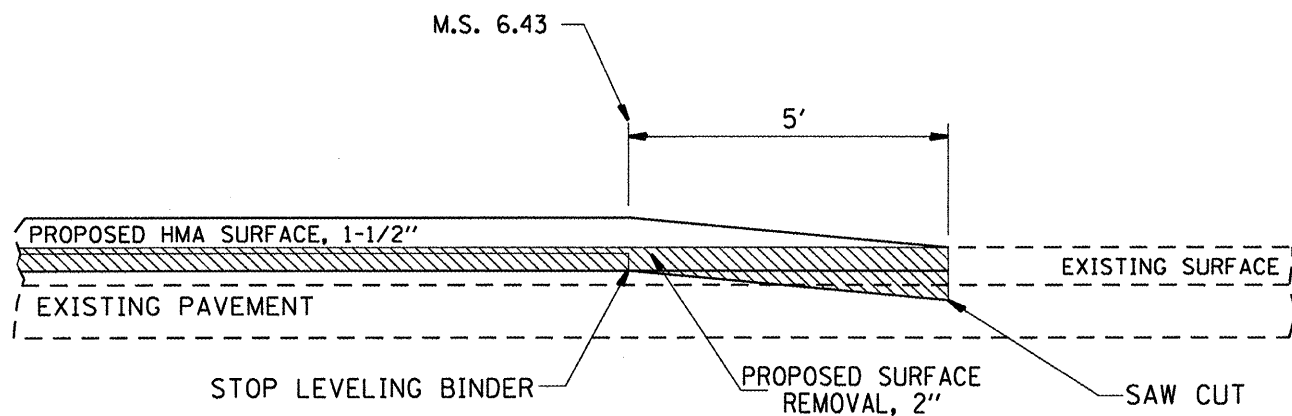

PROPOSED HMA SURFACE REMOVAL

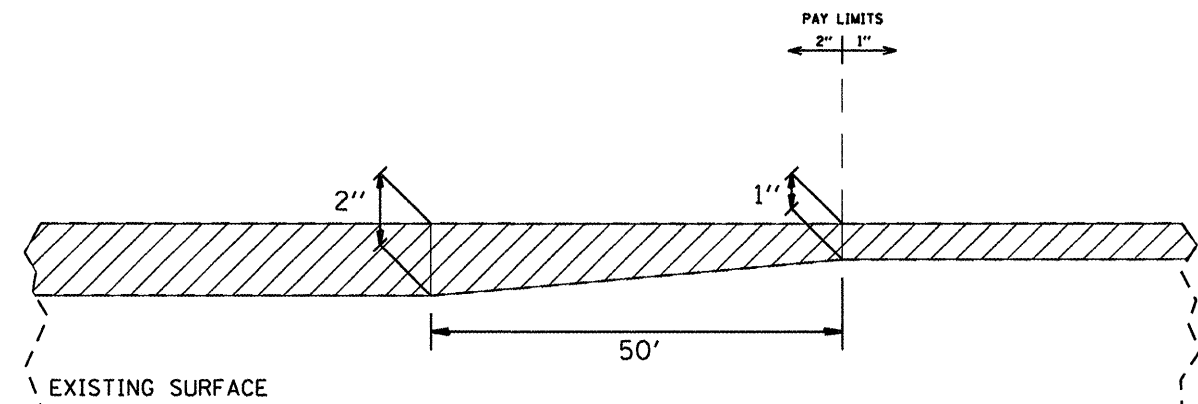

NOTE:
TRANSITION, PAID AS 2" SURFACE REMOVAL

NOT TO SCALE

FILE NAME =	USER NAME = *USER*	DESIGNED -	REVISED -	STATE OF ILLINOIS DEPARTMENT OF TRANSPORTATION	BUTTJOINT, BRIDGE BUTTJOINT & SURF REM TRANSITION DETAILS	F.A.P. RTE.	SECTION	COUNTY	TOTAL SHEET NO.	
#FILE#		DRAWN -	REVISED -			600	151,132RS-4	*	23	21
		CHECKED -	REVISED -			CONTRACT NO. 78879				
		DATE -	REVISED -	SCALE: _____ SHEET NO. _____ OF _____ SHEETS STA. _____ TO STA. _____		FED. ROAD DIST. NO. _____ ILLINOIS FED. AID PROJECT				

* MONROE, RANDOLPH

ENTRANCE DETAIL

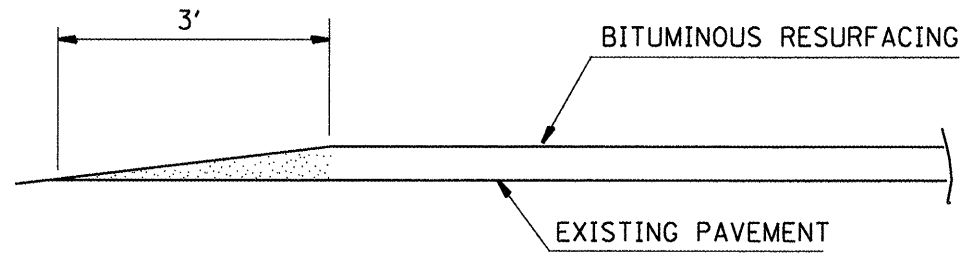

FEATHEREDGE DETAIL
SECTION A-A

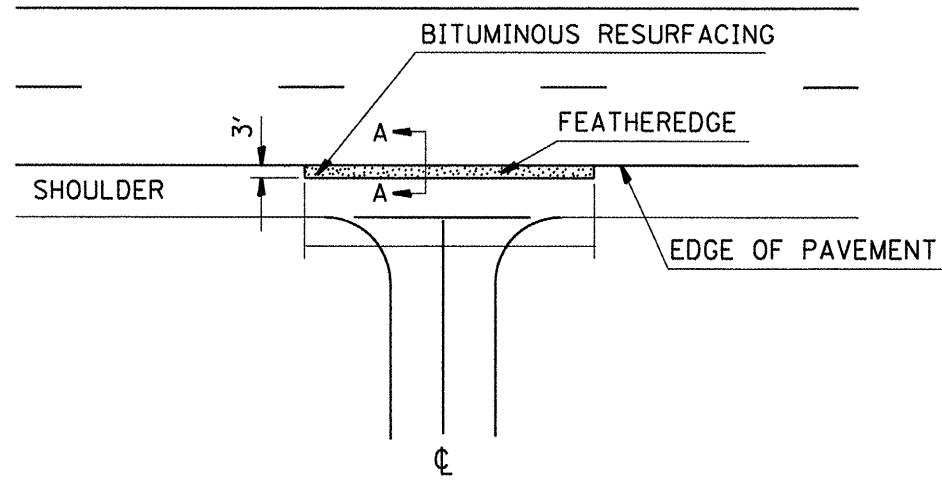

ENTRANCE DETAIL

SIDEROAD DETAIL

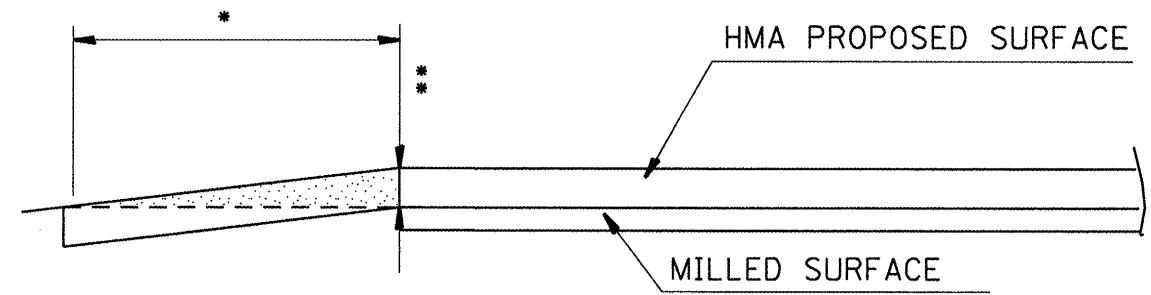

SIDEROAD TRANSITION DETAIL
SECTION A-A

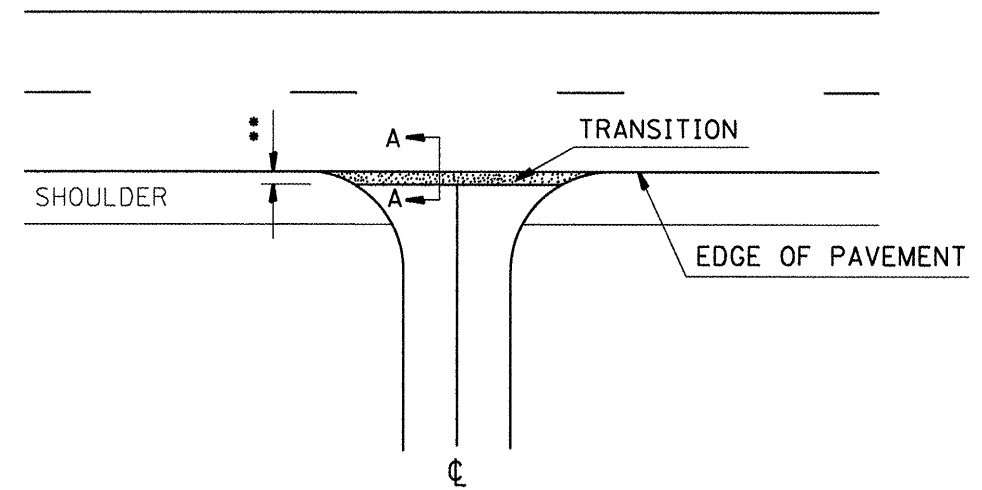

SIDEROAD DETAIL

*EOP ELEVATION CHANGE	**TOTAL TRANSITION LENGTH
3/4"	3.5'
1"	5'
1-1/2"	7.5'
2"	10'
2-1/2"	12.5'
3"	15'
3-1/2"	17.5'
4"	20'
4-1/2"	22.5'
5"	25'
5-1/2"	27.5'
6"	30'

**SEE SIDE ROAD SCHEDULE SHEET NO. 12 FOR SPECIFIC LENGTHS AND LOCATIONS OF SIDE ROADS

NOTE:
WHERE THE HMA TRANSITION IS MATCHING INTO AN EXISTING HMA SIDE ROAD SURFACE, A MILLED BUTT JOINT SHALL BE CONSTRUCTED WITHIN THE LIMITS OF THE TOTAL TRANSITION LENGTH ON THE LOCAL ROUTE.

FILE NAME =	USER NAME = *USER*	DESIGNED - ---	REVISED - ---	STATE OF ILLINOIS DEPARTMENT OF TRANSPORTATION	SCALE: _____ SHEET NO. ___ OF ___ SHEETS STA. _____ TO STA. _____	F.A.P. RTE. 600	SECTION (51)132RS-4	COUNTY	* MONROE, RANDOLPH		TOTAL SHEETS 23	SHEET NO. 22
#FILE#		DRAWN - ---	REVISED - ---			CONTRACT NO. 76B79		ILLINOIS FED. AID PROJECT				
	PLOT SCALE = *SCALE*	CHECKED - ---	REVISED - ---									
	PLOT DATE = *DATE*	DATE - ---	REVISED - ---									

SAFETY EDGE DETAIL

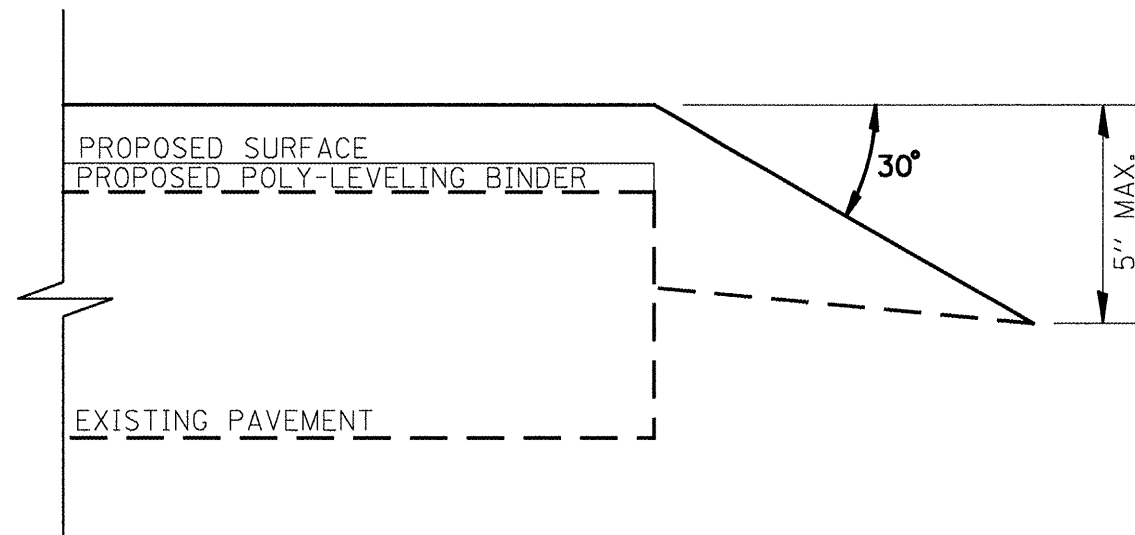

DITCH GRADING AND SHAPING DETAIL

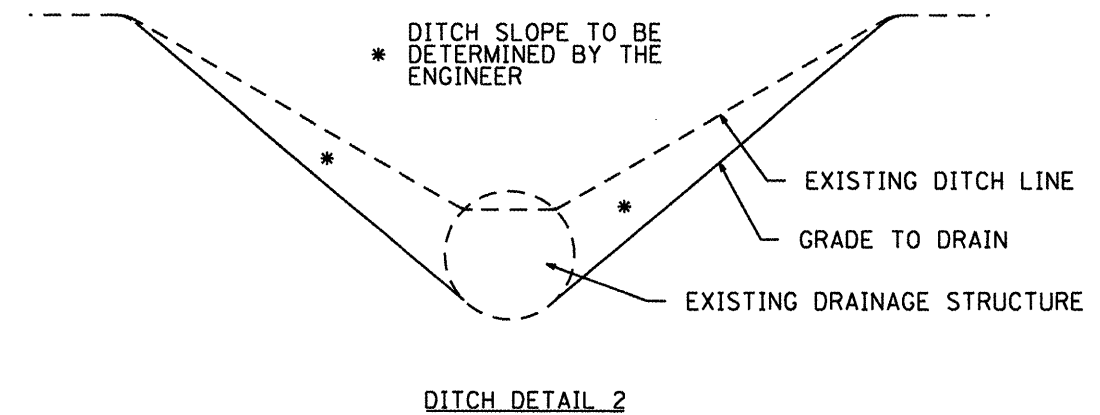
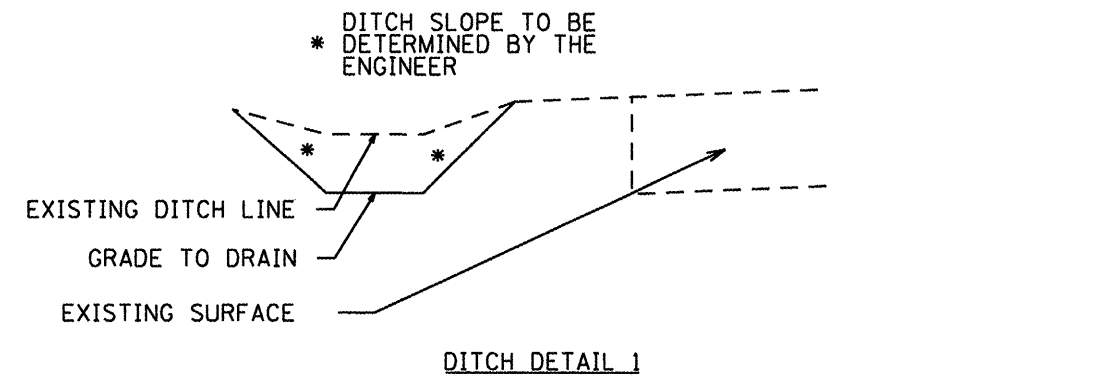

LOCATION
 M.S. 4.03 (LT) TO M.S. 4.59 (LT)
 GRADING AND SHAPING DITCHES - 2957 FT

R.O.W INFORMATION:
 R.O.W. IS 40 FT FROM CENTER LINE

NOT TO SCALE

FILE NAME =	USER NAME = *USER*	DESIGNED - ---	REVISED - ---
#FILE#		DRAWN - ---	REVISED - ---
	PLOT SCALE = *SCALE*	CHECKED - ---	REVISED - ---
	PLOT DATE = *DATE*	DATE - -----	REVISED - ---

**STATE OF ILLINOIS
 DEPARTMENT OF TRANSPORTATION**

SAFETY EDGE & DITCH GRADING AND SHAPING DETAILS

SCALE: _____ SHEET NO. ____ OF ____ SHEETS STA. _____ TO STA. _____

* MONROE, RANDOLPH				
F.A.P. RTE.	SECTION	COUNTY	TOTAL SHEETS	SHEET NO.
600	(51.132)RS-4	*	23	23
			CONTRACT NO. 76879	
FED. ROAD DIST. NO. _____ ILLINOIS FED. AID PROJECT				