

ALL GRADING ON THIS SHEET  
 BY OTHERS (CONTRACT 76C44)  
 FOR INFORMATION ONLY

PLAN	NO.	DATE
REVISION	BY	DATE
NOTED		
CHECKED		
DATE		

PROFILE	NO.	DATE
REVISION	BY	DATE
NOTED		
CHECKED		
DATE		

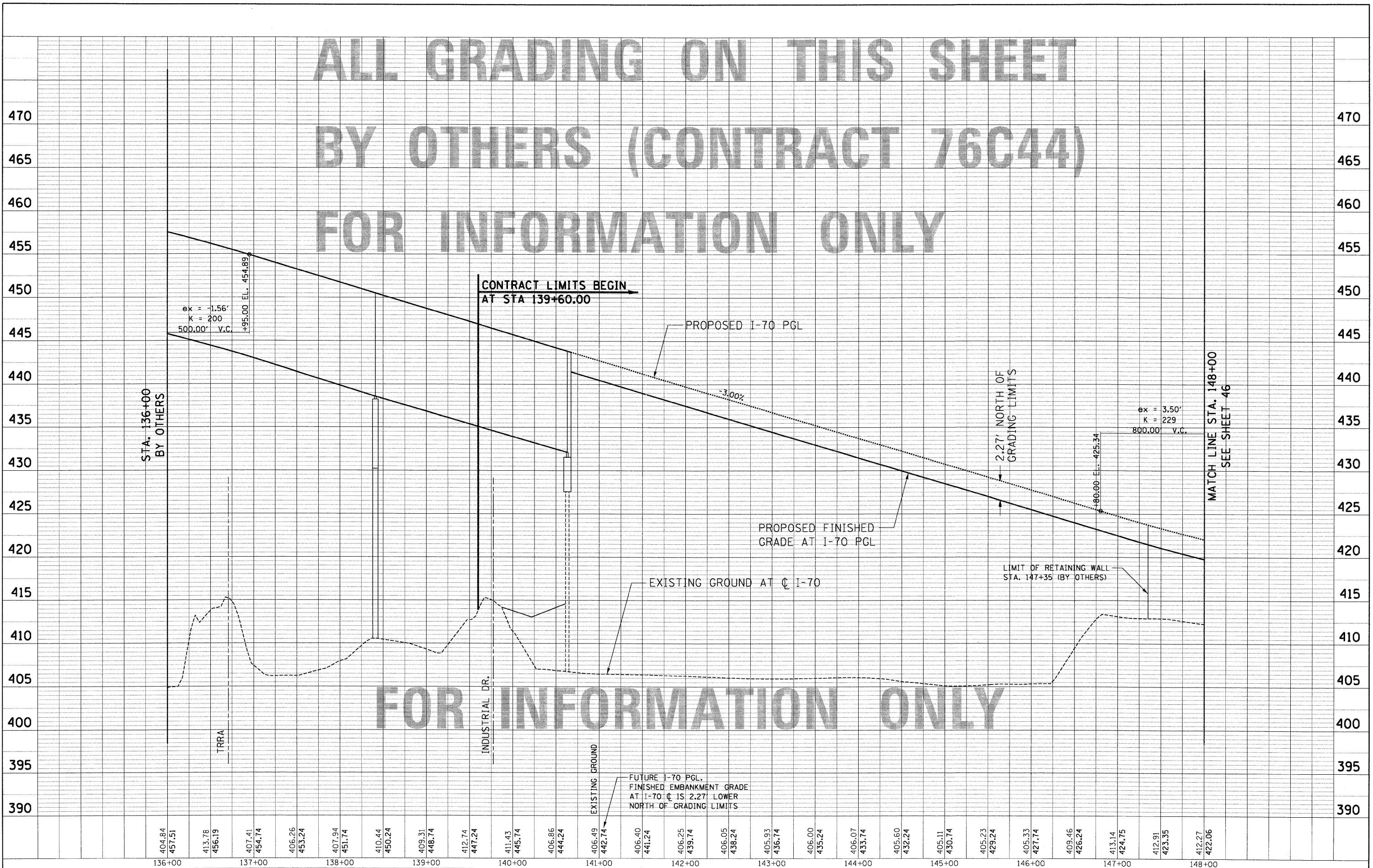

404.84	457.51	413.78	456.19	407.41	454.74	406.26	453.24	407.94	451.74	410.44	450.24	409.31	448.74	412.74	447.24	411.43	445.74	406.86	444.24	406.49	442.74	406.40	441.24	406.25	439.74	406.05	438.24	405.93	436.74	406.00	435.24	406.07	433.74	405.60	432.24	405.11	430.74	405.23	429.24	405.33	427.74	409.46	426.24	413.14	424.75	412.91	423.35	412.27	422.06
136+00	137+00	138+00	139+00	140+00	141+00	142+00	143+00	144+00	145+00	146+00	147+00	148+00																																					

FILE NAME =	USER NAME = #USER#	DESIGNED - JB	REVISED -	STATE OF ILLINOIS DEPARTMENT OF TRANSPORTATION				PROPOSED I-70 ROADWAY PROFILE STA. 136+00 TO STA. 148+00				F.A.P. RTE. 998	SECTION 82-1A	COUNTY ST. CLAIR	TOTAL SHEETS 190	SHEET NO. 45
#FILE#	PLOT SCALE = #SCALE#	DRAWN - JB	REVISED -	I-70 CONNECTION				SCALE: HORIZ. 1"=50' VERT. 1"=5'				FED. ROAD DIST. NO. ILLINOIS FED. AID PROJECT		CONTRACT NO. 76C41		
	PLOT DATE = #DATE#	CHECKED - ACL	REVISED -													
		DATE - 02/04/11	REVISED -													