



MATCH LINE STA. 21+50
SEE SHEET 78

CONTRACT LIMITS BEGIN
AT STA 139+60.00

STA. 139+00
BY OTHERS

MATCH LINE STA. 148+00
SEE SHEET 74

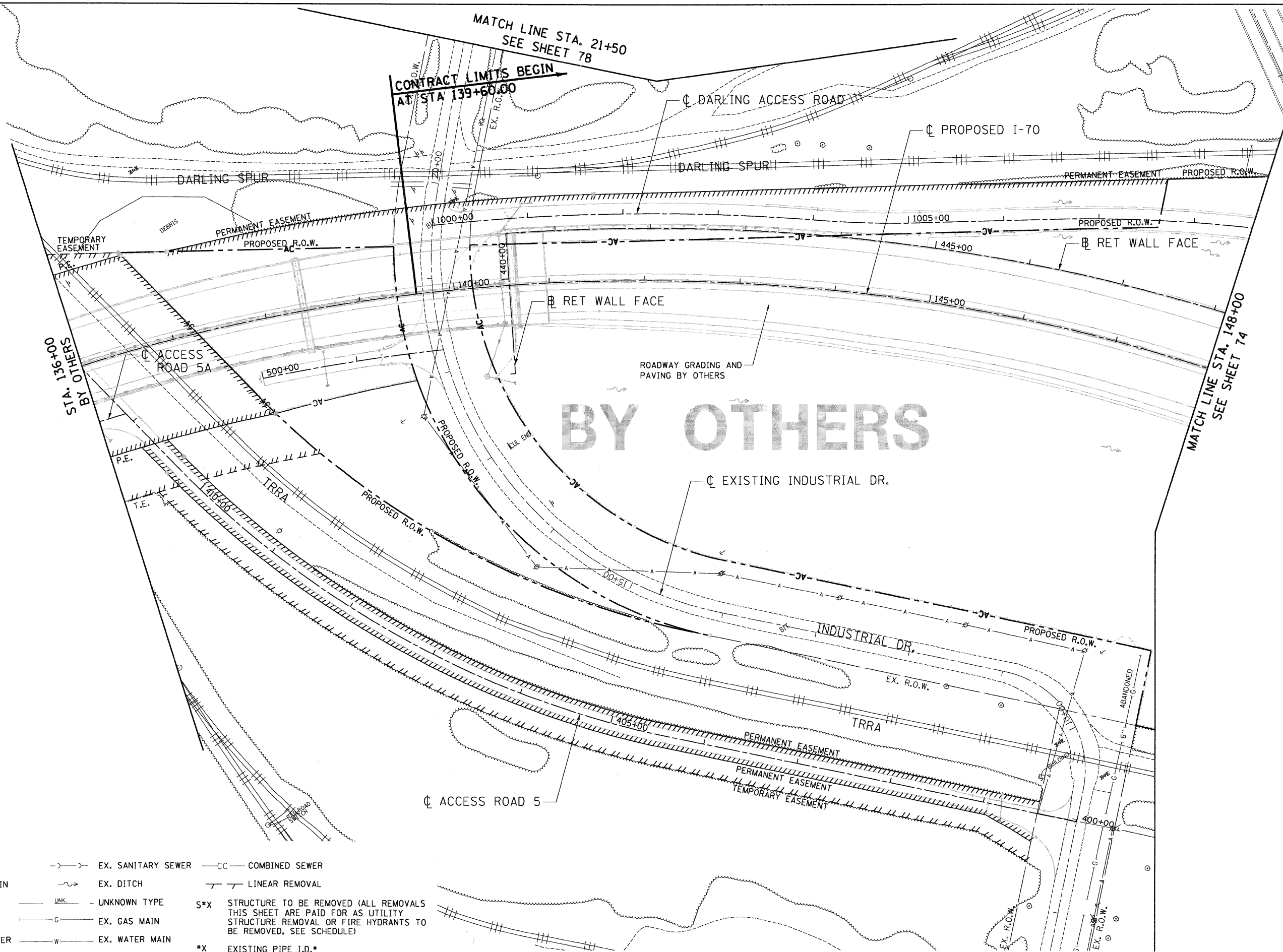

BY OTHERS

LEGEND

- | | | |
|---------------------|-------------------------|--|
| □ EX. INLET | —>—> EX. SANITARY SEWER | —CC— COMBINED SEWER |
| ○ EX. CATCH BASIN | —~— EX. DITCH | —/—/— LINEAR REMOVAL |
| ⊙ EX. MANHOLE | —LINK— UNKNOWN TYPE | S#X STRUCTURE TO BE REMOVED (ALL REMOVALS THIS SHEET ARE PAID FOR AS UTILITY STRUCTURE REMOVAL OR FIRE HYDRANTS TO BE REMOVED, SEE SCHEDULE) |
| ⊠ EX. HANDHOLE | —G— EX. GAS MAIN | *X EXISTING PIPE I.D.* |
| —V— EX. STORM SEWER | —W— EX. WATER MAIN | |

_DRCONN-99-MOTIFL.DGN, _DRCONN-96-BDRFIELDEN, _DRCONN-99-LAYOUTL.DGN, _DRCONN-96-I-EGENOLDEN, _DRCONN-96-MOTIFL.DGN, _DRCONN-96-MOTIFL.DGN
 5-04-2011 12:56:52 BONDHLD _S-2044\AMVAULT.D-TRANS.07\2202\28669.00\CIVIL\CAD\99-ALL-CONTRACT\CONNSHEETS.CONTRACT.05\DRCONN-96-SHT-DRNUTL1-13600.DGN

FILE NAME =	USER NAME = #USER#
#FILE#	
TENG TENG & ASSOCIATES, INC. ENGINEERS/ARCHITECTS/PLANNERS CHICAGO, ILLINOIS	

DESIGNED - JB	REVISED -
DRAWN - JB	REVISED -
CHECKED - ACL	REVISED -
DATE - 02/04/11	REVISED -

STATE OF ILLINOIS DEPARTMENT OF TRANSPORTATION I-70 CONNECTION	
--	--

PROPOSED I-70 EXISTING DRAINAGE & UTILITIES STA. 136+00 TO STA. 148+00	
SCALE: 1"=50'	SHEET NO. OF SHEETS STA. TO STA.

F.A.P. RTE. 998	SECTION 82-1A	COUNTY ST. CLAIR	TOTAL SHEETS 190	SHEET NO. 73
FED. ROAD DIST. NO.			ILLINOIS FED. AID PROJECT	

CONTRACT NO. 76C41				
--------------------	--	--	--	--