

MATCH LINE "A"
SEE SHEET 83

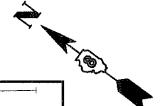

MATCH LINE STA 163+75
SEE SHEET 80

MATCH LINE STA 169+50
SEE SHEET 82

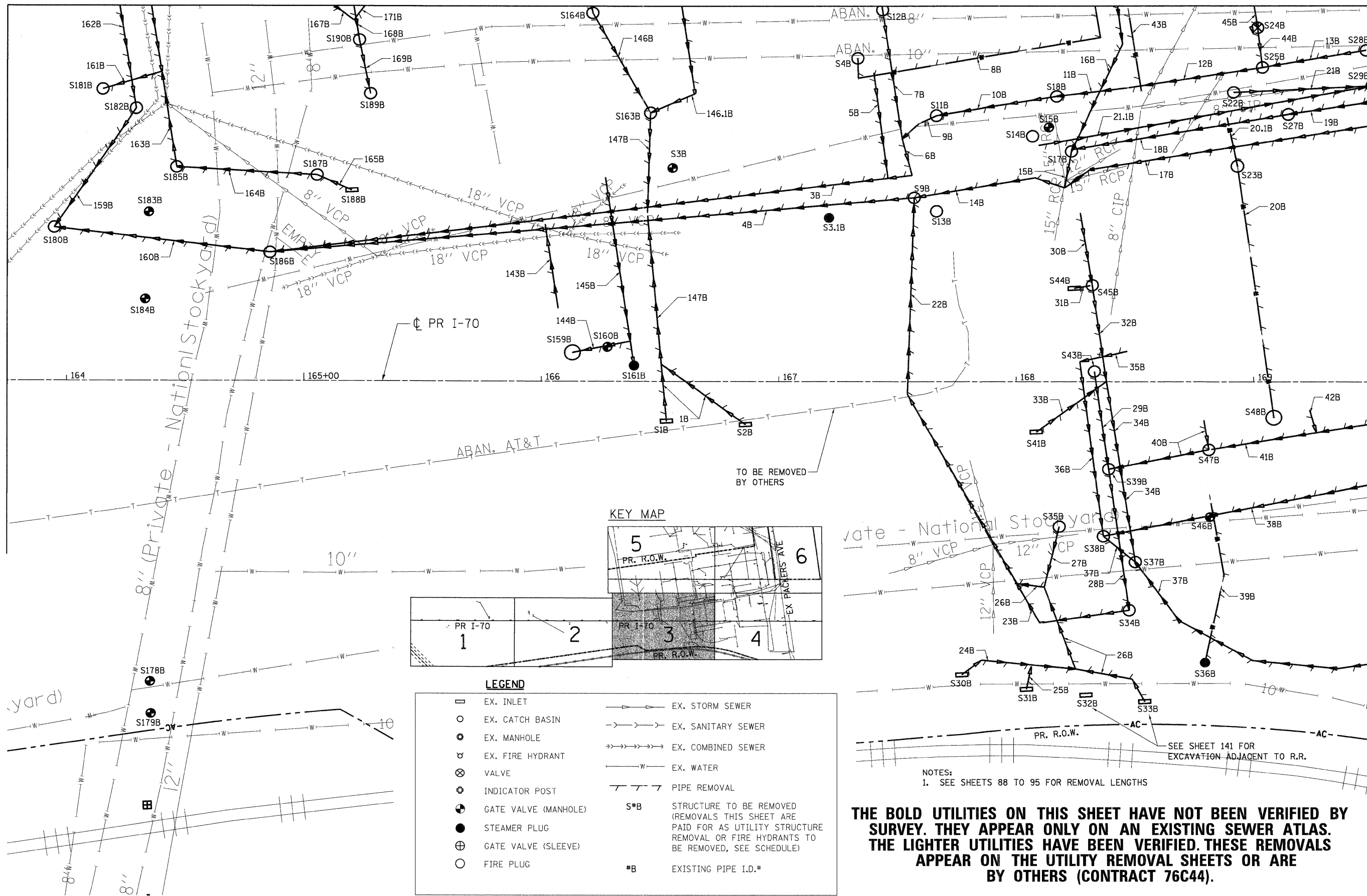

KEY MAP

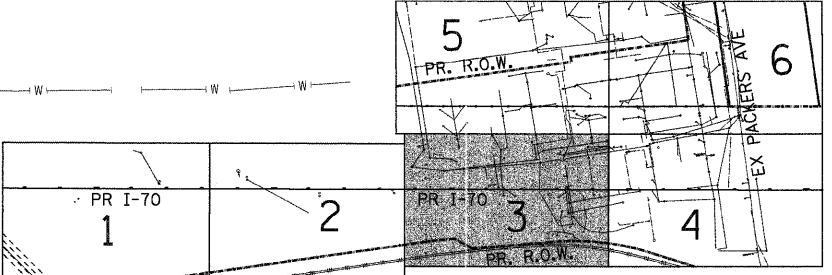

LEGEND

□	EX. INLET	—>—>	EX. STORM SEWER
○	EX. CATCH BASIN	—>—>—>	EX. SANITARY SEWER
●	EX. MANHOLE	—>—>—>—>	EX. COMBINED SEWER
⊕	EX. FIRE HYDRANT	—W—	EX. WATER
⊗	VALVE	—T—	PIPE REMOVAL
⊙	INDICATOR POST	S*B	STRUCTURE TO BE REMOVED (REMOVALS THIS SHEET ARE PAID FOR AS UTILITY STRUCTURE REMOVAL OR FIRE HYDRANTS TO BE REMOVED, SEE SCHEDULE)
⊕	GATE VALVE (MANHOLE)	#B	EXISTING PIPE I.D.#
●	STEAMER PLUG		
⊕	GATE VALVE (SLEEVE)		
○	FIRE PLUG		

NOTES:
1. SEE SHEETS 88 TO 95 FOR REMOVAL LENGTHS

THE BOLD UTILITIES ON THIS SHEET HAVE NOT BEEN VERIFIED BY SURVEY. THEY APPEAR ONLY ON AN EXISTING SEWER ATLAS. THE LIGHTER UTILITIES HAVE BEEN VERIFIED. THESE REMOVALS APPEAR ON THE UTILITY REMOVAL SHEETS OR ARE BY OTHERS (CONTRACT 76C44).

.\D:\CONNS-99-MOTIF.LDN, .\D:\CONNS-06-BORDER.LDN, .\D:\CONNS-06-MOTIF.LDN, .\D:\CONNS-06-LAYOUT2.LDN, .\D:\CONNS-06-LEGEND.LDN, .\D:\CONNS-06-MOTIF.LDN
 2-08-2011, 16:21:21

FILE NAME = #FILEL*	USER NAME = #USER*	DESIGNED - JB	REVISED -	STATE OF ILLINOIS DEPARTMENT OF TRANSPORTATION I-70 CONNECTION	PROPOSED I-70 EXISTING SEWER ATLAS 3			F.A.P. RTE. 998	SECTION 82-1A	COUNTY ST. CLAIR	TOTAL SHEETS 190	SHEET NO. 81
TENG & ASSOCIATES, INC. ENGINEERS/ARCHITECTS/PLANNERS CHICAGO, ILLINOIS	PLOT SCALE = #SCALE*	DRAWN - JB	REVISED -		SCALE: 1"=20'	SHEET NO.	OF SHEETS	STA.	TO STA.	CONTRACT NO. 76C41		
	PLOT DATE = #DATE*	CHECKED - ACL	REVISED -							FED. ROAD DIST. NO. ILLINOIS FED. AID PROJECT		
		DATE - 02/04/11	REVISED -									