

PLAN	NO.	NO.	NO.	NO.	NO.
NO.	NO.	NO.	NO.	NO.	NO.
NO.	NO.	NO.	NO.	NO.	NO.
NO.	NO.	NO.	NO.	NO.	NO.
NO.	NO.	NO.	NO.	NO.	NO.
NO.	NO.	NO.	NO.	NO.	NO.

PROFILE	NO.	NO.	NO.	NO.	NO.
NO.	NO.	NO.	NO.	NO.	NO.
NO.	NO.	NO.	NO.	NO.	NO.
NO.	NO.	NO.	NO.	NO.	NO.
NO.	NO.	NO.	NO.	NO.	NO.
NO.	NO.	NO.	NO.	NO.	NO.

5 04-2811, 1745943 BONDHOLD
 11 S 2844 N HWY 141, D. IRONS, ILLINOIS 62422-2888 888\A\CIVIL\CD\99 ALL CONTRACT SHEETS CONTRACT 06 SUBCONTRACT 06 SITE PROJ 2-13600.DGN

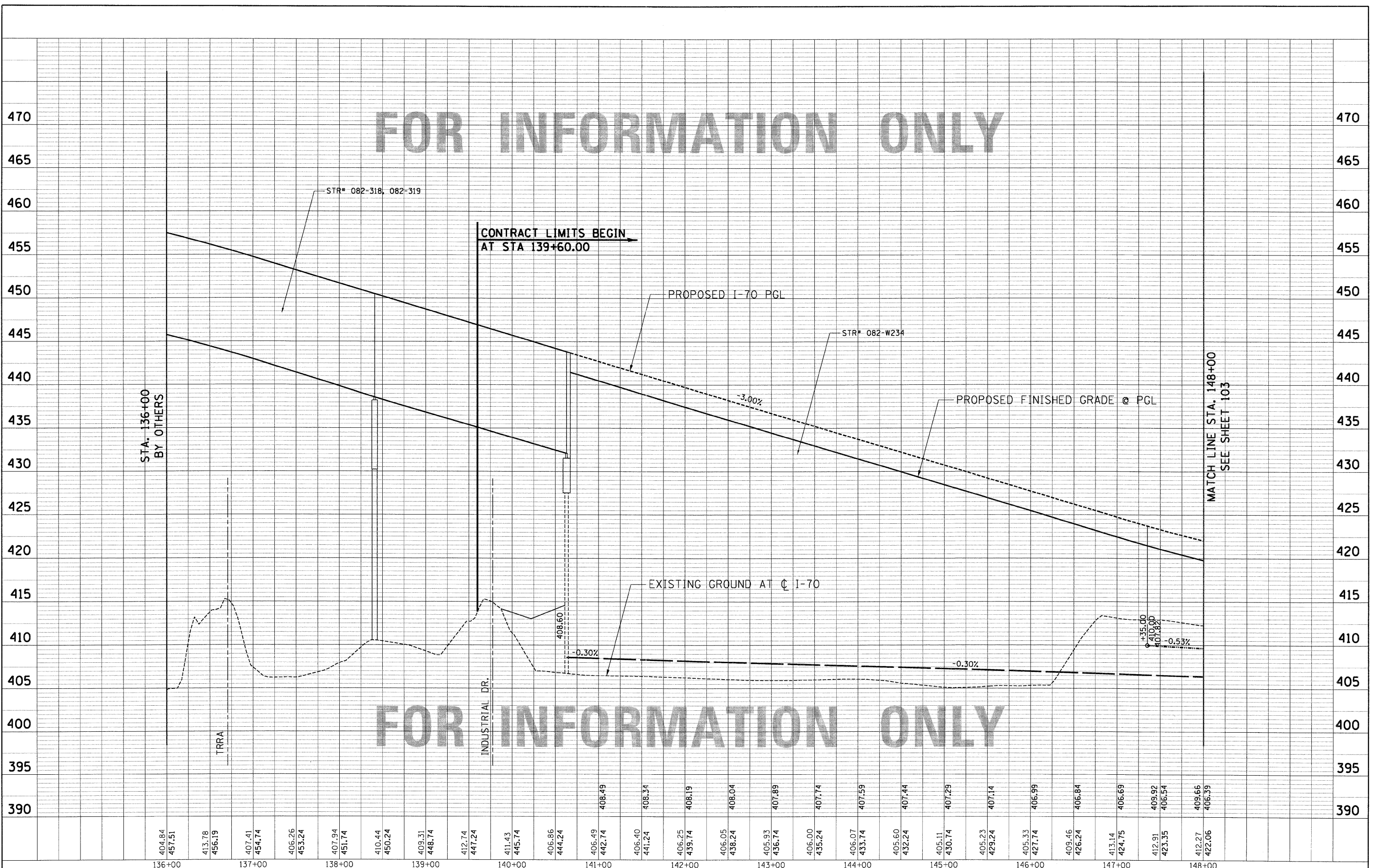

FOR INFORMATION ONLY

FOR INFORMATION ONLY

FILE NAME =	USER NAME = #USERS	DESIGNED - JB	REVISED -	STATE OF ILLINOIS DEPARTMENT OF TRANSPORTATION I-70 CONNECTION	PROPOSED I-70 DRAINAGE PROFILE STA. 136 + 00 TO STA. 148 + 00	F.A.P. RTE. 998	SECTION 82-1A	COUNTY ST. CLAIR	TOTAL SHEETS 190	SHEET NO. 102	
#FILE#	PLOT SCALE = #SCALE#	DRAWN - JB	REVISED -			SCALE: HORIZ. 1"=50'	VERT. 1"=5'	STA. TO STA.	FED. ROAD DIST. NO. ILLINOIS FED. AID PROJECT	CONTRACT NO. 76C41	
	PLOT DATE = #DATE#	CHECKED - ACL	REVISED -								
		DATE - 02/04/11	REVISED -								