

PROP. CURVE 55N-1
PI STA. = 51+92.01
Δ = 10° 37' 43" (RT)
D = 2° 46' 32"
R = 2,064.27'
T = 192.01'
L = 382.93'
E = 8.91'
P.C. STA = 50+00.00
P.T. STA = 53+82.93

PROP. CURVE 55N-2
PI STA. = 62+39.34
Δ = 10° 09' 06" (LT)
D = 1° 50' 43"
R = 3,105.00'
T = 275.79'
L = 550.14'
E = 12.22'
P.C. STA = 59+63.55
P.T. STA = 65+13.69

PROP. CURVE 55N-3
PI STA. = 79+77.22
Δ = 11° 19' 26" (LT)
D = 3° 10' 59"
R = 1,800.00'
T = 178.46'
L = 355.75'
E = 8.82'
P.C. STA = 77+98.77
P.C.C. STA = 81+54.52

PROP. CURVE 55N-4
PI STA. = 84+69.84
Δ = 18° 50' 46" (LT)
D = 3° 00' 56"
R = 1,900.00'
T = 315.33'
L = 624.96'
E = 25.99'
P.C.C. STA = 81+54.52
P.C.C. STA = 87+79.48

PROP. CURVE 55N-5
PI STA. = 89+19.86
Δ = 7° 38' 56" (LT)
D = 2° 43' 42"
R = 2,100.00'
T = 140.38'
L = 280.35'
E = 4.69'
P.C.C. STA = 87+79.48
P.T. STA = 90+59.82

PROP. CURVE 55S-1
PI STA. = 64+62.70
Δ = 0° 19' 12" (RT)
D = 0° 04' 19"
R = 79,694.32'
T = 222.64'
L = 445.28'
E = 0.31'
P.C. STA = 62+40.06
P.T. STA = 66+85.34

PROP. CURVE 55S-2
PI STA. = 71+51.26
Δ = 19° 05' 52" (RT)
D = 3° 16' 27"
R = 1,750.00'
T = 294.38'
L = 583.31'
E = 24.59'
P.C. STA = 68+56.88
P.C.C. STA = 74+40.19

PROP. CURVE 55S-3
PI STA. = 78+46.09
Δ = 24° 21' 42" (RT)
D = 3° 02' 49"
R = 1,880.42'
T = 405.90'
L = 799.54'
E = 43.31'
P.C.C. STA = 74+40.19
P.C.C. STA = 82+39.72

PROP. CURVE 55S-4
PI STA. = 85+55.05
Δ = 27° 16' 06" (RT)
D = 4° 24' 27"
R = 1,300.00'
T = 315.32'
L = 618.70'
E = 37.70'
P.C.C. STA = 82+39.72
P.T. STA = 88+58.42

PROP. CURVE 55S-5
PI STA. = 93+80.20
Δ = 30° 29' 46" (LT)
D = 6° 28' 13"
R = 885.51'
T = 241.39'
L = 471.32'
E = 32.31'
P.C. STA = 91+38.81
P.C.C. STA = 96+10.13

PROP. CURVE 55S-6
PI STA. = 97+85.47
Δ = 15° 22' 19" (LT)
D = 4° 24' 36"
R = 1,299.24'
T = 175.34'
L = 348.58'
E = 11.78'
P.C.C. STA = 96+10.13
P.T. STA = 99+58.71

PROP. CURVE 55S70W-1
PI STA. = 54+34.08
Δ = 25° 36' 07" (RT)
D = 3° 52' 55"
R = 1,476.00'
T = 335.37'
L = 659.54'
E = 37.62'
e = 5.00%
T.R. ATTAINMENT = 0'
S.E. RUN. ATTAINMENT = 107'
T.R. REMOVAL = 0'
S.E. RUN. REMOVAL = 36'
P.C. STA = 50+98.71
P.C.C. STA = 57+58.25

PROP. CURVE 55S70W-2
PI STA. = 60+50.80
Δ = 14° 29' 29" (RT)
D = 2° 29' 24"
R = 2,301.00'
T = 292.55'
L = 581.97'
E = 18.52'
e = 4.00%
T.R. ATTAINMENT = 0'
S.E. RUN. ATTAINMENT = 36'
T.R. REMOVAL = 0'
S.E. RUN. REMOVAL = 47'
P.C.C. STA = 57+58.25
P.T. STA = 63+40.22

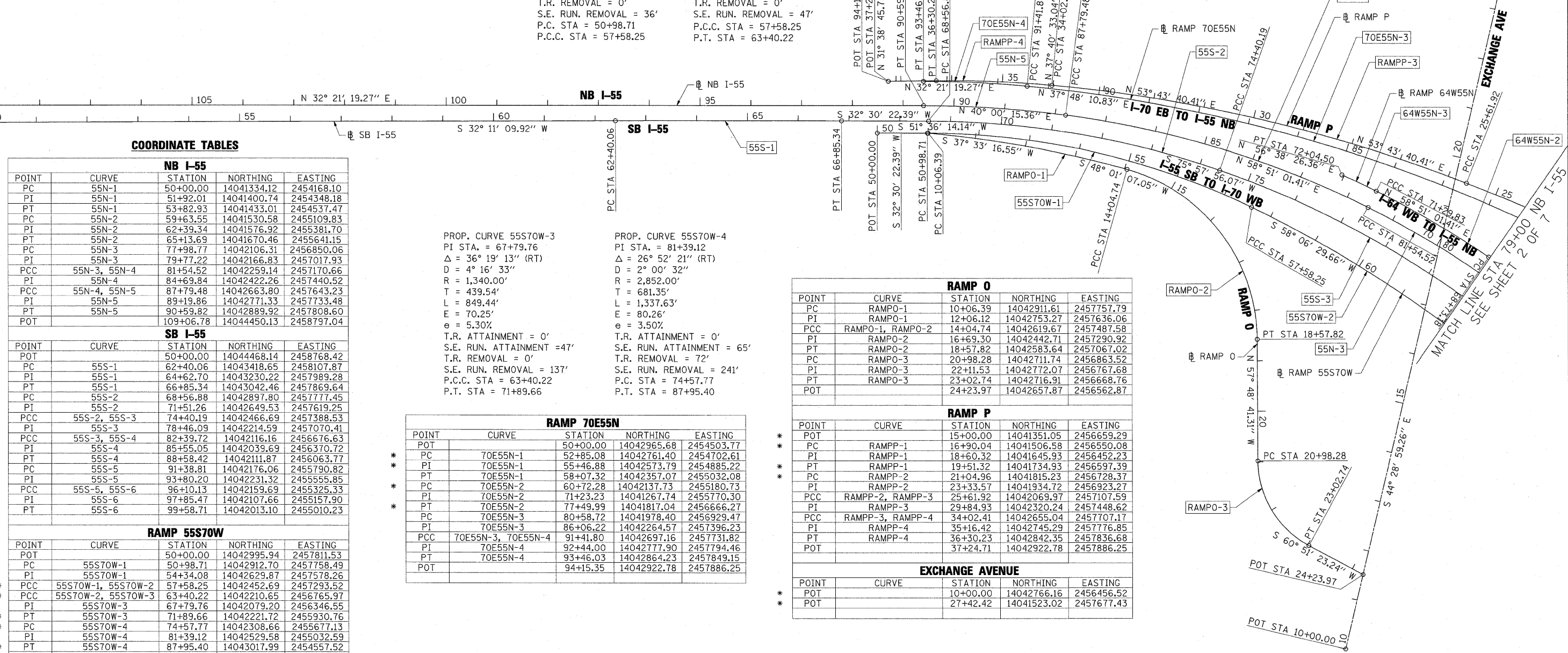

COORDINATE TABLES

NB I-55				
POINT	CURVE	STATION	NORTHING	EASTING
PC	55N-1	50+00.00	14041334.12	2454168.10
PI	55N-1	51+92.01	14041400.74	2454348.18
PT	55N-1	53+82.93	14041433.01	2454537.47
PC	55N-2	59+63.55	14041530.58	2455109.83
PI	55N-2	62+39.34	14041576.92	2455381.70
PT	55N-2	65+13.69	14041670.46	2455641.15
PC	55N-3	77+98.77	14042106.31	2456850.06
PI	55N-3	79+77.22	14042166.83	2457017.93
PCC	55N-3, 55N-4	81+54.52	14042259.14	2457170.66
PI	55N-4	84+69.84	14042422.26	2457440.52
PCC	55N-4, 55N-5	87+79.48	14042663.80	2457643.23
PI	55N-5	89+19.86	14042771.33	2457733.48
PT	55N-5	90+59.82	14042889.92	2457808.60
POT		109+06.78	14044450.13	2458797.04

SB I-55				
POINT	CURVE	STATION	NORTHING	EASTING
POT		50+00.00	14044468.14	2458768.42
PC	55S-1	62+40.06	14043418.65	2458107.87
PI	55S-1	64+62.70	14043230.22	2457989.28
PT	55S-1	66+85.34	14043042.46	2457869.64
PC	55S-2	68+56.88	14042897.80	2457777.45
PI	55S-2	71+51.26	14042649.53	2457619.25
PCC	55S-2, 55S-3	74+40.19	14042466.69	2457388.53
PI	55S-3	78+46.09	14042214.59	2457070.41
PCC	55S-3, 55S-4	82+39.72	14042116.16	2456676.63
PI	55S-4	85+55.05	14042039.69	2456370.72
PT	55S-4	88+58.42	14042111.87	2456063.77
PC	55S-5	91+38.81	14042176.06	2455790.82
PI	55S-5	93+80.20	14042231.32	2455555.85
PCC	55S-5, 55S-6	96+10.13	14042159.69	2455325.33
PI	55S-6	97+85.47	14042107.66	2455157.90
PT	55S-6	99+58.71	14042013.10	2455010.23

RAMP 55S70W				
POINT	CURVE	STATION	NORTHING	EASTING
POT		50+00.00	14042995.94	2457811.53
PC	55S70W-1	50+98.71	14042912.70	2457758.49
PI	55S70W-1	54+34.08	14042629.87	2457578.26
PCC	55S70W-1, 55S70W-2	57+58.25	14042452.69	2457293.52
PCC	55S70W-2, 55S70W-3	63+40.22	14042210.65	2456765.97
PI	55S70W-3	67+79.76	14042079.20	2456346.55
PT	55S70W-3	71+89.66	14042221.72	2455930.76
PC	55S70W-4	74+57.77	14042308.66	2455677.13
PI	55S70W-4	81+39.12	14042529.58	2455032.59
PT	55S70W-4	87+95.40	14043017.99	2454557.52

PROP. CURVE 55S70W-3
PI STA. = 67+79.76
Δ = 36° 19' 13" (RT)
D = 4° 16' 33"
R = 1,340.00'
T = 439.54'
L = 849.44'
E = 70.25'
e = 5.30%
T.R. ATTAINMENT = 0'
S.E. RUN. ATTAINMENT = 47'
T.R. REMOVAL = 0'
S.E. RUN. REMOVAL = 137'
P.C.C. STA = 63+40.22
P.T. STA = 71+89.66

PROP. CURVE 55S70W-4
PI STA. = 81+39.12
Δ = 26° 52' 21" (RT)
D = 2° 00' 32"
R = 2,852.00'
T = 681.35'
L = 1,337.63'
E = 80.26'
e = 3.50%
T.R. ATTAINMENT = 0'
S.E. RUN. ATTAINMENT = 65'
T.R. REMOVAL = 72'
S.E. RUN. REMOVAL = 241'
P.C. STA = 74+57.77
P.T. STA = 87+95.40

RAMP 70E55N				
POINT	CURVE	STATION	NORTHING	EASTING
POT		50+00.00	14042965.68	2454503.77
PC	70E55N-1	52+85.08	14042761.40	2454702.61
PI	70E55N-1	55+46.88	14042573.79	2454885.22
PT	70E55N-1	58+07.32	14042357.07	2455032.08
PC	70E55N-2	60+72.28	14042137.73	2455180.73
PI	70E55N-2	71+23.23	14041267.74	2455770.30
PT	70E55N-2	77+49.99	14041817.04	2456666.27
PC	70E55N-3	80+58.72	14041978.40	2456929.47
PI	70E55N-3	86+06.22	14042264.57	2457396.23
PCC	70E55N-3, 70E55N-4	91+41.80	14042697.16	2457731.82
PI	70E55N-4	92+44.00	14042777.90	2457794.46
PT	70E55N-4	93+46.03	14042864.23	2457849.15
POT		94+15.35	14042922.78	2457886.25

RAMP O				
POINT	CURVE	STATION	NORTHING	EASTING
PC	RAMPO-1	10+06.39	14042911.61	2457757.79
PI	RAMPO-1	12+06.12	14042753.27	2457636.06
PCC	RAMPO-1, RAMPO-2	14+04.74	14042619.67	2457487.58
PT	RAMPO-2	16+69.30	14042442.71	2457290.92
PT	RAMPO-2	18+57.82	14042583.64	2457067.02
PC	RAMPO-3	20+98.28	14042711.74	2456863.52
PI	RAMPO-3	22+11.53	14042772.07	2456767.68
PT	RAMPO-3	23+02.74	14042716.91	2456668.76
POT		24+23.97	14042657.87	2456562.87

RAMP P				
POINT	CURVE	STATION	NORTHING	EASTING
POT		15+00.00	14041351.05	2456659.29
PC	RAMPP-1	16+90.04	14041506.58	2456550.08
PI	RAMPP-1	18+60.32	14041645.93	2456452.23
PT	RAMPP-1	19+51.32	14041734.93	2456397.39
PC	RAMPP-2	21+04.96	14041815.23	2456283.37
PI	RAMPP-2	23+33.57	14041934.72	2456232.27
PCC	RAMPP-2, RAMPP-3	25+61.92	14042069.97	245707.59
PI	RAMPP-3	29+84.93	14042320.24	2457448.62
PCC	RAMPP-3, RAMPP-4	34+02.41	14042655.04	2457707.17
PT	RAMPP-4	35+16.42	14042745.29	2457776.85
PI	RAMPP-4	36+30.23	14042842.35	2457836.68
POT		37+24.71	14042922.78	2457886.25

EXCHANGE AVENUE				
POINT	CURVE	STATION	NORTHING	EASTING
POT		10+00.00	14042766.16	2456456.52
POT		27+42.42	14041523.02	2457677.43

* THREE-POINT TIE SET FOR THIS POINT

