

SEE DRAWING EL-07

NOTES:

- SEE DRAWING ME-01 FOR ELECTRICAL SYMBOLS AND ABBREVIATIONS.
- THE EXISTING ROADWAY LIGHTING SYSTEM, WHICH INCLUDES TEMPORARY LIGHTING, SHALL REMAIN IN OPERATION UNTIL THE PROPOSED ROADWAY LIGHTING SYSTEM HAS BEEN INSTALLED, ENERGIZED, TESTED AND ACCEPTED BY THE ENGINEER, UNLESS NOTED OTHERWISE.
- COORDINATE ALL WORK WITH IDOT CONTRACT NOS. 76C49, 76C50, 76C51, 76C52, 76C53, 76C55, 76C75, AND 76C76.
- DISCONNECT THE EXISTING SIGN LIGHTING ELECTRICAL FEED AND REMOVE CABLES BACK TO THE NEAREST SPLICE POINT. SIGN LUMINAIRES AND ALL ELECTRICAL EQUIPMENT MOUNTED TO SIGN STRUCTURE WILL BE REMOVED AS PART OF STRUCTURE.
- REMOVE THE EXISTING CONDUITS AND JUNCTION BOXES ATTACHED TO STRUCTURE MADE OBSOLETE BY THE REMOVAL OF THE HIGH MAST TOWERS. THE CONDUIT REMOVAL SHALL BE PAID FOR UNDER THE "REMOVE EXISTING CONDUIT ATTACHED TO STRUCTURE" PAY ITEM.
- DISCONNECT THE EXISTING SIGN LIGHTING ELECTRICAL FEED AND REMOVE CABLES BACK TO THE NEAREST SPLICE POINT. SIGN LUMINAIRES AND DISCONNECT SWITCH TO REMAIN FOR RECONNECTION TO THE PROPOSED LIGHTING CIRCUIT SHOWN ON RL-03.

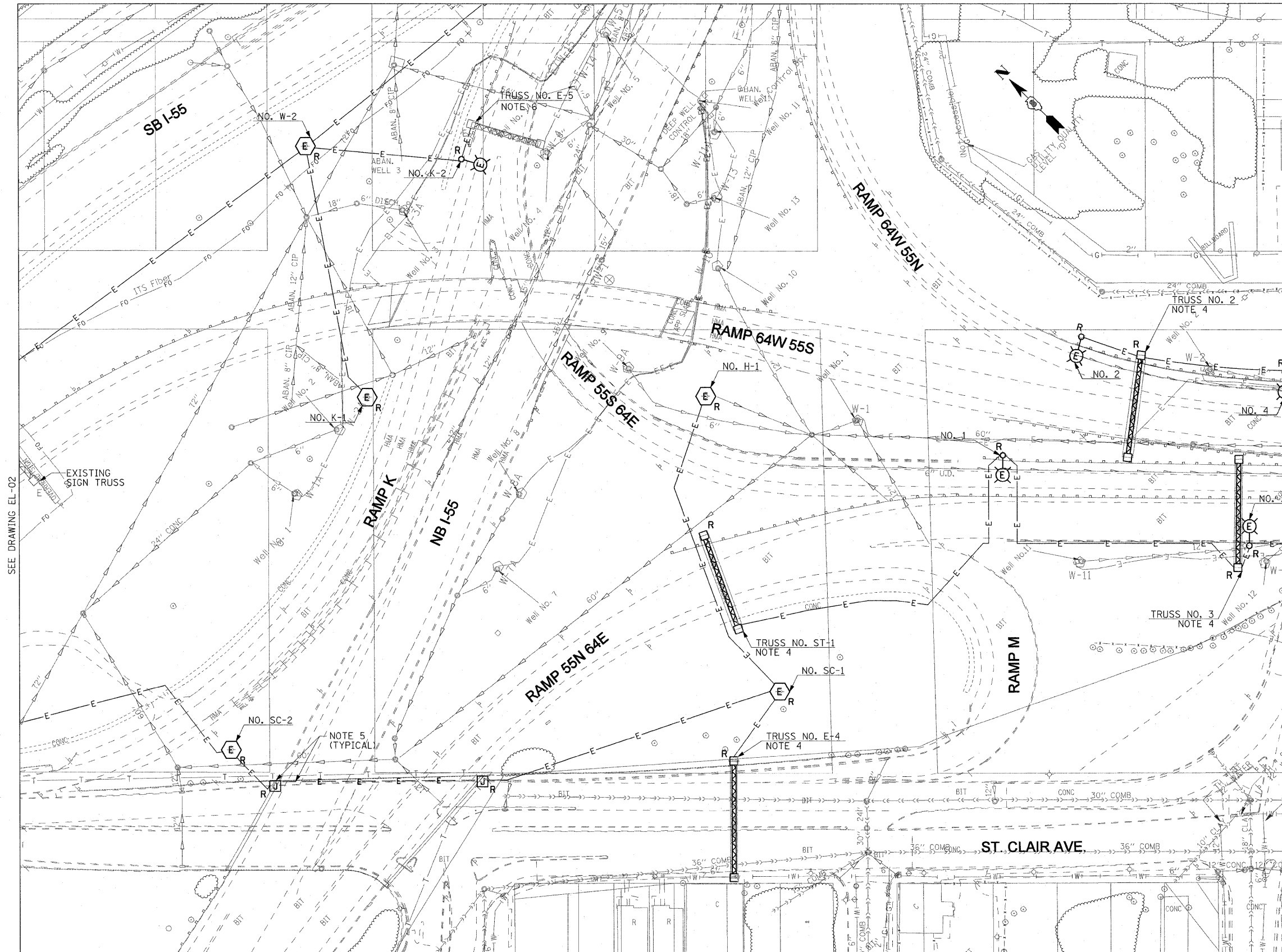

SEE DRAWING EL-02

SEE DRAWING EL-04

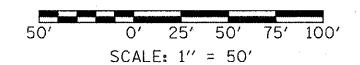

EL-03

FILE NAME = \$FILE#	USER NAME = lertzt	DESIGNED - WDS	REVISED -	STATE OF ILLINOIS DEPARTMENT OF TRANSPORTATION	LIGHTING PLANS EXISTING CONDITIONS AND DEMOLITION			F.A.I. RTE. 55/64	SECTION 82-1L	COUNTY ST. CLAIR	TOTAL SHEETS 60	SHEET NO. 39
	PLOT SCALE = 50.0001' / IN.	DRAWN - TL	REVISED -		SCALE: 1"=50'	SHEET NO. 2 OF 8 SHEETS	STA. 65+97.00 TO STA. 27+90.81	FED. ROAD DIST. NO.	ILLINOIS FED. AID PROJECT	CONTRACT NO. 76C54		
	PLOT DATE = 12/30/2010	CHECKED - JPC	REVISED -									
		DATE - JANUARY 4, 2011	REVISED -									