

NORTHBOUND I-57 FRANKLIN COUNTY REST AREA SIGN

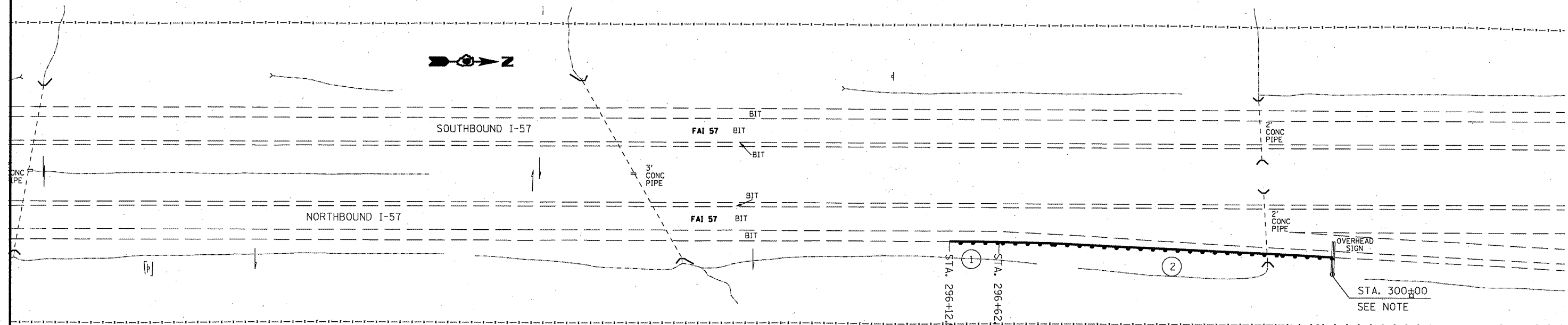

- ① TRAFFIC BARRIER TERMINAL, TYPE 1 (SPECIAL) TANGENT
- ② STEEL PLATE BEAM GUARDRAIL, TYPE A, 6 FOOT POSTS

STATION 300+00 IS A PROJECT SPECIFIC STATION SET FOR DESIGN AND CONSTRUCTION PURPOSE. IT INCREASES TO THE NORTH AND IS ALONG THE CENTERLINE OF NB I-57.

SIGN "0"

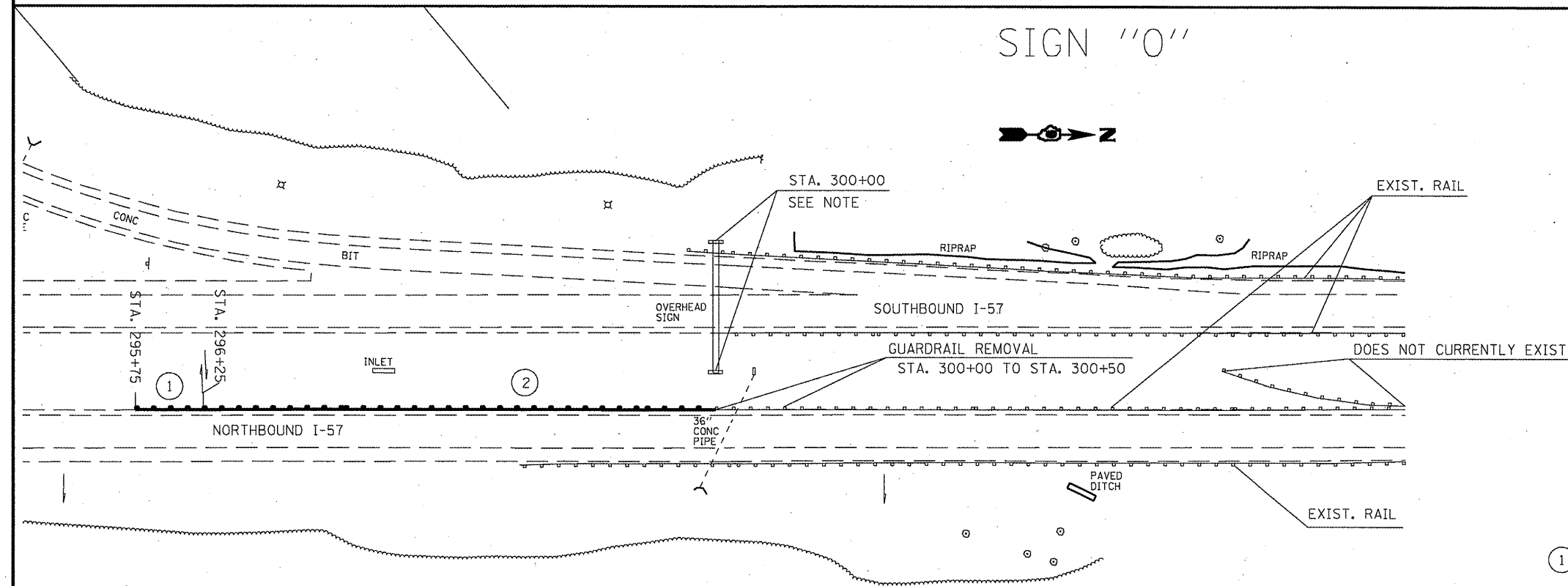

- ① TRAFFIC BARRIER TERMINAL, TYPE 1 (SPECIAL) TANGENT
- ② STEEL PLATE BEAM GUARDRAIL, TYPE A, 6 FOOT POSTS

STATION 300+00 IS A PROJECT SPECIFIC STATION SET FOR DESIGN AND CONSTRUCTION PURPOSE. IT INCREASES TO THE NORTH AND IS ALONG THE CENTERLINE OF NB I-57.

FILE NAME =	USER NAME = shepardgd	DESIGNED - ---	REVISED - ---	STATE OF ILLINOIS DEPARTMENT OF TRANSPORTATION	GUARDRAIL PLAN SHEET	F.A. RTE. -	SECTION	COUNTY	TOTAL SHEETS	SHEET NO.	
cr:\pwwork\pwwork\shepardgd\0239675\78228-shr-misc.dgn	228-shr-misc.dgn	DRAWN - ---	REVISED - ---			VAR	D9 SAFETY 2011-1	VARIJUS	165	31	
PLOT SCALE = 1/8" = 1' IN.	DATE - ---	CHECKED - ---	REVISED - ---			SCALE: _____ SHEET NO. ____ OF ____ SHEETS STA. _____ TO STA. _____		CONTRACT NO. 78228			
PLOT DATE = 3/4/2011	DATE - ---	REVISED - ---	REVISED - ---			ILLINOIS FED. AID PROJECT					