

NOTES:

LIMITS OF SIDEWALK REMOVAL AND PCC SIDEWALK ARE ESTIMATED AND SHALL BE ADJUSTED IN THE FIELD.

STATIONING IS APPROXIMATE.

ONE R10-4BL SIGN PANEL AND ONE R10-4BR SIGN PANEL TO BE PROVIDED AT EACH PUSH BUTTON LOCATION.

CONDUIT SPLICES IN THE NORTHEAST AND SOUTHEAST QUADS SHALL BE INCLUDED IN THE COST OF THE CONDUIT.

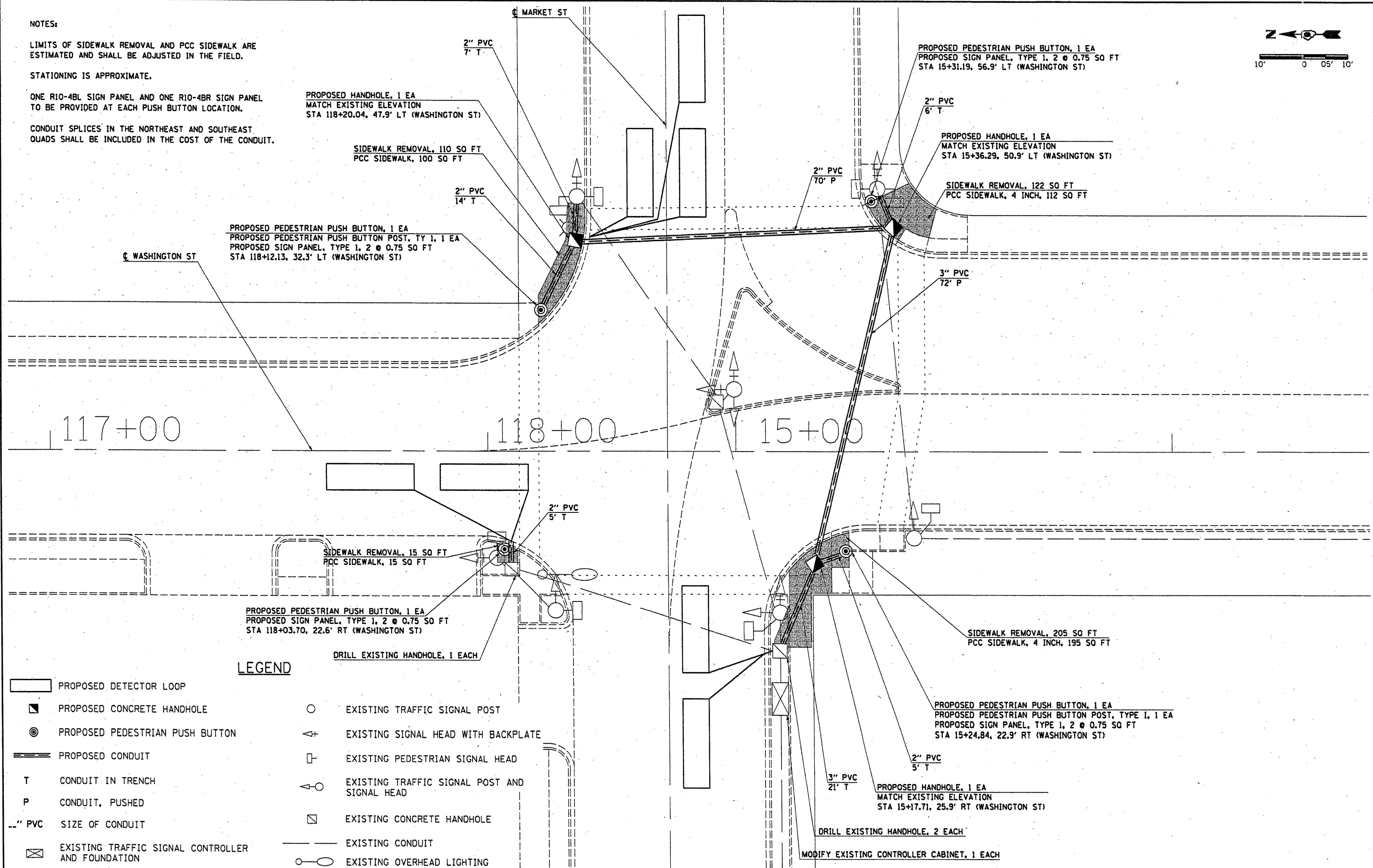
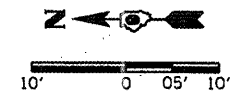

LEGEND

- ▭ PROPOSED DETECTOR LOOP
- PROPOSED CONCRETE HANDHOLE
- ⊙ PROPOSED PEDESTRIAN PUSH BUTTON
- ══ PROPOSED CONDUIT
- T CONDUIT IN TRENCH
- P CONDUIT, PUSHED
- " PVC SIZE OF CONDUIT
- ⊠ EXISTING TRAFFIC SIGNAL CONTROLLER AND FOUNDATION
- EXISTING TRAFFIC SIGNAL POST
- ⊕ EXISTING SIGNAL HEAD WITH BACKPLATE
- ⊠ EXISTING PEDESTRIAN SIGNAL HEAD
- ⊕ EXISTING TRAFFIC SIGNAL POST AND SIGNAL HEAD
- ▭ EXISTING CONCRETE HANDHOLE
- EXISTING CONDUIT
- EXISTING OVERHEAD LIGHTING

FILE NAME =	USER NAME = pswl	DESIGNED -	REVISED -
c:\pw_work\pmdot\pswl\d0253853\78235-	ht-plan.dgn	DRAWN -	REVISED -
	PLOT SCALE = 28.8244' / IN.	CHECKED -	REVISED -
	PLOT DATE = 3/7/2011	DATE -	REVISED -

**STATE OF ILLINOIS
DEPARTMENT OF TRANSPORTATION**

**TRAFFIC SIGNALS
MARKET ST AND WASHINGTON ST**

SCALE: 1"=10' SHEET NO. OF SHEETS STA. TO STA.

F.A. RTE.	SECTION	COUNTY	TOTAL SHEETS	SHEET NO.
*	D9 CM TRAFFIC SIGNAL 2011-1	HAMILTON	9	4
CONTRACT NO. 78235			ILLINOIS FED. AID PROJECT	

* FAP 849 / FAP 776 / CS 3100B