

STATE OF ILLINOIS  
DEPARTMENT OF TRANSPORTATION  
DIVISION OF HIGHWAYS

**PROPOSED  
HIGHWAY PLANS**

IL 142 / WASHINGTON ST (FAP 776)

SECTION D9 CM TRAFFIC SIGNAL 2011-1  
TRAFFIC SIGNAL MODERNIZATION  
HAMILTON COUNTY  
C-99-014-11

| F.A. RTE.                      | SECTION                     | COUNTY   | TOTAL SHEETS | SHEET NO. |
|--------------------------------|-----------------------------|----------|--------------|-----------|
| #                              | D9 CM TRAFFIC SIGNAL 2011-1 | HAMILTON | 9            | 1         |
| ILLINOIS CONTRACT NO. 78235    |                             |          |              |           |
| * FAP 849 / FAP 776 / CS 3100B |                             |          |              |           |

FOR INDEX OF SHEETS, SEE SHEET NO. 2  
FOR SUMMARY OF QUANTITIES, SEE SHEET NO. 3

**TRAFFIC DATA**

IL 142 / MARKET AND IL 142 / WASHINGTON

NORTH 3650 (2009) 8% TRUCKS  
SOUTH 3600 (2009) 5% TRUCKS  
EAST 3400 (2009) 5% TRUCKS  
WEST 3450 (2009) 8% TRUCKS

IL 142 / MARKET AND MAIN ST

NORTH 3600 (2009) 5% TRUCKS  
SOUTH 3600 (2009) 5% TRUCKS  
EAST 325 (2007) 3% TRUCKS  
WEST 850 (2007) 3% TRUCKS

D-99-012-11

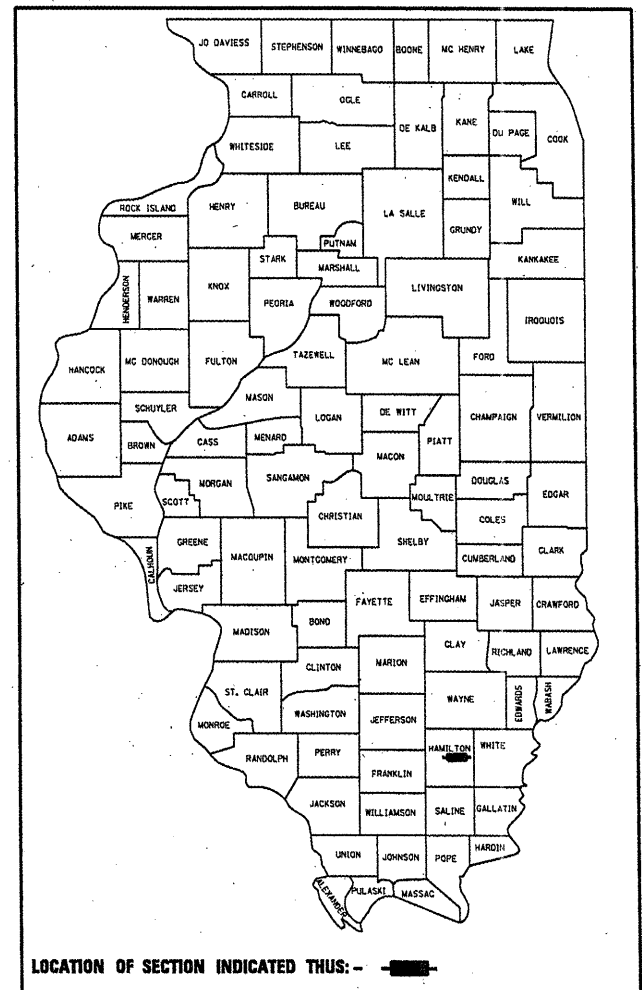

IL 142/MARKET ST (FAP 776/FAP 849)  
IL 142/WASHINGTON ST (FAP 776)

IL 142/WASHINGTON ST (FAP 776)  
MAIN ST (CS 3100B)

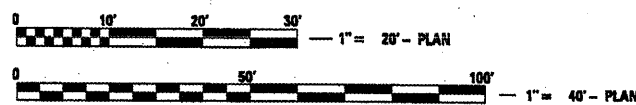

FULL SIZE PLANS HAVE BEEN PREPARED USING STANDARD ENGINEERING SCALES. REDUCED SIZED PLANS WILL NOT CONFORM TO STANDARD SCALES. IN MAKING MEASUREMENTS ON REDUCED PLANS, THE ABOVE SCALES MAY BE USED.

J.U.L.I.E.  
JOINT UTILITY LOCATION INFORMATION FOR EXCAVATION  
1-800-892-0123  
OR 811

PROJECT ENGINEER SUSAN POE  
PROJECT MANAGER SUSAN POE

CONTRACT NO. 78235

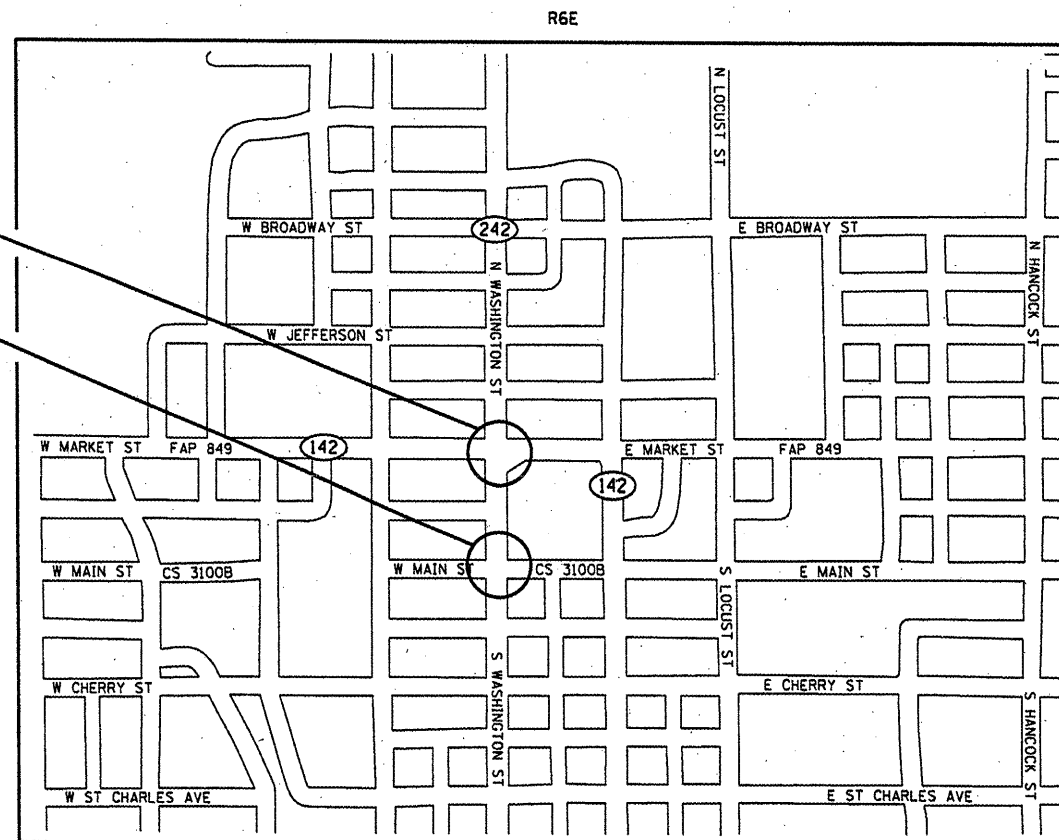

T55

STATE OF ILLINOIS  
DEPARTMENT OF TRANSPORTATION  
DIVISION OF HIGHWAYS

SUBMITTED March 18, 2011  
Mary C. Janice  
DEPUTY DIRECTOR OF HIGHWAYS, REGION I ENGINEER

May 13, 2011  
Scott E. Stitt, P.E.  
actg ENGINEER OF DESIGN AND ENVIRONMENT

May 13, 2011  
Christine M. Reed  
DIRECTOR OF HIGHWAYS, CHIEF ENGINEER

PRINTED BY THE AUTHORITY  
OF THE STATE OF ILLINOIS

**INDEX OF SHEETS**

- 1 COVER SHEET
- 2 GENERAL NOTES, INDEX OF SHEETS, STANDARDS
- 3 SUMMARY OF QUANTITIES
- 4 TRAFFIC SIGNALS - MARKET ST AND WASHINGTON ST
- 5 TRAFFIC SIGNAL CABLE DIAGRAM - MARKET ST AND WASHINGTON ST
- 6 TRAFFIC SIGNALS - MAIN ST AND WASHINGTON ST
- 7 TRAFFIC SIGNAL CABLE DIAGRAM - MAIN ST AND WASHINGTON ST
- 8 PHASE DESIGNATION DIAGRAM
- 9 DETAIL: DETECTOR LOOP DETAIL

**STANDARDS**

- 000001-06 STANDARD SYMBOLS, ABBREVIATIONS & PATTERNS
- 001006 DECIMAL OF AN INCH AND OF A FOOT
- 424001-05 CURB RAMPS FOR SIDEWALKS
- 701001-02 OFF-ROAD OPERATIONS, 2L, 2W, MORE THAN 15' AWAY
- 701006-03 OFF-ROAD OPERATIONS, 2L, 2W, MORE THAN 15' TO 24" FROM PAVEMENT EDGE
- 701101-02 OFF-ROAD OPERATIONS, MULTILANE, 15' TO 24" FROM PAVEMENT EDGE
- 701106-02 OFF-ROAD OPERATIONS, MULTILANE, MORE THAN 15' AWAY
- 701701-07 URBAN LANE CLOSURE, MULTILANE INTERSECTION
- 701801-04 LANE CLOSURE MULTILANE 1W OR 2W CROSSWALK OR SIDEROAD CLOSURE
- 701901-01 TRAFFIC CONTROL DEVICES
- 720001-01 SIGN PANEL MOUNTING DETAILS
- 814001-02 HANDHOLES
- 857001-01 STANDARD PHASE DESIGNATION DIAGRAMS AND PHASE SEQUENCES
- 876001-01 PEDESTRIAN PUSH BUTTON POST
- 886001-01 DETECTOR LOOP INSTALLATIONS
- 886006-01 TYPICAL LAYOUT FOR DETECTOR LOOPS

**GENERAL NOTES**

ALL NON-ESSENTIAL ELECTRIC CABLE SHALL BE REMOVED FROM EXISTING CONDUIT THAT IS TO BE REUSED FOR INSTALLATION OF PROPOSED ELECTRIC CABLE. THIS WORK WILL BE CONSIDERED INCLUDED IN THE PROPOSED ELECTRIC CABLE PAY ITEM.

ALL PEDESTRIAN PUSH-BUTTON POSTS SHALL BE EQUIPPED WITH TWO DIRECTIONAL SIGNS (R10-4A).

ALL ELECTRIC CABLE AND CONDUIT QUANTITIES ARE ROUNDED UP TO THE NEAREST 5 FEET.

THE FURNISHING AND INSTALLATION OF THE 1/4 INCH CONDUIT WITH ITS TRENCHING AND BACKFILL FROM THE LOOP SAWCUT TO THE SPLICE POINT SHALL BE INCLUDED IN THE LOOP INSTALLATION UNLESS SHOWN OTHERWISE ON THE PLANS.

THE INDUCTION LOOP WIRE AND LEAD-IN WIRE SHALL BE INSTALLED IN ACCORDANCE WITH THE MANUFACTURER'S RECOMMENDATION.

SHIELDED CABLE TO LOOP LEADS SHALL BE GROUNDED AT THE CONTROLLER TERMINAL ONLY.

ALL DETECTOR LOOP CORNERS SHALL BE CORE DRILLED 2 INCHES MINIMUM DIAMETER EXCEPT THOSE PLACED UNDER RESURFACING. THE DETECTOR LOOP CORNERS PLACED UNDER RESURFACING SHALL BE DIAGONALLY SAWCUT.

CABLE QUANTITIES ARE MEASURED IN PLAN VIEW.

SAWED SLOTS FOR TWISTED PAIR ELECTRIC CABLES SHALL BE LARGER THAN SINGLE CONDUCTOR LOOP SLOTS.

THE FINAL LOCATION OF THE DETECTOR LOOPS AND TRAFFIC SIGNAL FOUNDATIONS AS SHOWN ON THE PLANS MAY BE ADJUSTED TO FIT FIELD CONDITIONS AS DIRECTED BY THE ENGINEER OF TRAFFIC OPERATIONS.

**COMMITMENTS**

NONE

Prepared By: *Gregory Ambrosio*  
DISTRICT STUDIES & PLANS ENGINEER

Examined By: *John L. Eng*  
DISTRICT LAND ACQUISITION ENGINEER

Examined By: *Cornie Nelson*  
DISTRICT PROGRAM DEVELOPMENT ENGINEER

Examined By: *Carl H. H.*  
DISTRICT OPERATIONS ENGINEER

Examined By: *[Signature]*  
DISTRICT CONSTRUCTION ENGINEER

Examined By: *Bruce W. Peckles*  
DISTRICT MATERIALS ENGINEER

Approved By: *Mary C. Janis*  
DEPUTY DIRECTOR OF HIGHWAYS, REGION 5 ENGINEER  
MARCH 18 20 11  
DATE

|  |                              |            |           |
|--|------------------------------|------------|-----------|
| FILE NAME =  | USER NAME = poosl            | DESIGNED - | REVISED - |
| ca:\pwwork\pwwork\poosl\d0293853\78235-ht-plan.dgn |                              | DRAWN -    | REVISED - |
|  | PLOT SCALE = 1/8" = 1' / IN. | CHECKED -  | REVISED - |
|  | PLOT DATE = 3/7/2011         | DATE -     | REVISED - |

STATE OF ILLINOIS  
DEPARTMENT OF TRANSPORTATION

GENERAL NOTES, INDEX OF SHEETS  
AND STANDARDS

| F.A.P. RTE.               | SECTION                  | COUNTY   | TOTAL SHEETS | SHEET NO. |
|---------------------------|--------------------------|----------|--------------|-----------|
| * 09                      | CM TRAFFIC SIGNAL 2011-1 | HAMILTON | 9            | 2         |
| CONTRACT NO. 78235        |                          |          |              |           |
| ILLINOIS FED. AID PROJECT |                          |          |              |           |

**SUMMARY OF QUANTITIES**

| CODE NUMBER | ITEM  | CONSTRUCTION TYPE CODE | TOTAL QUANTITIES | 100% STATE 0021                        |                                      |
|-------------|---|------------------------|------------------|--|--------------------------------------|
|             |   | ITEM                   |                  | MARKET ST AND WASHINGTON ST 100% STATE | MAIN ST AND WASHINGTON ST 100% STATE |
| 42400100    | PORTLAND CEMENT CONCRETE SIDEWALK 4 INCH          | SQ FT                  | 588              | 422                                    | 166                                  |
| 44000600    | SIDEWALK REMOVAL                                  | SQ FT                  | 618              | 452                                    | 166                                  |
| 67100100    | MOBILIZATION                                      | L SUM                  | 1                | 0.5                                    | 0.5                                  |
| 70102635    | TRAFFIC CONTROL AND PROTECTION, STANDARD 701701   | L SUM                  | 1                | 0.5                                    | 0.5                                  |
| 70102640    | TRAFFIC CONTROL AND PROTECTION, STANDARD 701801   | L SUM                  | 1                | 0.5                                    | 0.5                                  |
| 72000100    | SIGN PANEL, TYPE 1                                | SQ FT                  | 12               | 6                                      | 6                                    |
| 80300100    | LOCATING UNDERGROUND CABLE                        | FOOT                   | 25               | 15                                     | 10                                   |
| 81012600    | CONDUIT IN TRENCH, 2" DIA., PVC                   | FOOT                   | 37               | 37                                     |                                      |
| 81012800    | CONDUIT IN TRENCH, 3" DIA., PVC                   | FOOT                   | 21               | 21                                     |                                      |
| 81021330    | CONDUIT PUSHED, 2" DIA., PVC                      | FOOT                   | 134              | 70                                     | 64                                   |
| 81021350    | CONDUIT PUSHED, 3" DIA., PVC                      | FOOT                   | 72               | 72                                     |                                      |
| 81400100    | HANDHOLE  | EACH                   | 3                | 3                                      |                                      |
| 81900200    | TRENCH AND BACKFILL FOR ELECTRICAL WORK           | FOOT                   | 58               | 58                                     |                                      |
| 87301215    | ELECTRIC CABLE IN CONDUIT, SIGNAL NO. 14 2C       | FOOT                   | 955              | 505                                    | 450                                  |
| 87301245    | ELECTRIC CABLE IN CONDUIT, SIGNAL NO. 14 5C       | FOOT                   | 145              | 145                                    |                                      |
| 87301255    | ELECTRIC CABLE IN CONDUIT, SIGNAL NO. 14 7C       | FOOT                   | 145              | 145                                    |                                      |
| 87301305    | ELECTRIC CABLE IN CONDUIT, LEAD-IN, NO. 14 1 PAIR | FOOT                   | 558              | 495                                    | 63                                   |
| 87600100    | PEDESTRIAN PUSH-BUTTON POST, TYPE I               | EACH                   | 2                | 2                                      |                                      |
| 87900200    | DRILL EXISTING HANDHOLE                           | EACH                   | 6                | 3                                      | 3                                    |
| 88500100    | INDUCTIVE LOOP DETECTOR                           | EACH                   | 5                | 4                                      | 1                                    |
| 88600100    | DETECTOR LOOP, TYPE 1                             | FOOT                   | 650              | 509                                    | 141                                  |
| 88800100    | PEDESTRIAN PUSH BUTTON                            | EACH                   | 8                | 4                                      | 4                                    |
| 89502210    | MODIFY EXISTING CONTROLLER CABINET                | EACH                   | 2                | 1                                      | 1                                    |

|   |                               |            |           |   |                              |           |           |      |                               |          |        |              |           |
|---|-------------------------------|------------|-----------|---|------------------------------|-----------|-----------|------|-------------------------------|----------|--------|--------------|-----------|
| FILE NAME =                                   | USER NAME = poe1              | DESIGNED - | REVISED - | <b>STATE OF ILLINOIS<br/>DEPARTMENT OF TRANSPORTATION</b> | <b>SUMMARY OF QUANTITIES</b> |           |           |      | F.A. RTE.                     | SECTION  | COUNTY | TOTAL SHEETS | SHEET NO. |
| c:\pwork\pwork\poe1\0253853\78235-ht-plan.dgn | PLOT SCALE = 1/32" = 1' / IN. | DRAWN -    | REVISED - |   |                              |           |           |      | * 09 CM TRAFFIC SIGNAL 2011-1 | HAMILTON | 9      | 3            |           |
| PLOT DATE = 3/7/2011                          | DATE -                        | CHECKED -  | REVISED - |   | CONTRACT NO. 78235           |           |           |      | ILLINOIS FED. AID PROJECT     |          |        |              |           |
|   |                               |            |           |   | SCALE:                       | SHEET NO. | OF SHEETS | STA. | TO STA.                       |          |        |              |           |

**NOTES:**

LIMITS OF SIDEWALK REMOVAL AND PCC SIDEWALK ARE ESTIMATED AND SHALL BE ADJUSTED IN THE FIELD.

STATIONING IS APPROXIMATE.

ONE R10-4BL SIGN PANEL AND ONE R10-4BR SIGN PANEL TO BE PROVIDED AT EACH PUSH BUTTON LOCATION.

CONDUIT SPLICES IN THE NORTHEAST AND SOUTHEAST QUADS SHALL BE INCLUDED IN THE COST OF THE CONDUIT.

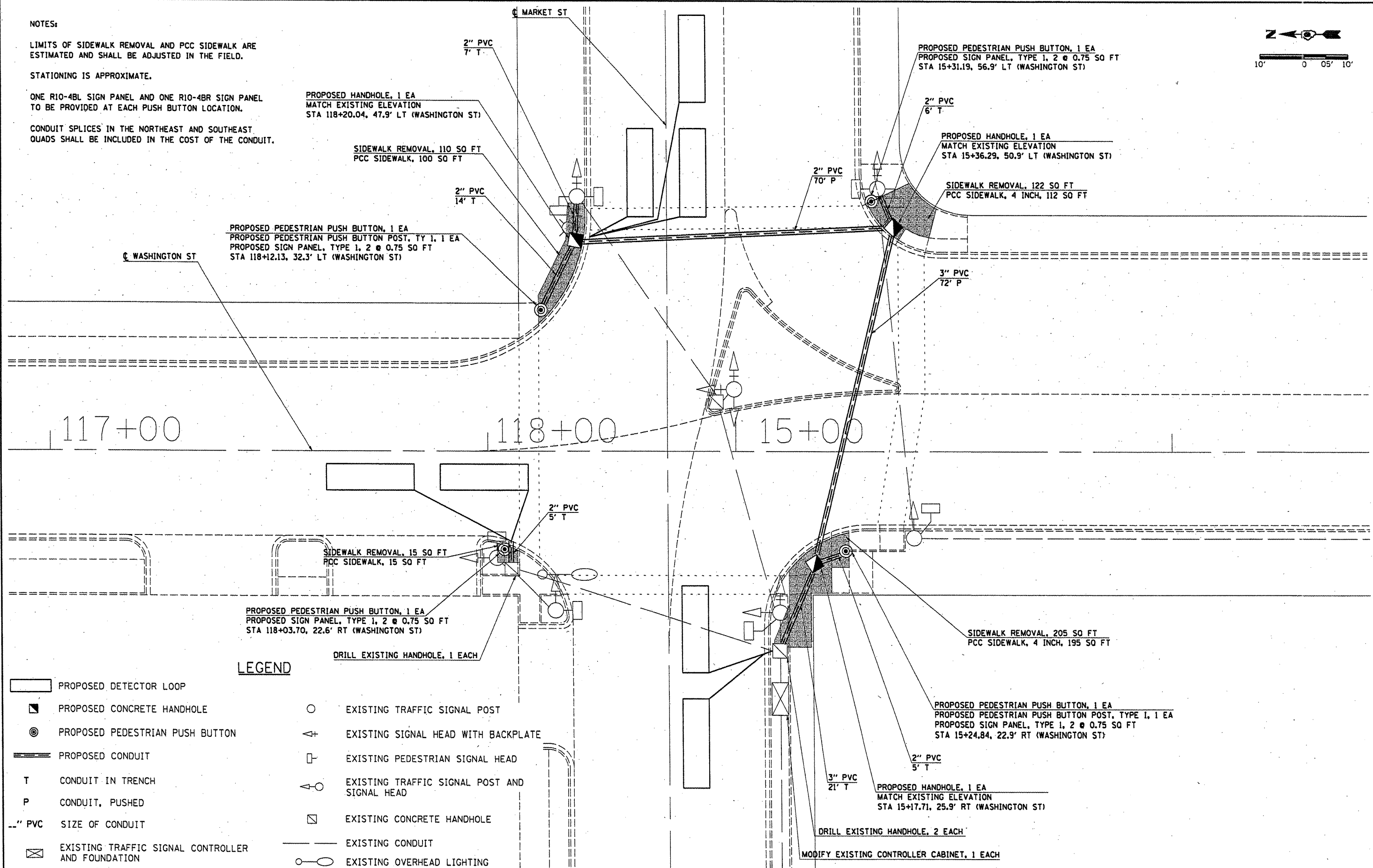
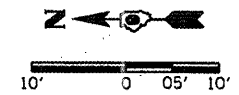

**LEGEND**

- ▭ PROPOSED DETECTOR LOOP
- PROPOSED CONCRETE HANDHOLE
- ⊙ PROPOSED PEDESTRIAN PUSH BUTTON
- ══ PROPOSED CONDUIT
- T CONDUIT IN TRENCH
- P CONDUIT, PUSHED
- " PVC SIZE OF CONDUIT
- ⊠ EXISTING TRAFFIC SIGNAL CONTROLLER AND FOUNDATION
- EXISTING TRAFFIC SIGNAL POST
- ⊕ EXISTING SIGNAL HEAD WITH BACKPLATE
- ⊠ EXISTING PEDESTRIAN SIGNAL HEAD
- ⊕ EXISTING TRAFFIC SIGNAL POST AND SIGNAL HEAD
- ▭ EXISTING CONCRETE HANDHOLE
- EXISTING CONDUIT
- EXISTING OVERHEAD LIGHTING

|                                       |                             |            |           |
|---------------------------------------|-----------------------------|------------|-----------|
| FILE NAME =                           | USER NAME = psw1            | DESIGNED - | REVISED - |
| c:\pw_work\pndot\psw1\d0253853\78235- | ht-plan.dgn                 | DRAWN -    | REVISED - |
|                                       | PLOT SCALE = 28.8244' / IN. | CHECKED -  | REVISED - |
|                                       | PLOT DATE = 3/7/2011        | DATE -     | REVISED - |

**STATE OF ILLINOIS  
DEPARTMENT OF TRANSPORTATION**

**TRAFFIC SIGNALS  
MARKET ST AND WASHINGTON ST**

SCALE: 1"=10' SHEET NO. OF SHEETS STA. TO STA.

| F.A. RTE.          | SECTION                     | COUNTY   | TOTAL SHEETS              | SHEET NO. |
|--------------------|-----------------------------|----------|---------------------------|-----------|
| *                  | D9 CM TRAFFIC SIGNAL 2011-1 | HAMILTON | 9                         | 4         |
| CONTRACT NO. 78235 |                             |          | ILLINOIS FED. AID PROJECT |           |

\* FAP 849 / FAP 776 / CS 3100B

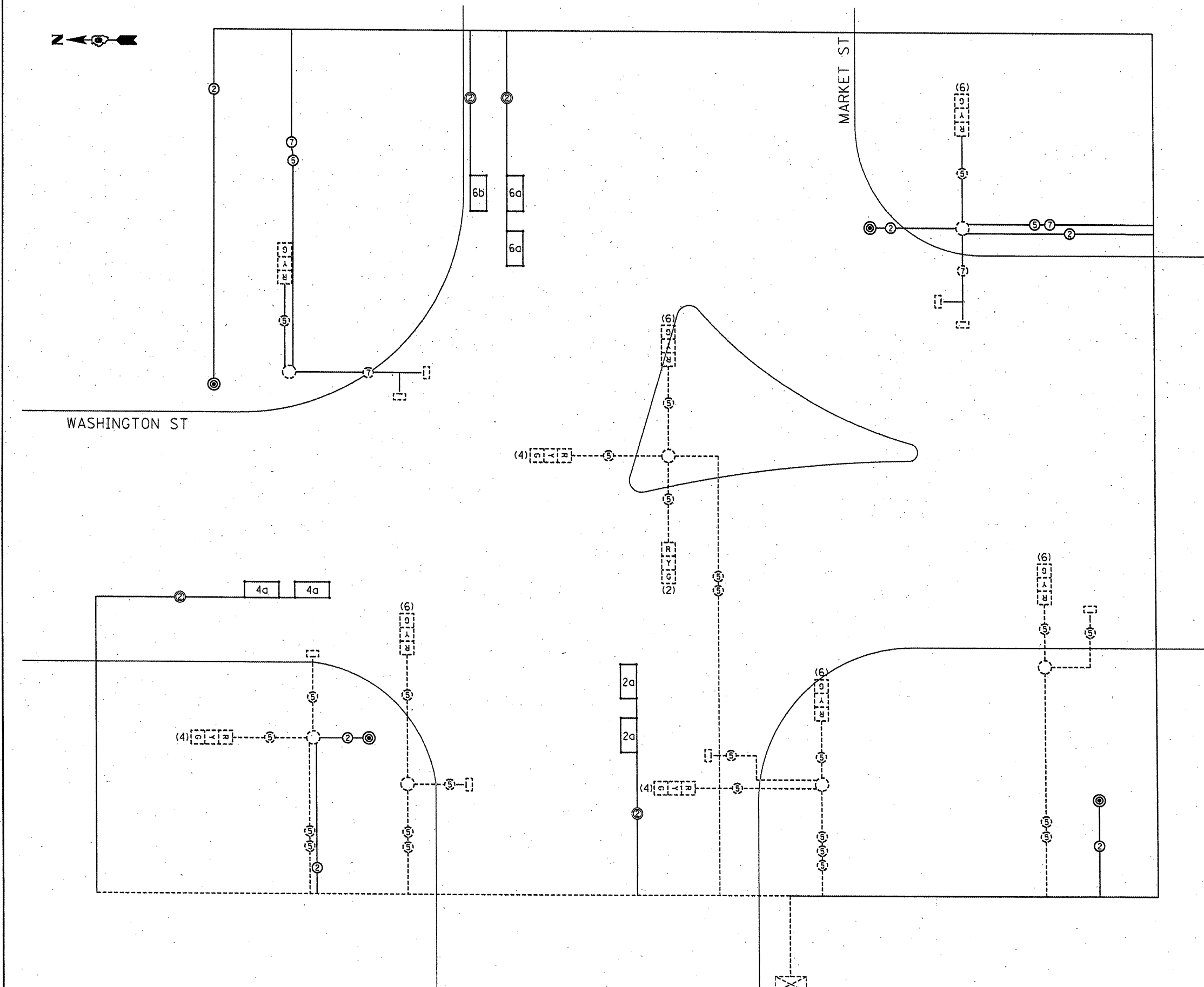

|  |                   |            |           |
|--|-------------------|------------|-----------|
| FILE NAME =  | USER NAME = poosl | DESIGNED - | REVISED - |
| cr:\pw\work\pwidot\poosl\d8253853\78235-ht-pln.dgn |                   | DRAWN -    | REVISED - |
| PLOT SCALE = 3/16" = 1/8" IN.                      |                   | CHECKED -  | REVISED - |
| PLOT DATE = 3/7/2011                               |                   | DATE -     | REVISED - |

**STATE OF ILLINOIS  
DEPARTMENT OF TRANSPORTATION**

**TRAFFIC SIGNAL CABLE DIAGRAM  
MARKET ST AND WASHINGTON ST**

|                               |         |          |                    |           |
|-------------------------------|---------|----------|--------------------|-----------|
| F.A. RTE.                     | SECTION | COUNTY   | TOTAL SHEETS       | SHEET NO. |
| * 09 CM TRAFFIC SIGNAL 2011-1 |         | HAMILTON | 9                  | 5         |
| ILLINOIS FED. AID PROJECT     |         |          | CONTRACT NO. 78235 |           |

SCALE: SHEET NO. OF SHEETS STA. TO STA.

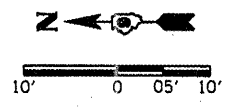

PROPOSED PEDESTRIAN PUSH BUTTON, 1 EA  
 PROPOSED PEDESTRIAN PUSH BUTTON POST, TY 1, 1 EA  
 PROPOSED SIGN PANEL, TYPE 1, 2 @ 0.75 SQ FT  
 STA 18+58.23, 45.3' LT (WASHINGTON ST)

SIDEWALK REMOVAL, 120 SQ FT  
 PCC SIDEWALK, 4 INCH, 120 SQ FT

PROPOSED PEDESTRIAN PUSH BUTTON, 1 EA  
 PROPOSED SIGN PANEL, TYPE 1, 2 @ 0.75 SQ FT  
 STA 19+56.66, 28.1' LT (WASHINGTON ST)

DRILL EXISTING HANDHOLE, 1 EACH

2" PVC  
 64' P

C WASHINGTON ST

20+00

WASHIN

PROPOSED PEDESTRIAN PUSH BUTTON, 1 EA  
 PROPOSED SIGN PANEL, TYPE 1, 2 @ 0.75 SQ FT  
 STA 18+59.54, 20.2' LT (WASHINGTON ST)

PROPOSED PEDESTRIAN PUSH BUTTON, 1 EA  
 PROPOSED SIGN PANEL, TYPE 1, 2 @ 0.75 SQ FT  
 STA 19+61.53, 30.0' LT (WASHINGTON ST)

SIDEWALK REMOVAL, 46 SQ FT  
 PCC SIDEWALK, 4 INCH, 46 SQ FT

DRILL EXISTING HANDHOLE, 2 EACH

MODIFY EXISTING CONTROLLER CABINET, 1 EACH

C MAIN ST

**LEGEND**

- PROPOSED DETECTOR LOOP
- PROPOSED PEDESTRIAN PUSH BUTTON
- PROPOSED CONDUIT
- P CONDUIT, PUSHED
- 2" PVC SIZE OF CONDUIT
- EXISTING TRAFFIC SIGNAL CONTROLLER AND FOUNDATION
- EXISTING TRAFFIC SIGNAL POST
- EXISTING SIGNAL HEAD WITH BACKPLATE
- EXISTING PEDESTRIAN SIGNAL HEAD
- EXISTING TRAFFIC SIGNAL POST AND SIGNAL HEAD
- EXISTING CONCRETE HANDHOLE
- EXISTING CONDUIT
- EXISTING OVERHEAD LIGHTING

**NOTES:**

LIMITS OF SIDEWALK REMOVAL AND PCC SIDEWALK ARE ESTIMATED AND SHALL BE ADJUSTED IN THE FIELD.

STATIONING IS APPROXIMATE.

ONE R10-4BL SIGN PANEL AND ONE R10-4BR SIGN PANEL TO BE PROVIDED AT EACH PUSH BUTTON LOCATION.

|   |                   |            |           |
|---|-------------------|------------|-----------|
| FILE NAME =                                     | USER NAME = poesi | DESIGNED - | REVISED - |
| c:\pwork\pwsdot\poesi\d0253853\78235-ht-pln.dgn |                   | DRAWN -    | REVISED - |
| PLOT SCALE = 20.6244' / IN.                     |                   | CHECKED -  | REVISED - |
| PLOT DATE = 3/7/2011                            |                   | DATE -     | REVISED - |

**STATE OF ILLINOIS  
 DEPARTMENT OF TRANSPORTATION**

**TRAFFIC SIGNALS  
 MAIN ST AND WASHINGTON ST**

SCALE: 1"=10' SHEET NO. OF SHEETS STA. TO STA.

| F.A. RTE.          | SECTION                  | COUNTY   | TOTAL SHEETS | SHEET NO. |
|--------------------|--------------------------|----------|--------------|-----------|
| * 09               | CM TRAFFIC SIGNAL 2011-1 | HAMILTON | 9            | 6         |
| CONTRACT NO. 78235 |                          |          |              |           |

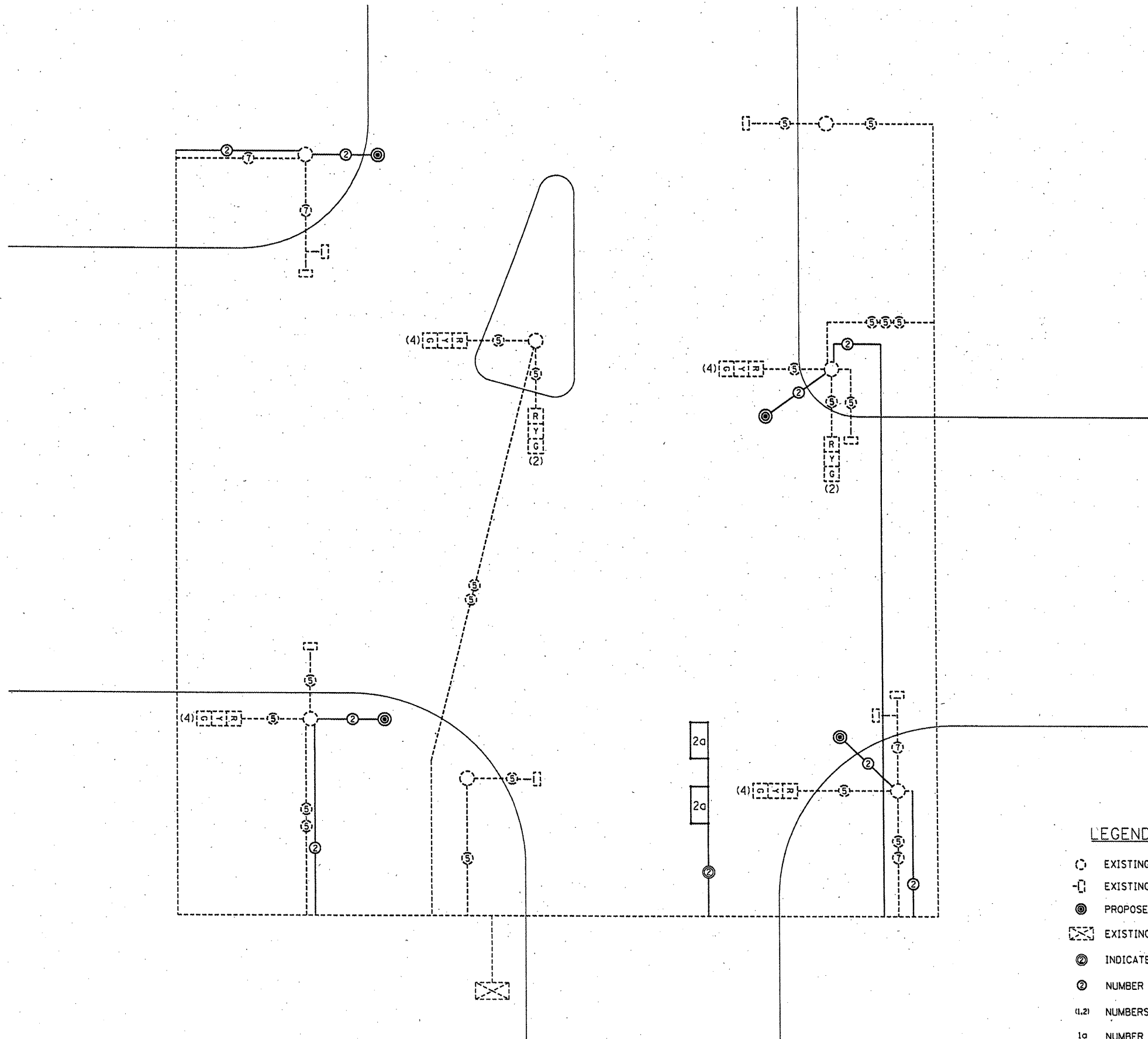

**LEGEND**

- ⊙ EXISTING SIGNAL POST
- EXISTING PEDESTRIAN SIGNAL HEAD
- ⊙ PROPOSED PEDESTRIAN PUSH BUTTON
- ⊠ EXISTING TRAFFIC SIGNAL CONTROLLER CABINET
- ⊙ INDICATES 2/C TWISTED, SHIELDED CABLE IN CONDUIT
- ⊙ NUMBER IN CIRCLE INDICATES NUMBER OF CONDUCTORS IN THAT CABLE
- (1,2) NUMBERS IN PARENTHESIS INDICATES PHASE
- 1a NUMBER INDICATES PHASE; LETTER OR LETTERS IDENTIFY AMPLIFIER

|                                       |                             |            |           |
|---------------------------------------|-----------------------------|------------|-----------|
| FILE NAME =                           | USER NAME = poes1           | DESIGNED - | REVISED - |
| a:\pwwork\p1dot\poes1\08253853\78235- | ht-plan.dgn                 | DRAWN -    | REVISED - |
|                                       | PLOT SCALE = 32.9998' / IN. | CHECKED -  | REVISED - |
|                                       | PLOT DATE = 3/7/2011        | DATE -     | REVISED - |

**STATE OF ILLINOIS  
DEPARTMENT OF TRANSPORTATION**

**TRAFFIC SIGNAL CABLE DIAGRAM  
MAIN ST AND WASHINGTON ST**

SCALE: SHEET NO. OF SHEETS STA. TO STA.

| F.A. RTE.                     | SECTION | COUNTY   | TOTAL SHEETS       | SHEET NO. |
|-------------------------------|---------|----------|--------------------|-----------|
| * 09 CM TRAFFIC SIGNAL 2011-1 |         | HAMILTON | 9                  | 7         |
| ILLINOIS FED. AID PROJECT     |         |          | CONTRACT NO. 78235 |           |

\* FAP 849 / FAP 776 / CS 3100B

### PHASE DESIGNATION DIAGRAM

MARKET ST AND WASHINGTON ST  
CONTROLLER SPECIFIED

REFERRING TO STANDARD 857001, THE  
VEHICULAR AND PEDESTRIAN PHASES  
USED ARE DESIGNATED AS SHOWN.

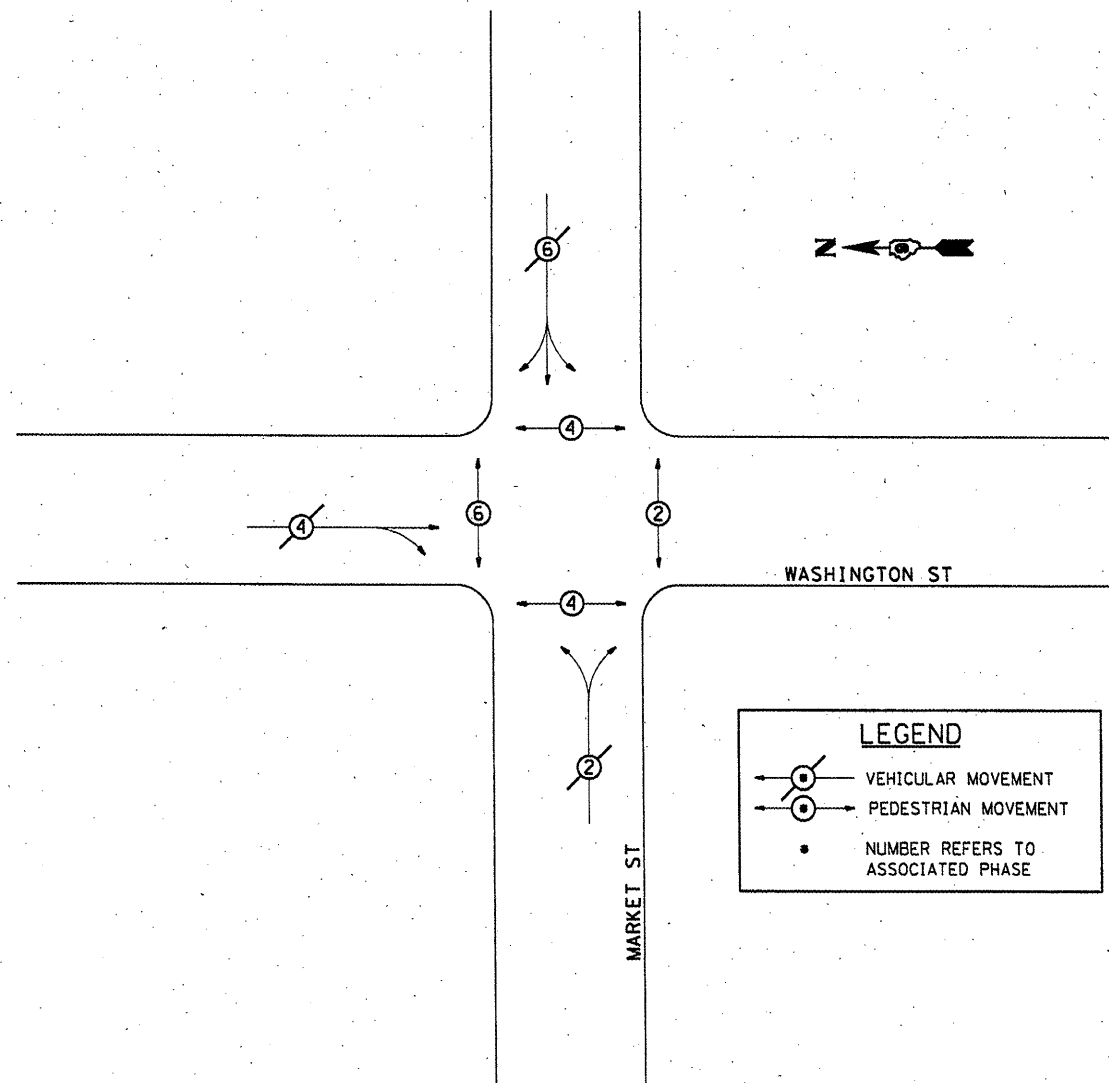

| REVISIONS |          |
|-----------|----------|
| DRAWN     | 1-31-90  |
| REVISD    | 5-30-90  |
| REVISD    | 12-18-01 |
| REVISD    | 3-27-08  |

STD. 9-66

STATE OF ILLINOIS  
DEPARTMENT OF TRANSPORTATION

### PHASE DESIGNATION DIAGRAM

MAIN ST AND WASHINGTON ST  
CONTROLLER SPECIFIED

REFERRING TO STANDARD 857001, THE  
VEHICULAR AND PEDESTRIAN PHASES  
USED ARE DESIGNATED AS SHOWN.

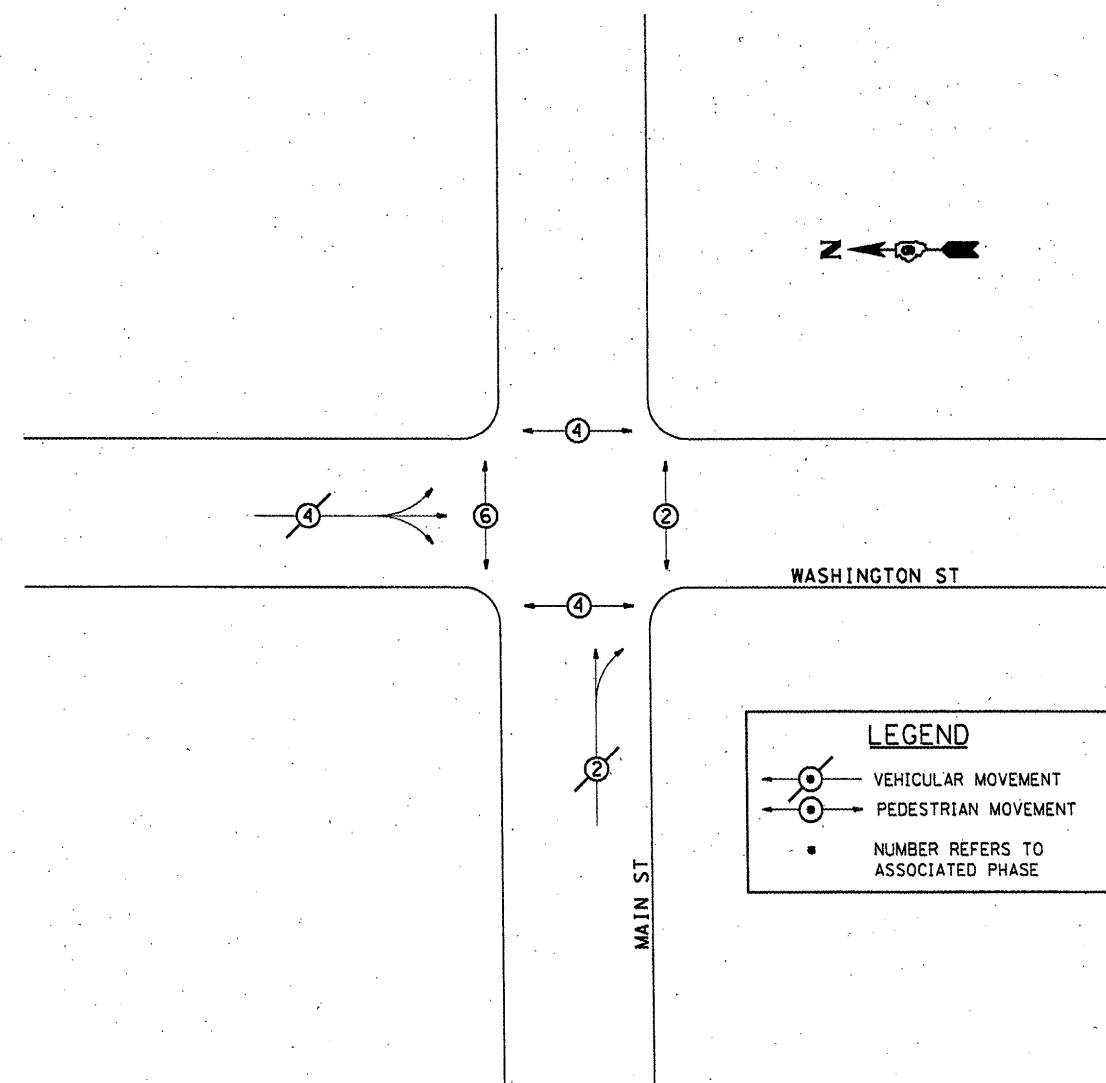

| REVISIONS |          |
|-----------|----------|
| DRAWN     | 1-31-90  |
| REVISD    | 5-30-90  |
| REVISD    | 12-18-01 |
| REVISD    | 3-27-08  |

STD. 9-66

PHASE DESIGNATION DIAGRAM

SCALE: SHEET NO. OF SHEETS STA. TO STA.

| F.A. RTE.          | SECTION                     | COUNTY   | TOTAL SHEETS | SHEET NO. |
|--------------------|-----------------------------|----------|--------------|-----------|
| *                  | D9 CM TRAFFIC SIGNAL 2011-1 | HAMILTON | 9            | 8         |
| CONTRACT NO. 78235 |                             |          |              |           |

ILLINOIS FED. AID PROJECT  
\* FAP 849 / FAP 776 / CS 3100B

|  |                   |            |          |
|--|-------------------|------------|----------|
| FILE NAME =                                  | USER NAME = pces1 | DESIGNED - | REVISD - |
| c:\pwork\pwidot\pces1\0253853\78235-1\plndgn |                   | DRAWN -    | REVISD - |
| PLOT SCALE = 20.6244' / IN.                  |                   | CHECKED -  | REVISD - |
| PLOT DATE = 3/7/2011                         |                   | DATE -     | REVISD - |



