

FILE = S:\PROJECTS\1183010\_10\Dev\less County Bethel\_Road\DESIGN\1183010\BETHEL1.DGN

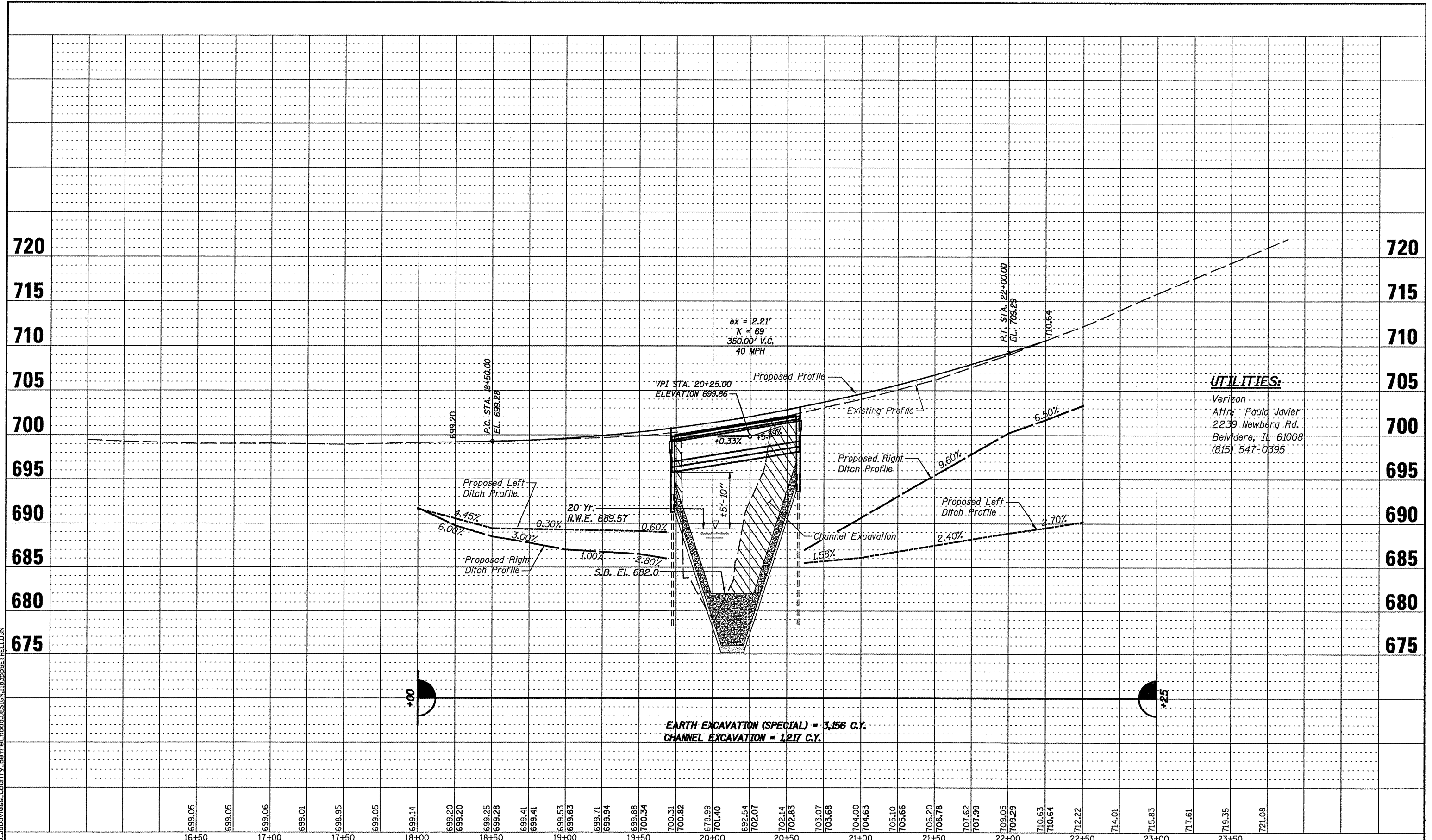

**UTILITIES:**  
 Verizon  
 Attn: Paula Javier  
 2239 Newberg Rd.  
 Belvidere, IL 61008  
 (815) 547-0395

EARTH EXCAVATION (SPECIAL) = 3,156 C.Y.  
 CHANNEL EXCAVATION = 1,217 C.Y.

REV.	DATE	BY	REMARKS

**DRAWN**  
M.P.O.  
**CHECKED**  
D.L.B.  
**APPROVED**  
X.X.X.

**JO DAVIESS COUNTY  
 BRIDGE REPLACEMENT  
 EAST BETHEL ROAD OVER LITTLE RUSH CREEK  
 2011**

**WILLET, HOFMANN & ASSOCIATES, INC.**  
 CONSULTING ENGINEERS  
 Land Surveying - Transportation - Structural  
 Environmental - Architecture  
 800 East Second Street Dixon, Illinois 61021  
 Phone 815.294.3381 Fax 815.294.3385  
 Design Firm #184-000918  
 www.willett.com

**EAST BETHEL ROAD  
 PROFILE VIEW**

**STA. 18+00.00 - STA. 23+30.00**

SECTION	COUNTY	TOTAL SHEETS	SHEET NO.
10-00134-00-BR	JO DAVIESS	34	7
STA. 18+00.00 - STA. 23+30.00			
WHA PROJECT: 1183010		DATE: 1/2011	