

**LEFT EDGE OF APPROACH PAVEMENT**

Location	Station	Offset Lt.	Theoretical Grade Elevations
A	19+43.88	15.00'	699.98
B	19+53.88	15.00'	700.16
C	19+63.88	15.00'	700.35
D	19+73.88	15.00'	700.55

**LEFT EDGE OF TRAFFIC LANE**

Location	Station	Offset Lt.	Theoretical Grade Elevations
A	19+43.35	12.00'	700.03
B	19+53.35	12.00'	700.21
C	19+63.35	12.00'	700.40
D	19+73.35	12.00'	700.60

**CENTERLINE**

Location	Station	Offset	Theoretical Grade Elevations
A	19+41.23	0.00'	700.19
B	19+51.23	0.00'	700.36
C	19+61.23	0.00'	700.54
D	19+71.23	0.00'	700.74

**RIGHT EDGE OF TRAFFIC LANE**

Location	Station	Offset Rt.	Theoretical Grade Elevations
A	19+39.12	12.00'	699.96
B	19+49.12	12.00'	700.13
C	19+59.12	12.00'	700.31
D	19+69.12	12.00'	700.51

**RIGHT EDGE OF APPROACH PAVEMENT**

Location	Station	Offset Rt.	Theoretical Grade Elevations
A	19+38.59	15.00'	699.89
B	19+48.59	15.00'	700.06
C	19+58.59	15.00'	700.24
D	19+68.59	15.00'	700.44

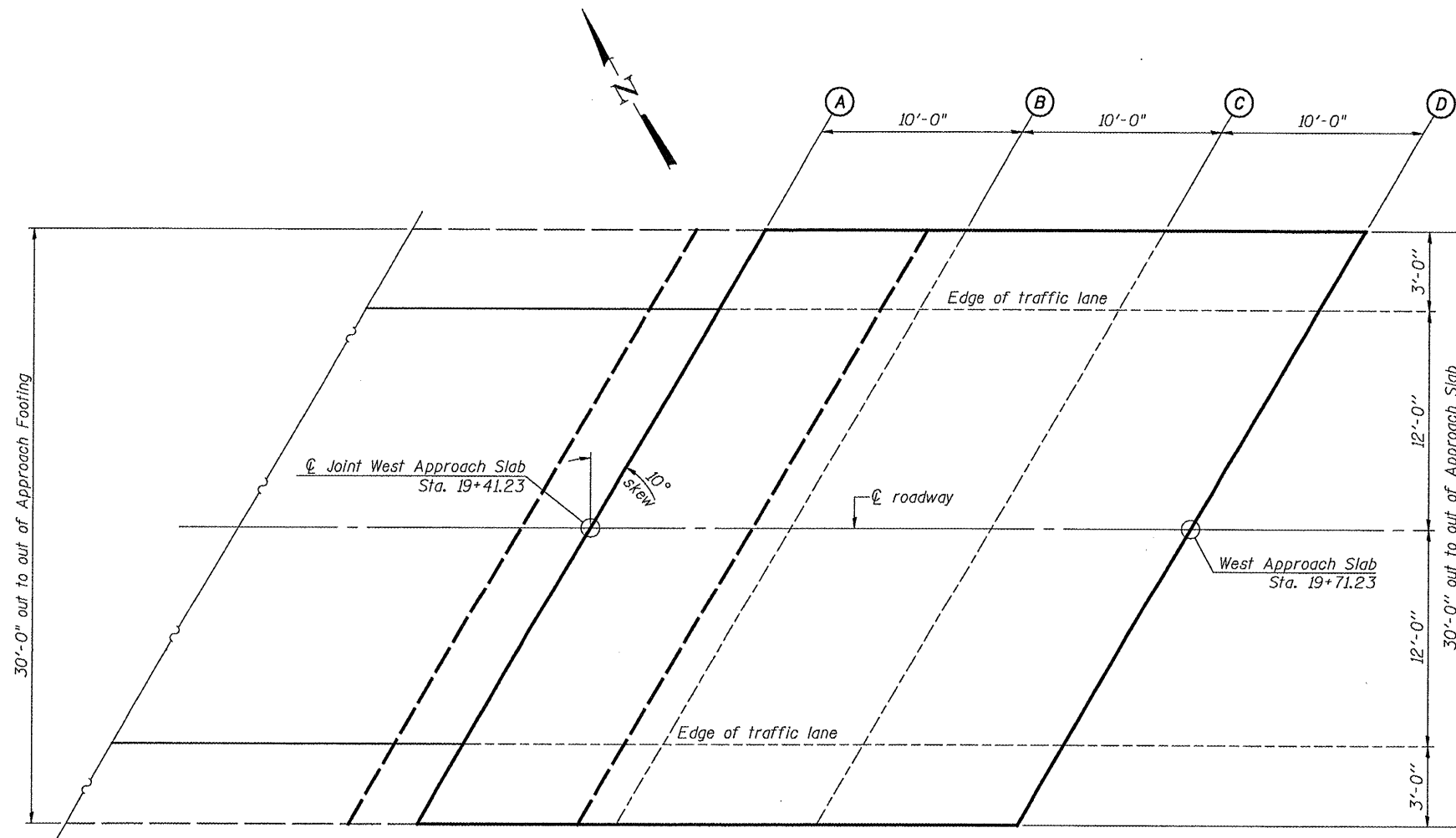

**PLAN**

FILE NAME = S:\PROJECTS\2010\1183D10\JcdDevress\County\Bethel\_Road\DESIGN\STRUCT\Drawings\1183D10\WestAppr-SlabElev.dgn

USER NAME =	DESIGNED - M. C. WAGNER	REVISED -
	CHECKED - B. K. CONVERSE	REVISED -
PLOT SCALE =	DRAWN - F. D. LACHAT	REVISED -
PLOT DATE =	CHECKED - M. A. CACKLEY	REVISED -

**JODAVIESS COUNTY**  
**F.A.S. 72 (E. BETHEL RD.) OVER LITTLE RUSH CREEK**  
**STATION 20 + 15**

**TOP OF WEST BRIDGE APPROACH SLAB ELEVATIONS**  
**STRUCTURE NO. 043-3277**

STRUCTURAL SHEET NO. 4 OF 17 SHEETS

F.A.S. RTE.	SECTION	COUNTY	TOTAL SHEETS	SHEET NO.
72	10-00134-00-BR	JODAVIESS	34	14
WHA# 1183D10		CONTRACT NO. 85536		

ILLINOIS FED. AID PROJECT ER-0072(103)