

INDEX OF SHEETS

- 1 = COVER SHEET
- 2 = SUMMARY OF QUANTITIES
- 3 = SCHEDULE OF QUANTITIES
- 4 = GENERAL NOTES AND DETAILS
- 5 = TYPICAL SECTIONS
- 6-7 = PLAN AND PROFILE
- 8-9 = EROSION CONTROL PLAN
- 10 = GENERAL PLAN AND ELEVATION
- 11 = RIPRAP AND PILE LAYOUT
- 12 = 33"x48" PPC DECK BEAM
- 13 = 33"x48" PPC DECK BEAM DETAILS
- 14 = SOUTH ABUTMENT
- 15 = NORTH ABUTMENT
- 16 = STEEL RAILING, TYPE S1 DETAILS
- 17 = HP PILE DETAILS
- 18 = BORING LOGS
- 19-23 = CROSS SECTIONS

STANDARDS

- 000001-06 STANDARD SYMBOLS, ABBREVIATIONS, AND PATTERNS
- 280001-05 TEMPORARY EROSION CONTROL SYSTEMS
- 515001-03 NAME PLATE FOR BRIDGES
- 601001-04 SUB-SURFACE DRAINS
- 601101-01 CONCRETE HEADWALL FOR PIPE DRAIN
- 630001-09 STEEL PLATE BEAM GUARDRAIL
- 630301-05 SHOULDER WIDENING FOR TYPE 1 (SPECIAL) GUARDRAIL TERMINALS
- 635006-03 REFLECTOR AND TERMINAL MARKER PLACEMENT
- 635011-02 REFLECTOR MARKER AND MOUNTING DETAILS
- 701901-01 TRAFFIC CONTROL DEVICES
- 720011-01 METAL POSTS FOR SIGNS, MARKERS & DELINEATORS
- 728001-01 TELESCOPING STEEL SIGN SUPPORT
- 729001-01 APPLICATIONS OF TYPE A & B METAL POSTS (FOR SIGNS & MARKERS)
- BLR 21-8 TYPICAL APPLICATION OF TRAFFIC CONTROL DEVICES FOR CONSTRUCTION ON RURAL LOCAL HIGHWAYS
- BLR 22-6 TYPICAL APPLICATION OF TRAFFIC CONTROL DEVICES FOR CONSTRUCTION ON RURAL LOCAL HIGHWAYS
- BLR 27-1 TRAFFIC BARRIER TERMINAL TYPE 5A

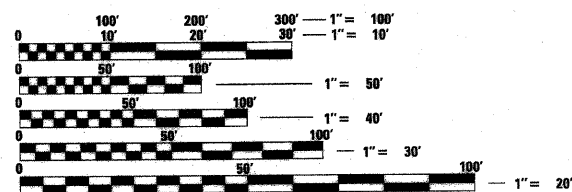

FULL SIZE PLANS HAVE BEEN PREPARED USING STANDARD ENGINEERING SCALES. REDUCED SIZED PLANS WILL NOT CONFORM TO STANDARD SCALES. IN MAKING MEASUREMENTS ON REDUCED PLANS, THE ABOVE SCALES MAY BE USED.

J.U.L.I.E.
JOINT UTILITY LOCATION INFORMATION FOR EXCAVATION
1-800-892-0123
OR 811

PROJECT ENGINEER - BSK
PROJECT MANAGER - BKC

CONTRACT NO. 87483

PROPOSED STRUCTURE: S.N. 006-4012
A SINGLE SPAN (84'-10") PRECAST PRESTRESSED CONCRETE DECK BEAM BRIDGE ON SPILL-THRU ABUTMENTS @ STA. 15+00 SKEWED 20° RT. AHEAD.

FUNCTIONAL CLASSIFICATION
LOCAL ROAD (NON-URBAN)
DESIGN SPEED 30 MPH
2011 ADT - 225
3R GUIDELINES

STATE OF ILLINOIS

DEPARTMENT OF TRANSPORTATION

DIVISION OF HIGHWAYS

**PLANS FOR PROPOSED
FEDERAL-AID PROJECT
HIGHWAY BRIDGE PROGRAM**

**TOWNSHIP ROUTE 240
SECTION 10-01121-00-BR
PROJECT BROS-0011(075)
STRUCTURE REPLACEMENT
BUREAU COUNTY
ARISPIE ROAD DISTRICT**

C-93-070-11

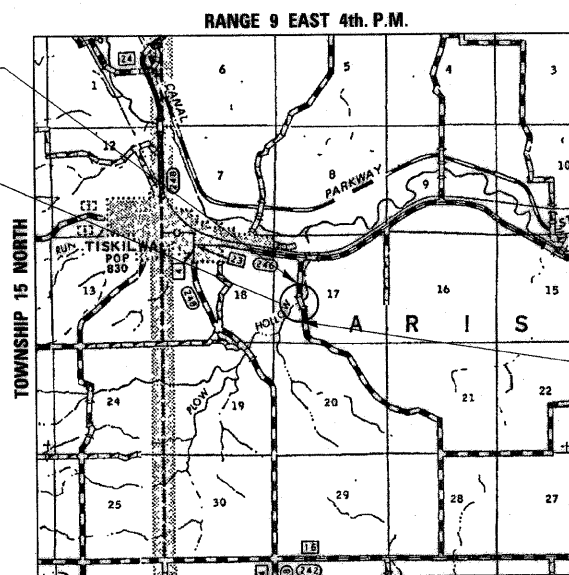

GROSS LENGTH = 600 FT. = 0.11 MILE
NET LENGTH = 600 FT. = 0.11 MILE

UTILITIES:

NICOR GAS
ATTN: ENGINEERING DEPARTMENT
4651 LINDEN ROAD
ROCKFORD, IL 61109
815-965-0143

VERIZON (FRONTIER COM.)
ATTN: GARRETT BURT
112 ELM STREET
SYCAMORE, IL 60178
815-895-1538

CORN BELT ENERGY
ATTN: IAN CARDOSI
1 ENERGY WAY
BLOOMINGTON, IL 61705
800-879-0339 EXT. 304

CONSTRUCTION BEGINS
STATION 12+00

CONSTRUCTION ENDS
STATION 18+00



LOCATION OF SECTION INDICATED THUS: - ■ -

BUREAU COUNTY HIGHWAY DEPARTMENT		
APPROVED	<u>4-8</u> <i>John C. [Signature]</i> BUREAU COUNTY ENGINEER	2011
APPROVED	<u>4-8</u> <i>Carl [Signature]</i> ARISPIE TOWNSHIP ROAD COMMISSIONER	2011
PASSED	<u>Apr 8</u> <i>[Signature]</i> DISTRICT 3 PROJECT IMPLEMENTATION ENGINEER	2011
RELEASING FOR BID BASED ON LIMITED REVIEW	<u>Apr 8</u> <i>[Signature]</i> DEPUTY DIRECTOR OF HIGHWAYS, REGION 2 ENGINEER	2011

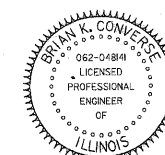

Brian K. Converse
DATE: March 31, 2011
EXPIRES 11/30/11

WILLETT, HOFMANN & ASSOCIATES, INC.
CONSULTING ENGINEERS
Land Surveying - Transportation - Structural
Environmental - Architecture
809 East Second Street Dixon, Illinois 61021
Phone 815.284.3381 Fax 815.284.3385
Design Firm #184-000918
www.willett-hofmann.com

FILE NAME = S:\PROJECTS\2010\1285010_BureauCo_TR240\DESIGN\STRUCT\1285010_Cover.dgn