

TR 240 (1925 EAST STREET) - HORIZONTAL CONTROL POINTS (NAD83-2007)

PT #	STA.	N	E	EL.	DESCRIPTION
100	10.7' LT. 19+91.1	1682604.09	2483757.38	520.17	5/8" I.P. W/CAP
101	24.4' LT. 16+24.0	1682235.90	2483755.18	522.00	5/8" I.P. W/CAP
102	15.5' RT. 13+93.6	1682017.01	2483838.88	525.56	5/8" I.P. W/CAP
103	11.7' LT. 10+65.7	1681700.78	2483928.15	534.13	5/8" I.P. W/CAP

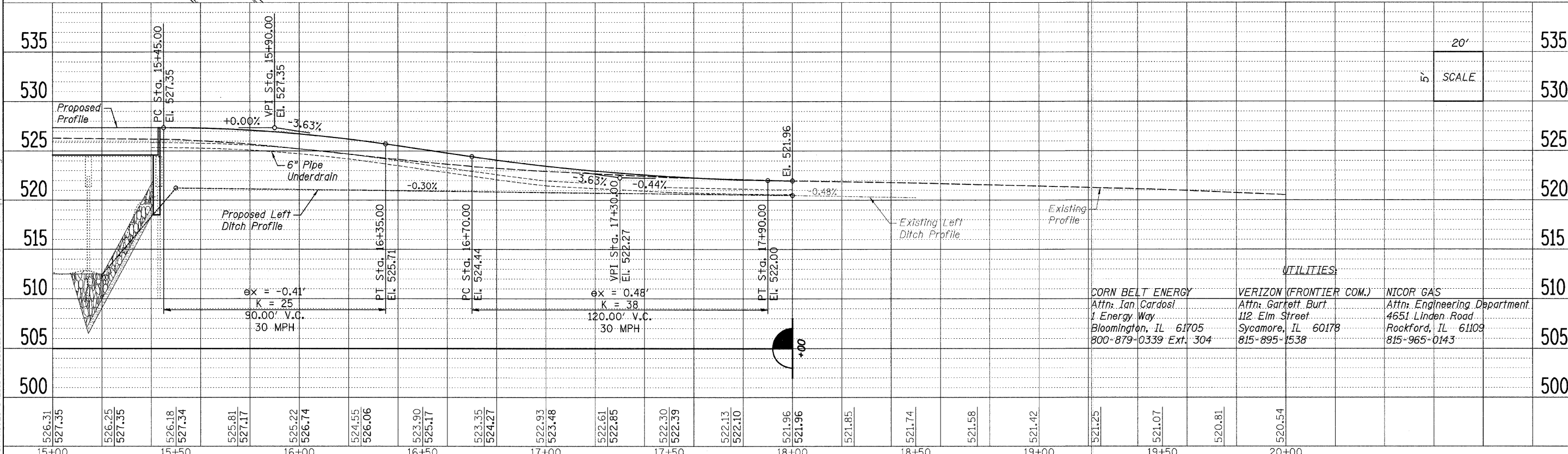
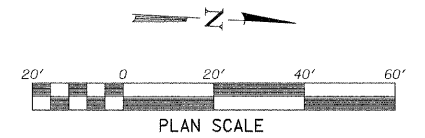
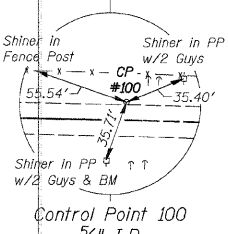

FILE NAME = S:\PROJECTS\2010\1285010_BureauCo_TR240\DESIGN\STRUCT\TR240.dgn

USER NAME =	DESIGNED - B.S.K.	REVISED -	BUREAU COUNTY TR 240 OVER PLOW HOLLOW CREEK STATION 15 + 00	PLAN AND PROFILE STRUCTURE NO. 006-4012	TWP. RTE.	SECTION	COUNTY	TOTAL SHEETS	SHEET NO.	
PLOT SCALE =	CHECKED - B.K.C.	REVISED -			240	10-0121-00-BR	BUREAU	23	7	
PLOT DATE =	DRAWN - R.D.A.	REVISED -			WHA* 1285010		CONTRACT NO. 87483			
	CHECKED - B.S.K.	REVISED -			STA. 15+00 TO STA. 20+00		ILLINOIS FED. AID PROJECT		BROS-0011(075)	