

SEC. THRU ABUT.
(Dimensions are at Rt. L's)

BILL OF MATERIAL

Bar	No.	Size	Length	Shape
h	3	#5	27'-4"	—
h ₁	3	#5	3'-7"	┌
h ₂	3	#5	3'-7"	└
h ₃	34	#7	13'-7"	—
h ₄	12	#4	10'-9"	—
p	14	#6	27'-4"	—
s ₅	58	#7	9'-10"	└
u ₂	14	#6	7'-2"	└
v	32	#5	4'-10"	—
v ₁	8	#5	8'-0"	—
v ₂	7	#5	12'-0"	—
v ₃	8	#5	8'-10"	—
v ₄	7	#5	13'-6"	—
Concrete Structures		Cu. Yd.	22.9	
Concrete Encasement		Cu. Yd.	2.1	
Reinforcement Bars		Pound	2,740	
Furnishing Steel				
Piles HP 12x63		Foot	140	
Driving Piles		Foot	140	
Test Pile Steel HP 12x63		Each	1	
** Porous Granular Embankment, Special		Ton	50	

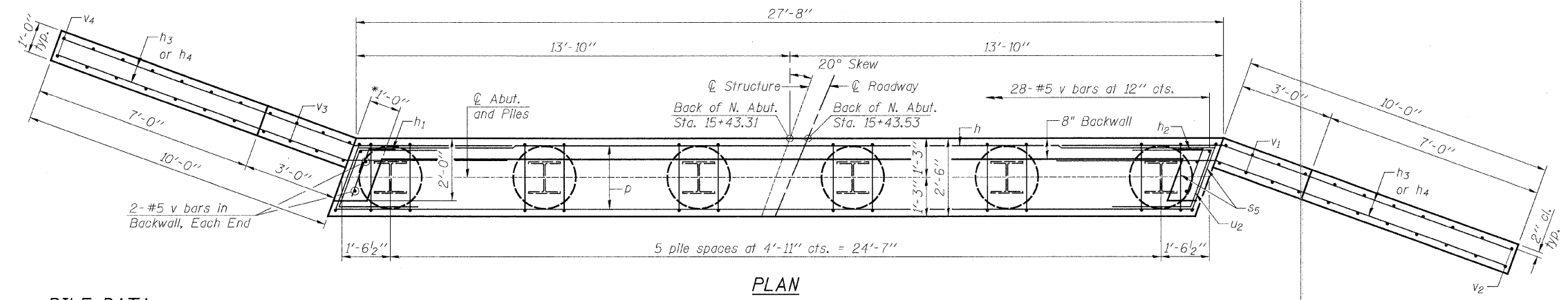

PILE DATA

Type: Steel HP 12X63
Nominal Required Bearing: 271 k
Factored Resistance Available: 149 k
Est. Length: 28'
No. Production Piles: 5
No. Test Piles: 1 @ N.W. corner

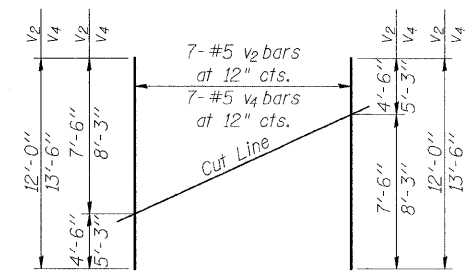
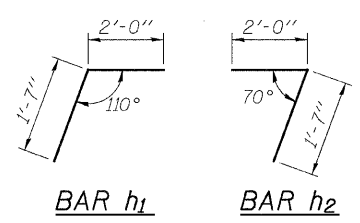

FIELD CUTTING DIAGRAM
Order v₂ & v₄ full length. Cut as shown and use remainder of bars in opposite face.

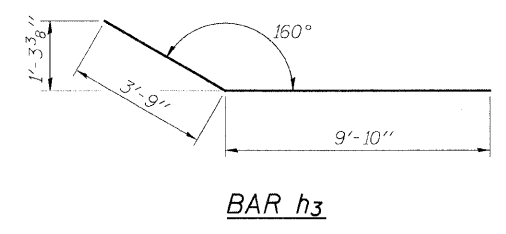

BAR h₃

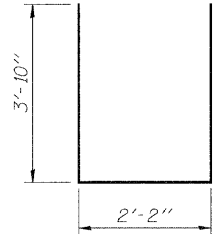

BARS s₅

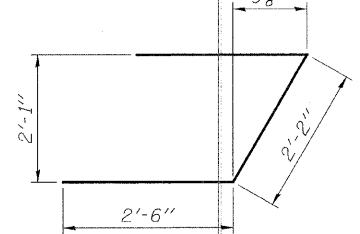

BAR u₂

NOTES:

Hatched portion of wingwalls to be poured with the backwall after the deck beams have been installed and grout has cured for a minimum of 24 hours.
All exposed edges shall have standard 3/4" chamfers, except as noted.
Space reinforcement in cap to miss dowel rods.
After beams have been erected, holes shall be drilled into substructure and anchor dowels placed. Dowel holes shall be filled with non-shrink grout to top of beam and allowed to cure a min. of 24 hours prior to grouting the shear keys.
For HP Pile Details see Structural Sheet 8 of 9.
* May vary due to overrun of beams.
** For Drainage Details, see Structural Sheet 2 of 9.

FILE NAME = S:\PROJECTS\2010\1285010\Bureau\Co. TR240\DESIGN\STRUCT\NORTH ABUTMENT.dgn

USER NAME =	DESIGNED - B.S.K.	REVISED -
PLOT SCALE =	CHECKED - B.K.C.	REVISED -
PLOT DATE =	DRAWN - F.D.L.	REVISED -
	CHECKED - M.A.C.	REVISED -

BUREAU COUNTY
T.R. 240 OVER PLOW HOLLOW CREEK
STATION 15 + 00

NORTH ABUTMENT
STRUCTURE NO. 006-4012
STRUCTURAL SHEET NO. 6 OF 9 SHEETS

TWP. RTE.	SECTION	COUNTY	TOTAL SHEETS	SHEET NO.
240	10-01121-00-BR	BUREAU	23	15
WHA# 1285010		CONTRACT NO. 87483		
ILLINOIS FED. AID PROJECT BROS-0011075				