

SECTION A1-A1

Bar splicers are billed with Superstructure.
* Tilt hooked #9 b(E) bars as required to maintain clearance.
** va(E) are billed with Superstructure
*** Cost included with Concrete Superstructure.

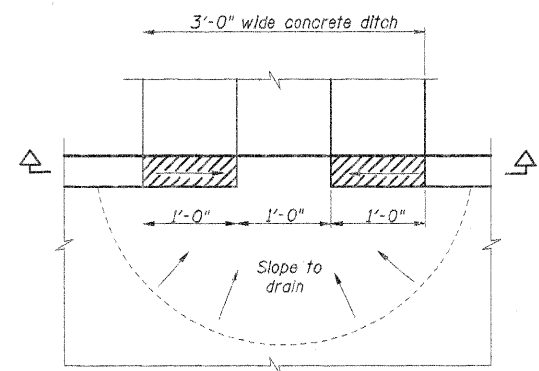

CURB CUT-OUT DETAIL

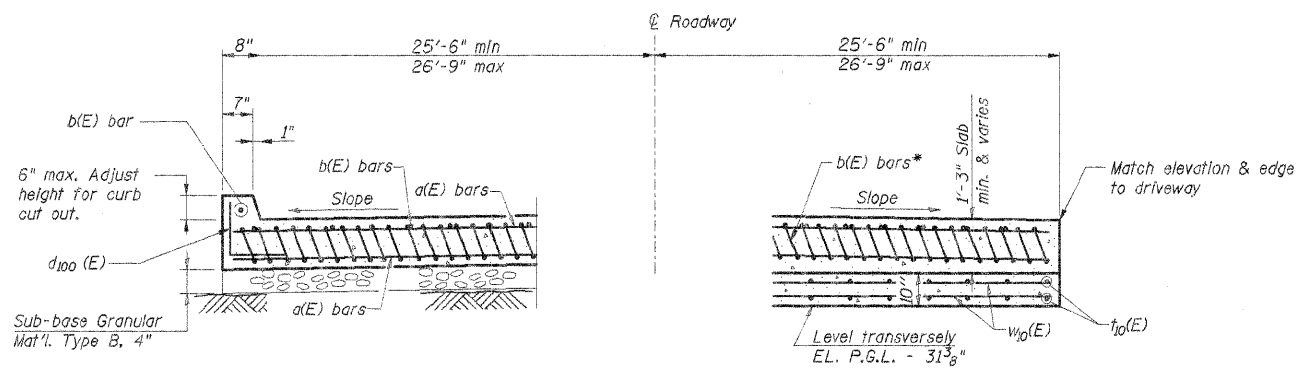

NEAR ABUTMENT

SECTION A2-A2

(See Plan for dimensions not shown)

AT APPROACH FOOTING

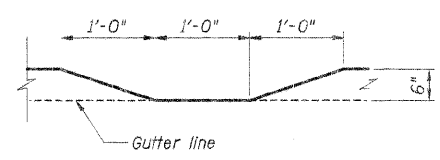

CURB CUT-OUT SECTION

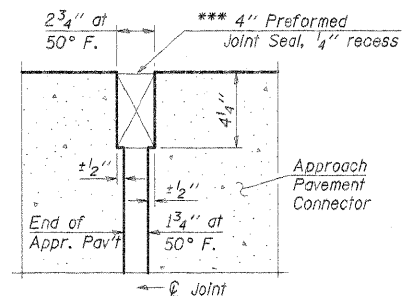

RIGID PAVEMENT DETAIL A

*** Cost Included with Concrete Superstructure.

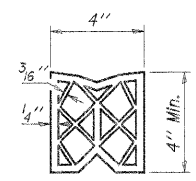

PREFORMED JOINT SEAL

**REINFORCING LIST (PART 1)
SOUTH BRIDGE
APPROACH PAVEMENT**

Bar	No.	Size	Length	Shape
a1 (E)	68	# 5	29'-0"	—
a2 (E)	4	# 5	29'-6"	—
a10 (E)	1	# 5	3'-9"	—
a11 (E)	1	# 5	8'-5"	—
a112 (E)	1	# 5	13'-0"	—
a113 (E)	1	# 5	17'-7"	—
a114 (E)	1	# 5	22'-2"	—
a115 (E)	1	# 5	26'-7"	—
a116 (E)	1	# 5	7'-10"	—
a117 (E)	1	# 5	12'-6"	—
a118 (E)	1	# 5	17'-2"	—
a119 (E)	1	# 5	21'-10"	—
a120 (E)	1	# 5	26'-6"	—
a121 (E)	1	# 5	25'-0"	—
a122 (E)	1	# 5	22'-11"	—
a123 (E)	1	# 5	20'-10"	—
a124 (E)	1	# 5	18'-9"	—
a125 (E)	1	# 5	16'-9"	—
a126 (E)	1	# 5	14'-8"	—
a127 (E)	1	# 5	12'-8"	—
a128 (E)	1	# 5	10'-7"	—
a129 (E)	1	# 5	8'-6"	—
a130 (E)	1	# 5	6'-5"	—
a131 (E)	1	# 5	4'-5"	—
a132 (E)	1	# 5	27'-10"	—
a133 (E)	1	# 5	25'-8"	—
a134 (E)	1	# 5	23'-6"	—
a135 (E)	1	# 5	21'-4"	—
a136 (E)	1	# 5	19'-2"	—
a137 (E)	1	# 5	17'-0"	—
a138 (E)	1	# 5	14'-10"	—
a139 (E)	1	# 5	12'-7"	—
a140 (E)	1	# 5	10'-5"	—
a141 (E)	1	# 5	8'-3"	—
a142 (E)	1	# 5	6'-1"	—
b31 (E)	20	# 9	12'-0"	—
b32 (E)	20	# 9	14'-3"	—
b33 (E)	20	# 9	16'-6"	—
b34 (E)	20	# 9	18'-8"	—
b35 (E)	20	# 9	20'-11"	—
b36 (E)	20	# 9	23'-2"	—
b37 (E)	7	# 9	23'-10"	—

**REINFORCING LIST (PART 2)
SOUTH BRIDGE
APPROACH PAVEMENT**

Bar	No.	Size	Length	Shape
d50 (E)	2	# 5	10'-0"	—
d51 (E)	1	# 5	10'-4"	—
d52 (E)	1	# 5	10'-8"	—
d53 (E)	1	# 5	11'-0"	—
d54 (E)	1	# 5	11'-4"	—
d55 (E)	1	# 5	11'-8"	—
d56 (E)	1	# 5	12'-0"	—
d57 (E)	1	# 5	12'-4"	—
d58 (E)	1	# 5	12'-8"	—
d59 (E)	1	# 5	13'-0"	—
d60 (E)	1	# 5	13'-4"	—
d61 (E)	1	# 5	13'-8"	—
d62 (E)	1	# 5	14'-0"	—
d63 (E)	1	# 5	14'-4"	—
d64 (E)	1	# 5	14'-8"	—
d65 (E)	1	# 5	15'-0"	—
d66 (E)	1	# 5	15'-4"	—
d67 (E)	1	# 5	15'-8"	—
d68 (E)	1	# 5	16'-0"	—
d69 (E)	1	# 5	16'-4"	—
d70 (E)	1	# 5	16'-8"	—
d71 (E)	1	# 5	17'-0"	—
d72 (E)	1	# 5	17'-4"	—
d73 (E)	1	# 5	17'-8"	—
d74 (E)	1	# 5	18'-0"	—
d75 (E)	1	# 5	18'-4"	—
d76 (E)	1	# 5	18'-8"	—
d77 (E)	1	# 5	19'-0"	—
d78 (E)	1	# 5	19'-4"	—
d79 (E)	1	# 5	19'-8"	—
d80 (E)	1	# 5	20'-0"	—
d81 (E)	1	# 5	20'-4"	—
d82 (E)	1	# 5	20'-8"	—
d83 (E)	1	# 5	21'-0"	—
d84 (E)	1	# 5	21'-4"	—
d85 (E)	1	# 5	21'-8"	—
d86 (E)	1	# 5	22'-0"	—
d87 (E)	1	# 5	22'-4"	—
d88 (E)	1	# 5	22'-8"	—
d89 (E)	1	# 5	23'-0"	—
d90 (E)	2	# 5	23'-4"	—
d100 (E)	7	# 5	2'-4"	—
T10 (E)	104	# 4	9'-8"	—
W10 (E)	80	# 5	28'-4"	—

**BILL OF MATERIAL
SOUTH BRIDGE
APPROACH PAVEMENT**

Reinforcement Bars, Epoxy Coated	Lbs.	14270
Concrete Superstructure	Cu. Yds.	52
Concrete Structures	Cu. Yds.	16.3
Bridge Deck Grooving	Sq. Yd.	100
Protective Coat	Sq. Yd.	104
Sub-base Granular Mat'l. Type B 4"	Sq. Yd.	18
Earth Excavation	Cu. Yd.	22

NOTES:

Approach slab concrete shall be measured and paid for as Concrete Superstructures.

Approach Footing concrete shall be measured and paid for as Concrete Structures.

Reinforcement bars designated (E) shall be epoxy coated.

The approach footing maximum applied service bearing pressure (0max) = 2.0 ksf.

DSGN	K.J. Hoffmann				
DR	B.A. Clark				
CHK	J.R. Wolf				
APVD	A. Fraenhoffer	NO.	DATE	REVISION	BY

FRAUENHOFER & ASSOCIATES
A division of Engineering Resource Associates, Inc.
Consulting Engineers, Scientists, & Surveyors

3002 CROSSING COURT
CHAMPAIGN, ILL 61822
PHONE (217) 351-6268
FAX (217) 355-1802

SOUTH BRIDGE APPROACH PAV'T (SHEET 2 OF 2) SHEET 9

FAS 1523 (CH 55) OVER UPPER SALT FORK
SEC 09-00956-00-BR
CHAMPAIGN COUNTY

DWG NO. 7052ap.or.dgn
DATE FEB 2011
PROJ NO. 7052