

CO. HWY#	SECTION	COUNTY	TOTAL SHEETS	SHEET NO.
31	08-00073-10-WR	McLEAN	9	1

INDEX OF SHEETS

1. Cover Sheet
2. Existing Typical Cross Section
3. Proposed Typical Cross Section
- 4-6. Plan View
- 7-8. Details
9. Intersection Detail

STATE STANDARD DETAILS

630106-00	LONG-SPAN GUARD RAIL OVER CULVERT
701001-02	OFF-RD OPERATIONS, 2L, 2W, MORE THAN 15' AWAY
701006-03	OFF-RD OPERATIONS, 2L, 2W, 15' TO 24" FROM PAVEMENT EDGE
701011-02	OFF-RD MOVING OPERATIONS, 2L, 2W, DAY ONLY
701201-04	LANE CLOSURE, 2L, 2W, DAY ONLY, FOR SPEEDS > 45 MPH
701301-04	LANE CLOSURE, 2L, 2W, SHORT TIME OPERATIONS
701306-03	LANE CLOSURE, 2L, 2W, SLOW MOVING OPERATIONS DAY ONLY, FOR SPEEDS > 45 MPH
701326-04	LANE CLOSURE, 2L, 2W, PAVEMENT WIDENING, FOR SPEEDS > 45 MPH
701901-01	TRAFFIC CONTROL DEVICES

B. L. R. 23-3 TRAFFIC BARRIER TERMINAL TYPE 1
 B. L. R. 26-2 STEEL PLATE BEAM GUARDRAIL 27 1/2" HEIGHT

SUMMARY OF QUANTITIES

ITEM NUMBER	ITEM	UNIT	QUANTITY
20200500	EARTH EXCAVATION (WIDENING)	CU YD	574
35501308	HOT-MIX ASPHALT BASE COURSE	SQ YD	360
35600700	HMA BASE COURSE WIDENING 6"	SQ YD	3445
40600100	BITUMINOUS MATERIALS (PRIME COAT)	GAL.	2800
40600300	AGGREGATE (PRIME COAT)	TON	70
40600625	LEVELING BINDER - MACHINE METHOD, N50	TON	1250
40600982	SURFACE REMOVAL - BUTT JOINT	SQ YD	533
40600990	TEMPORARY RAMP	SQ YD	53
40603080	HMA BINDER COURSE IL-19.0 N50	TON	3,150
40603310	HMA SURFACE COURSE "C" N50	TON	2,000
40800010	BITUMINOUS MATERIALS (PRIME COAT)	GAL.	60
40800030	AGGREGATE (PRIME COAT)	TON	3
40800050	INCIDENTAL HMA SURFACE	TON	150
44300100	AREA REFLECTIVE CRACK CONTROL TR	SQ YD	27,560
48101200	AGGREGATE SHLDS B	TON	2,100
60255500	MANHOLES TO BE ADJUSTED	EACH	1
60266600	VALVE BOXES TO BE ADJUSTED	EACH	3
60609800	COMB. CONCRETE CURB & GUTTER, TYPE M-6.18	LF	236.5
* 63000001	SPBGR, TYPE A, 6' POSTS	LF	200
* 63000350	LONG-SPAN GUARD RAIL OVER CULVERT, 12' -6" SPAN	LF	325
* 63300925	VERTICAL ADJ OF TRAF BARR TERM, TYPE 1	EACH	2
67100100	MOBILIZATION	L SUM	1
X7010216	TRAFFIC CONTROL & PROTECTION (SPECIAL)	L SUM	1
* 78100100	RAISED REFLECTIVE PAVEMENT MARKER	EACH	128
* LR631020	TRAFFIC BARRIER TERMINAL, TYPE 1	EACH	6
* Z0000200	ADJUST EXISTING GUARDRAIL	LF	275

* SPECIALTY ITEMS

THESE PLANS ARE NOT TO SCALE

J.U.L.I.E.
 JOINT UTILITY LOCATION INFORMATION FOR EXCAVATION
 1-800-892-0123 OR 811

CONTRACT NO. 91456

STATE OF ILLINOIS
DEPARTMENT OF TRANSPORTATION
DIVISION OF HIGHWAYS
PROPOSED
HIGHWAY PLANS
F.A.S. ROUTE 1472
SECTION 08-00073-10-WR
PROJECT RS-1472(105)
WIDEN AND RESURFACE
MCLEAN COUNTY
PIPELINE RD (CH 31)
JOB NO: C-95-317-11

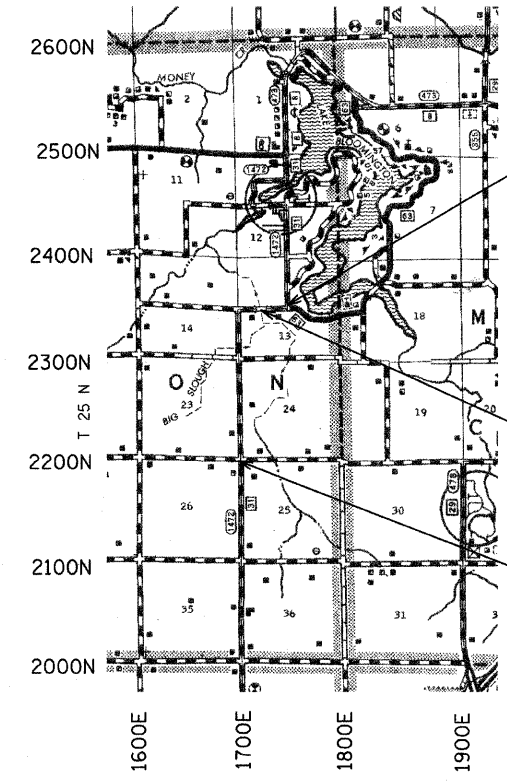

IMPROVEMENT ENDS STA: 346 + 35.46
 OMISSION = 48.04'
 STA: 346 + 35.46 TO STA: 346 + 83.50

BRIDGE OMISSION = 108.66'
 STA: 330 + 50.80 TO 331 + 59.46

IMPROVEMENT BEGINS STA: 241 + 92.50
 OMISSION = 90'
 STA: 241 + 02.50 TO STA 241 + 92.50

- NOTE: THE TOTAL LENGTH OF THE PROPOSED PROJECT IS 10,581' FEET WITH A NET LENGTH OF 10,334.30' FEET (1.957 MILES)
- NOTE: THESE PLANS MEET THE MINIMUM REQUIREMENTS FOR A 3R IMPROVEMENT.
- NOTE: CURRENT ADT: 1200
 FUNCTIONAL CLASSIFICATION: MAJOR COLLECTOR

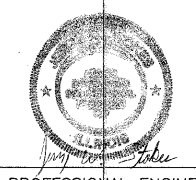

ILLINOIS PROFESSIONAL ENGINEER #57636
 EXPIRES 11-30-11



STATE OF ILLINOIS
DEPARTMENT OF TRANSPORTATION
DIVISION OF HIGHWAY

Approved: 2/24/2011
 [Signature]
 County Engineer

Passed: March 11, 2011
 [Signature]
 District Five Engineer of Local Roads & Streets

Releasing For Bid Based on Limited Review: March 11, 2011
 [Signature]
 Deputy Director of Highways, Region Three Engineer

PRINTED BY THE AUTHORITY OF THE STATE OF ILLINOIS