

DATE	
BY	
FINISH SURVEYED	
NOTED	
PLOTTED	
TEMPLATE	
NO. BOOK	
AREAS CHECKED	

DATE	
BY	
ORIGINAL SURVEYED	
NOTED	
PLOTTED	
TEMPLATE	
NO. BOOK	
AREAS CHECKED	

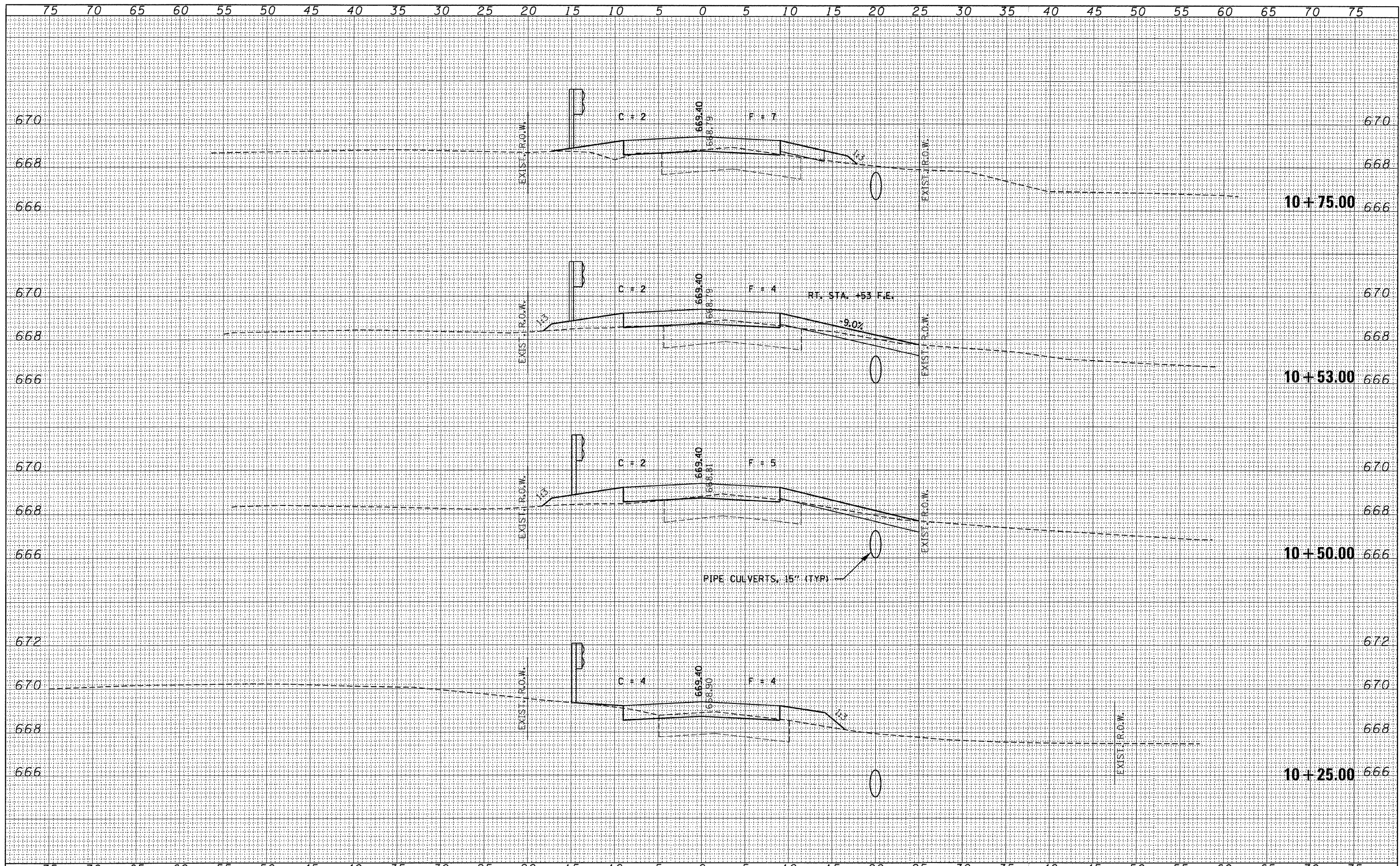

FILE NAME = 100322-ah1-svs.dgn	USER NAME =	DESIGNED - J.W.F.	REVISED -	STATE OF ILLINOIS VERMILION COUNTY HIGHWAY DEPARTMENT	STATION CROSS SECTIONS T.R. 225 / 2050N ROAD		T.R.	SECTION	COUNTY	TOTAL SHEETS	SHEET NO.	
HLR HAMPSON, LENZINI AND RENWICK, INC. 3085 STEVENSON DRIVE, SUITE 201 SPRINGFIELD, ILLINOIS 62703 ILLINOIS PROFESSIONAL DESIGN FIRM LS / PE / SE CORP. 184-00989	DESIGNED - J.W.F.	DRAWN - D.T.M.	REVISED -		225	08-14136-00-BR	VERMILION	21	12			
PLOT SCALE =	CHECKED - M.G.B.	DATE - 02/15/11	REVISED -		SCALE: H5V2	SHEET NO.	OF	SHEETS	STA. 10+25.00	TO STA. 10+75.00	CONTRACT NO. 91457	[ILLINOIS] FED. AID PROJECT
PLOT DATE = 3/2/2011	DATE - 02/15/11	REVISED -										