

PATRICIA TRIMBLE
NE 1/4, NE 1/4, SEC 33, T. 20 N., R. 13 W., 2ND P.M.

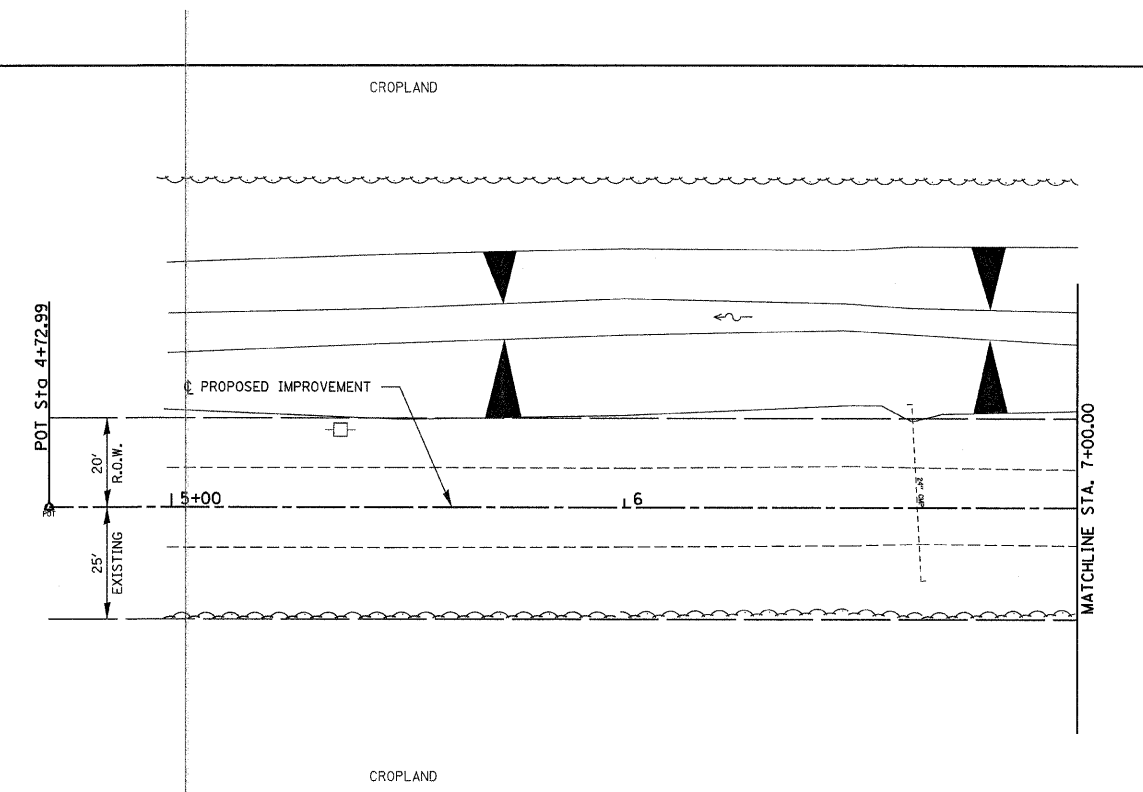
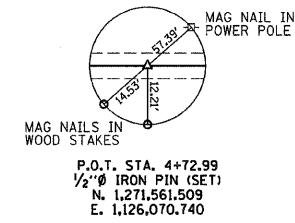

MARK A. & TONI K. SHEPHERD
N 1/2, NW 1/4, SEC 34, T. 20 N., R. 13 W., 2ND P.M.

PLAN	DATE
BY	
NOTED	
CHECKED	
BY	
DATE	

PROFILE	DATE
BY	
NOTED	
CHECKED	
BY	
DATE	

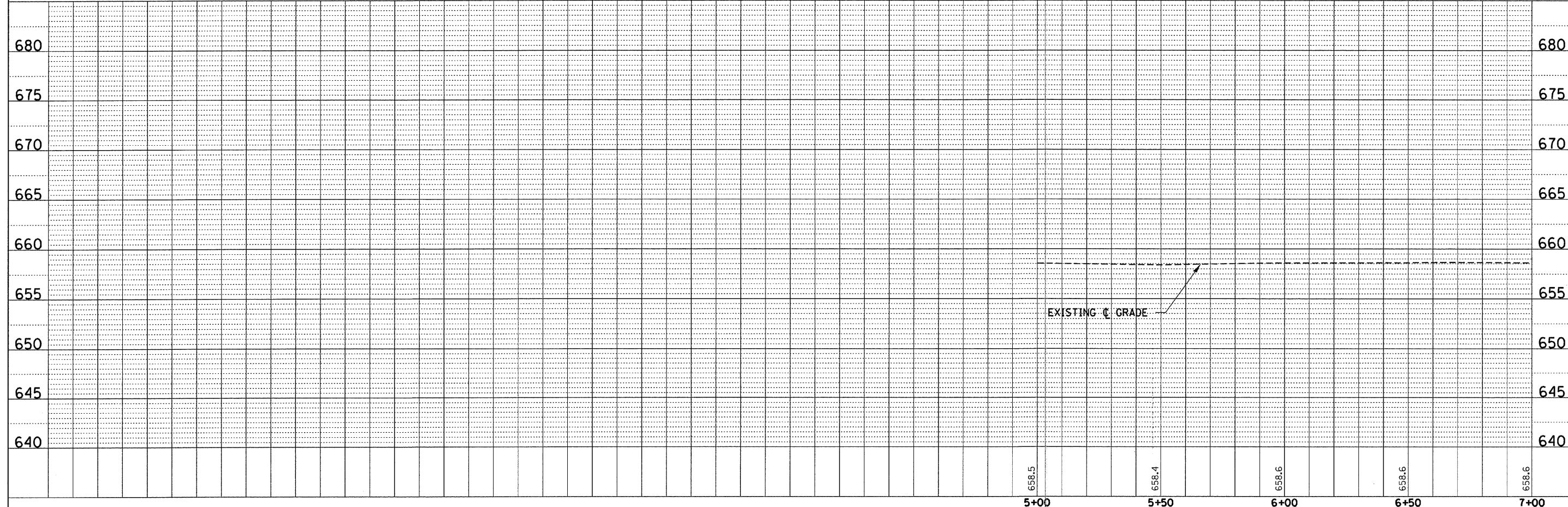

FILE NAME = 100323-sht-pp1.dgn	USER NAME =	DESIGNED - J.W.F.	REVISED -	STATE OF ILLINOIS VERMILION COUNTY HIGHWAY DEPARTMENT	PLAN & PROFILE T.R. 78 / 600E ROAD	T.R.	SECTION	COUNTY	TOTAL SHEETS	
HAMPTON, LENZINI AND RENWICK, INC.		DRAWN - D.T.M.	REVISED -			78	09-14138-00-BR	VERMILION	27	6
3604 STEVENSON DRIVE, SUITE 201 SPRINGFIELD, ILLINOIS 62703	PLOT SCALE =	CHECKED - S.W.M.	REVISED -			OAKWOOD ROAD DISTRICT		CONTRACT NO. 91458		
ILLINOIS PROFESSIONAL DESIGN FIRM LS / PE / SE CORP. 184,000958	PLOT DATE = 3/2/2011	DATE - 11/23/10	REVISED -			SCALE: H20:V5	SHEET NO. 1 OF 4 SHEETS	STA. 4+72.99 TO STA. 7+00.00	ILLINOIS FED. AID PROJECT	