

SECTION NO.	COUNTY HIGHWAY	COUNTY	SHEET OF SHEETS
06-00201-02-BR	CH 58	ST. CLAIR	1 OF 13
FHWA REG. NO. 7	ILLINOIS	PROJ: BRM-5011(309)	
FEDERAL AID PROJECT		CONTRACT 97465	

STATE OF ILLINOIS
DEPARTMENT OF TRANSPORTATION
PLANS FOR PROPOSED
LOCAL AGENCY IMPROVEMENT
FEDERAL AID H.B.P. PROJECT
EAST O'FALLON DR., CH 58, FAU 9148
PROJECT NO. BRM-5011(309)
JOB NO. C-98-340-10
ST. CLAIR COUNTY
SECTION 06-00201-02-BR

- INDEX TO SHEETS
1 COVER SHEET
2 GENERAL NOTES, TYPICAL SECTIONS, TRAFFIC CONTROL PLAN
3 PLAN AND PROFILE
4 GENERAL PLAN & ELEVATION
5 SUPERSTRUCTURE
6 PPC DECK BEAM
7 PPC DECK BEAM DETAILS
8 ABUTMENT DETAILS
9 STEEL RAILING TYPE SM
10 PILE DETAILS
11-13 CROSS SECTIONS

SUMMARY OF QUANTITIES

CODE NO.	ITEM	UNIT	QUANTITY
20200100	EARTH EXCAVATION	CU YD	49
20400800	FURNISHED EXCAVATION	CU YD	149
25000200	SEEDING, CLASS 2	ACRE	0.2
25000400	NITROGEN FERTILIZER NUTRIENT	POUND	18
25000500	PHOSPHORUS FERTILIZER NUTRIENT	POUND	18
25000600	POTASSIUM FERTILIZER NUTRIENT	POUND	18
25100115	MULCH, METHOD 2	ACRE	0.2
28100707	STONE DUMPED RIPRAP, CLASS A4	SQ YD	270
28200200	FILTER FABRIC	SQ YD	270
35100700	AGGREGATE BASE COURSE, TYPE A 8"	SQ YD	59
40600100	BITUMINOUS MATERIALS (PRIME COAT)	GALLON	23
40603315	HOT-MIX ASPHALT SURFACE COURSE, MIX "C", N70	TON	33
40800050	INCIDENTAL HOT-MIX ASPHALT SURFACING	TON	13
48100700	AGGREGATE SHOULDERS, TYPE A 8"	SQ YD	318
50100100	REMOVAL OF EXISTING STRUCTURES	EACH	1
50105220	PIPE CULVERT REMOVAL	FOOT	12
50300225	CONCRETE STRUCTURES	CU YD	32.2
50300280	CONCRETE ENCASEMENT	CU YD	4.2
50400505	PRECAST PRESTRESSED CONCRETE DECK BEAMS (27" DEPTH)	SQ FT	2096
50500505	STUD SHEAR CONNECTORS	EACH	96
50800205	REINFORCEMENT BARS, EPOXY COATED	POUND	2578
50901050	STEEL RAILING, TYPE SM	FOOT	132
51201600	FURNISHING STEEL PILES HP 12 X 53	FOOT	605
51202305	DRIVING PILES	FOOT	605
51203600	TEST PILE STEEL HP 12 X 53	EACH	1
51204650	PILE SHOES	EACH	12
51500100	NAME PLATES	EACH	1
58100200	WATERPROOFING MEMBRANE SYSTEM	SQ YD	233
58300100	PORTLAND CEMENT MORTAR FAIRING COURSE	FOOT	459
63100087	TRAFFIC BARRIER TERMINAL, TYPE 6A	EACH	4
63100167	TRAFFIC BARRIER TERMINAL, TYPE 1 (SPECIAL) TANGENT	EACH	4
63200310	GUARDRAIL REMOVAL	FOOT	204
66700205	PERMANENT SURVEY MARKERS, TYPE I	EACH	2
67100100	MOBILIZATION	L SUM	1
70101830	TRAFFIC CONTROL AND PROTECTION, STANDARD BLR 21	L SUM	1
78200410	GUARDRAIL MARKERS, TYPE A	EACH	4
78200530	BARRIER WALL MARKERS, TYPE C	EACH	4
78201000	TERMINAL MARKER - DIRECT APPLIED	EACH	4
X0323265	REMOVE EXISTING RIPRAP	SQYD	375
Z0018700	DRAINAGE STRUCTURE TO BE REMOVED	EACH	2
20076600	TRAINERS	Hour	500
* SPECIALTY ITEM			

SECTION 06-00201-02-BR BEGINS STA. 90+70.94
SECTION 06-00201-02-BR ENDS STA. 94+57.51

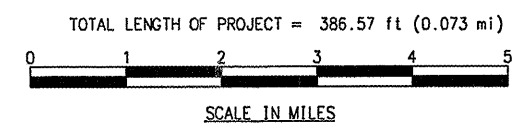
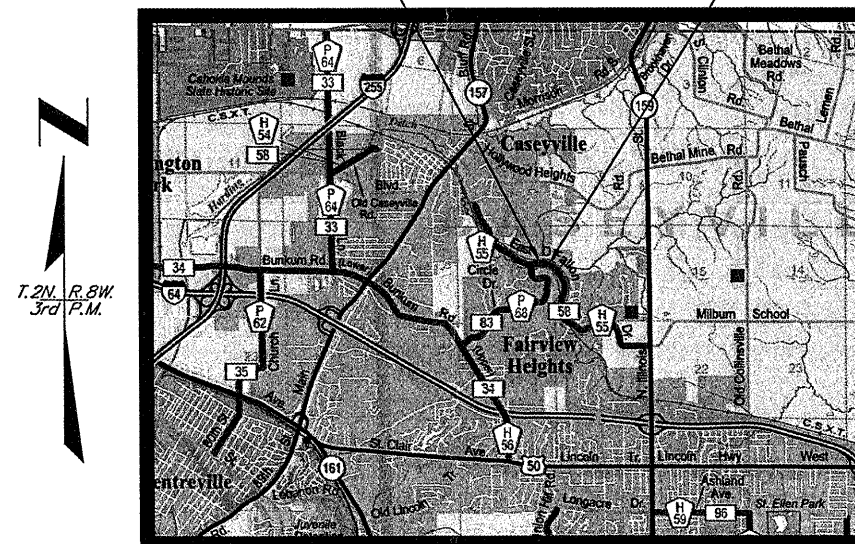

SECTION 06-00201-02-BR INCLUDES A PROPOSED SINGLE SPAN (65.5 FT), PRECAST, PRESTRESSED, CONCRETE DECK BEAM BRIDGE, 27" DEEP DECK BEAMS.

ROADWAY CLASSIFICATION : URBAN COLLECTOR
CURRENT ADT: 900
DESIGN SPEED: 30 mph
DESIGN FREQUENCY: 30 YEAR STORM

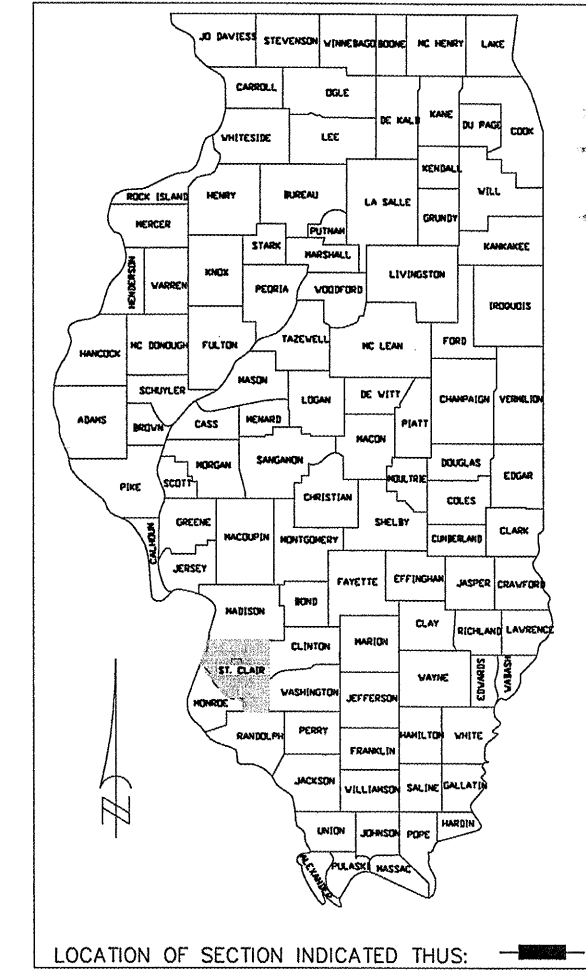

March 18, 2011

These plans were prepared by me or by a full-time member of my staff working under my personal supervision.



Darrell Cates
DARRELL I. CATES, P.E.
County Engineer
License Number 062-042908
License Expiration Date: November 30, 2011

STATE OF ILLINOIS
DEPARTMENT OF TRANSPORTATION
DIVISION OF HIGHWAYS

APPROVED March 18, 20 11
Darrell Cates
COUNTY ENGINEER

PASSED April 5, 20 11
Mary C. Lamie
DISTRICT ENGINEER OF LOCAL ROADS & STREETS

Releasing for Bid April 5, 20 11
Based on Limited Review
Mary C. Lamie
Mary C. Lamie, PE
DEPUTY DIRECTOR OF HIGHWAYS, REGION FIVE ENGINEER

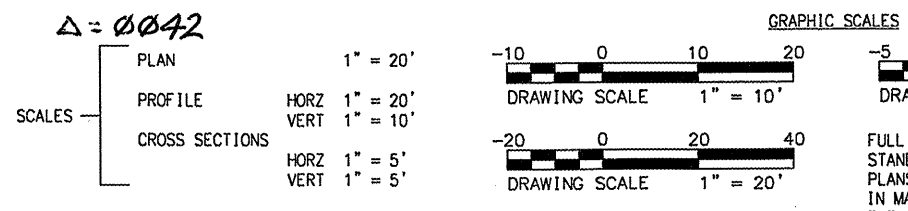

STANDARDS

000001-06	635011-02
515001-03	667101-01
630301-05	701901-01
631032-06	BLR 21-8
635006-03	

Call Joint Utility Locating Information for Excavators (J.U.L.I.E.) before digging 800-892-0123

CASEYVILLE TOWNSHIP T.2N., R.8W.
S.E. 1/4 OF THE N.E. 1/4 SECTION 17
S.W. 1/4 OF THE N.W. 1/4 SECTION 16

PRINTED BY AUTHORITY OF THE STATE OF ILLINOIS

PLOT DATE: 3/11