

| | | | |
|--------------------------|----------------|---------------------|-----------------|
| SECTION NO. | COUNTY HIGHWAY | COUNTY | SHEET OF SHEETS |
| 06-00201-02-BR | C.H.58 | ST. CLAIR | 11 of 13 |
| FHWA REG.NO.7 | ILLINOIS | PROJ: BRM-5011(309) | |
| STA 90+70.94 TO 92+15.01 | | CONTRACT 97465 | |

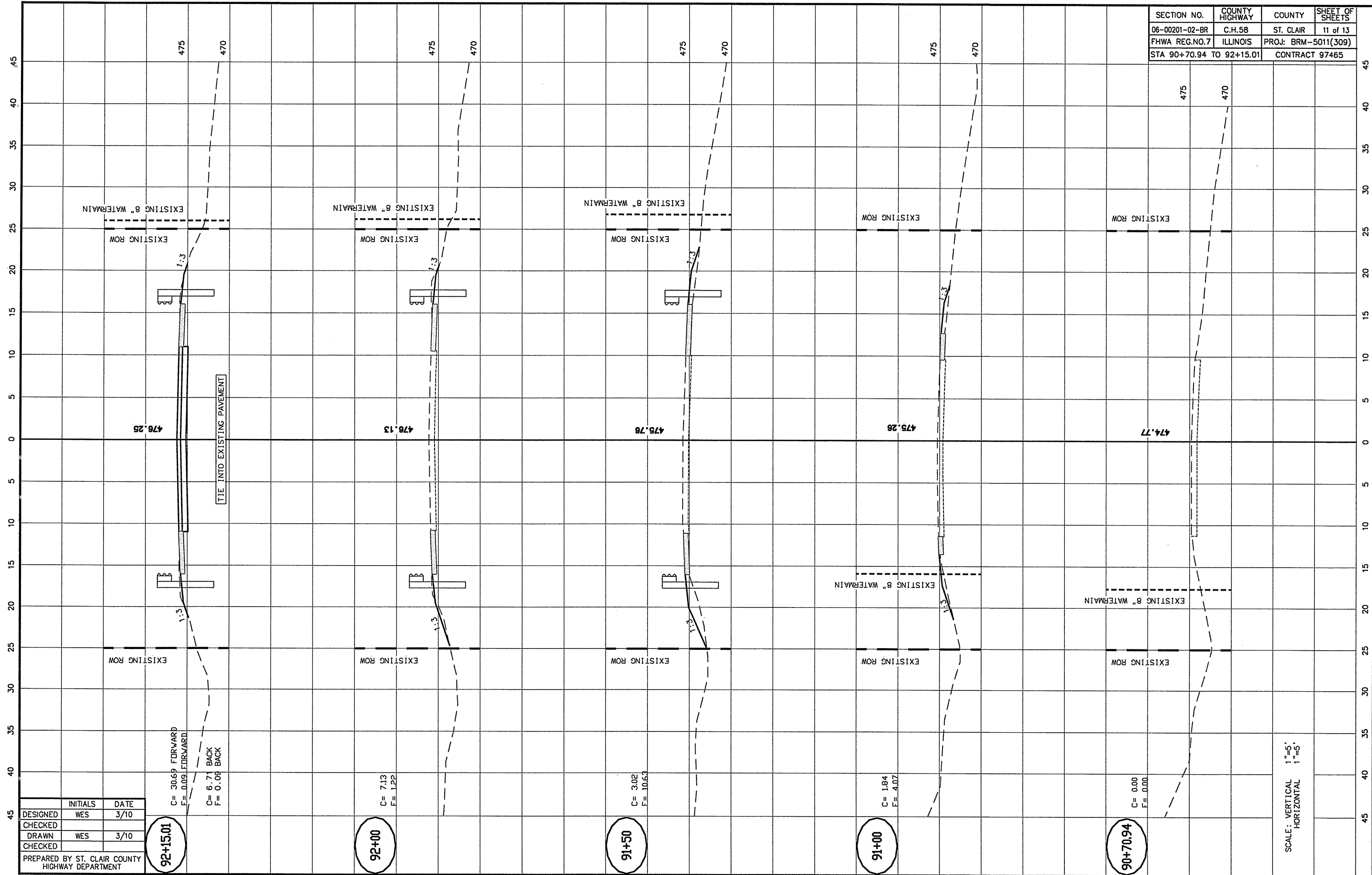

C = 30.69 FORWARD
F = 0.09 FORWARD
C = 6.71 BACK
F = 0.08 BACK

92+15.01

C = 7.13
F = 1.22

92+00

C = 3.02
F = 10.63

91+50

C = 1.84
F = 4.07

91+00

C = 0.00
F = 0.00

90+70.94

| | INITIALS | DATE |
|----------|----------|------|
| DESIGNED | WES | 3/10 |
| CHECKED | | |
| DRAWN | WES | 3/10 |
| CHECKED | | |

PREPARED BY ST. CLAIR COUNTY HIGHWAY DEPARTMENT

SCALE: VERTICAL 1"=5'
HORIZONTAL 1"=5'