

SECTION NO.	COUNTY HIGHWAY	COUNTY	SHEET OF SHEETS
06-00201-02-BR	C.H.58	ST. CLAIR	12 of 13
FHWA REG.NO.7	ILLINOIS	PROJ: BRM-5011(309)	
STA 92+27.05 TO 93+06.59		CONTRACT 97465	

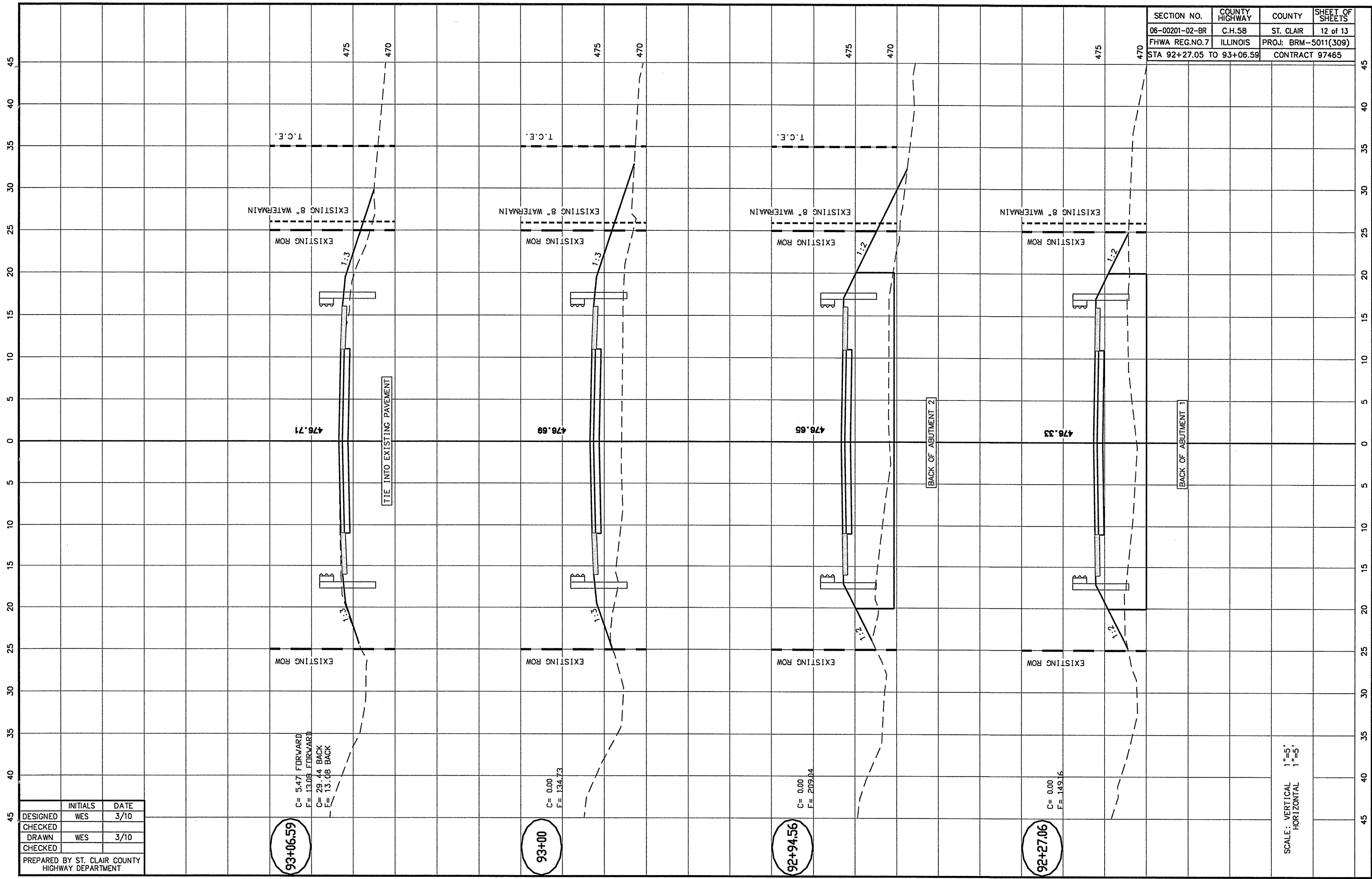

93+06.59
C= 5.47 FORWARD
F= 13.08 FORWARD
C= 29.44 BACK
F= 13.08 BACK

93+00
C= 0.00
F= 134.73

92+94.56
C= 0.00
F= 209.04

92+27.06
C= 0.00
F= 149.16

	INITIALS	DATE
DESIGNED	WES	3/10
CHECKED		
DRAWN	WES	3/10
CHECKED		
PREPARED BY ST. CLAIR COUNTY HIGHWAY DEPARTMENT		

SCALE: VERTICAL 1"=5'
HORIZONTAL 1"=5'