

PRE-STAGE NOTES

1. REMOVE ONLY THE AMOUNT OF EXISTING CURB AND GUTTER NECESSARY TO CONSTRUCT ALL OF PROPOSED.
(THE CONTRACTOR HAS THE OPTION TO REMOVE ALL CURB AND GUTTER IF APPROVED BY THE ENGINEER.)
2. REPLACE THE EXISTING STORM SEWER AND INLETS AS SHOWN ON THE STORM SEWER PLAN FOR THIS INTERSECTION.
3. PLACE A TEMPORARY CLASS D PATCH OVER THE PROPOSED STORM SEWER.
4. PLACE AGGREGATE FOR TEMPORARY ACCESS AT THE NEW ENTRANCES AS REQUIRED BY THE ENGINEER FOR ACCESS DURING STAGE CONSTRUCTION.
5. THE CONTRACTOR HAS THE OPTION TO CORE OUT THE PROPOSED ENTRANCE FOR PROPOSED P.C.C. DRIVE PAVEMENT 7 INCH. IF THIS OPTION IS USED, THEN ANY ENTRANCE PAVEMENT THAT BECOMES DAMAGED DURING THE STAGING OPERATIONS WILL BE TOTALLY REPLACED AT THE CONTRACTOR'S EXPENSE. NO PATCHING WILL BE PERMITTED ON NEW ENTRANCES.
6. ALL PRE-STAGE WORK IN THE SOUTHWEST QUADRANT SHALL BE DONE AT NIGHT.

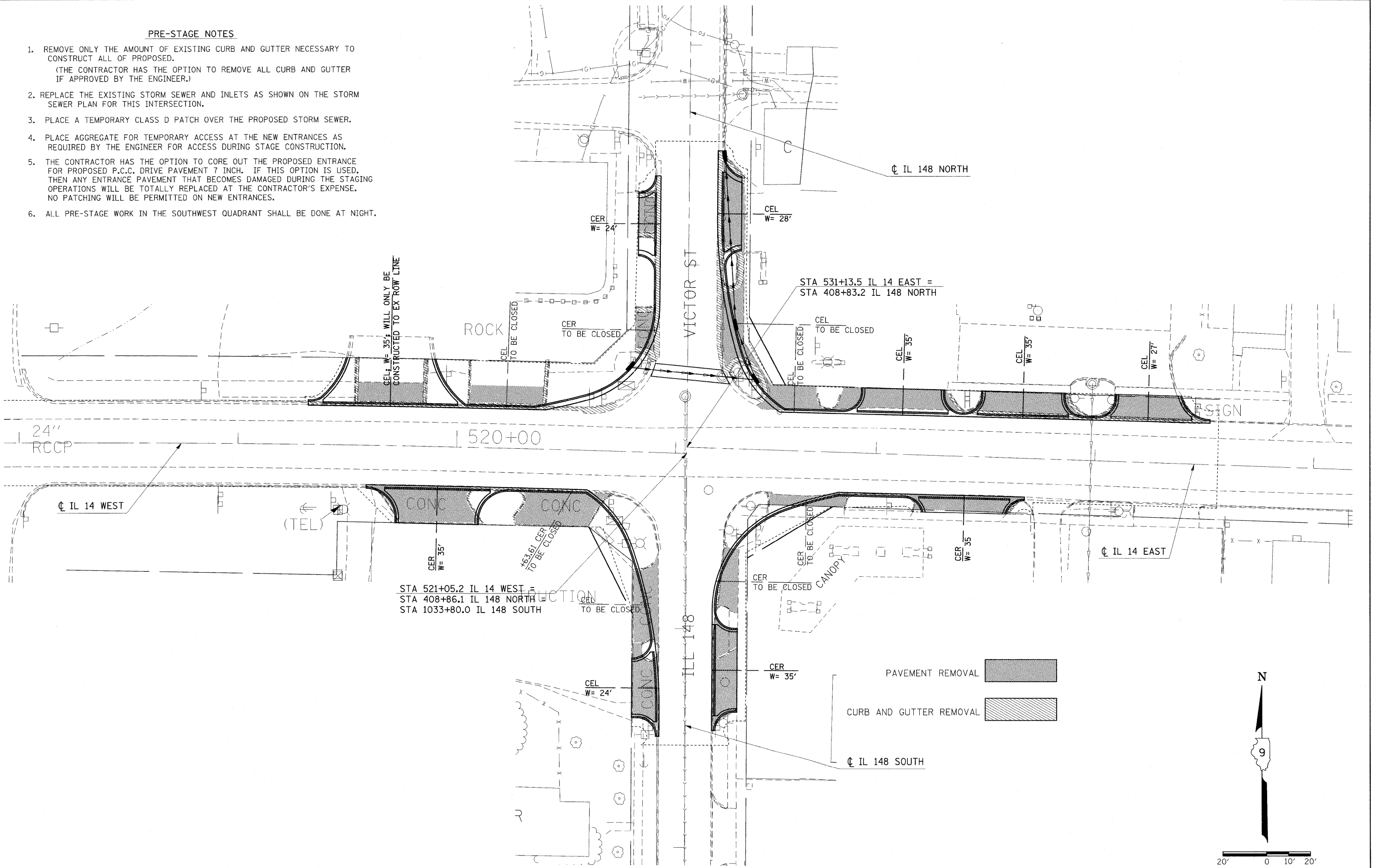

FILE NAME =	USER NAME = #USER#	DESIGNED -	REVISED -	STATE OF ILLINOIS DEPARTMENT OF TRANSPORTATION	PRE-STAGE WORK			F.A.P. RTE.	SECTION	COUNTY	TOTAL SHEETS	SHEET NO.
#FILE#		DRAWN -	REVISED -		SCALE: 20	SHEET NO. OF	SHEETS	STA.	TO STA.	*	299	59
		CHECKED -	REVISED -							*	PERRY & FRANKLIN COUNTY	CONTRACT NO. 98797
		DATE -	REVISED -							ILLINOIS FED. AID PROJECT		