

STAGING NOTES

1. CHANGEABLE MESSAGE SIGNS REQUIRED AT US 51.
2. IL 148 NORTHBOUND TURNING MOVEMENT CLOSED TO IL 14 EASTBOUND TRAFFIC.
3. CHANGEABLE MESSAGE SIGN REQUIRED AT IL 154.
4. IL 14 WESTBOUND TURNING MOVEMENT CLOSED TO IL 148 SOUTHBOUND TRAFFIC.
5. SEE TYPICAL SECTION FOR ROADWAY STAGING DIMENSIONS.

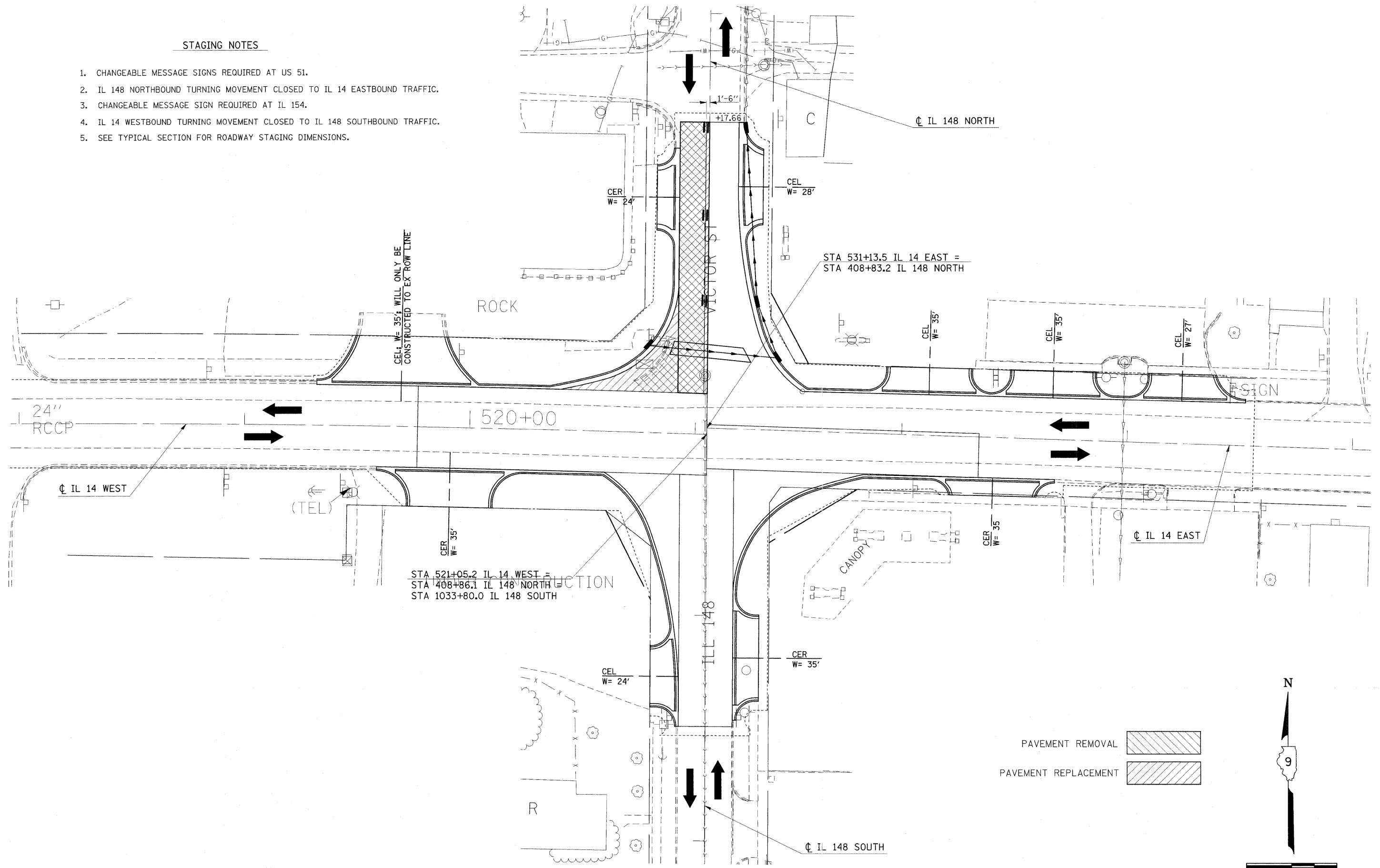

FILE NAME =	USER NAME = #USER#	DESIGNED -	REVISED -	STATE OF ILLINOIS DEPARTMENT OF TRANSPORTATION	STAGE 6: IL 14 /IL 148 INTERSECTION			F.A.P. RTE.	SECTION	COUNTY	TOTAL SHEETS	SHEET NO.			
#FILE#		DRAWN -	REVISED -		SCALE: 20	SHEET NO.	OF	SHEETS	STA.	TO STA.	869	(1-1,3,6)R-1,RS-3(1,3,6)B-2	*	299	65
		CHECKED -	REVISED -								* PERRY & FRANKLIN COUNTY CONTRACT NO. 98797				
		DATE -	REVISED -								ILLINOIS FED. AID PROJECT				