

GEORGE BYARS
NE 1/4, SEC 2, T. 2 S., R. 4 E., 3RD P.M.

PROP. CURVE DATA
 PI Sta. 12+48.94
 $\Delta = 89^\circ 39' 12''$ (LT)
 $D = 34^\circ 43' 29''$
 $T = 164.01'$
 $R = 165.00'$
 $L = 258.18'$
 $E = 67.64'$
 PC Sta. 10+84.94
 PT Sta. 13+43.12
 S.E. = 4.0%
 S.E. TRANSITIONS:
 STA. 10+69.00 TO STA. 11+54.86
 STA. 13+22.79 TO STA. 14+08.65

RT. STA. 13+67 F.E.
 PIPE CULVERTS, TY. 1, CL. A, 24"
 42' F.T. LONG
 EXISTING CMP TO BE REMOVED

INDICATES TEMPORARY
 CONSTRUCTION EASEMENT

JIMMIE LEE WIGGINS, et al
 NE 1/4, SEC 2, T. 2 S., R. 4 E., 3RD P.M.

P.O.T. STA. 14+32.68
 MAG NAIL (SET)
 N. 1,253.565
 E. 1,250.477

P.O.T. STA. 16+93.48
 1/2" Ø IRON PIN (SET)
 N. 1,514.352
 E. 1,252.054

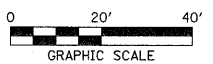

DATE	
BY	
REVISIONS	
NO.	
DATE	
BY	
REVISIONS	
NO.	
DATE	
BY	
REVISIONS	
NO.	

DATE	
BY	
REVISIONS	
NO.	
DATE	
BY	
REVISIONS	
NO.	
DATE	
BY	
REVISIONS	
NO.	

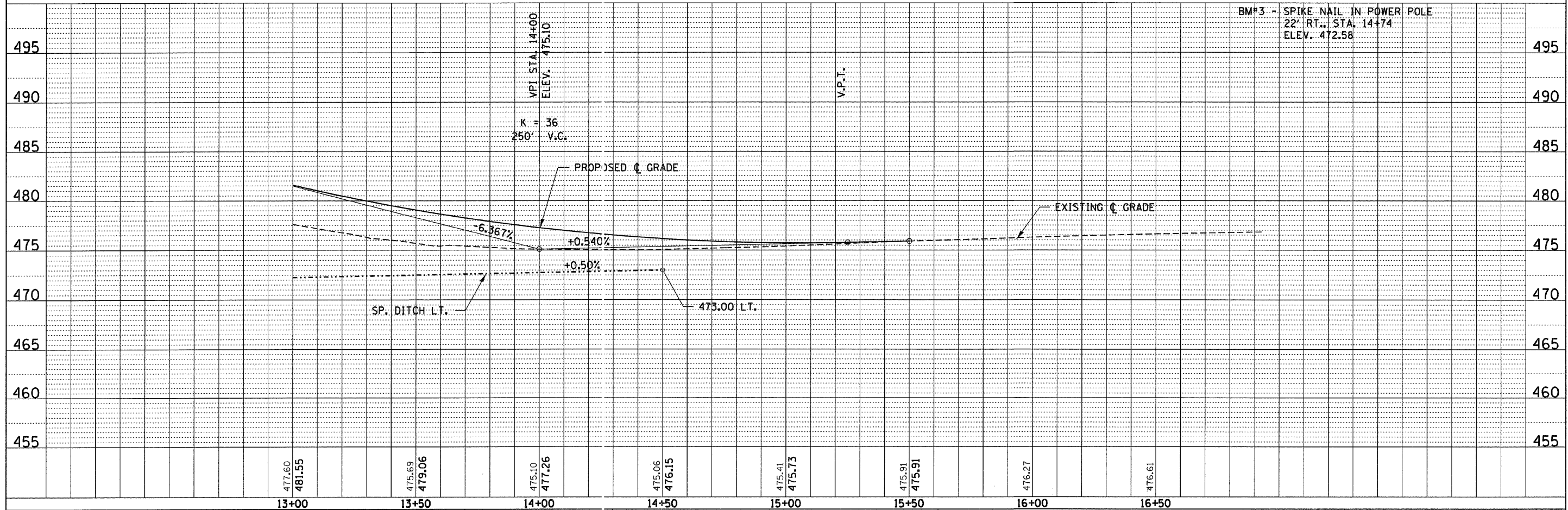

FILE NAME = 898172-shr-pp4.dgn	USER NAME =	DESIGNED - L.F.S.	REVISED -	STATE OF ILLINOIS JEFFERSON COUNTY HIGHWAY DEPARTMENT	PLAN & PROFILE DENKER ROAD	T.R.	SECTION	COUNTY	TOTAL SHEETS	SHEET NO.
HAMPTON, LENZINI AND RENWICK, INC. 3035 STEVENSON DRIVE, SUITE 201 SPRINGFIELD, ILLINOIS 62769		DRAWN - D.T.M.	REVISED -			165B	05-16113-00-BR	JEFFERSON	34	8
ILLINOIS PROFESSIONAL DESIGN FIRM 15 / PE / SE CORP. 134.000969	PLOT SCALE =	CHECKED - S.W.M.	REVISED -			WEBBER ROAD DISTRICT		CONTRACT NO.		
	PLOT DATE = 2/4/2011	DATE - 05/19/10	REVISED -			FED. ROAD DIST. NO.	ILLINOIS FED. AID PROJECT			