

**GENERAL NOTES:**

THIS SECTION SHALL BE CONSTRUCTED IN ACCORDANCE WITH THE PLANS, SPECIAL PROVISIONS AND "STANDARD SPECIFICATIONS FOR ROAD AND BRIDGE CONSTRUCTION", ADOPTED JANUARY 1, 2007.

THE WORK INVOLVED ON THIS SECTION CONSISTS OF THE REMOVAL OF THE EXISTING STRUCTURE, THE CONSTRUCTION OF A 75 FOOT LONG SINGLE SPAN PRECAST, PRESTRESSED CONCRETE DECK BEAM BRIDGE, EARTH APPROACHES, AGGREGATE SURFACE COURSE AND OTHER MISCELLANEOUS ITEMS NECESSARY TO COMPLETE THIS SECTION.

ALL ELEVATIONS ARE BASED ON U.S.G.S. MEAN SEA LEVEL DATUM.

IT SHALL BE THE CONTRACTOR'S RESPONSIBILITY TO CONTACT ALL THE UTILITIES, AFFECTING THE PROJECT, PRIOR TO CONSTRUCTION.

AGGREGATE SURFACE COURSE, TYPE B INCLUDES 24 TON FOR FILL NEXT TO THE BRIDGE, 56 TON FOR FIELD ENTRANCES, AND 360 TON FOR THE ROADWAY.

**NOTE: CONSTRUCTION TRANSITION**  
 STA. 1+70 TO STA 2+20  
 STA. 7+80 TO STA 8+30

ALL QUANTITIES ARE INCLUDED IN THE PROPOSAL

P.I. STA= 2+38.4  
 $\Delta = 00^{\circ}32'07''$  LT

P.I. STA= 7+42.5  
 $\Delta = 00^{\circ}37'08''$  RT

T.R.	SECTION	COUNTY	TOTAL SHEETS	SHEET NO.
296B	08-09114-00-BR	HAMILTON	12	2
FED. ROAD DIST. NO. 9 ILLINOIS		FED. AID PROJECT		
PROJECT# BROS 0651047		CONTRACT# 99454		
JOB NO. C-99-511-09		SOUTHERN OUTLET		
LEC JOB # H081017M				

323 W. 3RD ST.  
 P.O. BOX 160  
 MT. CARMEL, IL  
 62863  
 PHONE:  
 (618)-262-8651  
 FAX:  
 (618)-263-3327

405 W. STATE ST.  
 SUITE 1  
 PRINCETON, IN  
 47670

PHONE:  
 (812)-386-7611  
 FAX:  
 (812)-385-2812



PROFESSIONAL DESIGN FIRM  
 LAND SURVEY &  
 PROFESSIONAL  
 ENGINEERING  
 CORPORATION  
 184-000887  
 (62-032435)(35-002769)

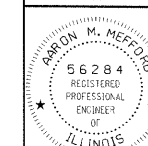

AARON M. MEFFORD

NAME  
 SIGNATURE

DATE  
 2-24-11

11-30-11  
 EXPIRES

TOWNSHIP ROUTE 296B  
 OVER SOUTHERN OUTLET  
 HAMILTON COUNTY, ILLINOIS

SHEET TITLE:

PLAN & PROFILE

SCALE: VARIES

BY: AMM

DATE: 2/11

REV:

2 OF 12  
 SHEETS

SHEET NO.

2

TYPICAL CROSS SECTION  
 PROPOSED

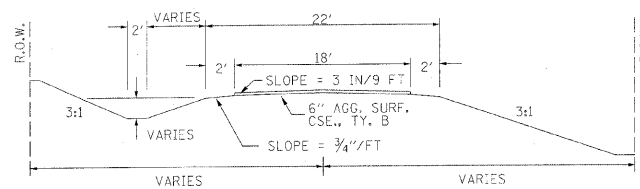

TYPICAL CROSS SECTION  
 EXISTING

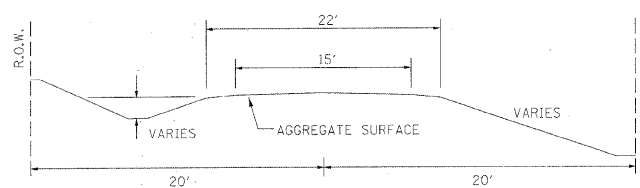

**UTILITIES:**

JULI.E. 1-800-892-0123

**FIELD ENTRANCE DETAIL**

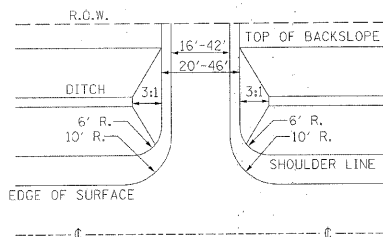

NOTE: CONSTRUCT SPECIAL DITCH

STA 2+50 TO STA 4+67 LT  
 STA 2+00 TO STA 4+15 RT  
 STA 6+50 TO STA 8+30 LT  
 STA 6+50 TO STA 8+30 RT

NOTE: CONSTRUCT STONE LINED DITCH

STA 4+17 TO STA 4+67 LT (0.62 TON/LIN FT)  
 31 TON STONE LINED DITCH.

SEE STONE LINED DITCH DESIGN.

**STONE LINED DITCH DESIGN**

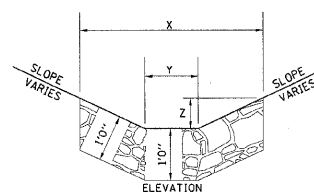
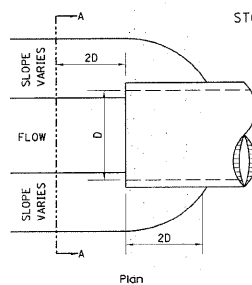

NOTE:

BOTTOM OF DITCH	SLOPE		
	1 1/2:1	2:1	3:1
2 FT	x= 5 FT	6 FT	8 FT
	y= 2 FT	2 FT	2 FT
	z= 1 FT	1 FT	1 FT
	0.40	0.48	0.62 TON/LIN. FT

NOTE: FOR PLACEMENT, QUALITY GRADATION AND OTHER MISCELLANEOUS REQUIREMENTS FOR STONE LINED DITCH-SEE SPECIAL PROVISIONS.

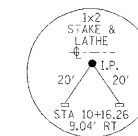
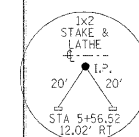
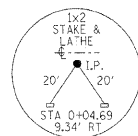
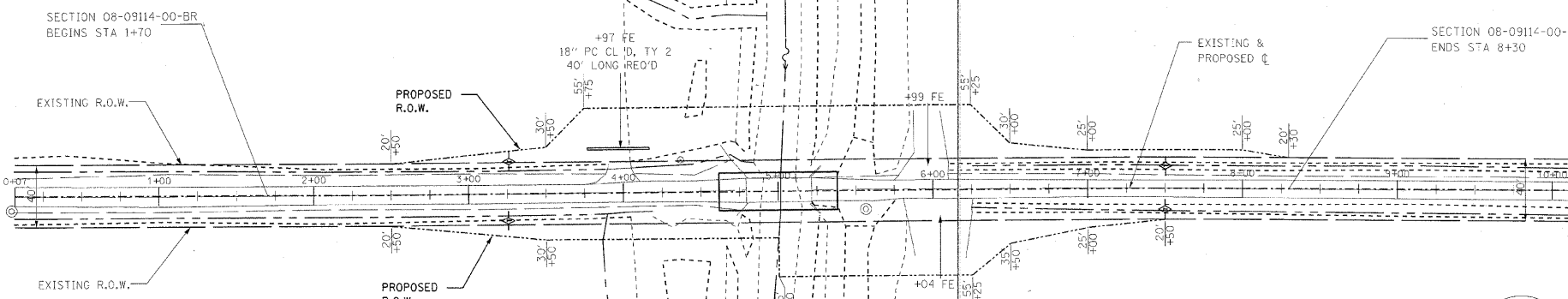

EXISTING BRIDGE STA 5+00.5; STRUCTURE NUMBER: 033-3100  
 A 40' LONG SINGLE SPAN BRIDGE WITH A 6" CONCRETE DECK ON  
 9-20" I BEAMS ON CONCRETE ABUTMENTS WITH CONCRETE WINGWALLS.

ONE (1) EACH-REMOVAL OF EXISTING STRUCTURES ALLOWED IN THIS PROPOSAL.

PROPOSED STRUCTURE: NO. 033-3314, STA 5+00,  
 A 75' LONG SINGLE SPAN P.P.C.D.B. BRIDGE  
 WITH 33" DEPTH BEAMS, SPILL THROUGH TYPE  
 ABUTMENTS, 24' WIDTH, 0° SKEW.

SEE BRIDGE PLAN SHEETS FOR THE DESIGN AND BILL OF MATERIALS.

NOTE: FILL NEXT TO BRIDGE TO BE  
 AGGREGATE SURFACE COURSE

6.0 UNITS TREE REMOVAL (6 TO 15 UNITS DIAMETER)  
 28.0 EACH TEMPORARY DITCH CHECKS  
 0.6 ACRES SEEDING, CLASS 2 SPECIAL REQUIRED

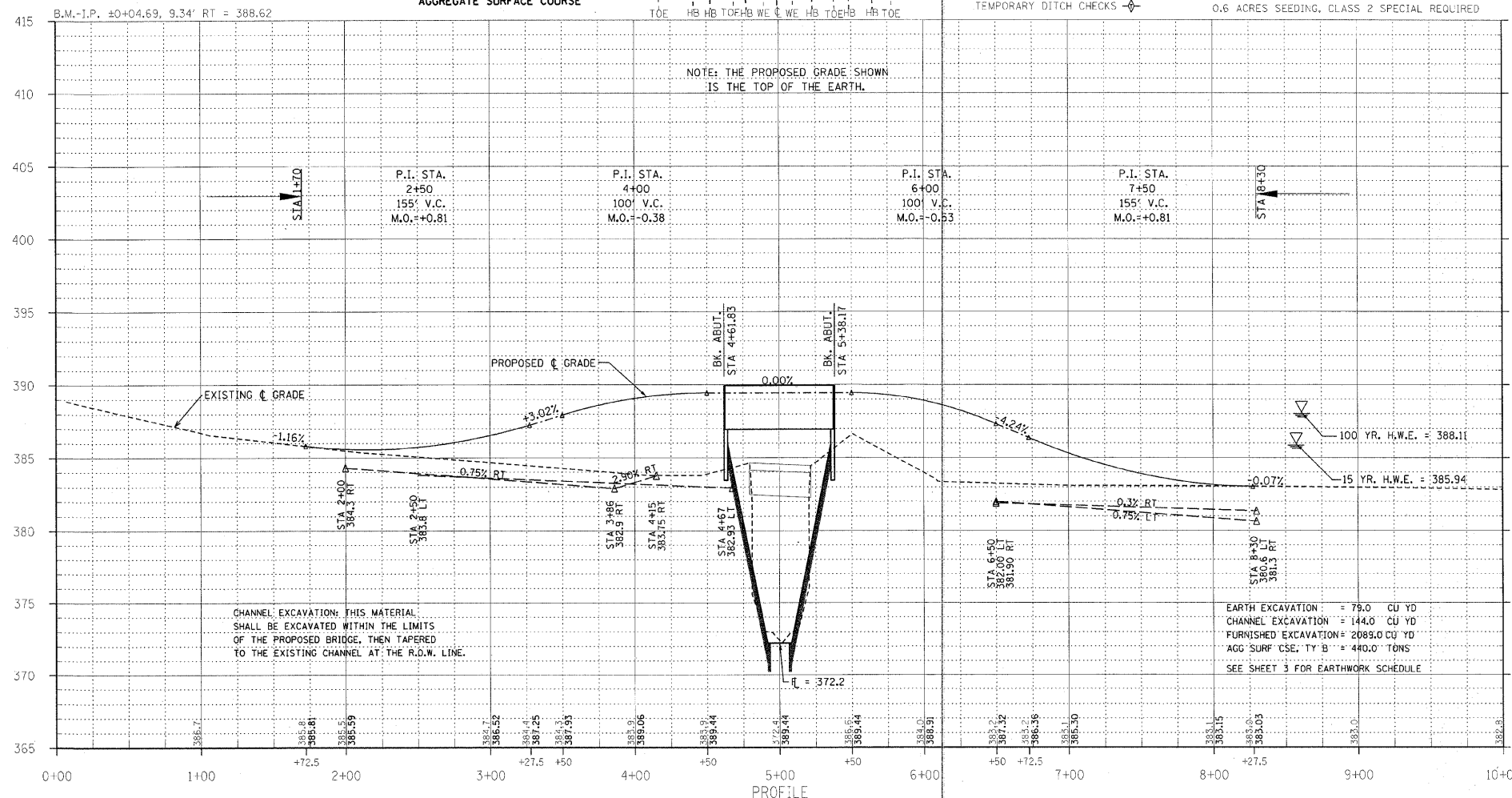

NOTE: THE PROPOSED GRADE SHOWN  
 IS THE TOP OF THE EARTH.

CHANNEL EXCAVATION: THIS MATERIAL SHALL BE EXCAVATED WITHIN THE LIMITS OF THE PROPOSED BRIDGE, THEN TAPERED TO THE EXISTING CHANNEL AT THE R.O.W. LINE.

EARTH EXCAVATION = 79.0 CU YD  
 CHANNEL EXCAVATION = 144.0 CU YD  
 FURNISHED EXCAVATION = 2083.0 CU YD  
 AGG SURF CSE, TY B = 440.0 TONS  
 SEE SHEET 3 FOR EARTHWORK SCHEDULE