

06-17-2022 LETTING ITEM 018

STATE OF ILLINOIS
DEPARTMENT OF TRANSPORTATION
DIVISION OF HIGHWAYS

F.A.P. RTE.	SECTION	COUNTY	TOTAL SHEETS	SHEET NO.
595	**	ROCK ISLAND	4	1

**D2 PP 2022-5
CONTRACT NO. 64R47
D-92-014-22

FOR INDEX OF SHEETS & STATE STANDARDS
SEE SHEET NO. 2

PROPOSED HIGHWAY PLANS

F.A.P. ROUTE 595 (IL 5)
SECTION D2 PP 2022-5
ROCK ISLAND COUNTY
C-92-062-22

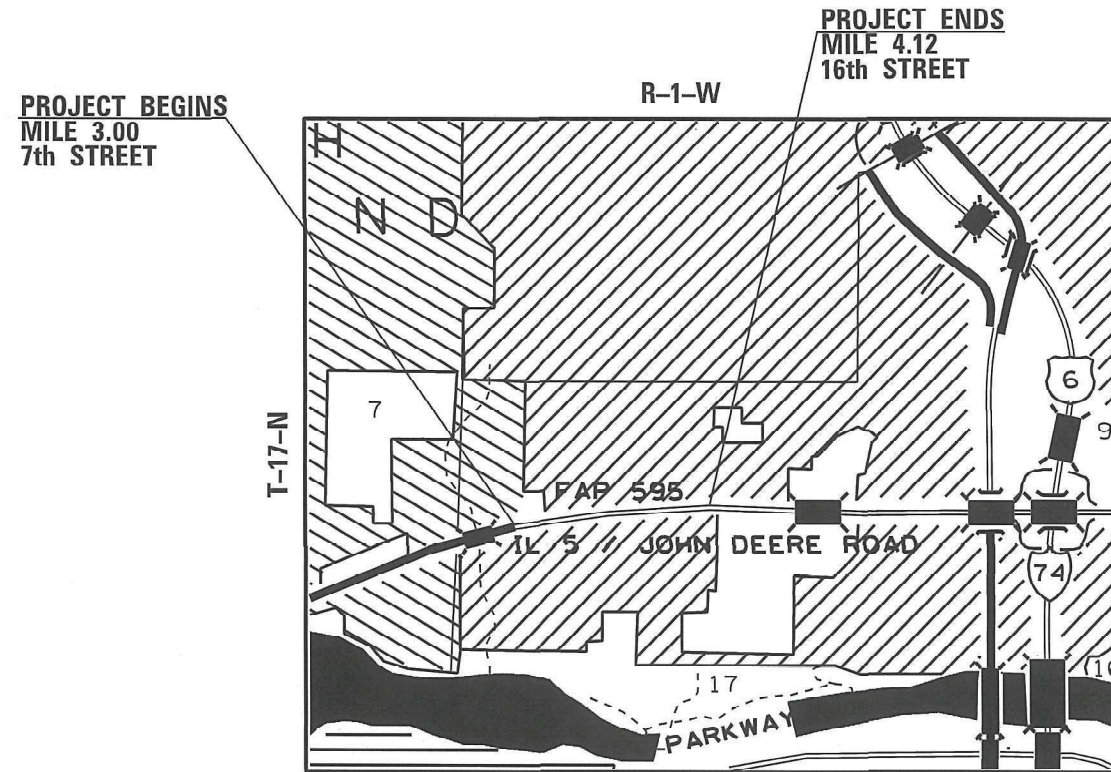

GROSS LENGTH OF PROJECT = 5914 FOOT = 1.12 MILES
NET LENGTH OF PROJECT = 5914 FOOT = 1.12 MILES

TOWNSHIP (SECTION):
SOUTH MOLINE (7,8,9,16,17,18)

J.U.L.I.E.
JOINT UTILITY LOCATION INFORMATION FOR EXCAVATION
1-800-892-0123

STATE OF ILLINOIS
DEPARTMENT OF TRANSPORTATION
DIVISION OF HIGHWAYS

SUBMITTED March 05, 20 22

[Signature]
REGION ENGINEER

May 13, 2022 [Signature]
ENGINEER OF DESIGN AND ENVIRONMENT

May 13, 2022 [Signature]
DIRECTOR OF HIGHWAYS PROJECT IMPLEMENTATION

PRINTED BY THE AUTHORITY
OF THE STATE OF ILLINOIS

PROJECT ENGINEER: SCOTT KULLERSTRAND

SQUAD LEADER: LANCE NICKLAUS 815-284-5407

INDEX

- 1 Cover Sheet
- 2 Index of Sheets / State Standards
- 3 Summary of Quantities
- 4 General Notes

STATE STANDARDS

- | | |
|-----------|--|
| 420001-10 | PAVEMENT JOINTS |
| 420701-03 | PAVEMENT WELDED WIRE REINFORCEMENT |
| 442101-09 | CLASS B PATCHES |
| 701101-05 | OFF-ROAD OPERATIONS, MULTILANE, 15'(4.5m) TO 24"(600mm) FROM PAVEMENT EDGE |
| 701422-10 | LANCE CLOSURE, MULTILANE, FOR SPEEDS \geq 45 MPH TO 55 MPH |
| 701601-09 | URBAN LANE CLOSURE, MULTILANE, 1W OR 2W WITH NONTRAVERSABLE MEDIAN |
| 701701-10 | URBAN LANE CLOSURE, MULTILANE INTERSECTION |
| 701901-08 | TRAFFIC CONTROL DEVICES |
| 720011-01 | METAL POST FOR SIGNS, MARKERS AND DELINEATORS |
| 728001-01 | TELESCOPING STEEL SIGN SUPPORT |
| 729001-01 | APPLICATIONS OF TYPES A AND B METAL POST (FOR SIGNS & MARKERS) |

DISTRICT STANDARDS

- | | |
|------|---|
| 94.2 | Traffic Control & Protection at Turn Bays (To Remain Open to Traffic) |
| 34.1 | Work Zone Sign Details |

SUMMARY OF QUANTITIES

FAP 595 (IL 5)
SECTION D2 PP 2022-5
ROCK ISLAND COUNTY
CONTRACT #64R47
SHEET 3 OF 4

URBAN

100% State
0096

CODE NO.	ITEM	UNIT	TOTAL QUANTITY
44200050	WELDED WIRE REINFORCEMENT	SQ. YDS.	335
44200970	CLASS B PATCHES, TYPE II 10"	SQ. YDS.	4,328
44200974	CLASS B PATCHES, TYPE III 10"	SQ. YDS.	164
44200976	CLASS B PATCHES, TYPE IV 10"	SQ. YDS.	170
44201294	CLASS B PATCH - EXPANSION JOINT	FOOT	72
44201299	DOWEL BARS 1 1/2"	EACH	10120
44213200	SAW CUT	FOOT	15518
44213204	TIE BARS 3/4"	EACH	58
67100100	MOBILIZATION	L SUM	1
70100320	TRAFFIC CONTROL AND PROTECTION, STANDARD 701422	L SUM	1
70102630	TRAFFIC CONTROL AND PROTECTION, STANDARD 701601	L SUM	1
70102635	TRAFFIC CONTROL AND PROTECTION, STANDARD 701701	L SUM	1
70103815	TRAFFIC CONTROL SURVEILLANCE	CAL DAY	15
70106800	CHANGEABLE MESSAGE SIGN	CAL MO	4

REV. 3/30/22

GENERAL NOTES

Closed expansion joints on jointed pavements shall be re-established during the patching operations. Class B Patches - when the pavement requires patching at the location of the expansion joint, a new joint should be established using a dowelled expansion patch as shown on Highway Standard 442101. When the joint is closed, but does not require patching, an expansion joint may be formed by sawing the pavement and filling the saw cut with a preformed expansion joint filler meeting the requirements of Section 1051 of the Standard Specifications as shown on Standard 420001.

When laying out for patching, the minimum distance between new patches (saw cut to saw cut) shall be 15 feet. When patch spacing is less than 15 feet, the pavement between patches shall also be removed and replaced.

The RE shall contact Stephanie McMeekan at (815) 677-5282 for patching layout.

FILE NAME = 64R47.GN.DOCX	USER NAME =	DESIGNED - Engineering Systems	REVISED -	STATE OF ILLINOIS DEPARTMENT OF TRANSPORTATION	GENERAL NOTES			ROUTE	SECTION	COUNTY	TOTAL SHEETS	SHEET NO.
	PLOT SCALE =	DRAWN -	REVISED -					FAP 595 (IL 5)	D2 PP 2022-5	Rock Island		1
	PLOT DATE = 3/9/2022 9:41 AM	CHECKED -	REVISED -		SCALE: SHEET NO. OF SHEETS STA. TO STA.			ILLINOIS		CONTRACT NO. 64R47		
	DATE - 3/9/2022 9:36 AM	DATE - 3/9/2022 9:36 AM	REVISED -		FED. AID PROJECT							