

STATE OF ILLINOIS
DEPARTMENT OF TRANSPORTATION

F.A. RTE.	SECTION	COUNTY	TOTAL SHEETS	SHEET NO.
	D9 Patch 2022-8	GALLATIN	6	1
		ILLINOIS	CONTRACT NO. 78950	

FAP 331/FAP 782

FOR INDEX OF SHEETS, SEE SHEET NO. 3
FOR SUMMARY OF QUANTITIES, SEE SHEET NO. 4

**PROPOSED
HIGHWAY PLANS**

FAP ROUTE 331/782 (IL 13/L 1)
SECTION D9 PATCH 2022-8

**TRAFFIC DATA
2021: ADT 3500**

**PATCHING
GALLATIN COUNTY**

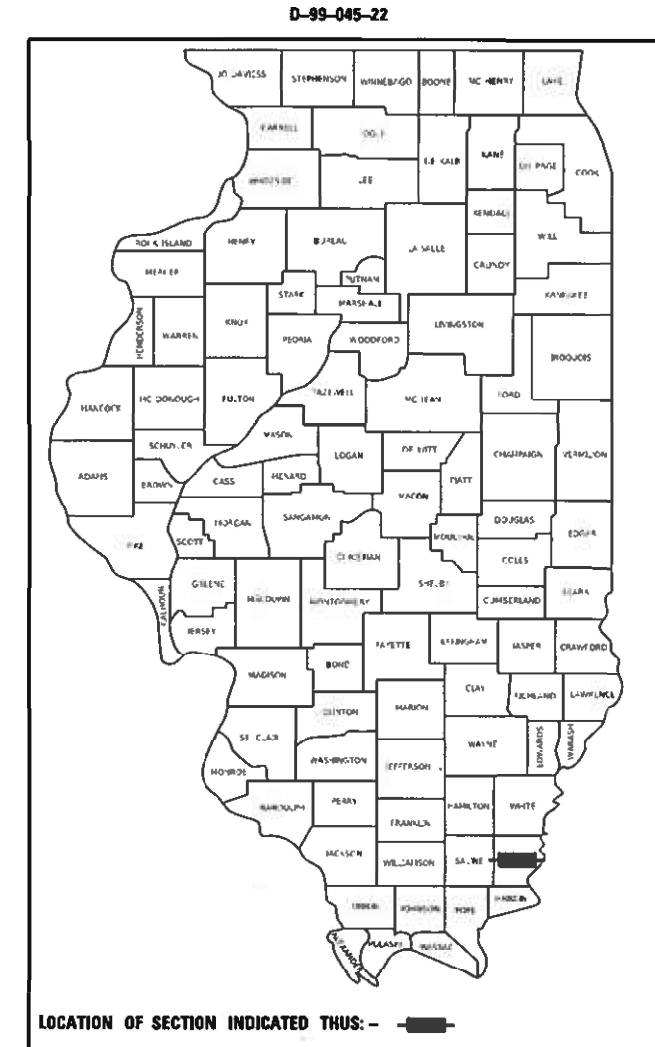

C-99-058-22

IL 13/L 1 INTERSECTION
IL 13 STA: 1803+70 TO STA: 1842+40
IL 1 STA: 205+97 TO STA: 212+61

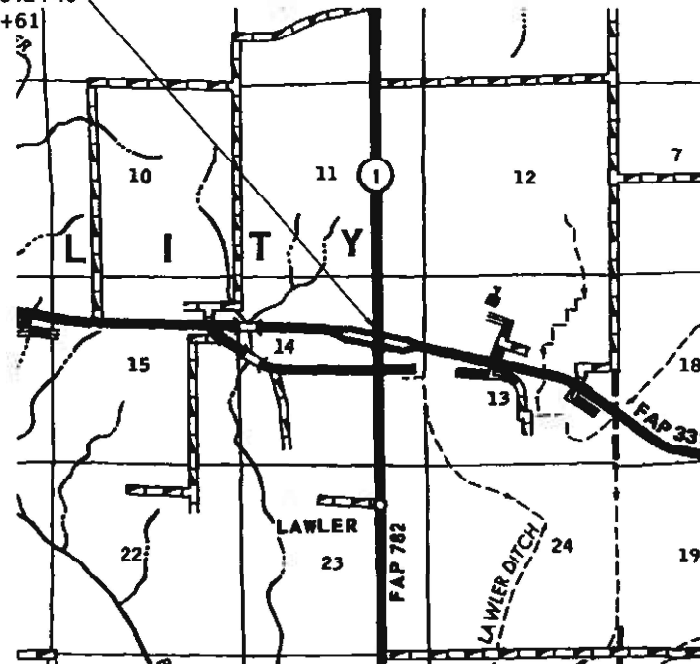

**TOWNSHIPS
EQUALITY**

DESIGN DESIGNATION : N/A
COORDINATE SYSTEM : N/A
POSTED SPEED : 55 MPH

J.U.L.I.E.
JOINT UTILITY LOCATION INFORMATION FOR EXCAVATION
1-800-892-0123
OR 811

PROJECT ENGINEER: VALERIE ROLLA
PROJECT DESIGNER: JAXON HORN

CONTRACT NO. 78950

GROSS LENGTH = 2196.98 FT. = 0.42 MILES
NET LENGTH = 2196.98 FT. = 0.42 MILES

STATE OF ILLINOIS
DEPARTMENT OF TRANSPORTATION

SUBMITTED March 11 20 22

Stephen M. Travia
REGION FIVE ENGINEER

May 13, 2022 [Signature]
ENGINEER OF DESIGN AND ENVIRONMENT

May 13, 2022 [Signature]
DIRECTOR OF HIGHWAYS PROJECT IMPLEMENTATION

**PRINTED BY THE AUTHORITY
OF THE STATE OF ILLINOIS**

MODEL: Default
 FILE: \\MAIL\bin\libas-gp-wb-115y.com\FW\FDOT\Documents\1510DOT_Offices\District 9\Projects\78950\Gallatin\Contract\0978950_Sheet.dgn

Prepared By: Charles Stein
 DISTRICT STUDIES & PLANS ENGINEER

Examined By: Naugette
 DISTRICT LAND ACQUISITION ENGINEER

Examined By: Carrie Nelson
 DISTRICT PROGRAM DEVELOPMENT ENGINEER

Examined By: RCS
 DISTRICT OPERATIONS ENGINEER

Examined By: Douglas Wehler
 DISTRICT PROJECT IMPLEMENTATION ENGINEER

Examined By: Douglas Wehler
 DISTRICT CONSTRUCTION ENGINEER

Examined By: RCS
 DISTRICT MATERIALS ENGINEER

USER NAME = HORNIJ	DESIGNED -	REVISED -
DRAWN -	CHECKED -	REVISED -
PLOT SCALE = 100,0000' / in.	DATE -	REVISED -
PLOT DATE = 2/25/2022		

**STATE OF ILLINOIS
 DEPARTMENT OF TRANSPORTATION**

SIGNATURE SHEET

SCALE:	SHEET	OF	SHEETS	STA.	TO STA.
--------	-------	----	--------	------	---------

F.A. RTE.	SECTION	COUNTY	TOTAL SHEETS	SHEET NO.
"	D9 Patch 2022-8	GALLATIN	6	2
ILLINOIS FED. AID PROJECT			CONTRACT NO. 78950	

INDEX OF SHEETS

- 1 COVER
- 2 SIGNATURE SHEET
- 3 INDEX, GENERAL NOTES, STANDARDS
- 4 SUMMARY OF QUANTITIES
- 5-6 PATCHING SCHEDULE

HIGHWAY STANDARDS

- 000001-08
- 001001-02
- 001006
- 420001-10
- 442101-09
- 701301-04
- 701336-07
- 701901-08

GENERAL NOTES

COMMITMENTS: NONE

HMA MIXTURE REQUIREMENTS TABLES

The following HMA mixture requirements are applicable for this project

Location(s):	Partial Depth Patching (2")
Mixture Use(s):	Hot Mix Asphalt Surface Course, Mix D, N70
PG:	PG 64-22
Design Air Voids:	4.0 %, 70 Gyration Design
Mixture Composition:	IL-9.5mm
Friction Aggregate:	Mix D
Mixture Weight:	112 lbs/Sq Yd/in
Quality Management Program:	QCQA
Sublot Size:	NA
Material Transfer Device (Required?)	No

REV. - MS

MODEL: Default
 FILE: M:\GIS\p\illinois\benley.com\p\DOT\Documents\DOT_Offices\District_9\Project\78950\CAD\Drawings\CAD\Drawings\78950-Sheets.dgn

USER NAME = HORNJD	DESIGNED -	REVISED -
	DRAWN -	REVISED -
PLOT SCALE = 100.0000' / in.	CHECKED -	REVISED -
PLOT DATE = 3/1/2022	DATE -	REVISED -

**STATE OF ILLINOIS
DEPARTMENT OF TRANSPORTATION**

INDEX, STANDARDS, GENERAL NOTES.

SCALE: SHEET OF SHEETS STA. TO STA.

F.A. * RTE.	SECTION	COUNTY	TOTAL SHEETS	SHEET NO.
*	D9 Patch 2022-8	GALLATIN	6	3
			CONTRACT NO. 78950	
ILLINOIS FED. AID PROJECT				

*FAP 331/FAP 782

SUMMARY OF QUANTITIES

COUNTY:	GALLATIN COUNTY	GALLATIN COUNTY
ROUTE:	IL 13	IL 1
FUNDING:	100% STATE	100% STATE
LOCATION:	RURAL	RURAL
	ROADWAY	ROADWAY
	0005	0005

CODE NUMBER	ITEM DESCRIPTION	UNIT	TOTAL QUANTITY		
44200934	CLASS B PATCHES, TYPE II, 8 INCH	SQ YD	248	248	0
44201299	DOWEL BARS 1 1/2"	EACH	596	596	0
44213200	SAW CUTS	FOOT	1,450	186	1,264
67100100	MOBILIZATION	L SUM	1	0.5	0.5
70100600	TRAFFIC CONTROL AND PROTECTION, STANDARD 701336	L SUM	1	0.5	0.5
70107025	CHANGEABLE MESSAGE SIGN	CAL DA	28	14	14
X4406020	PARTIAL DEPTH REMOVAL, TYPE I, 2"	SQ YD	13	0	13
X4406220	PARTIAL DEPTH REMOVAL, TYPE II, 2"	SQ YD	131	9	122
X4406620	PARTIAL DEPTH REMOVAL, TYPE IV, 2"	SQ YD	182	182	0
X4421000	PARTIAL DEPTH PATCHING	TON	41	23	18

MODEL: Default
 FILE NAME: p:\ultra-cw-bead\p\com\p\p\DOT\Documents\DOT Office\Dir\et 8\Project\78950\CAD\Drawn\CAD\Drawn\078950\Sheets.dgn

USER NAME = HORNJD	DESIGNED -	REVISED -
	DRAWN -	REVISED -
PLOT SCALE = 100,0000 ' / in.	CHECKED -	REVISED -
PLOT DATE = 2/25/2022	DATE -	REVISED -

STATE OF ILLINOIS
DEPARTMENT OF TRANSPORTATION

SUMMARY OF QUANTITIES

SCALE: SHEET OF SHEETS STA. TO STA.

F.A. RTE.	SECTION	COUNTY	TOTAL SHEETS	SHEET NO.
*	D9 Patch 2022-8	GALLATIN	6	4
			CONTRACT NO. 78950	
		ILLINOIS	FED. AID PROJECT	

PATCHING SCHEDULE

IL 13	STATION	WIDTH	LENGTH	AREA	CLASS B PATHCES, TY II, 8"	PARTIAL DEPTH PATCHING	PARTIAL DEPTH REMOVAL TY I, 2"	PARTIAL DEPTH REMOVAL TY II, 2"	PARTIAL DEPTH REMOVAL TY IV, 2"	DOWEL BARS 1 1/2"	SAW CUTS
		FT	FT	SQ YD							FT
IL 13 Eastbound	1803+70.	12	6	8	8	20	48
EB	1807+45.	12	6	8	8	20	48
EB Partial Depth	1807+94 to 1816+12	2	818	182	.	21	.	.	182	.	.
EB	1830+26.	8	8	7	7	12	40
EB	1831+33.	14	6	9	9	24	54
EB	1833+00.	14	6	9	9	24	54
EB	1834+02.	13	6	9	9	22	51
EB	1834+86.	13	6	9	9	22	51
EB	1836+87.	12	6	8	8	20	48
EB	1837+90.	12	6	8	8	20	48
EB	1838+90.	12	6	8	8	20	48
EB	1839+90.	12	6	8	8	20	48
EB	1840+90.	12	6	8	8	20	48
EB	1841+45.	12	6	8	8	20	48
EB	1842+40.	12	6	8	8	20	48
Intersection Partial Depth		2	40	9	.	2	.	9	.	.	.
IL 13 Westbound	1842+40.	12	6	8	8	20	48
WB	1841+45.	12	6	8	8	20	48
WB	1840+89.	12	6	8	8	20	48
WB	1839+90.	12	6	8	8	20	48
WB	1838+90.	12	6	8	8	20	48
WB	1837+90.	12	6	8	8	20	48
WB	1836+87.	12	6	8	8	20	48
WB	1835+77.	12	6	8	8	20	48
WB	1834+86.	12	6	8	8	20	48
WB	1834+02.	12	6	8	8	20	48
WB	1833+00.	11	6	7	7	18	45
WB	1831+33.	11	6	7	7	18	45
WB	1830+71.	11	6	7	7	18	45
IL 13 Westbound Turn Lane		11	12	15	15	18	57
IL 13 Westbound	1807+45.	12	6	8	8	20	48
WB	1803+70.	12	6	8	8	20	48
IL 13 TOTALS					248	23	.	9	182	596	1450

Model: Default
 File: M:\GIS\Projects\78950\CADD\Drawings\DOT_Offices\DOT_78950\CADD\Drawings\DOT_78950_Sheets.dgn

REV. - MS

USER NAME = HORNID	DESIGNED -	REVISED -
	DRAWN -	REVISED -
PLOT SCALE = 100.0000' / in.	CHECKED -	REVISED -
PLOT DATE = 2/25/2022	DATE -	REVISED -

**STATE OF ILLINOIS
DEPARTMENT OF TRANSPORTATION**

PATCHING SCHEDULE

SCALE: SHEET OF SHEETS STA. TO STA.

F.A. RTE.	SECTION	COUNTY	TOTAL SHEETS	SHEET NO.
*	D9 Patch 2022-8	GALLATIN	6	5
		CONTRACT NO. 78950		
ILLINOIS FED. AID PROJECT				

*FAP 331/FAP 782

PATCHING SCHEDULE CONT.

IL 1	STATION	WIDTH	LENGTH	AREA	CLASS B PATHCES, TY II, 8"	PARTIAL DEPTH PATCHING	PARTIAL DEPTH REMOVAL TY I, 2"	PARTIAL DEPTH REMOVAL TY II, 2"	PARTIAL DEPTH REMOVAL TY IV, 2"	DOWEL BARS 1 1/2"	SAW CUTS
		FT	FT	SQ YD							
IL 1 Southbound Partial Dept	212+02 to 212+61	2	59	13	.	2	.	13	.	.	.
SB Partial Depth	213+23 to 213+96	2	73	16	.	2	.	16	.	.	.
IL 1 Northbound Partial Depth	214+75 to 213+62	2	113	25	.	3	.	25	.	.	.
NB Partial Depth	212+74 to 212+04	2	70	16	.	2	.	16	.	.	.
NB Partial Depth	210+22 to 210+00	2	22	5	.	1	5
NB LT Wheel Lane Partial Depth	209+34 to 208+85	2	49	11	.	2	.	11	.	.	.
NB RT Wheel Lane Partial Depth	209+34 to 208+97	2	37	8	.	1	8
IL 1 Southbound Partail Depth	205+97 to 207+82	2	185	41	.	5	.	41	.	.	.
IL 1 TOTALS					.	18	.	13	.	.	.
IL 13 TOTALS					248	23	.	9	182	596	1450
PROJECT TOTALS					248	41	13	131	182	596	1450

REV. - MS

MODEL: Default
 FILE: M:\aspc\paw\illinois\benley.com\pwwd\DOT\Documents\DOT_Offices\District_9\Project\78950\CAD\Drawings\DOT\78950-Sheets.dgn

USER NAME = HORNJD	DESIGNED -	REVISED -	STATE OF ILLINOIS DEPARTMENT OF TRANSPORTATION	PATCHING SCHEDULE				F.A. RTE.	SECTION	COUNTY	TOTAL SHEETS	SHEET NO.
	DRAWN -	REVISED -						D9 Patch 2022-8	GALLATIN	6	6	
PLOT SCALE = 100.0000' / in.	CHECKED -	REVISED -			SCALE:	SHEET	OF	SHEETS	STA.	TO	STA.	ILLINOIS FED. AID PROJECT
PLOT DATE = 2/25/2022	DATE -	REVISED -										CONTRACT NO. 78950

*FAP 331/FAP 782