

STATE OF ILLINOIS
DEPARTMENT OF TRANSPORTATION

F.A.P. RTE.	SECTION	COUNTY	TOTAL SHEETS	SHEET NO.
313	4-PP	WARREN	6	1
		ILLINOIS	CONTRACT NO. 68G93	

INDEX OF SHEETS

- 1 COVER SHEET
- 2 COMMITMENTS, GENERAL NOTES, AND PROJECT SPECIFIC NOTES
- 3 SUMMARY OF QUANTITIES
- 4 SCHEDULE OF QUANTITIES
- 5 TYPICAL SECTIONS
- 6 LINE DIAGRAM

ILLINOIS HIGHWAY STANDARDS

- 000001-08
- 442201-03
- 701201-05
- 701901-08

DESIGN DESIGNATION

- US 34: PRINCIPAL ARTERIAL
- ADT: 4,900 (2019)
- SU: 975
- MU: 300

PROPOSED
HIGHWAY PLANS

FAP ROUTE 313 (US 34)
SECTION 4-PP
CONTRACT MAINTENANCE
WARREN COUNTY
C-94-027-22

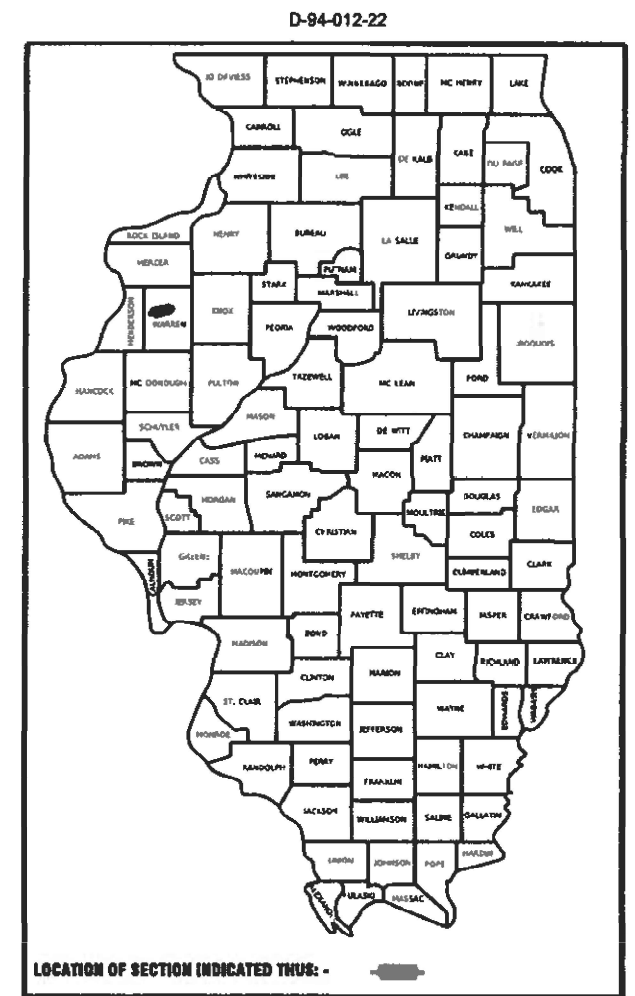

BEGIN IMPROVEMENT
20TH STREET

END IMPROVEMENT
US 67

T11
T10



FULL SIZE PLANS HAVE BEEN PREPARED USING STANDARD ENGINEERING SCALES. REDUCED SIZED PLANS WILL NOT CONFORM TO STANDARD SCALES. IN MAKING MEASUREMENTS ON REDUCED PLANS, THE ABOVE SCALES MAY BE USED.

J.U.L.I.E.
JOINT UTILITY LOCATION INFORMATION FOR EXCAVATORS
1-800-892-0123
OR 811

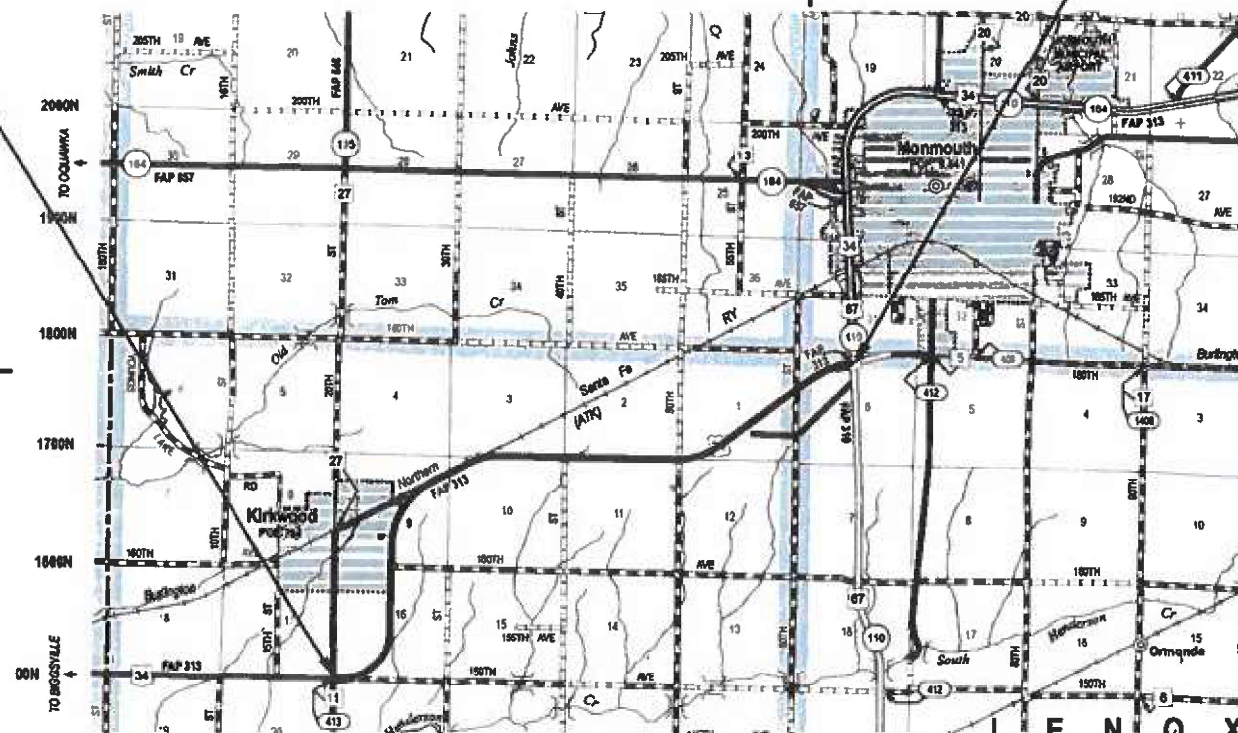

PROJECT ENGINEER: BEN TELLEFSON (309) 671-3333
PROJECT MANAGER: WILL MOSER (309) 671-3333
CATALOG NO. 036301-00D
CONTRACT NO. 68G93

Mark C. Lee
MARK C. LEE DATE 3/21/22
REGISTERED PROFESSIONAL ENGINEER
STATE OF ILLINOIS NO. 062-060864
LICENSE EXPIRES NOVEMBER 30, 2023

GROSS LENGTH = 32,842.00 FT. = 6.22 MILE
NET LENGTH = 32,842.00 FT. = 6.22 MILE

KLINGNER
& ASSOCIATES, P.C.
Engineers • Architects • Surveyors
www.klingner.com
Galesburg, Illinois
49 North Prairie Street
309.342.4042
Quincy, IL Hannibal, MO
Burlington, IA Peoria, IA Columbia, MO
Des Moines, IA Carbondale, IL
DESIGN FIRM NO. 184-2738

PROJECT DESCRIPTION:

PAVEMENT PATCHING ON
US 34 FROM 20TH ST. TO US 67

STATE OF ILLINOIS
DEPARTMENT OF TRANSPORTATION
SUBMITTED *March 30, 2022*
Ben Tellefson
REGIONAL ENGINEER
May 13, 2022 *Ben Tellefson*
ENGINEER OF DESIGN AND ENVIRONMENT
May 13, 2022 *Stephen McArthur*
DIRECTOR OF HIGHWAYS PROJECT IMPLEMENTATION

PRINTED BY THE AUTHORITY
OF THE STATE OF ILLINOIS

COMMITMENTS

COMMITMENTS ARE NOT TO BE ALTERED WITHOUT THE WRITTEN APPROVAL OF ALL PARTIES TO WHICH THE COMMITMENT WAS MADE.

NO COMMITMENTS HAVE BEEN MADE ON THIS PROJECT.

ENVIRONMENTAL REVIEWS

PRIOR TO THE USE OF ANY PROPOSED BORROW AREAS, USE AREAS (TEMPORARY ACCESS ROADS, DETOURS, RUN-AROUNDS, ETC.) AND /OR WASTE AREAS, THE CONTRACTOR SHALL FILE THE REQUIRED ENVIRONMENTAL RESOURCE REQUEST SURVEYS ACCORDING TO SECTION 107.22 OF THE STANDARD SPECIFICATIONS. THESE SURVEYS ARE REQUIRED IN ORDER FOR THE DEPARTMENT TO CONDUCT CULTURAL AND BIOLOGICAL RESOURCE SURVEYS FOR THE PROPOSED SITE.

THE REQUIRED ENVIRONMENTAL RESOURCE DOCUMENTATION SHALL INCLUDE THE FOLLOWING:

- BDE FORM 2289 (CULTURAL AND NATURAL RESOURCE REVIEW OF BORROW AREAS)
- BDE FORM 2290 (WASTE/USE AREA REVIEW)
- A LOCATION MAP SHOWING THE SIZE LIMITS AND LOCATION OF THE USE AREA
- COLOR PHOTOGRAPHS DEPICTING THE USE AREA
- BORROW AREA ENTRY AGREEMENT FORM-D4 PI0101

PRIOR TO ANY WASTE MATERIALS BEING REMOVED FROM THE CONSTRUCTION SITE THE REQUIRED ENVIRONMENTAL RESOURCE SURVEYS SHALL BE OBTAINED AND FILED BY THE CONTRACTOR. EXCESS WASTE PRODUCTS REMOVED FROM THE CONSTRUCTION SITE SHALL BE DISPOSED OF AS REQUIRED IN SECTION 202.03 OF THE STANDARD SPECIFICATIONS.

ANY PROTRUDING METAL BARS SHALL BE REMOVED PRIOR TO THE DISPOSAL OF BROKEN CONCRETE AT APPROVED DISPOSAL SITES.

PLEASE NOTE THAT A MINIMUM OF FOUR WEEKS SHALL BE ALLOWED FOR THE DISTRICT TO OBTAIN THE REQUIRED WASTE SITE ENVIRONMENTAL CLEARANCES AND SIX WEEKS FOR THE REQUIRED BORROW SITE ENVIRONMENTAL CLEARANCES.

JOB SPECIFICATIONS

1. FLAGGERS, WHEN SHOWN, SHALL BE INCLUDED IN THE COST OF TRAFFIC CONTROL STANDARD PAY ITEMS.
2. TWO CHANGEABLE MESSAGE SIGNS SHALL BE PLACED IN ADVANCE OF THE PROJECT AND SHALL REMAIN IN PLACE THROUGHOUT THE EXTENT OF THE PROJECT. ONE PER EACH DIRECTION OF TRAVEL ON US 34 ONE WEEK PRIOR TO CONSTRUCTION.

HOT-MIX ASPHALT MIXTURE REQUIREMENTS

THE FOLLOWING MIXTURE REQUIREMENTS ARE APPLICABLE FOR THIS PROJECT

LOCATION(S)	MAINLINE	MAINLINE	MAINLINE
MIXTURE USE(S):	CLASS D PATCH (POLY SURFACE 2")	CLASS D PATCH (LOWER LIFTS)	PARTIAL DEPTH PATCH (POLY SURFACE 2")
PG:	SBS 76-28	PG 64-22	SBS 76-28
DESIGN AIR VOIDS:	4% N=70	4% N=70	4% N=70
MIXTURE COMPOSITION:	IL 9.5	IL 19.0	IL 9.5
FRICTION AGGREGATE:	MIX C	N.A.	MIX C
MIXTURE WEIGHT:	112.0 LB/SY/IN	112.0 LB/SY/IN	112.0 LB/SY/IN
QUALITY MANAGEMENT PROGRAM:	QC/QA	QC/QA	QC/QA
SUBLOT SIZE:	N/A	N/A	N/A
MATERIAL TRANSFER DEVICE:	NO	NO	NO

NOTES:

1) INDIVIDUAL LIFT THICKNESS OF EACH MIX TYPE WILL BE NO LESS THAN 3 TIMES NOMINAL MAXIMUM AGGREGATE SIZE AND NO MORE THAN 6 TIMES NOMINAL MAXIMUM.

2) FOR DESIGN PURPOSES, MIXTURE WEIGHT FOR ALL MIXES IS DETERMINED TO BE 112.0 LB./S.Y./IN., UNLESS OTHERWISE NOTED.

MODEL: D:\p\h\...
 FILE NAME: 031111es211081.IDOT - DIST 4 - PTP 20140323\Work Order 03 - Western DA118 Transportation\US 34 COH Street to US 67\CAD Sheets\Notes.dgn

KLINGNER & ASSOCIATES, P.C.
 Engineers • Architects • Surveyors
 www.klingner.com
 Galesburg, Illinois Quincy, IL, Marshall, MO
 40 North Perry Street Burlington, MA, Perry, MO, Columbia, MO
 200 West 4th Street Des Moines, IA, Columbus, IA

USER NAME = mirch	DESIGNED - MCR	REVISED -
PLOT SCALE = 100.0000 ' / in.	DRAWN - MCR	REVISED -
PLOT DATE = 3/25/2022	CHECKED - MCL	REVISED -
	DATE -	REVISED -

DESIGNED - MCR	REVISED -
DRAWN - MCR	REVISED -
CHECKED - MCL	REVISED -
DATE -	REVISED -

**STATE OF ILLINOIS
DEPARTMENT OF TRANSPORTATION**

**COMMITMENTS, GENERAL NOTES,
AND PROJECT SPECIFIC NOTES**

SCALE: NONE SHEET 2 OF 6 SHEETS STA. N/A TO STA. N/A

F.A.P. RTE.	SECTION	COUNTY	TOTAL SHEETS	SHEET NO.
313	4-PP	WARREN	6	2
CONTRACT NO. 68G93				
ILLINOIS FED. AID PROJECT				

MOBILIZATION	
LOCATION	L SUM
US 34	1
TOTAL	1

CLASS D PATCHES, TYPE II, 12"	
LOCATION	SQ YD
US 34	383
TOTAL	383

TRAFFIC CONTROL & PROTECTION STANDARD 701201	
LOCATION	L SUM
US 34	1
TOTAL	1

CLASS D PATCHES, TYPE III, 12"	
LOCATION	SQ YD
US 34	61
TOTAL	61

CHANGEABLE MESSAGE SIGN	
LOCATION	CAL DAY
US 34	74
TOTAL	74

CLASS D PATCHES, TYPE IV, 12"	
LOCATION	SQ YD
US 34	210
TOTAL	210

RAISED REFLECTIVE PAVEMENT MARKER REMOVAL	
LOCATION	EACH
US 34	30
TOTAL	30

LANE	WIDTH	LENGTH	AREA	PARTIAL DEPTH PATCHING (SPL)	PARTIAL DEPTH PATCHING (2 INCH)
	FT	FT	SQ YD	SQ YD	TON
WB	6	20	13.3	13.3	1.5
WB	12	13	17.3	17.3	2.0
WB	12	11	14.7	14.7	1.7
WB	6	18	12.0	12.0	1.4
WB	12	28	37.3	37.3	4.3
WB	6	33	22.0	22.0	2.5
WB	6	15	10.0	10.0	1.1
WB	3	120	40.0	40.0	4.6
WB	12	30	40.0	40.0	4.6
WB	12	17	22.7	22.7	2.6
WB	7	10	7.8	7.8	0.9
WB	7	16	12.4	12.4	1.4
WB	7	15	11.7	11.7	1.3
WB	12	11	14.7	14.7	1.7
WB	7	36	28	28.0	3.2
SUBTOTAL				304	35

LANE	WIDTH	LENGTH	AREA	PARTIAL DEPTH PATCHING (SPL)	PARTIAL DEPTH PATCHING (2 INCH)
	FT	FT	SQ YD	SQ YD	TON
EB	7	35	27.2	27.2	3.1
EB	7	20	15.6	15.6	1.8
EB	12	28	37.3	37.3	4.3
EB	12	24	32.0	32.0	3.6
EB	7	30	23.3	23.3	2.7
EB	7	35	27.2	27.2	3.1
EB	7	37	28.8	28.8	3.3
EB	7	13	10.1	10.1	1.2
EB	12	51	68.0	68.0	7.8
EB	12	12	16.0	16.0	1.8
EB	12	12	16.0	16.0	1.8
EB	12	53	70.7	70.7	8.1
EB	12	48	64.0	64.0	7.3
EB	7	16	12.4	12.4	1.4
SUBTOTAL				449	51

	PARTIAL DEPTH PATCHING (SPL)	PARTIAL DEPTH PATCHING (2 INCH)
SUBTOTAL	753	86
TOTAL	828	95
(QUANTITIES INCREASED 10% FOR EXPECTED OVERAGE)		

MODEL: Default
 FILE NAME: C:\Users\j13081\DOT - DIST 4 - PTP 201623\Work Order 03 - Western DA118 Transportation\US 34 (20th Street to US 67)\CAD Sheets\Schedule of Quantities.dgn



USER NAME = mirch	DESIGNED - MCR	REVISED -
PLOT SCALE = 100,0000' / in.	DRAWN - MCR	REVISED -
PLOT DATE = 3/18/2022	CHECKED - MCL	REVISED -
	DATE -	REVISED -

DESIGNED - MCR	REVISED -
DRAWN - MCR	REVISED -
CHECKED - MCL	REVISED -
DATE -	REVISED -

**STATE OF ILLINOIS
 DEPARTMENT OF TRANSPORTATION**

SCHEDULE OF QUANTITIES

SCALE: NONE SHEET 4 OF 6 SHEETS STA. N/A TO STA. N/A

F.A.P. RTE.	SECTION	COUNTY	TOTAL SHEETS	SHEET NO.
313	4-PP	WARREN	6	4
			CONTRACT NO. 68G93	
ILLINOIS FED. AID PROJECT				

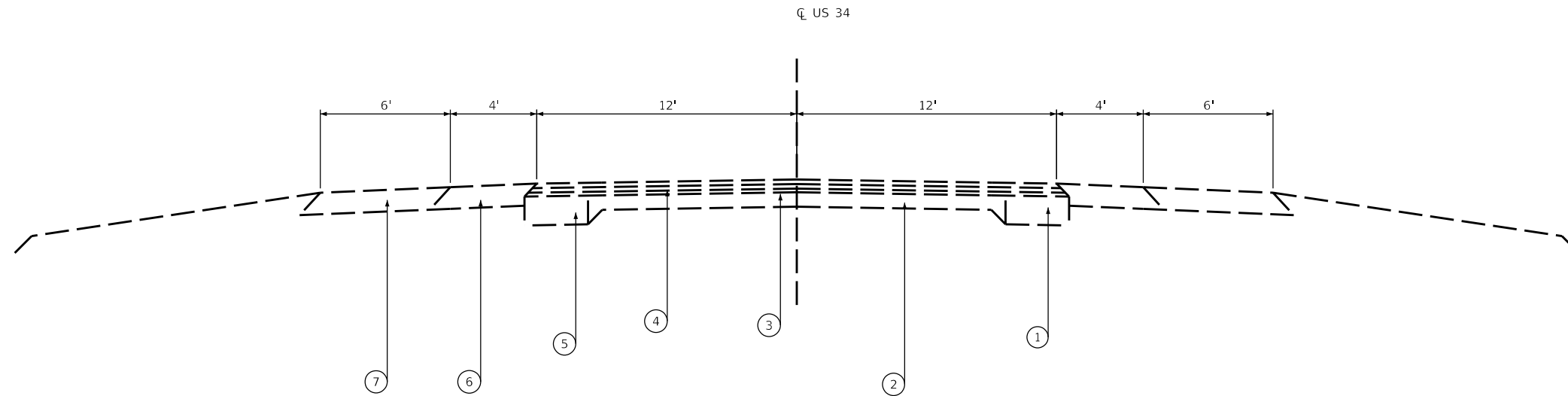

EXISTING TYPICAL US 34 SECTION
(20TH STREET TO US 67)

LEGEND

- ① EXISTING HMA BASE COURSE WIDENING, 12"
- ② EXISTING P.C.C. BASE, 8"
- ③ EXISTING HMA LEVELING BINDER, 1"
- ④ EXISTING I-II HMA BINDER & SURFACE COURSE, 2 1/2"
- ⑤ EXISTING P.C.C. BASE COURSE WIDENING, 8"
- ⑥ EXISTING STABILIZED SHOULDER, 8"
- ⑦ GRAVEL SHOULDERS, TYPE A, 8"

MODEL: Default
 FILE NAME: C:\311081\1081_IDOT - DIST 4 - PTP 201623\Work_Order_03 - Western DA\18_Transportation\US 34 (20th Street to US 67)\CAD_Sheets\Typical_Sheet.dwg
 DATE: 3/18/2022

KLINGNER & ASSOCIATES, P.C.
 Engineers • Architects • Surveyors
 Galesburg, Illinois
 Quincy, IL, Macomb, MO
 Burlington, MA, Plover, WI, Columbia, MD
 Danvers, VT, Columbus, IA

USER NAME = mirch	DESIGNED - MCR	REVISED -
PLOT SCALE = 100.0:0.0000 "' / in.	DRAWN - MCR	REVISED -
PLOT DATE = 3/18/2022	CHECKED - MCL	REVISED -
	DATE -	REVISED -

DESIGNED - MCR	REVISED -
DRAWN - MCR	REVISED -
CHECKED - MCL	REVISED -
DATE -	REVISED -

**STATE OF ILLINOIS
DEPARTMENT OF TRANSPORTATION**

TYPICAL SECTIONS			
SCALE: NONE	SHEET 5 OF 6 SHEETS	STA. N/A	TO STA. N/A

F.A.P. RTE.	SECTION	COUNTY	TOTAL SHEETS	SHEET NO.
313	4-PP	WARREN	6	5
CONTRACT NO. 68G93				
ILLINOIS FED. AID PROJECT				

CITY OF
MONMOUTH



US 67

US 67

US 34

VILLAGE OF
KIRKWOOD

20TH STREET

PROJECT END

PROJECT START

MODEL: I:\default\Klingner & Associates, P.C. - Engineers - Architects - Surveyors\Projects\2018\2018081_IDOT - DIST 4 - PTP 201803\Work_Order_03 - Western DA\18_Transportation\US_34_20th_Street_to_US_67\CAD_Sheets\Line_Diagram.dgn

KLINGNER & ASSOCIATES, P.C.
 Engineers • Architects • Surveyors
 www.klingner.com
 Galesburg, Illinois Quincy, IL, Macomb, MO
 40 North Prairie Street Burlington, MA, Plover, WI, Columbia, MO
 565-242-4442 Danvers, IA, Cantonville, IL

USER NAME = mirch
PLOT SCALE = 100,0000 ' / in.
PLOT DATE = 3/18/2022

DESIGNED - MCR
DRAWN - MCR
CHECKED - MCL
DATE -

REVISED -
REVISED -
REVISED -
REVISED -

**STATE OF ILLINOIS
DEPARTMENT OF TRANSPORTATION**

LINE DIAGRAM

SCALE: NONE SHEET 6 OF 6 SHEETS STA. N/A TO STA. N/A

F.A.P. RTE.	SECTION	COUNTY	TOTAL SHEETS	SHEET NO.
313	4-PP	WARREN	6	6
CONTRACT NO. 68G93				
ILLINOIS FED. AID PROJECT				