

STATE OF ILLINOIS
DEPARTMENT OF TRANSPORTATION

F.A. RTE.	SECTION	COUNTY	TOTAL SHEETS	SHEET NO.
	D1 APP Paint PVT MKG 22-11	Various	9	1
	ILLINOIS	CONTRACT NO. 46575		

INDEX OF SHEETS

1. COVER SHEET
2. SUMMARY OF QUANTITIES
3. DUPAGE COUNTY
4. WILL COUNTY
5. LAKE COUNTY
6. MCHENRY COUNTY
7. NORTH COOK COUNTY
8. SOUTH COOK COUNTY
9. KANE COUNTY

STATE STANDARDS

- | | |
|-----------|---|
| 701301-04 | LANE CLOSURE 2L,2W, SHORT TIME OPERATIONS |
| 701311-03 | LANE CLOSURE 2L,2W MOVING OPERATIONS-DAY ONLY |
| 701426-09 | LANE CLOSURE, MULTILANE,INTERMITTENT OR MOVING OPERATION FOR SPEEDS > 45MPH |
| 701427-05 | LANE CLOSURE, MULTILANE,INTERMITTENT OR MOVING OPERATION FOR SPEEDS < 40MPH |
| 701901-08 | TRAFFIC CONTROL DEVICES |

PROPOSED
HIGHWAY PLANS

VARIOUS ROUTES
D1 APP PAINT PVT MKG 22-11
PAINT PAVEMENT MARKING
VARIOUS COUNTY

M-60-011-22

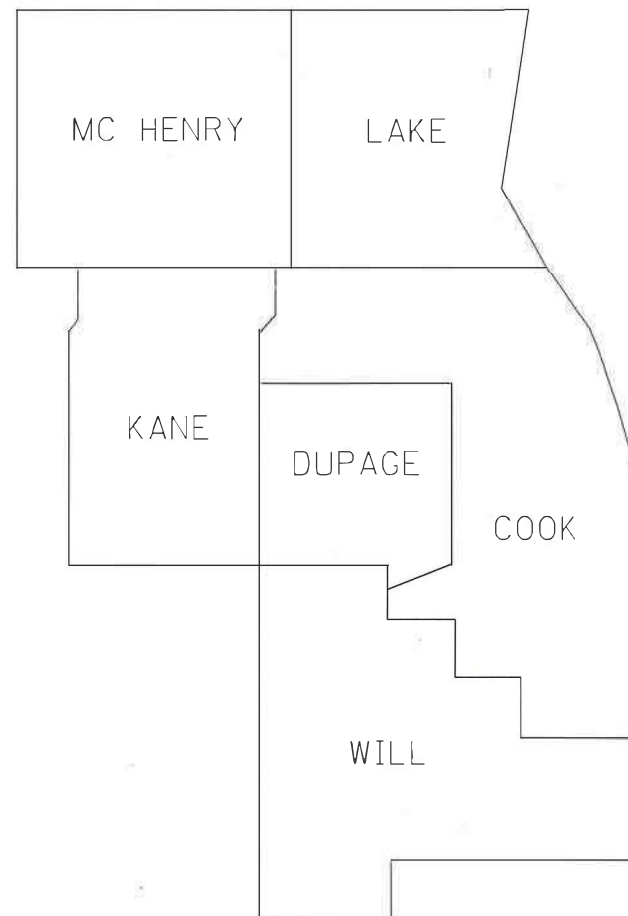

D-1

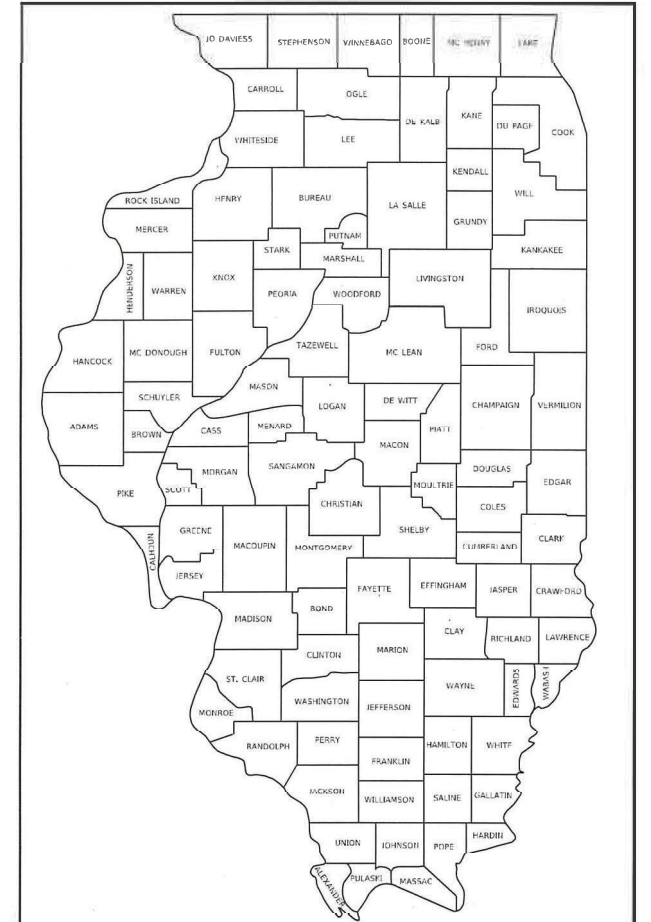

LOCATION OF SECTION INDICATED THUS: - [thick black line] -

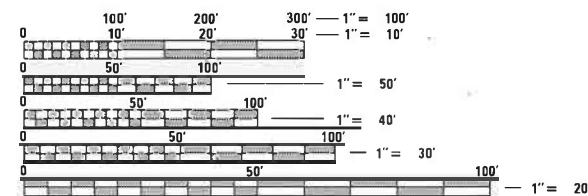

FULL SIZE PLANS HAVE BEEN PREPARED USING STANDARD ENGINEERING SCALES. REDUCED SIZED PLANS WILL NOT CONFORM TO STANDARD SCALES. IN MAKING MEASUREMENTS ON REDUCED PLANS, THE ABOVE SCALES MAY BE USED.

J.U.L.I.E.
JOINT UTILITY LOCATION INFORMATION FOR EXCAVATORS
1-800-892-0123
OR 811

CONTRACT NO. 46575

STATE OF ILLINOIS
DEPARTMENT OF TRANSPORTATION

SUBMITTED February 8, 2022
April 13, 2022

REGIONAL ENGINEER
May 13, 2022 [Signature]

ENGINEER OF DESIGN AND ENVIRONMENT
May 13, 2022 [Signature]

DIRECTOR OF HIGHWAYS PROJECT IMPLEMENTATION
[Signature]

PRINTED BY THE AUTHORITY
OF THE STATE OF ILLINOIS

SUMMARY OF QUANTITIES

NUMBER	ITEM	UNIT	100% STATE URBAN 0021 QUANTITY
78300201	PAVEMENT MARKING REMOVAL - GRINDING	SQ FT	5000
78300202	PAVEMENT MARKING REMOVAL - WATER BLASTING	SQ FT	1000
78001100	PAINT PAVEMENT MARKING LETTERS AND SYMBOLS	SQ FT	10000
78001110	PAINT PAVEMENT MARKING - LINE 4"	FOOT	100000
78001130	PAINT PAVEMENT MARKING - LINE 6"	FOOT	40000
78001140	PAINT PAVEMENT MARKING - LINE 8"	FOOT	35000
78001150	PAINT PAVEMENT MARKING - LINE 12"	FOOT	725000
78001180	PAINT PAVEMENT MARKING - LINE 24"	FOOT	5000

MODEL: Default
FILE NAME: S:\Contracts\CAD\CoverSheets for Contracts.dgn

USER NAME = kenenakhonep	DESIGNED -	REVISED -
	DRAWN -	REVISED -
PLOT SCALE = 100.3338' / in.	CHECKED -	REVISED -
PLOT DATE = 2/4/2022	DATE -	REVISED -

**STATE OF ILLINOIS
DEPARTMENT OF TRANSPORTATION**

SUMMARY OF QUANTITIES

SCALE: SHEET 2 OF 9 SHEETS STA. TO STA.

F.A. RTE.	SECTION	COUNTY	TOTAL SHEETS	SHEET NO.
	D1 APP Paint PVT MKG 22-11	VARIOUS	9	2
CONTRACT NO. 46575				
ILLINOIS FED. AID PROJECT				

DUPAGE COUNTY

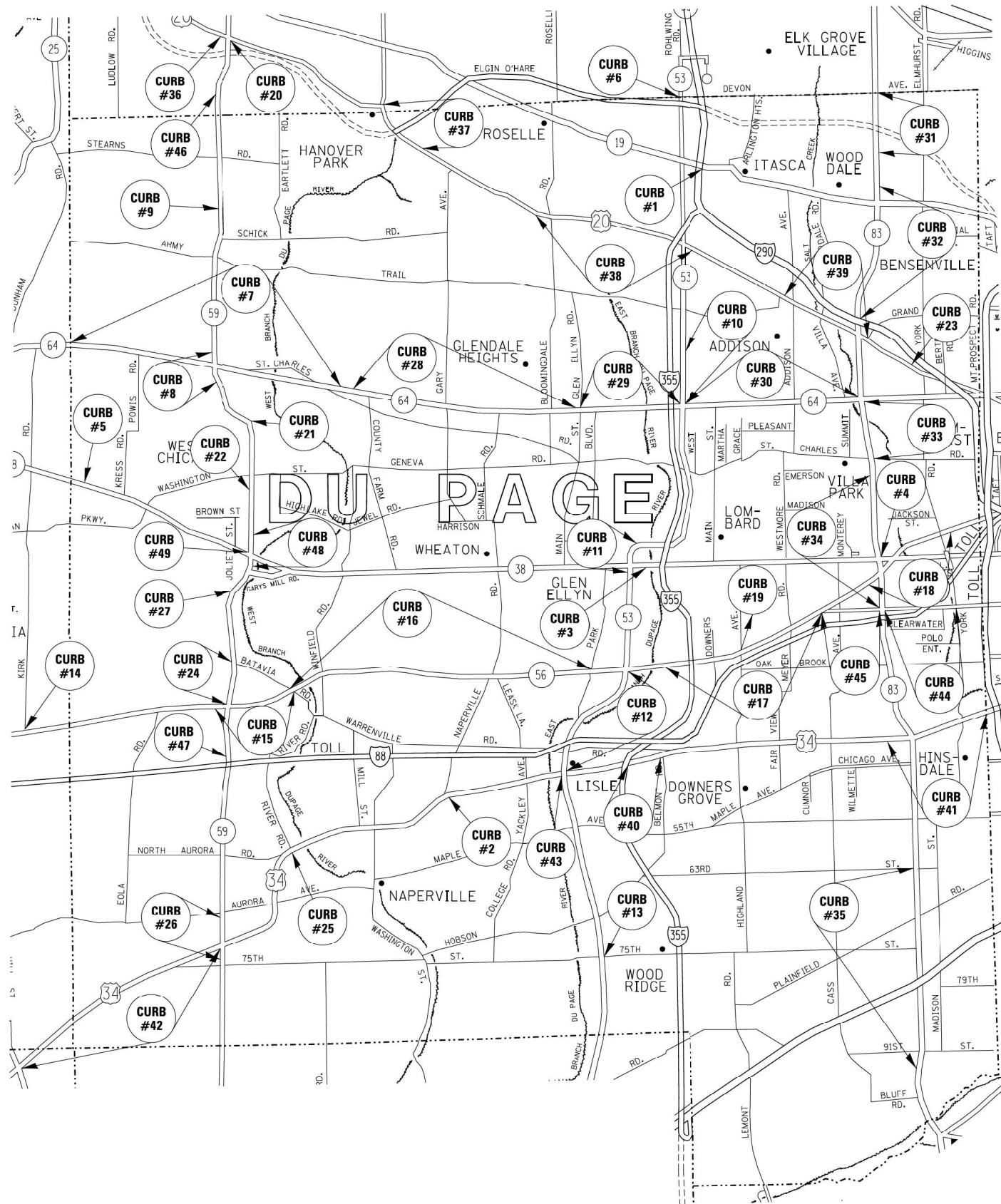

MODEL: Default
 FILE NAME: S:\SIS\Contracts\CAD\CoverSheets for Contracts.dgn

USER NAME = GONZALEZDJR	DESIGNED -	REVISED -
	DRAWN -	REVISED -
PLOT SCALE = 101.9904' / in.	CHECKED -	REVISED -
PLOT DATE = 2/2/2022	DATE -	REVISED -

STATE OF ILLINOIS
DEPARTMENT OF TRANSPORTATION

DUPAGE COUNTY

SCALE: SHEET 3 OF 9 SHEETS STA. TO STA.

F.A. RTE.	SECTION	COUNTY	TOTAL SHEETS	SHEET NO.
	D1 APP Paint PVT MKG 22-11	VARIOUS	9	3
			CONTRACT NO. 46575	
ILLINOIS FED. AID PROJECT				

WILL COUNTY

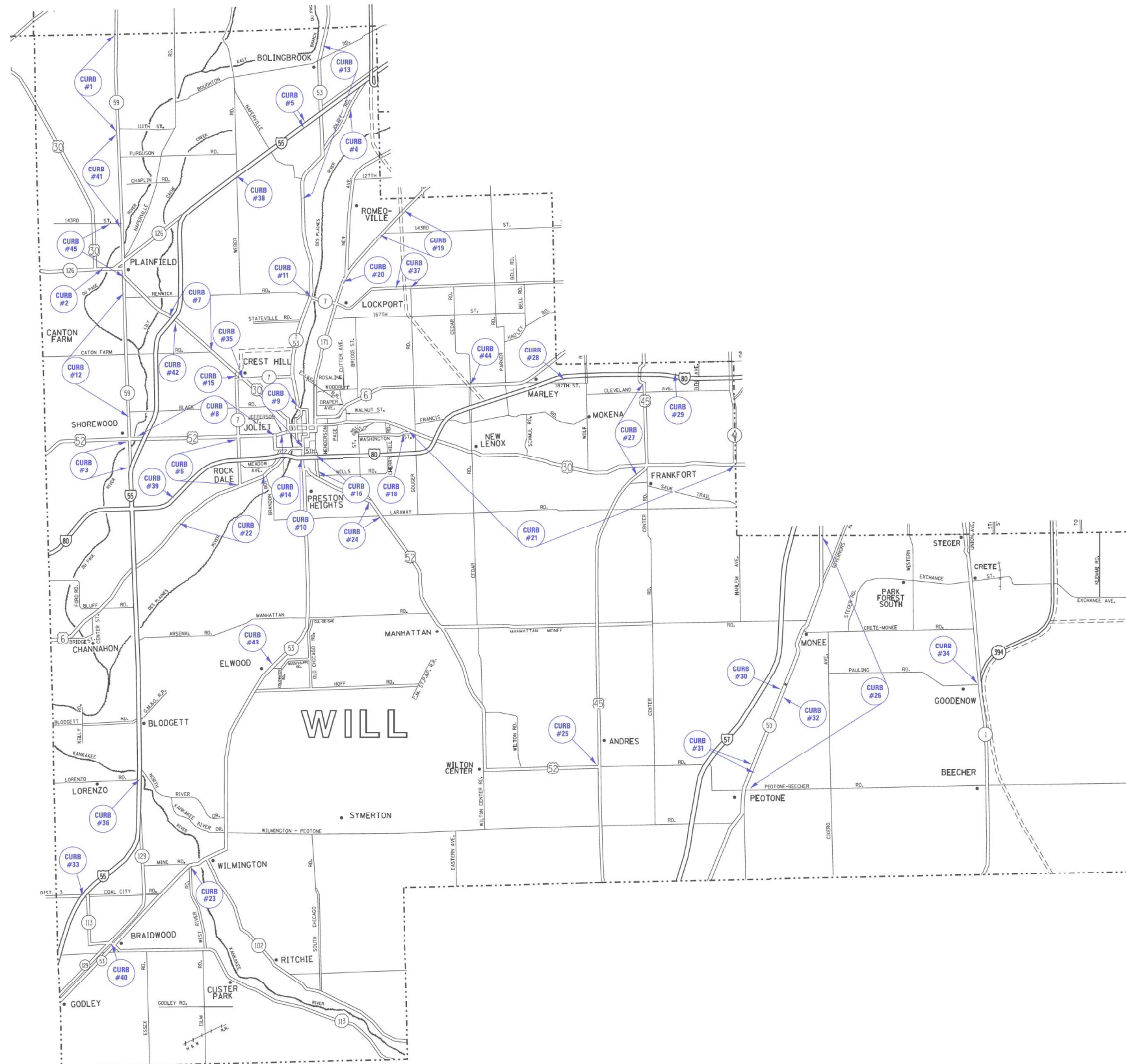

MODEL: Default
 FILE NAME: S:\S\Contract\CAD\CoverSheets for Contracts.dgn

USER NAME = GONZALEZDJR	DESIGNED -	REVISED -
PLOT SCALE = 102.5029' / 1 in.	DRAWN -	REVISED -
PLOT DATE = 2/2/2022	CHECKED -	REVISED -
	DATE -	REVISED -

STATE OF ILLINOIS
DEPARTMENT OF TRANSPORTATION

WILL COUNTY
 SCALE: SHEET 4 OF 9 SHEETS STA. TO STA.

F.A. RTE.	SECTION	COUNTY	TOTAL SHEETS	SHEET NO.
	D1 APP Paint PVT MKG 22-11	VARIOUS	9	4
CONTRACT NO. 46575				
ILLINOIS FED. AID PROJECT				

LAKE COUNTY

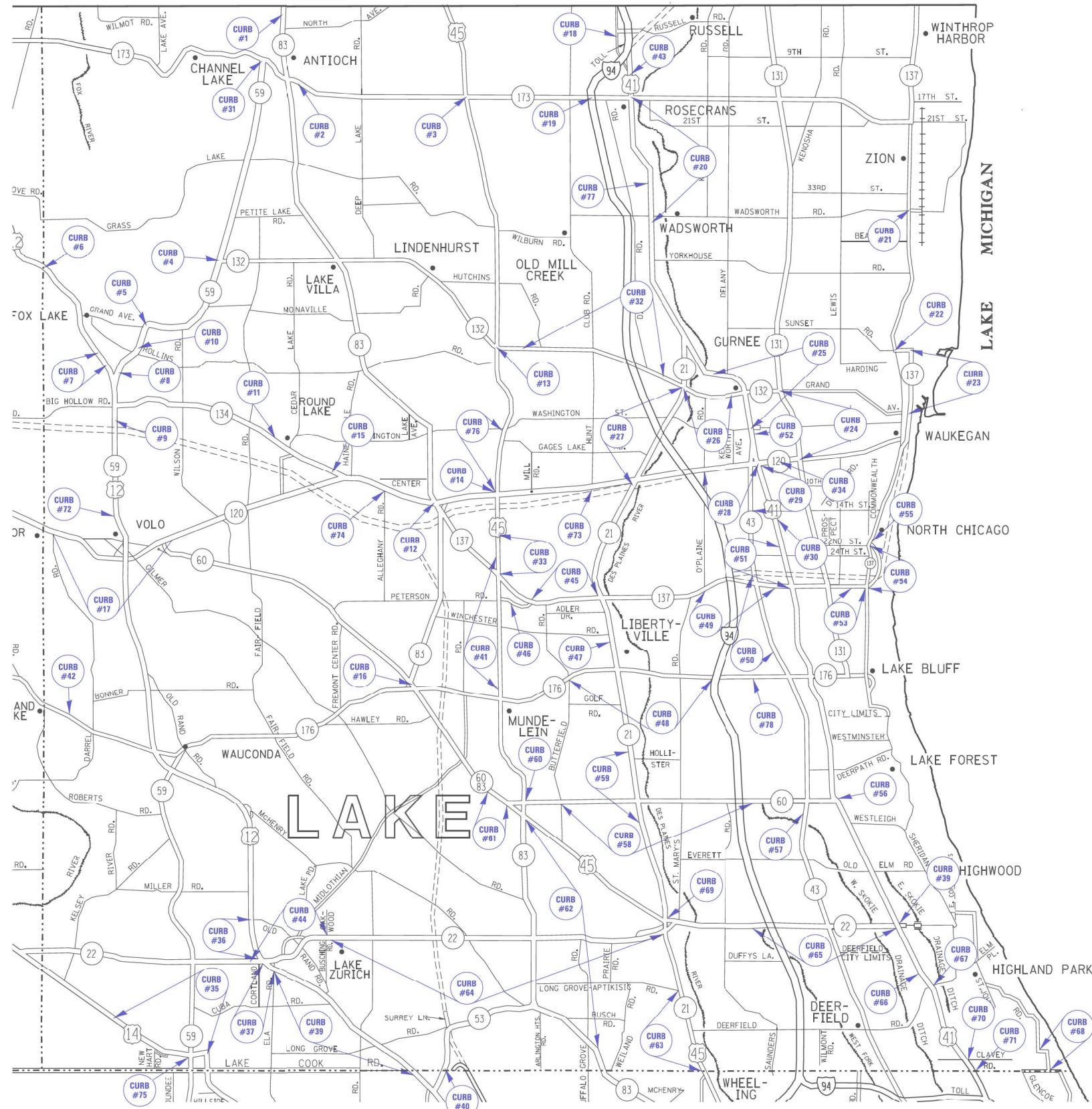

MODEL: Default
FILE NAME: S:\Contracts\CAD\CoverSheets for Contracts.dgn

USER NAME = GONZALEZDJR	DESIGNED -	REVISED -
PLOT SCALE = 102.5029' / in.	DRAWN -	REVISED -
PLOT DATE = 2/2/2022	CHECKED -	REVISED -
	DATE -	REVISED -

**STATE OF ILLINOIS
DEPARTMENT OF TRANSPORTATION**

LAKE COUNTY

SCALE: SHEET 5 OF 9 SHEETS STA. TO STA.

F.A. RTE.	SECTION	COUNTY	TOTAL SHEETS	SHEET NO.
	D1 APP Paint PVT MKG 22-11	VARIOUS	9	5
			CONTRACT NO. 46575	
ILLINOIS FED. AID PROJECT				

MCHENRY COUNTY

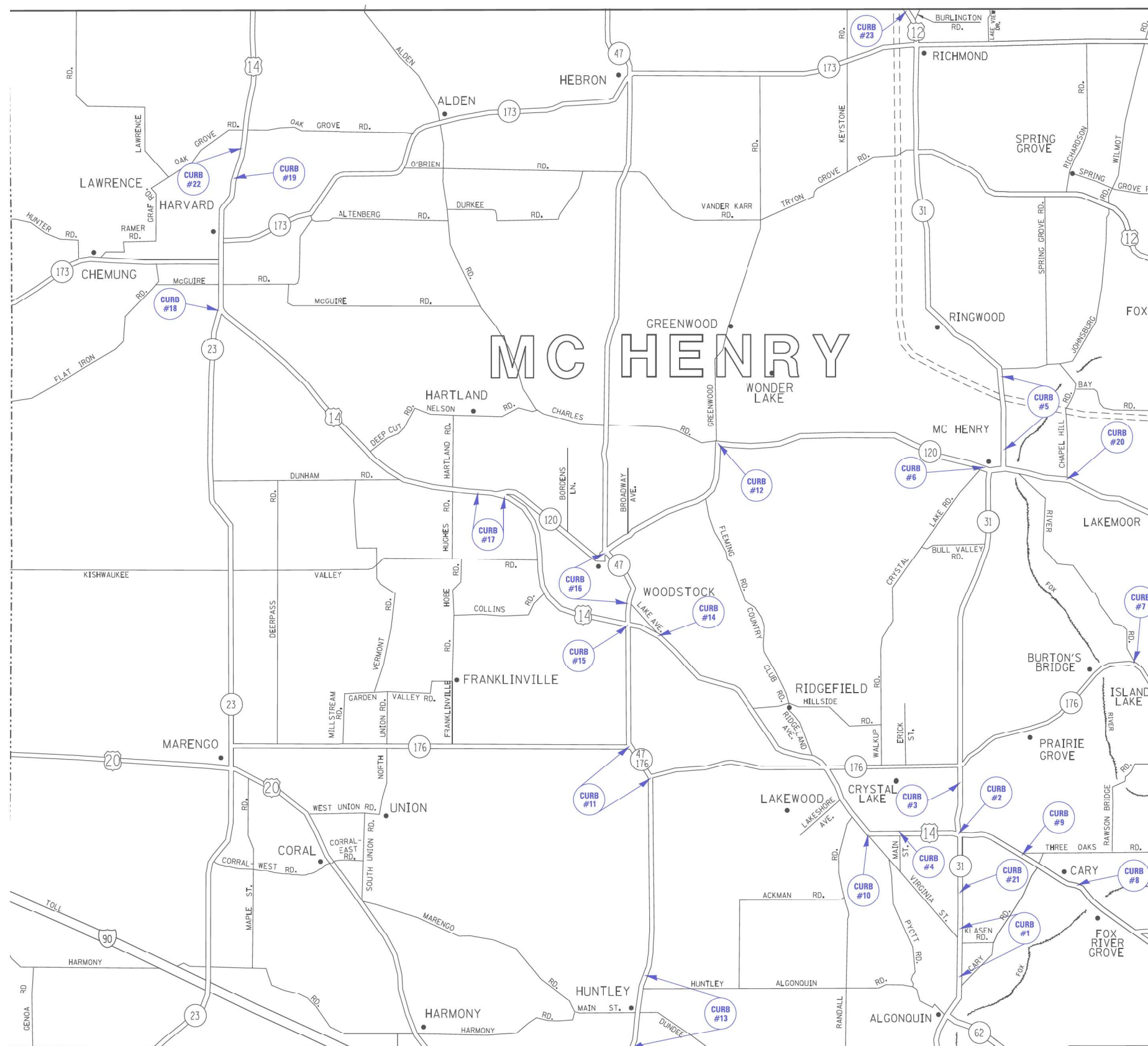

MODEL: P:\Print
 FILE NAME: S:\S\CONTRACTS\CAD\Drawings\Streets for Contracts.dgn

USER NAME = GONZALEZDJR	DESIGNED -	REVISED -
	DRAWN -	REVISED -
PLOT SCALE = 102.5029' / in.	CHECKED -	REVISED -
PLOT DATE = 2/2/2022	DATE -	REVISED -

STATE OF ILLINOIS
DEPARTMENT OF TRANSPORTATION

MCHENRY COUNTY
 SCALE: SHEET 6 OF 9 SHEETS STA. TO STA.

F.A. RTE.	SECTION	COUNTY	TOTAL SHEETS	SHEET NO.
	D1 APP Paint PVT MKG 22-11	VARIOUS	9	6
CONTRACT NO. 46575				
ILLINOIS FED. AID PROJECT				

NORTH COOK COUNTY

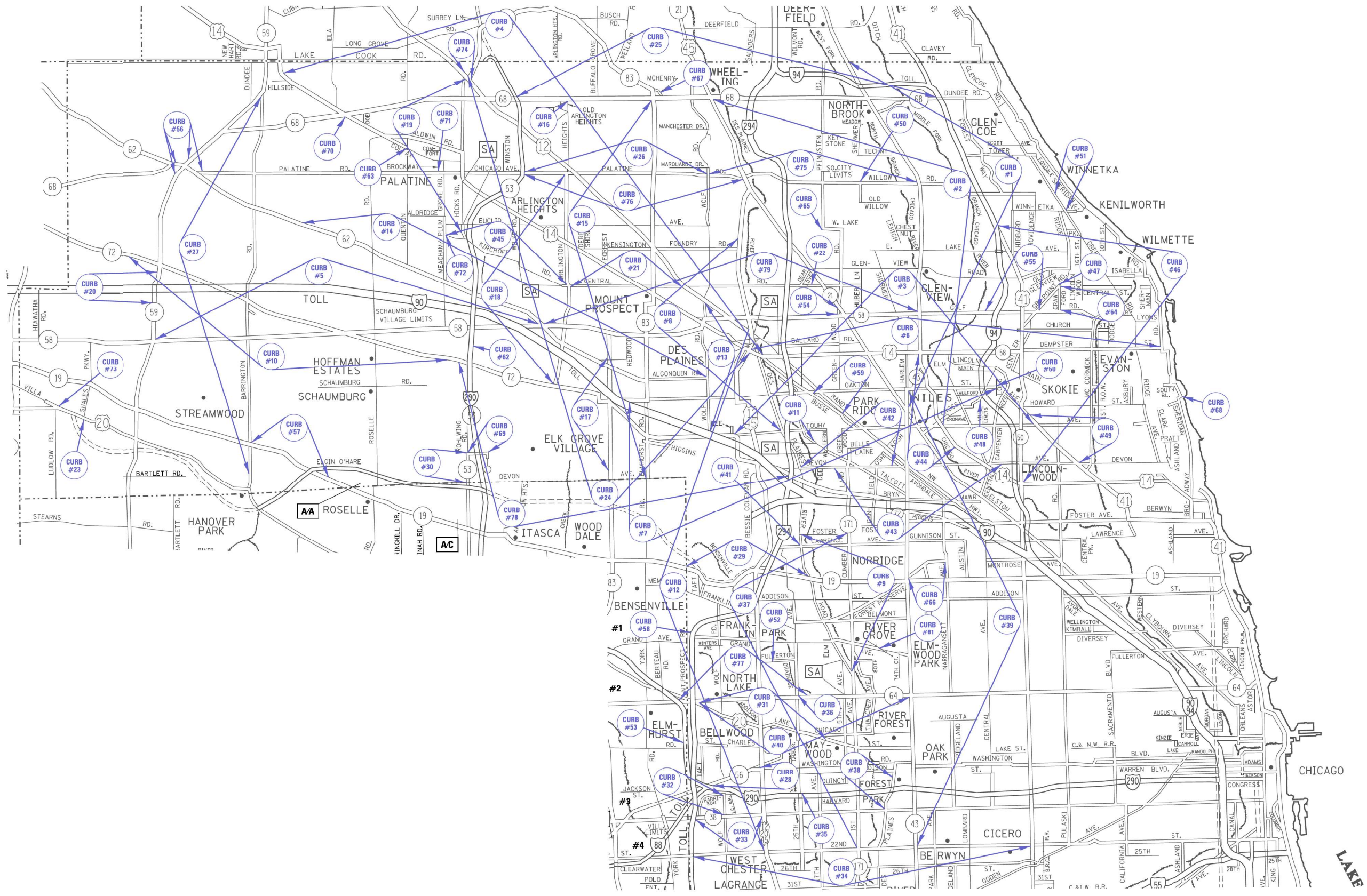

MODEL: P:\Client
 FILE NAME: S:\S\CONTRACTS\CAD\Cover-Sheets for Contracts.dgn

USER NAME = GONZALEZDJR	DESIGNED -	REVISED -
PLOT SCALE = 102,5029' / in.	DRAWN -	REVISED -
PLOT DATE = 2/2/2022	CHECKED -	REVISED -
	DATE -	REVISED -

STATE OF ILLINOIS
DEPARTMENT OF TRANSPORTATION

NORTH COOK COUNTY	
SCALE:	SHEET 7 OF 9 SHEETS STA. TO STA.

F.A. RTE.	SECTION	COUNTY	TOTAL SHEETS	SHEET NO.
	D1 APP Paint PVT MKG 22-11	VARIOUS	9	7
CONTRACT NO. 46575				
ILLINOIS FED. AID PROJECT				

SOUTH COOK COUNTY

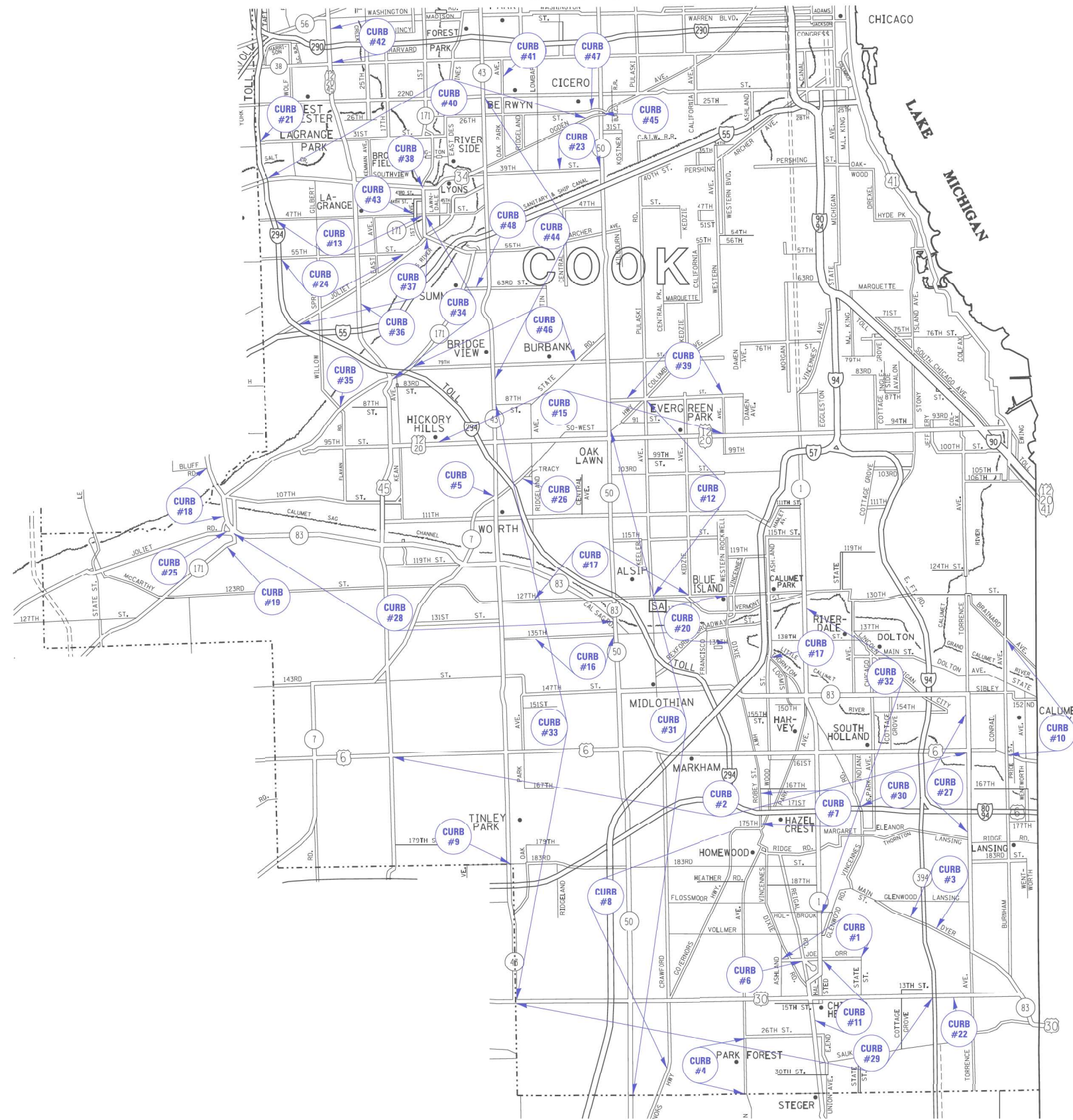

MODEL - Default
FILE NAME: S:\S\CONTRACTS\CAD\CoverSheets For Contracts.dgn

USER NAME = GONZALEZDJR	DESIGNED -	REVISED -
PLOT SCALE = 102.5029' / in.	DRAWN -	REVISED -
PLOT DATE = 2/2/2022	CHECKED -	REVISED -
	DATE -	REVISED -

STATE OF ILLINOIS
DEPARTMENT OF TRANSPORTATION

SOUTH COOK COUNTY

SCALE: SHEET 8 OF 9 SHEETS STA. TO STA.

F.A. RTE.	SECTION	COUNTY	TOTAL SHEETS	SHEET NO.
	D1 APP Paint PVT MKG 22-11	VARIOUS	8	9
CONTRACT NO. 46575				
ILLINOIS FED. AID PROJECT				

KANE COUNTY

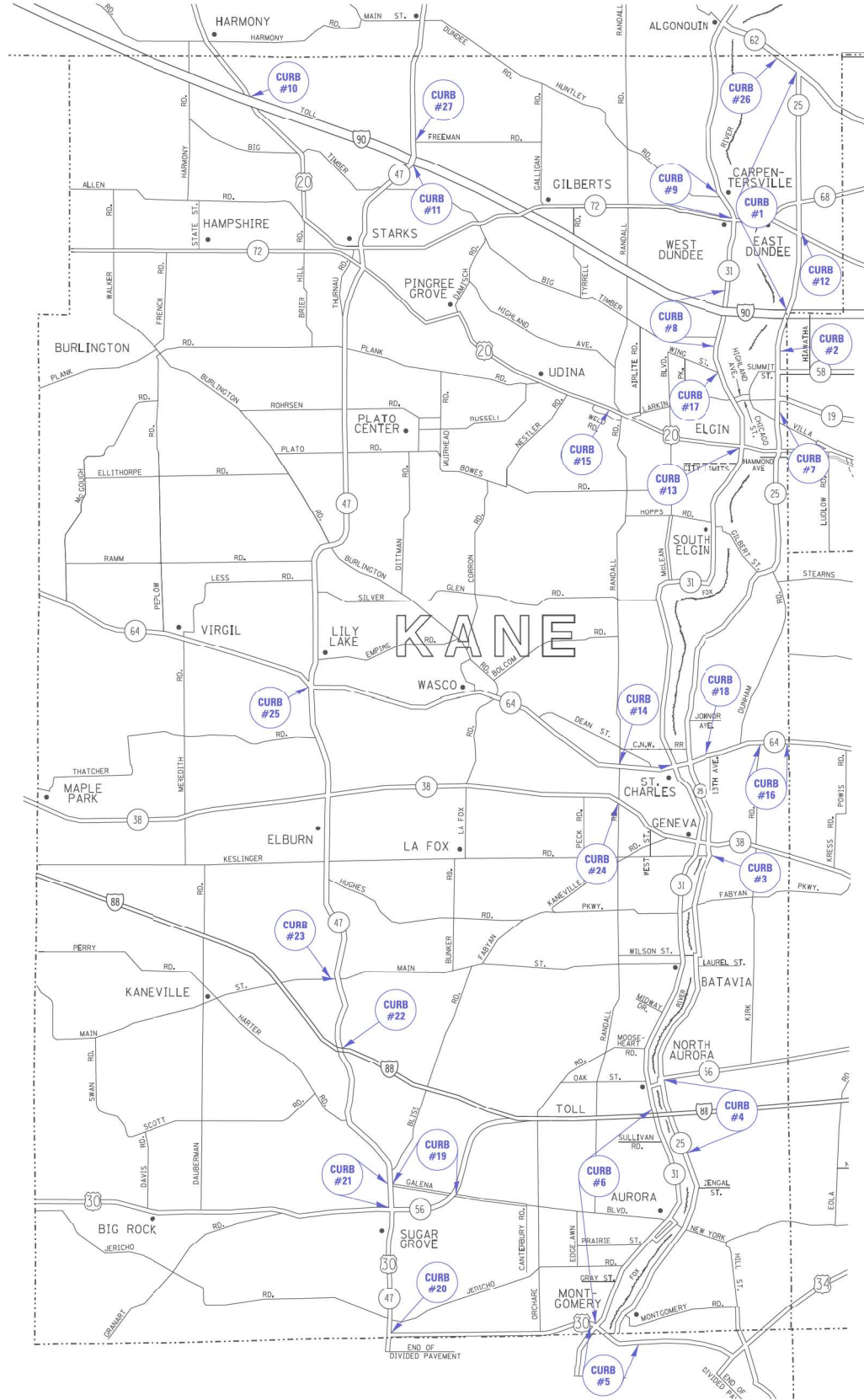

MODEL: Default
FILE NAME: S:\S1\Contracts\CAD\CoverSheets for Contract.dgn

USER NAME = GONZALEZDJR	DESIGNED -	REVISED -
PLOT SCALE = 102.7592' / in.	DRAWN -	REVISED -
PLOT DATE = 2/2/2022	CHECKED -	REVISED -
	DATE -	REVISED -

**STATE OF ILLINOIS
DEPARTMENT OF TRANSPORTATION**

KANE COUNTY	
SCALE:	SHEET 9 OF 9 SHEETS STA. TO STA.

F.A. RTE.	SECTION	COUNTY	TOTAL SHEETS	SHEET NO.
	D1 APP Paint PVT MKG 22-11	VARIOUS	9	9
CONTRACT NO. 46575				
ILLINOIS FED. AID PROJECT				