

FILE PATH = p:\388035-p\m\1\escomon\local\p\AEC\000\Documents\01\_Americas\Transportation\6269938\_Circle\Phase\_1\000\_CAD\005\_Roadway\Sheets\60W28-SHT-PLAN-06.dgn

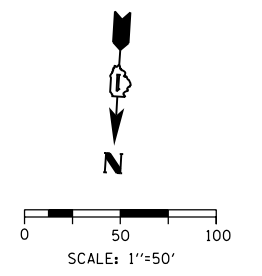

- REMOVAL LEGEND**
- PAVEMENT REMOVAL
  - PAVED SHOULDER REMOVAL
  - APPROACH SLAB REMOVAL
  - LINEAR REMOVAL
  - TREE REMOVAL, ACRES
  - TREE REMOVAL

**EXISTING**

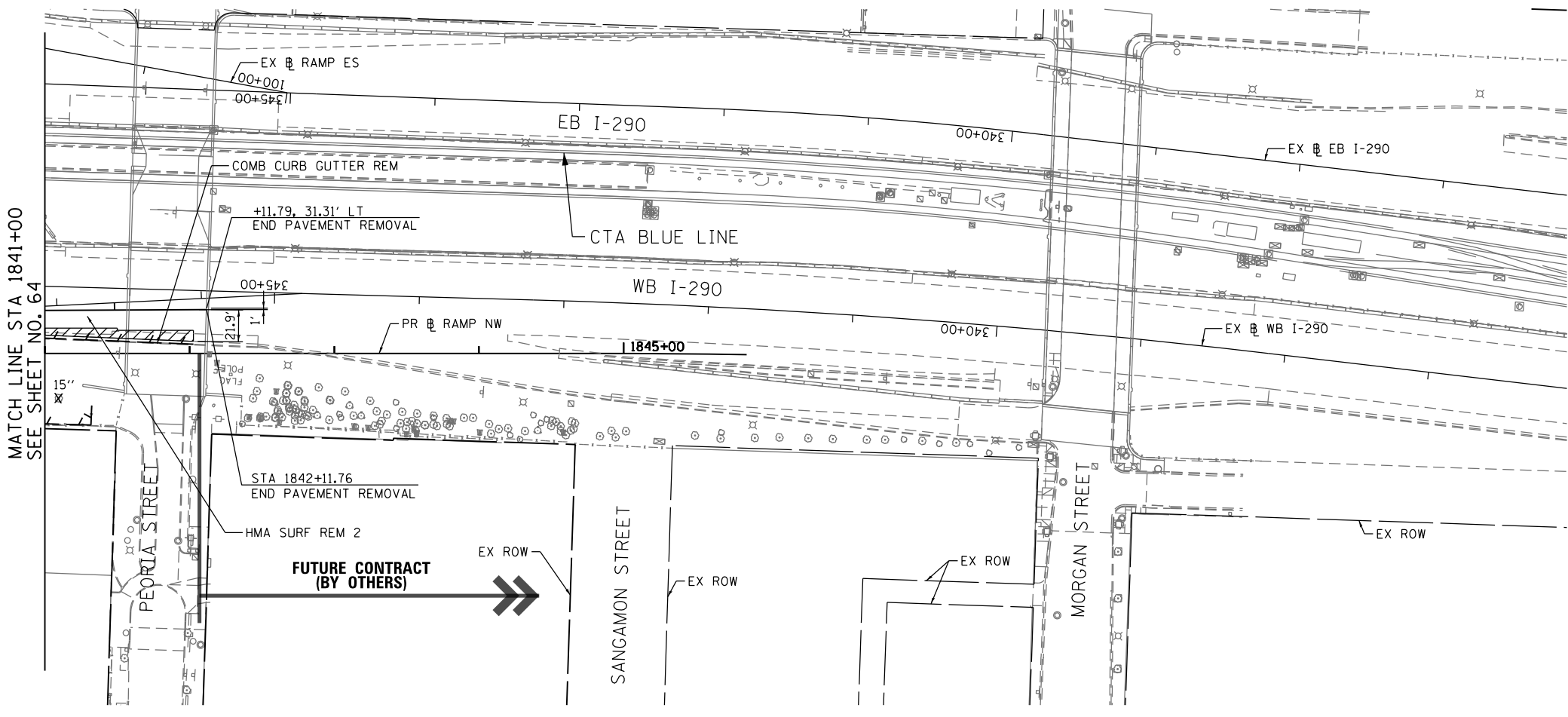
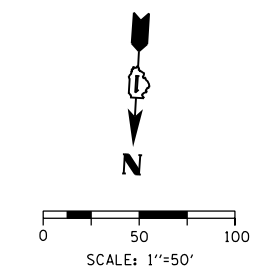
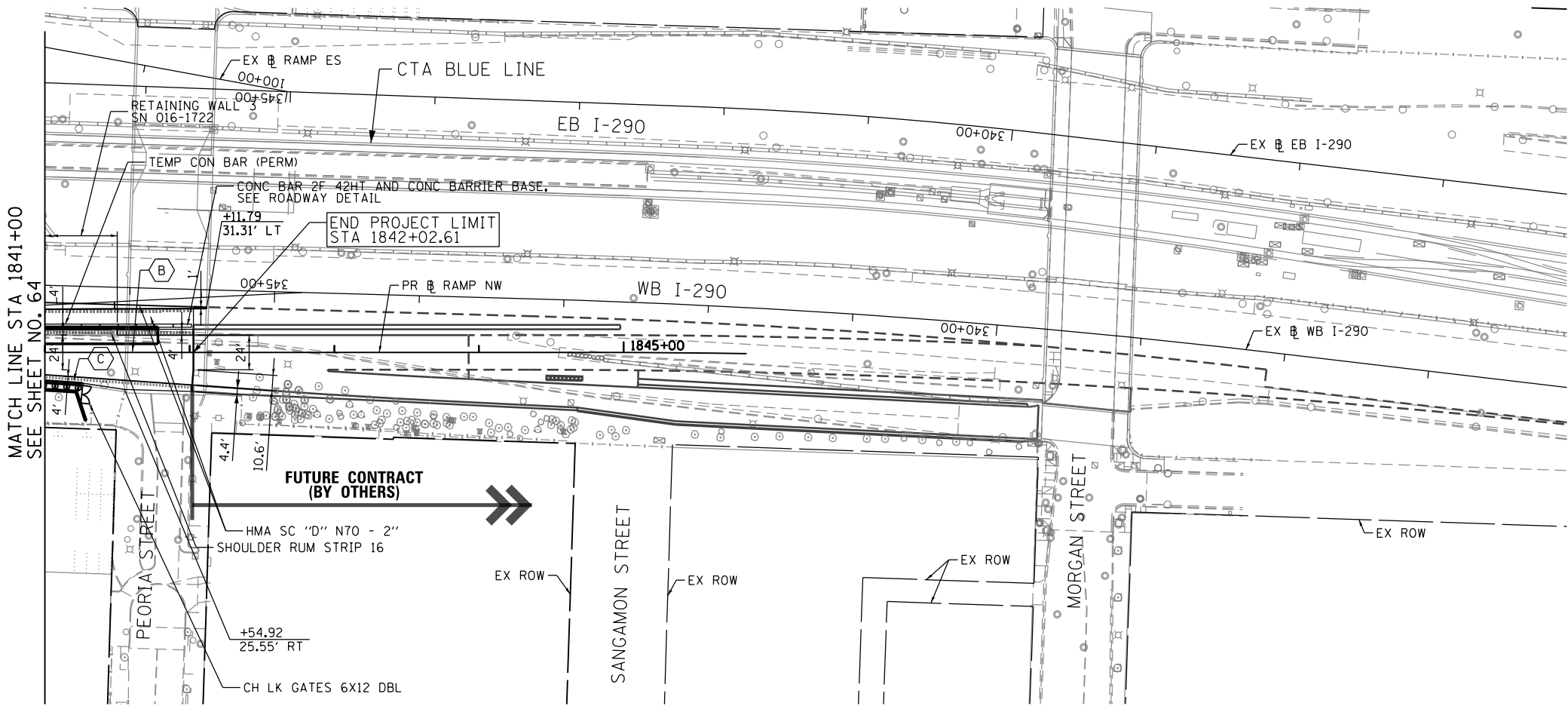

**NOTE:**  
 1. SEE SHTS 66 TO 69 FOR PR ROADWAY PROFILES

- PROPOSED ROADWAY LEGEND**
- TEMPORARY PAVEMENT SUB GRAN MAT B 4
  - PCC PVT 10 1/2 JOINTD STAB SUBBASE HMA 4 AGG SUBGRADE IMPR 12
  - PCC SHOULDERS 10 1/2 SUB GRAN MAT C 4 AGG SUBGRADE IMPR 12
  - PCC PVT 10 JOINTED STAB SUBBASE HMA 4 AGG SUBGRADE IMPR 12
  - PCC SHOULDERS 10 SUB GRAN MAT C 4 AGG SUBGRADE IMPR 12

**PROPOSED**



D160W28-SHT-PLAN-06.dgn
USER NAME = pimsarno
PLOT SCALE = 100.0000' / 1"
PLOT DATE = 4/27/2014

DESIGNED - KAM	REVISED -
DRAWN - NSA/OPS	REVISED -
CHECKED - KCF	REVISED -
DATE - 04/28/14	REVISED -

**STATE OF ILLINOIS  
 DEPARTMENT OF TRANSPORTATION**

<b>EXISTING AND PROPOSED PLAN RAMP NW</b>			
SCALE: 1"=50'	SHEET 6 OF 6 SHEETS	STA. 1841+00 TO STA. 1842+02.61	

F.A.I. RTE.	SECTION	COUNTY	TOTAL SHEETS	SHEET NO.
90/94/290	2013-010R	COOK	747	65
CONTRACT NO. 60W28				
ILLINOIS FED. AID PROJECT				