

* FROM PREVIOUS TO REMAIN

PROPOSED TEMP PAVEMENT MARKINGS AND TRAFFIC CONTROL DEVICES

- (A) TEMP EPOXY PVT MK LINE 4 (SOLID WHITE)
- (B) TEMP EPOXY PVT MK LINE 4 (SOLID YELLOW)
- (C) TEMP EPOXY PVT MK LINE 4 (2' DASH 6' SKIP, WHITE)
- (D) TEMP EPOXY PVT MK LINE 5 (10' DASH 30' SKIP, WHITE)
- (E) TEMP EPOXY PVT MK LINE 8 (SOLID WHITE)
- (F) TEMP EPOXY PVT MK LINE 12 (WHITE CHEVRONS @ 45°, 30' SPACING) (TYP)
- (G) TEMP CONC BARRIER @ 12:1 ON TAPERS UNLESS OTHERWISE NOTED
- (H) IMP ATTN TEMP FRN TL3
- (I) TYPE II BARRICADE OR DRUMS WITH STEADY BURN MONODIRECTIONAL LIGHT @ 50' C-C (TYP) ON TAPERS AND RAMPS @ 100' C-C (TYP) ON TANGENTS
- (J) DIRECTIONAL INDICATOR BARRICADE WITH STEADY BURN MONODIRECTIONAL LIGHT @ 50' C-C
- (K) REL TEMP CONC BARRIER @ 12:1 ON TAPERS UNLESS OTHERWISE NOTED
- (L) IMP ATTN REL FRN TL3

- LEGEND:**
- WORK ZONE
 - TEMPORARY CONCRETE BARRIER
 - TEMPORARY IMPACT ATTENUATOR
 - TEMPORARY SOIL RETENTION SYSTEM OR BRACED EXCAVATION
 - DIRECTION OF TRAFFIC FLOW
 - TYPE III BARRICADE
 - TYPE II BARRICADE OR DRUMS WITH STEADY BURN MONODIRECTIONAL LIGHT
 - DIRECTIONAL INDICATOR BARRICADE WITH STEADY BURN MONODIRECTIONAL LIGHT
 - SIGN
 - ARROW BOARD
 - REMOVAL LIMITS
 - TEMPORARY PAVEMENT

MATCH LINE STA 135+00 EX NB I-90/94 SEE SHEET NO. 182

MATCH LINE STA 150+00 EX NB I-90/94 SEE SHEET NO. 184

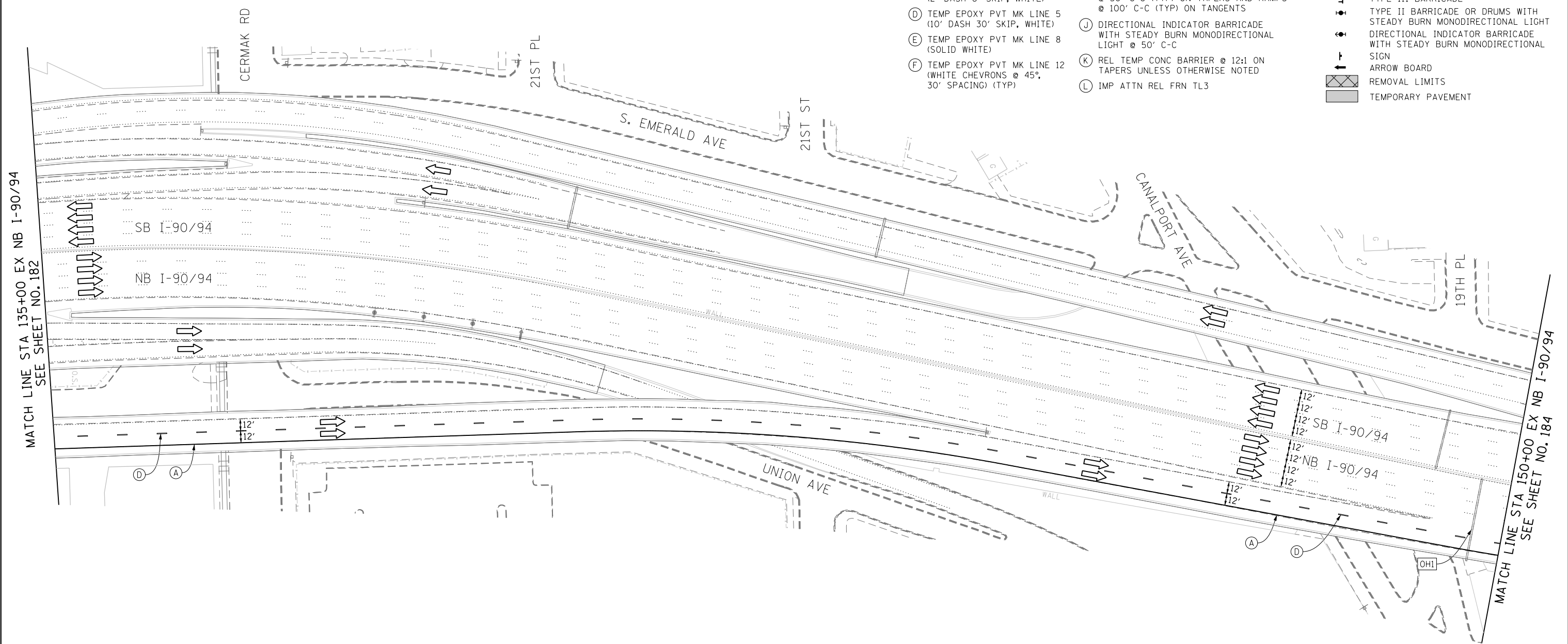

OH1 EXISTING OVERHEAD SIGNS

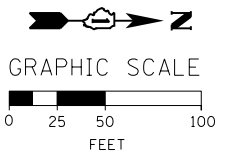

FILE PATH = CA:\Projectbase\160W28-sht-Staging4-02.dgn



DI60W28-sht-Staging4-02.dgn	DESIGNED - OPS	REVISED -
USER NAME = auyeungh	DRAWN - PHP	REVISED -
PLOT SCALE = 50.0000' / in.	CHECKED - KCF	REVISED -
PLOT DATE = 4/28/2014	DATE - 04/28/14	REVISED -

DESIGNED - OPS	REVISED -
DRAWN - PHP	REVISED -
CHECKED - KCF	REVISED -
DATE - 04/28/14	REVISED -

**STATE OF ILLINOIS
DEPARTMENT OF TRANSPORTATION**

SUGGESTED STAGES OF CONSTRUCTION AND TRAFFIC CONTROL PLAN			
MAINLINE STAGING 4			
SCALE: 1" = 50'	SHEET 3	OF 14 SHEETS	STA. 135+00 TO STA. 150+00

F.A.I. RTE. 90/94/290	SECTION 2013-010R	COUNTY COOK	TOTAL SHEETS 747	SHEET NO. 183
CONTRACT NO. 60W28				
ILLINOIS FED. AID PROJECT				