

PAVEMENT MARKING NOTES

1. ALL FINAL PAVEMENT MARKING MATERIALS PLACED ON PCC PAVEMENT SHALL BE POLYUREA TYPE I EXCEPT WHERE NOTED IN THE PLANS.
2. ALL FINAL PAVEMENT MARKING MATERIALS PLACED ON BITUMINOUS PAVEMENT SHALL BE THERMOPLASTIC EXCEPT WHERE NOTED IN THE PLANS.
3. ALL FINAL PAVEMENT MARKING SYMBOLS SHALL BE OF SMALL SIZE.
4. ALL DAMAGE TO EXISTING PAVEMENT MARKINGS OR RAISED REFLECTIVE PAVEMENT MARKERS OUTSIDE OF THE IMPROVEMENT LIMITS SHOWN ON THE PLANS SHALL BE REPLACED AT THE CONTRACTOR'S EXPENSE.
5. BEFORE BEGINNING ANY WORK, THE CONTRACTOR SHALL RECORD AND RETAIN ALL EXISTING PAVEMENT MARKINGS AND MARKERS FOR FUTURE REFERENCE. EXACT LOCATIONS OF ALL PAVEMENT MARKINGS SHALL BE DIRECTED BY THE ENGINEER.
6. THE RESIDENT ENGINEER SHALL CONTACT EXPRESSWAY TRAFFIC CONTROL SUPERVISOR AT 847-705-4155 AND ARTERIAL TRAFFIC CONTROL SUPERVISOR AT 847-705-4470 A MINIMUM OF 2 WEEKS PRIOR TO PLACEMENT OF PERMANENT PAVEMENT MARKINGS.
7. PARTIAL STATIONS PROVIDED REFER TO MAINLINE I-290 UNLESS OTHERWISE NOTED.
8. MAINLINE AND RAMP LANE WIDTHS ARE 12' AND 11', RESPECTIVELY, UNLESS OTHERWISE NOTED.
9. SEE PAVEMENT MARKING DETAIL SHEETS FOR ADDITIONAL INFORMATION.

LEGEND

PAVEMENT MARKING MATERIAL

- EPOXY PAVEMENT MARKING
- ◇ PAVEMENT MARKING TAPE, TYPE III
- THERMOPLASTIC PAVEMENT MARKING
- △ POLYUREA PAVEMENT MARKING TYPE I

PAVEMENT MARKING TYPE

- A - LETTERS AND SYMBOLS (WHITE)
- B - 4" WHITE EDGE LINE
- C - 4" YELLOW LINE
- D - 4" DOUBLE YELLOW CENTERLINE
- E - 4" WHITE (6' DASH, 18' SKIP)
- F - 4" YELLOW (6' DASH, 18' SKIP)
- G - 4" WHITE (2' DASH, 6' SKIP)
- H - 5" WHITE (10' DASH, 30' SKIP)
- I - 6" WHITE SOLID LINE
- J - 6" WHITE (2' DASH, 6' SKIP)
- K - 6" WHITE 45° DIAGONALS SPACED @ 20' CENTERS
- L - 8" WHITE EDGE LINE
- M - 8" WHITE DOTTED LANE LINE, 3' DASH, 9' SKIP
- N - 12" WHITE 45° DIAGONALS SPACED @ 20' CENTERS
- O - 12" WHITE 45° DIAGONALS SPACED @ 30' CENTERS
- P - 12" WHITE 45° DIAGONALS SPACED @ 500' CENTERS
- Q - 12" YELLOW 45° DIAGONALS SPACED @ 50' CENTERS
- R - 12" YELLOW 45° DIAGONALS SPACED @ 500' CENTERS
- S - 12" WHITE CHEVRONS SPACED @ 30' CENTERS
- T - 24" WHITE STOP BAR
- U - 24" WHITE CROSSWALK, 6' WIDTH, SPACED @ 4' CENTERS
- Y - RAISED REFLECTIVE PAVEMENT MARKER (BRIDGE) (1-WAY CRYSTAL / OPAQUE)
- Z - RAISED REFLECTIVE PAVEMENT MARKER (1-WAY CRYSTAL / OPAQUE)

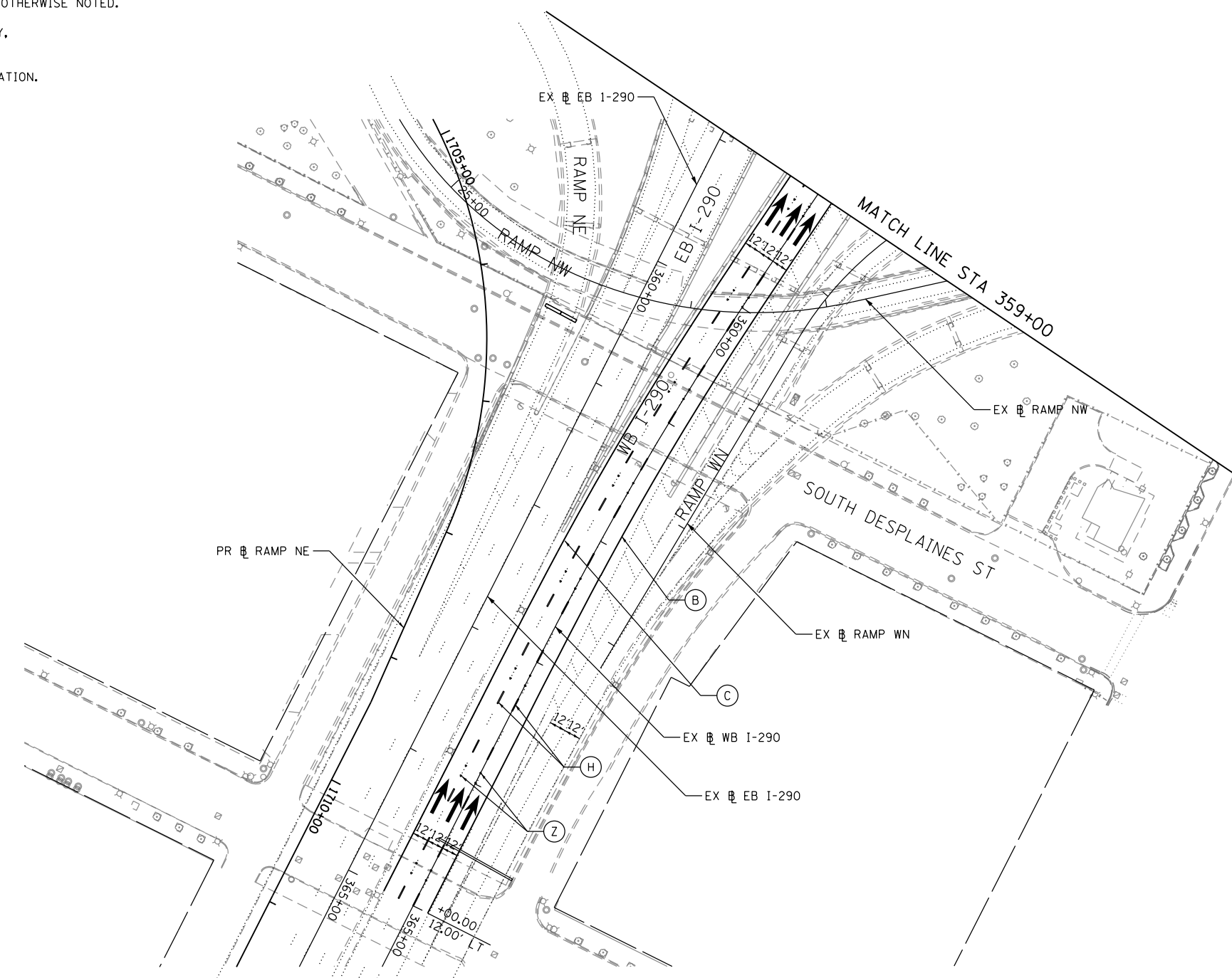
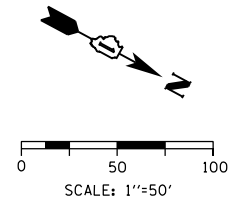

FILE PATH = C:\Users\alizabethN\Desktop\Prints\Final Sheets\0160W28-SHT-Pmk-11.dgn



| | | |
|------------------------------|-----------------|-----------|
| D160W28-SHT-Pmk-11.dgn | DESIGNED - OPS | REVISED - |
| USER NAME = alizabethn | DRAWN - NSA | REVISED - |
| PLOT SCALE = 100.0000' / in. | CHECKED - KCF | REVISED - |
| PLOT DATE = 4/27/2014 | DATE - 04/28/14 | REVISED - |

**STATE OF ILLINOIS
DEPARTMENT OF TRANSPORTATION**

PAVEMENT MARKING PLAN

SCALE: 1"=50' SHEET 11 OF 11 SHEETS STA. TO STA.

| | | | | |
|--------------------|-----------|--------|---------------------------|-----------|
| F.A.I. RTE. | SECTION | COUNTY | TOTAL SHEETS | SHEET NO. |
| 90/94/290 | 2013-010R | COOK | 747 | 268 |
| CONTRACT NO. 60W28 | | | ILLINOIS FED. AID PROJECT | |