

FILE PATH = p:\388035\pmt\escomonline\local\p\AECOM\Documents\01_Americas\Transportation\6269938_Circle\Phase_1\000_CAD\016_Electrical\Sheets\60W28_Contract\0160W28-sht-Light-11

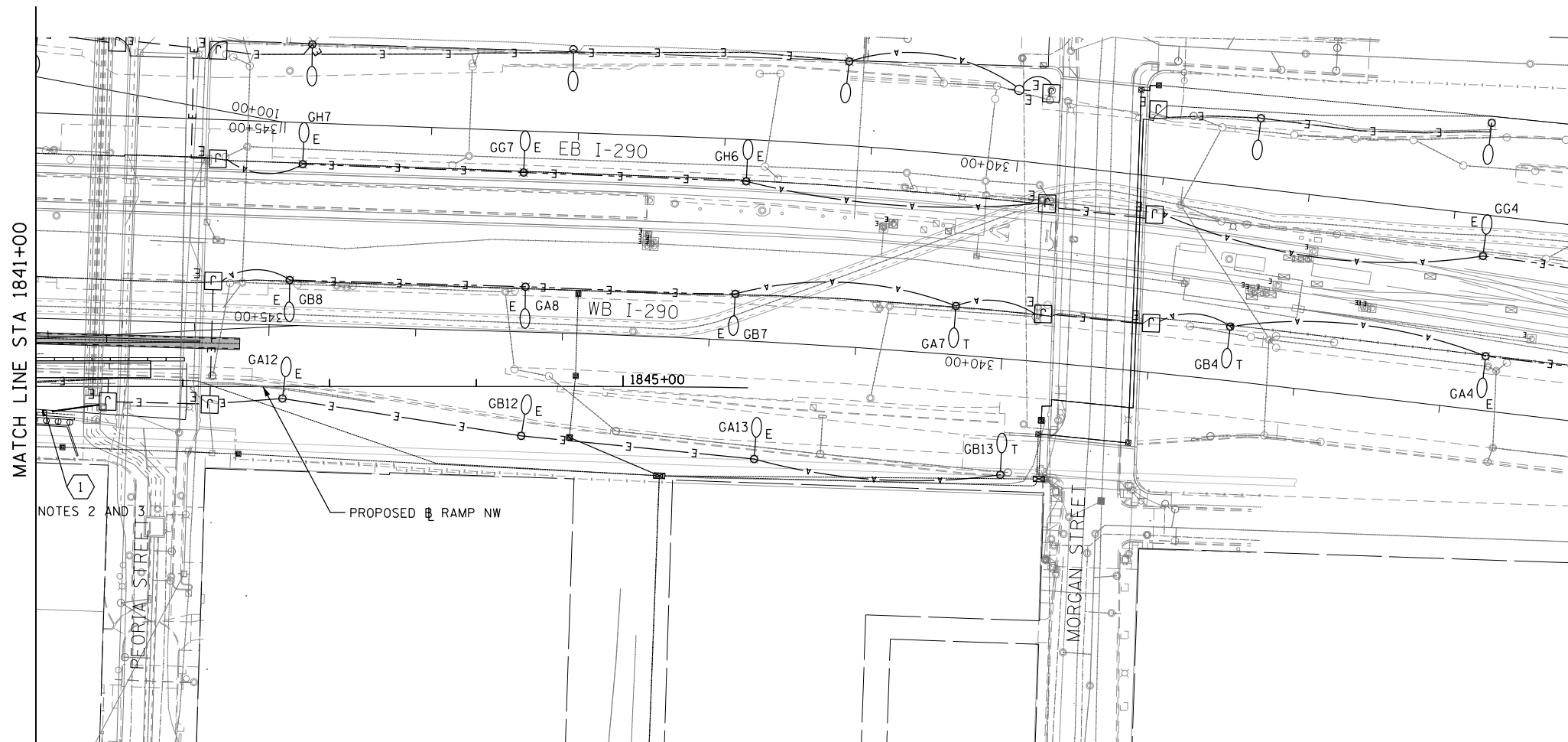

1 CKTS GA & GB: 3-1/2 NO. 2 & 1-1/2 NO. 4 GROUND XLP
TYPE USE CABLES IN 1 1/2" POLYETHYLENE UNIT DUCT
NOTE 4

NOTES:

1. SEE DRAWING E-01 FOR IDOT ELECTRICAL SYMBOLS.
2. PROVIDE A NEW LIGHTING FEED FROM THE EXISTING JUNCTION BOX ATTACHED TO THE PEORIA STREET BRIDGE TO THE TEMPORARY LIGHTING UNIT, GB11 AS SHOWN. ROUTE THE UNIT DUCT THROUGH EXISTING CONDUIT ATTACHED TO STRUCTURE TO THE EXISTING JUNCTION BOX.
3. THE UNIT DUCT INSTALLATION AND ROUTING SHALL BE COORDINATED WITH THE NOISE WALL RECONSTRUCTION WORK. THE UNIT DUCT FOR THE ROADWAY LIGHTING FEED SHALL BE ROUTED BETWEEN THE CAISSONS FOR THE NEW NOISE WALL, UNLESS OTHERWISE DIRECTED.
4. EXISTING IDOT LIGHTING CONTROLLER 'G' IS LOCATED ON THE NORTH SIDE OF WB I-290 JUST EAST OF RACINE AVE. SEE DRAWING E-14 FOR IDOT CONTROLLER 'G' WIRING DIAGRAM.

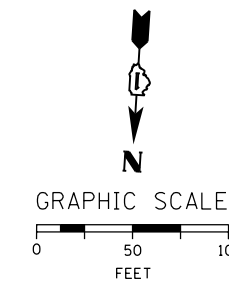

E-11



D160W28-sht-Light-11
USER NAME = myersc
PLOT SCALE = 50.0000' / in.
PLOT DATE = 4/24/2014

DESIGNED - WDS	REVISED -
DRAWN - CAM	REVISED -
CHECKED - WDS	REVISED -
DATE - 04/28/14	REVISED -

**STATE OF ILLINOIS
DEPARTMENT OF TRANSPORTATION**

**RAMP NORTHWEST
PROPOSED LIGHTING PLAN**

SCALE: 1"=50' SHEET 11 OF 17 SHEETS STA. 1841+00 TO STA. 1846+00

F.A.I. RTE.	SECTION	COUNTY	TOTAL SHEETS	SHEET NO.
90/94/290	2013-010R	COOK	747	301
CONTRACT NO. 60W28				
ILLINOIS FED. AID PROJECT				