

To determine "t": After all structural steel has been erected, elevations of the top flanges of the girders shall be taken at intervals shown below. These elevations subtracted from the "Theoretical Grade Elevations Adjusted for Dead Load Deflection" shown on Sheets S-16 and S-17, minus slab thickness, equals the fillet heights "t" above top flange of girders.

**FILLET HEIGHTS**

Girder No.	DEAD LOAD DEFLECTIONS									
	Span 3					Span 4				
	A1	A2	A3	A4	A5	B1	B2	B3	B4	B5
1B	1 1/4"	1 1/8"	0 1/8"	43'-1 5/8"	172'-6 3/8"	1 1/2"	2 7/8"	2 3/8"	42'-3 7/8"	169'-3 5/8"
2B	-	-	-	-	-	2 7/8"	2 5/8"	1 5/8"	26'-2 7/8"	104'-11 5/8"
3B	0 1/8"	0"	-0 1/8"	13'-11 1/8"	55'-8 3/4"	1 3/8"	2 3/4"	2 3/8"	42'-6 1/8"	170'-0 5/8"
4B	1 3/8"	1 1/2"	0 3/8"	43'-0 1/8"	172'-0 5/8"	1 1/4"	2 5/8"	2 3/8"	42'-7 7/8"	170'-7 1/2"
5B	1 5/8"	1 3/4"	0 5/8"	43'-0 1/8"	172'-0 3/8"	1 1/8"	2 5/8"	2 1/4"	42'-9 5/8"	171'-2 3/8"
6B	1 3/4"	1 7/8"	0 5/8"	43'-0"	172'-0 1/8"	1 1/8"	2 1/2"	2 1/4"	42'-11 3/8"	171'-9 1/4"
7B	1 3/4"	1 3/4"	0 5/8"	43'-0"	171'-11 7/8"	1"	2 3/8"	2 1/8"	43'-1"	172'-4 1/4"
8B	0 1/2"	0 1/4"	0"	13'-11 1/8"	55'-8 3/4"	1"	2 3/8"	2 1/8"	43'-2 3/8"	172'-9 5/8"
9B	1 5/8"	1 5/8"	0 1/2"	43'-0 1/8"	172'-0 3/8"	1"	2 1/4"	2"	43'-4 1/8"	173'-4 3/8"

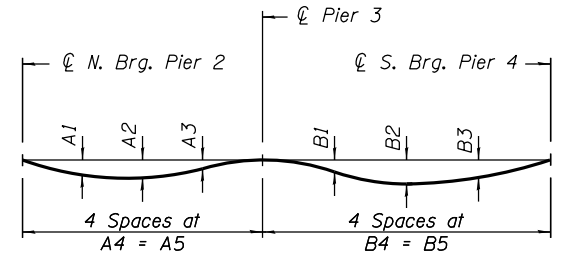

**DEAD LOAD DEFLECTION DIAGRAM**

(Includes weight of concrete only.)

Notes:  
The above deflections are not to be used in the field if the engineer is working from the grade elevations adjusted for dead load deflections as shown on Sheets S-16 and S-17.

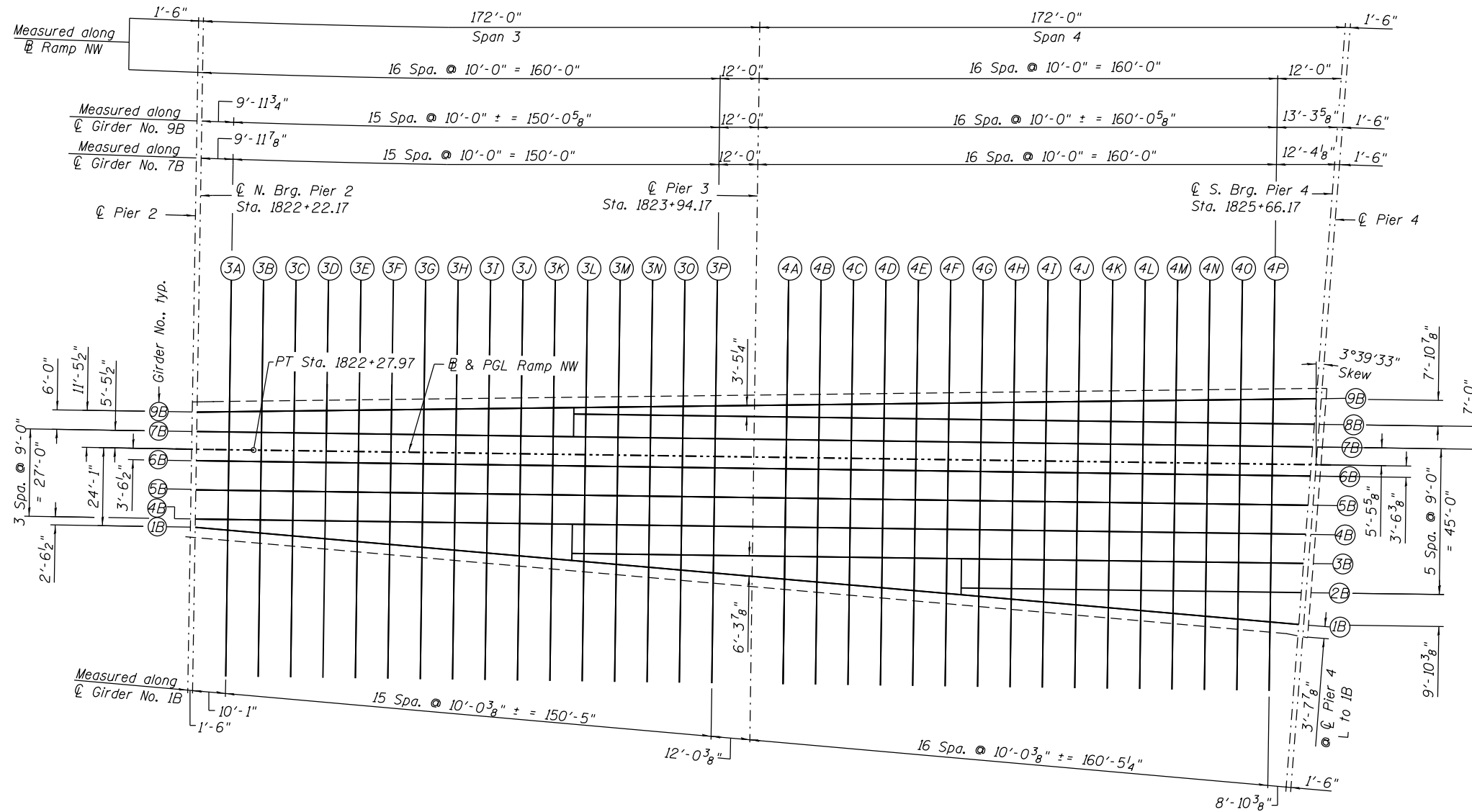
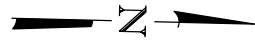

**PLAN**

0161705-60W28-5015-TopSlab.dgn



USER NAME = floresg	DESIGNED - VP	REVISED
	CHECKED - MK	REVISED
PLOT SCALE = N.T.S.	DRAWN - MRK	REVISED
PLOT DATE = 5/7/2014	CHECKED - ATB	REVISED

STATE OF ILLINOIS  
DEPARTMENT OF TRANSPORTATION

TOP OF SLAB ELEVATIONS PLAN - UNIT II  
STRUCTURE NO. 016-1705

SHEET NO. S-15 OF S-165 SHEETS

F.A.I. RTE. 90/94/290	SECTION 2013-010R	COUNTY COOK	TOTAL SHEETS 747	SHEET NO. 331
CONTRACT NO. 60W28			ILLINOIS FED. AID PROJECT	