

GIRDER ELEVATION - UNIT III

(Connection and Splice R's not shown for clarity)

Girder	AA	BB	CC	DD	EE	FF
1, 2, 3	1"x18"	1 1/2"x22"	2"x24"	2"x24"	1"x18"	1 1/2"x18"
4, 5, 6	1"x18"	1"x18"	2"x22"	2"x22"	1"x18"	1"x18"

GIRDER DIMENSIONS - UNIT III

(All Dimensions in Feet)

Girder	Radius	L*	S1	S2	A	B	C	D	E	C1	C2	C3
1	560.417	299.438	164.467	134.972	50.246	71.671	42.550	57.080	77.892	147 Spa at 10"	80 Spa at 15"	94 Spa at 10"
2	552.250	295.263	162.280	132.983	49.723	70.626	41.930	56.248	76.736	121 Spa at 12"	74 Spa at 16"	77 Spa at 12"
3	544.083	291.088	160.093	130.994	49.201	69.583	41.310	55.416	75.579	119 Spa at 12"	73 Spa at 16"	76 Spa at 12"
4	535.917	286.912	157.907	129.006	48.679	68.538	40.690	54.584	74.421	118 Spa at 12"	72 Spa at 16"	82 Spa at 11"
5	527.750	282.737	155.720	127.017	48.157	67.494	40.069	53.752	73.265	116 Spa at 12"	81 Spa at 14"	80 Spa at 11"
6	519.583	278.561	153.533	125.028	47.634	66.449	39.450	52.921	72.107	115 Spa at 12"	80 Spa at 14"	73 Spa at 12"

* Girder Length "L" excludes girder ends beyond first & last bearings.

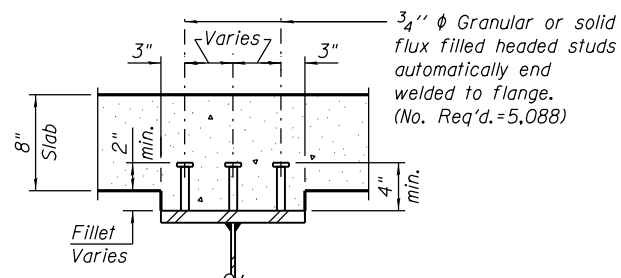

SECTION A-A

NOTES:

1. See Sheet S-83 for girder framing plan.
2. See Sheet S-85 for camber & top of web elevations.
3. See Sheet S-86 for moment tables & reaction tables.
4. See Sheet S-99 for girder bolted field splice details.
5. See Sheets S-100 thru S-102 for girder cross frame details.
6. All structural steel shall be AASHTO M270 Grade 50.
7. Load carrying components designated "NTR" shall conform to the Impact Testing Requirement, Zone 2.

0161705-60W28-50B4-GirderElev.dgn



USER NAME = floresg	DESIGNED - DD	REVISED
	CHECKED - ATB	REVISED
PLOT SCALE = N.T.S.	DRAWN - MRK	REVISED
PLOT DATE = 5/7/2014	CHECKED - DD	REVISED

**STATE OF ILLINOIS
DEPARTMENT OF TRANSPORTATION**

**GIRDER ELEVATIONS - UNIT III
STRUCTURE NO. 016-1705**

SHEET NO. S-84 OF S-165 SHEETS

F.A.I. RTE.	SECTION	COUNTY	TOTAL SHEETS	SHEET NO.
90/94/290	2013-010R	COOK	747	400
CONTRACT NO. 60W28			ILLINOIS FED. AID PROJECT	