

BEARING LAYOUT - UNIT 5

NOTES:

- A = Angle between Tangent to Girder and Direction of Movement.
- B = Angle between Tangent to Girder and \varnothing of Pier or Abutment.
- C = Setting angle between \varnothing of Bearing Base Plate and \varnothing Pier or Abutment.
- D = Set Bearing Base Plates at right angles to the Direction of Movement/Chord.

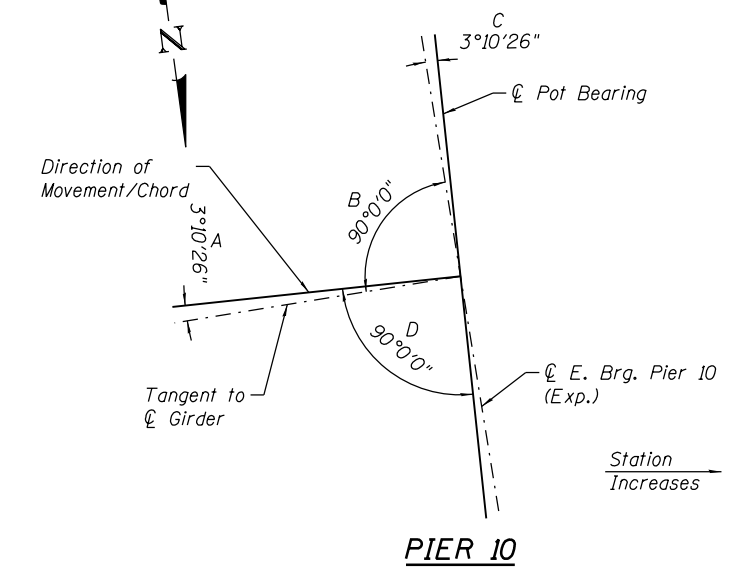
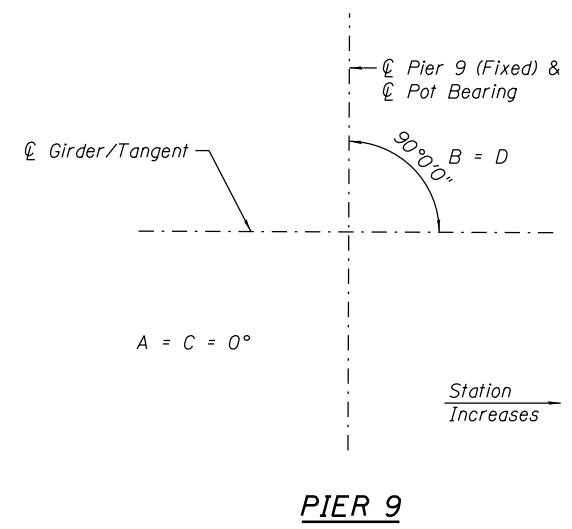
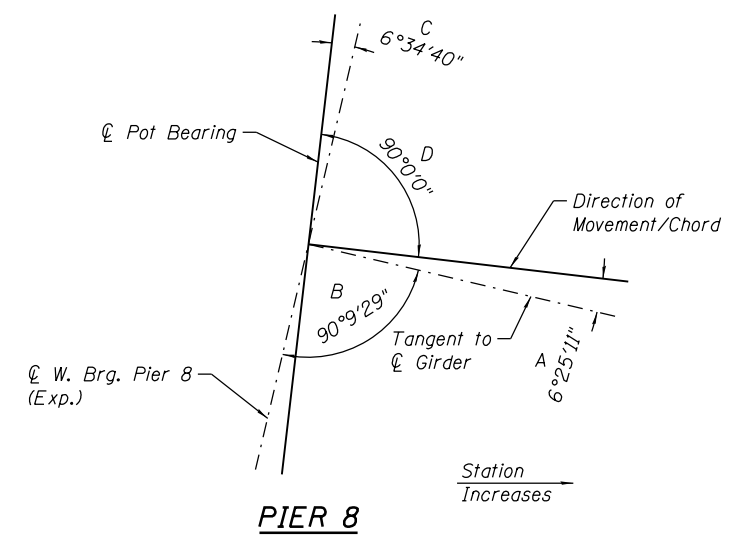

BEARING ORIENTATION - UNIT 5

0161705-60W28-5105-Bearing.dgn



USER NAME = floresg	DESIGNED - ATB	REVISED
PLOT SCALE = N.T.S.	CHECKED - EJO	REVISED
PLOT DATE = 5/7/2014	DRAWN - MK	REVISED
	CHECKED - ATB	REVISED

**STATE OF ILLINOIS
DEPARTMENT OF TRANSPORTATION**

**BEARING LAYOUT AND ORIENTATION - UNIT V
STRUCTURE NO. 016-1705**

SHEET NO. S-105 OF S-165 SHEETS

F.A.I. RTE. 90/94/290	SECTION 2013-010R	COUNTY COOK	TOTAL SHEETS 747	SHEET NO. 421
CONTRACT NO. 60W28			ILLINOIS FED. AID PROJECT	