

FOR INFORMATION ONLY

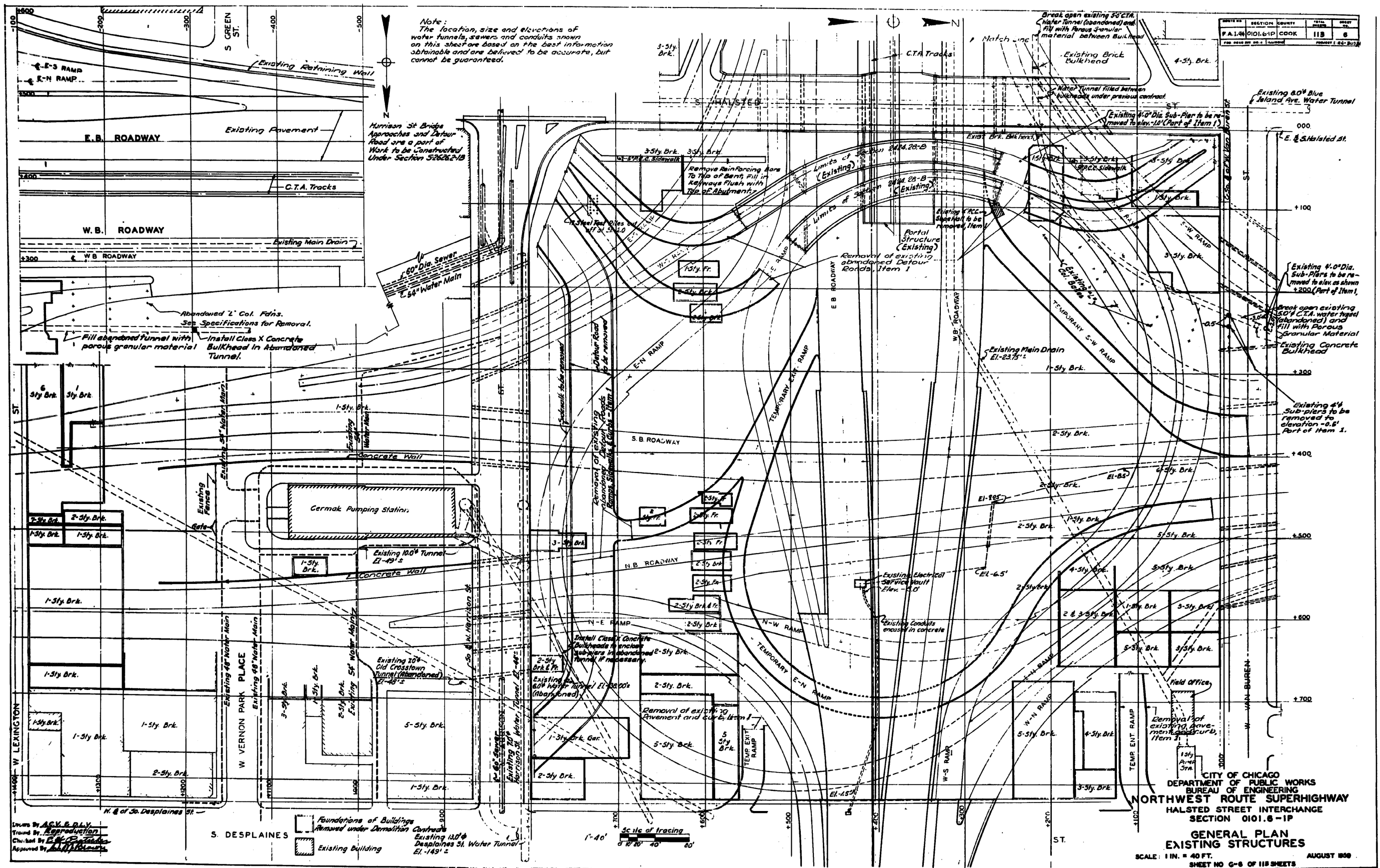

SECTION	COUNTY	TOTAL SHEETS	SHEET NO.
F.A.I. 90/94/290	COOK	118	6

CITY OF CHICAGO  
 DEPARTMENT OF PUBLIC WORKS  
 BUREAU OF ENGINEERING  
**NORTHWEST ROUTE SUPERHIGHWAY**  
 HALSTED STREET INTERCHANGE  
 SECTION 0101.6-1P  
**GENERAL PLAN**  
**EXISTING STRUCTURES**  
 SCALE: 1 IN. = 40 FT.  
 SHEET NO. 6-6 OF 118 SHEETS  
 AUGUST 1990

FILE PATH = C:\Projects\11-0425 - 60W28 Structure\11-0425-60W28-AS-BUILT-04.dgn



D160W28-sht-AS-BUILT-04.dgn  
 USER NAME = ayeung  
 PLOT SCALE = 1:8000 / 1 in.  
 PLOT DATE = 4/25/2014

DESIGNED -  
 DRAWN -  
 CHECKED -  
 DATE - 04/28/14

REVISED -  
 REVISED -  
 REVISED -  
 REVISED -

STATE OF ILLINOIS  
 DEPARTMENT OF TRANSPORTATION

EXISTING AS-BUILTS  
 SN 016-2449 & SN 016-2451  
 SCALE: NTS  
 SHEET 4 OF 48 SHEETS  
 STA. TO STA.

F.A.I. RTE.	SECTION	COUNTY	TOTAL SHEETS	SHEET NO.
90/94/290	2013-010R	COOK	747	474
CONTRACT NO. 60W28				
ILLINOIS FED. AID PROJECT				