

FOR INFORMATION ONLY

ROUTE NO.	SECTION	COUNTY	TOTAL SHEETS	SHEET NO.
F. A. I. 94	0101.6-1P	COOK	113	79
PLAN RAMP ORL No. 4	ALIGNED	PRIORITY 1-94-3(1)-21		

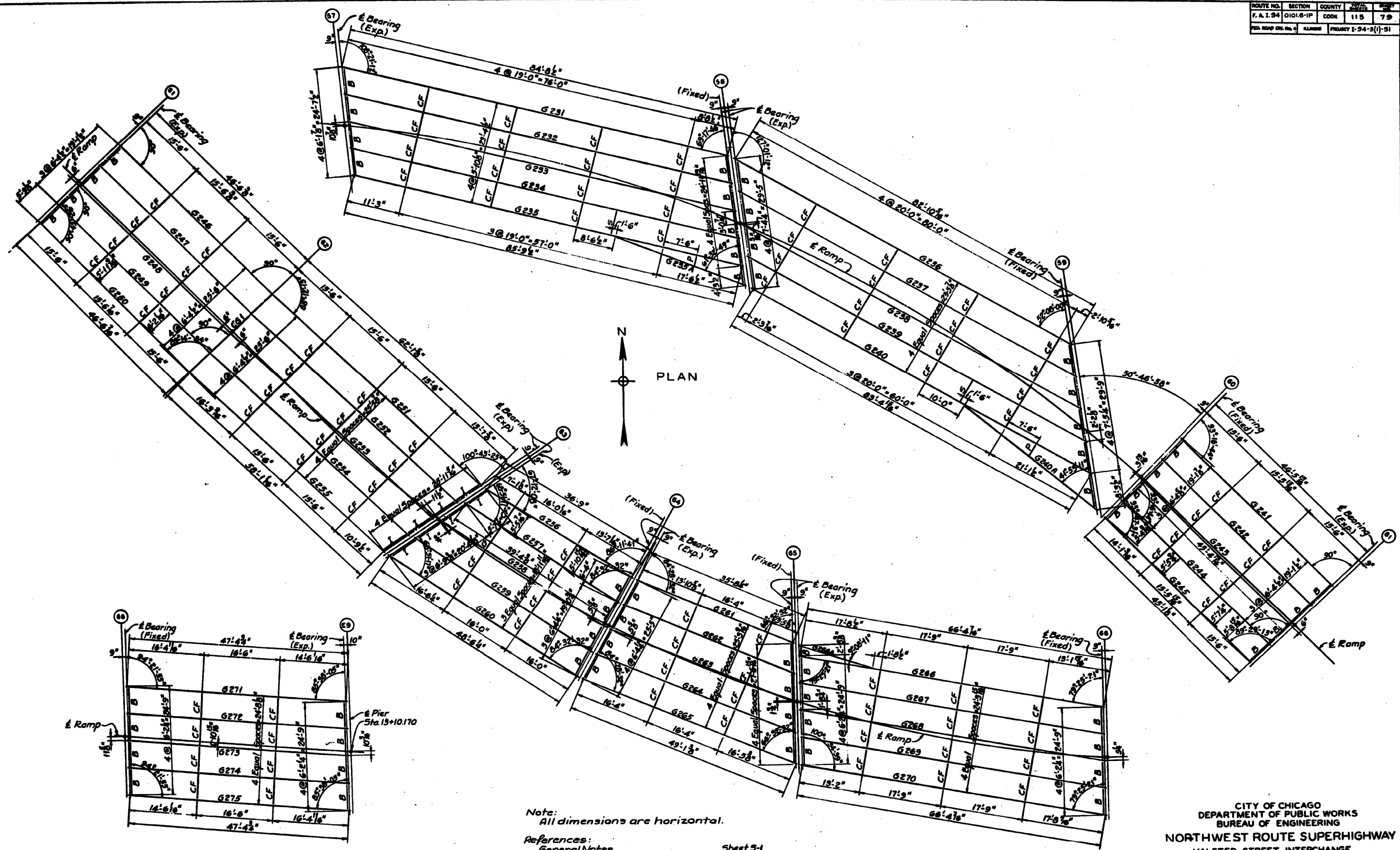

Note:
All dimensions are horizontal.

- References:
- General Notes
 - Structural Steel Details
 - Concrete Beris
 - Structural Steel Expansion Guards
 - Deck Slab
 - Additional Framing Plan
 - Girder Schedule

- Sheet 5-1
- Sheets 5-24 & 5-25
- Sheets 5-11 & 5-12
- Sheets 5-26 & 5-27
- Sheets 5-28 & 5-31
- Sheet 5-21
- Sheet 5-21

IN CHARGE *[Signature]*
DESIGNED BY *[Signature]*
DRAWN BY *[Signature]*
CHECKED BY *[Signature]*
APPROVED BY *[Signature]*

CITY OF CHICAGO
DEPARTMENT OF PUBLIC WORKS
BUREAU OF ENGINEERING
NORTHWEST ROUTE SUPERHIGHWAY
HALSTED STREET INTERCHANGE
SECTION 0101.6-1P
STRUCTURAL STEEL FRAMING PLAN
W.S. RAMP
SCALE: 1/4" = 1'-0"
AUGUST 1999
SHEET NO. 3-22 OF 113 SHEETS

FILE PATH = C:\Projects\14-0425 - 60W28 StructBulds\14-0425-sht-AS-BUILT-27.dgn



D160W28-sht-AS-BUILT-27.dgn
USER NAME = auyeungh
PLOT SCALE = 1:8000 / 1 in.
PLOT DATE = 4/25/2014

DESIGNED -	REVISED -
DRAWN -	REVISED -
CHECKED -	REVISED -
DATE - 04/28/14	REVISED -

STATE OF ILLINOIS
DEPARTMENT OF TRANSPORTATION

EXISTING AS-BUILTS
SN 016-2449 & SN 016-2451
SCALE: NTS SHEET 27 OF 48 SHEETS STA. TO STA.

F.A.I. RTE.	SECTION	COUNTY	TOTAL SHEETS	SHEET NO.
90/94/290	2013-010R	COOK	747	497
CONTRACT NO. 60W28				
ILLINOIS FED. AID PROJECT				