

FOR INFORMATION ONLY

ROUTE NO.	SECTION	COUNTY	TOTAL SHEETS	SHEET NO.
F. A. I. 94	0101.6-1P	COOK	113	99
FED. ROAD BY No. 4 ILL. HDW. PROJECT I-94-2(1)-21				

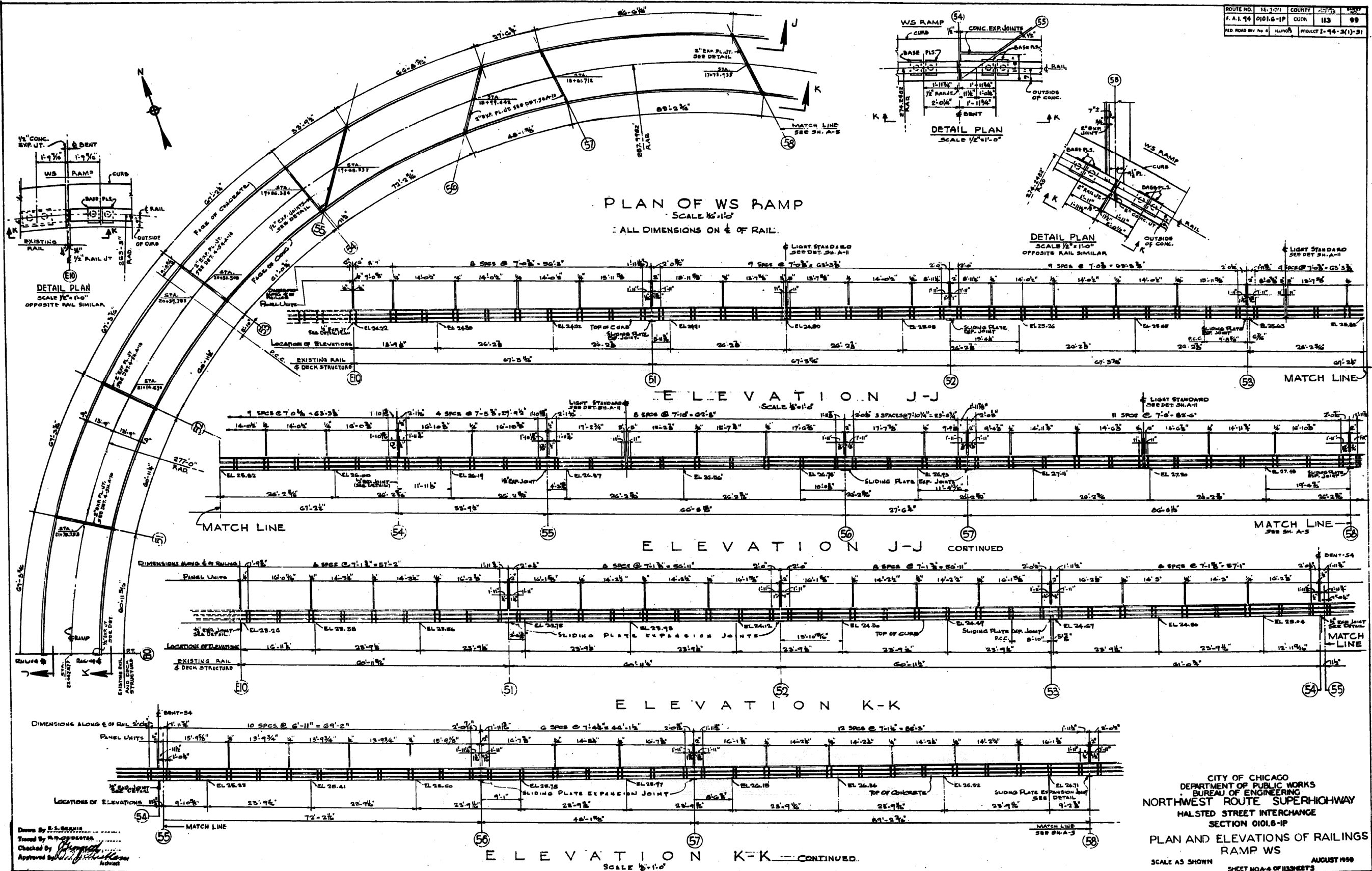

Drawn By S. S. Berman  
 Traced By M. J. Gussman  
 Checked By [Signature]  
 Approved By [Signature]

CITY OF CHICAGO  
 DEPARTMENT OF PUBLIC WORKS  
 BUREAU OF ENGINEERING  
 NORTHWEST ROUTE SUPERHIGHWAY  
 HALSTED STREET INTERCHANGE  
 SECTION 0101.6-1P  
 PLAN AND ELEVATIONS OF RAILINGS  
 RAMP WS  
 SCALE AS SHOWN  
 AUGUST 1999  
 SHEET NO. 4 OF 113 SHEETS

FILE PATH = C:\Project\14-0425 - 60W28-Structure\14-0425-sht-AS-BUILT-40.dgn



D160W28-sht-AS-BUILT-40.dgn  
 USER NAME = auyeungh  
 PLOT SCALE = 1:8000 / 1" = 80'  
 PLOT DATE = 4/25/2014

DESIGNED -	REVISED -
DRAWN -	REVISED -
CHECKED -	REVISED -
DATE - 04/28/14	REVISED -

STATE OF ILLINOIS  
 DEPARTMENT OF TRANSPORTATION

EXISTING AS-BUILTS  
 SN 016-2449 & SN 016-2451

SCALE: NTS SHEET 40 OF 48 SHEETS STA. TO STA.

F.A.I. RTE.	SECTION	COUNTY	TOTAL SHEETS	SHEET NO.
90/94/290	2013-010R	COOK	747	510
CONTRACT NO. 60W28				
ILLINOIS FED. AID PROJECT				