

FOR INFORMATION ONLY

ROUTE NO.	SECTION	COUNTY	DATE	NO.
F.A.I. 94	0101.6-1P	COOK	118	104
FED. ROAD DIST. NO.	NUMBER	PROJECT	I-94-2(1)-21	

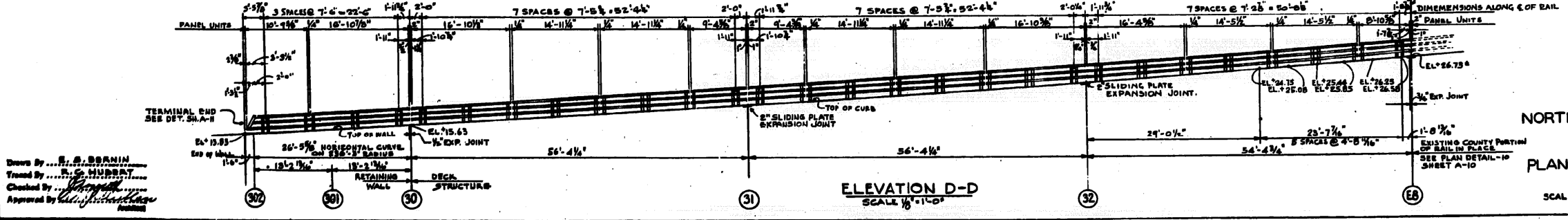
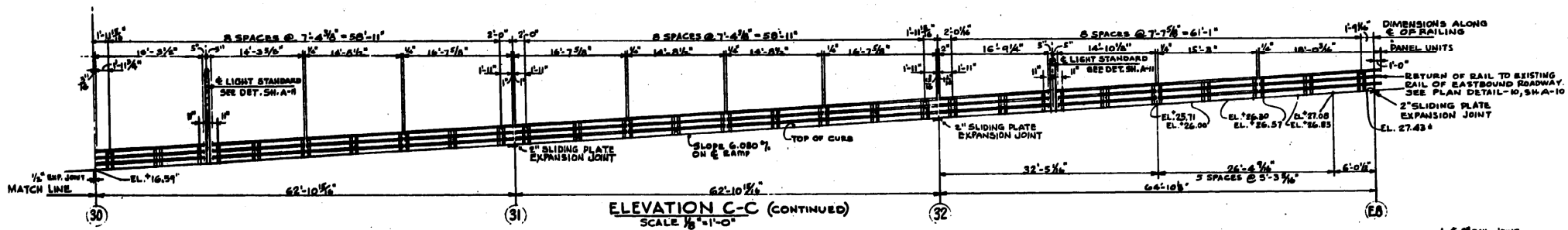
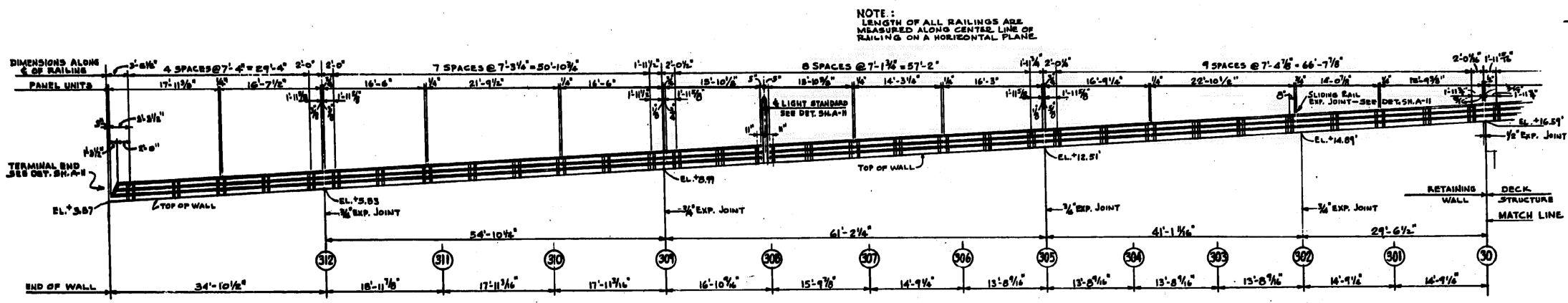
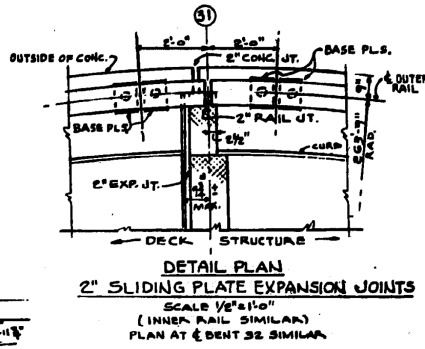
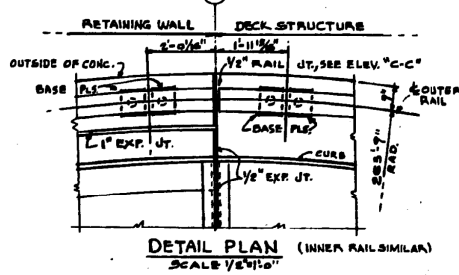
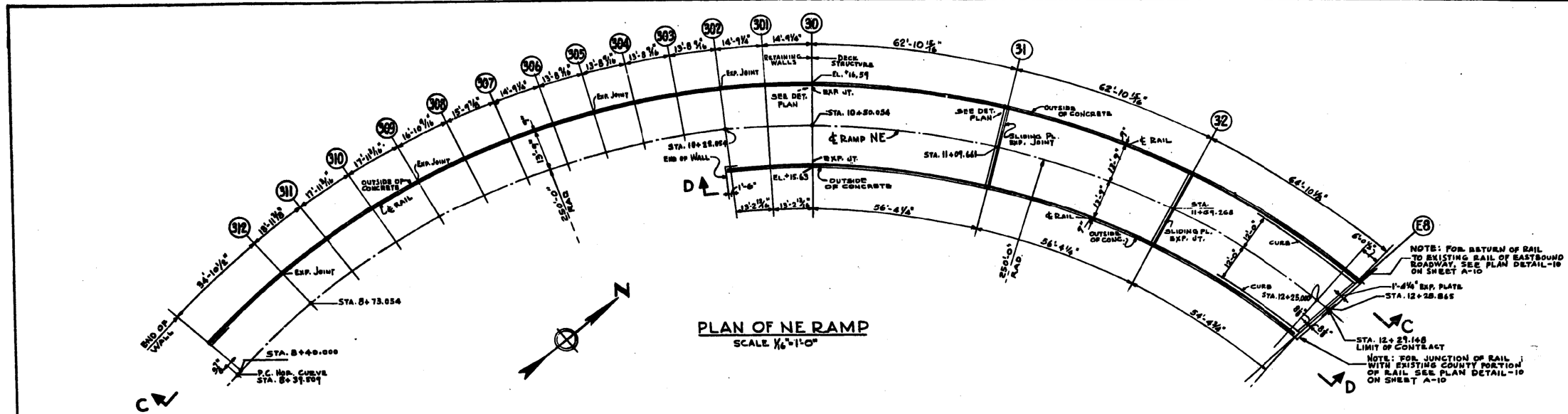

Drawn By: R. S. BEANIN  
 Traced By: R. S. HUBBART  
 Checked By: [Signature]  
 Approved By: [Signature]

CITY OF CHICAGO  
 DEPARTMENT OF PUBLIC WORKS  
 BUREAU OF ENGINEERING  
 NORTHWEST ROUTE SUPERHIGHWAY  
 HALSTED STREET INTERCHANGE  
 SECTION 0101.6-1P  
 PLAN AND ELEVATIONS OF RAILINGS  
 RAMP NE  
 SCALE AS SHOWN  
 AUGUST 1999  
 SHEET NO. A-9 OF 118 SHEETS

FILE PATH = C:\Projects\14-0425 - 60W28 Structure\14-0425-sht-AS-BUILT-45.dgn



D160W28-sht-AS-BUILT-45.dgn  
 USER NAME = ayeuengh  
 PLOT SCALE = 1.0000 / in.  
 PLOT DATE = 4/25/2014

DESIGNED -	REVISED -
DRAWN -	REVISED -
CHECKED -	REVISED -
DATE - 04/28/14	REVISED -

STATE OF ILLINOIS  
 DEPARTMENT OF TRANSPORTATION

EXISTING AS-BUILTS	SCALE: NTS
SN 016-2449 & SN 016-2451	SHEET 45 OF 48 SHEETS
TO STA.	TO STA.

F.A.I. RTE.	SECTION	COUNTY	TOTAL SHEETS	SHEET NO.
90/94/290	2013-010R	COOK	747	515
CONTRACT NO. 60W28				
ILLINOIS FED. AID PROJECT				