

- NOTES:**
1. Drill and Grout d10(E) into the Concrete to 1/4" larger in dia. than the diameter of the bar used with a Minimum Depth of 9 Inches in accordance with Section 584 of the Standard Specifications. Cost included with Reinforcement Bars, Epoxy Coated pay item.
 2. Work this sheet with Sheet RW2-09.

- LEGEND:**
- Cut Existing Steel Pile
 - Drill thru Existing Steel Pile
 - Proposed Drilled Shaft number

TYPICAL SECTION

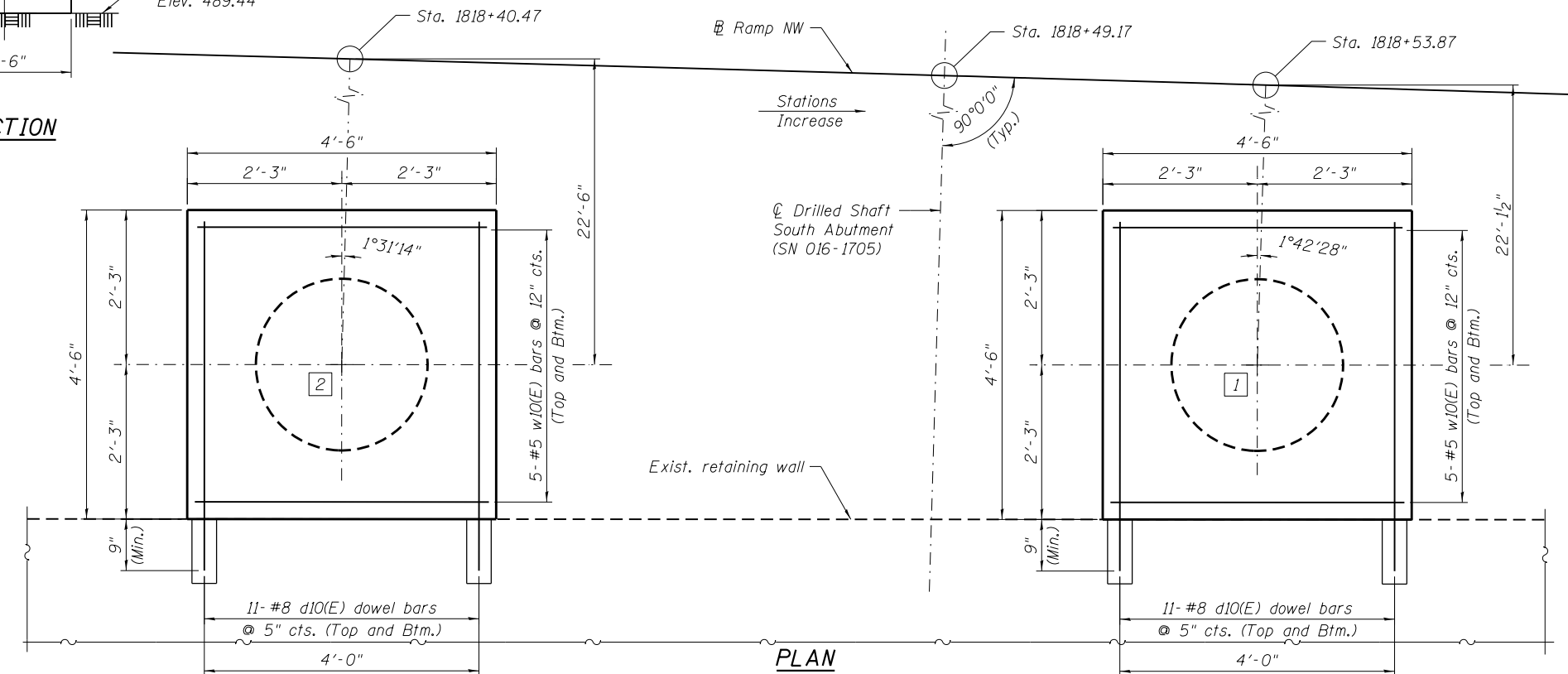

PLAN

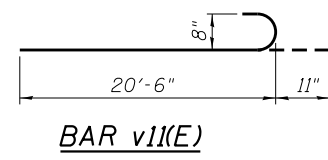

BILL OF MATERIAL

Bar	No.	Size	Length	Shape	
d10(E)	44	#8	5'-1"	—	
sp10	2	#4	87'-9"	~	
v10	44	#8	40'-0"	—	
v11(E)	22	#8	21'-5"	U	
w10(E)	20	#5	4'-2"	—	
Structure Excavation				Cu. Yd.	68
Concrete Structures				Cu. Yd.	4
Reinforcement Bars				Pound	6170
Reinforcement Bars, Epoxy Coated				Pound	1950
Drilled Shaft In Soil				Cu. Yd.	32

* Length is height of spiral.

016Z024-60W28-RW2-10



USER NAME = dunkerleyb	DESIGNED - ATB	REVISED
PLOT SCALE = N.T.S.	CHECKED - EJO	REVISED
PLOT DATE = 3/20/2014	DRAWN - MRK	REVISED
	CHECKED - ATB	REVISED

**STATE OF ILLINOIS
DEPARTMENT OF TRANSPORTATION**

**FOUNDATION DETAILS - II
STRUCTURE NO. 016-2024**

SHEET NO. RW2-100F RW2-12 SHEETS

F.A.I. RTE. 90/94/290	SECTION 2013-010R	COUNTY COOK	TOTAL SHEETS 747	SHEET NO. 542
CONTRACT NO. 60W28			ILLINOIS FED. AID PROJECT	